



# Core & Coil (71A) HPS ~LT~ 200W

## CORE & COIL HID HPS BAL 100W S54 120/220/240/V 50HZ C&C

The basic ballast is the open core and coil which is most often used as a component within a lighting luminaire. The core and coil also forms the nucleus of Philips Advance's five other ballast configurations.

### Product data

General Information	
ANSI Code	S54
Lamp Type	100W HPS
Number of Lamps	1 piece/unit
Circuit Type	HX-HPF
Ballast Type	Magnetic HID
Base Model	71A80N1
Core Size	3 X 4 (2 coil)
Suitable For Outdoor Use	Yes
Ignitor Catalog Number	LI551-H4
Ignitor Temperature Rating	105°C
Capacitor Value	12 MFD
Capacitor Catalog Number	7C120M33-R
Capacitor Requirements	280V
Capacitor Temperature Rating	105°C
Capacitor Diameter/Oval Dimensions	1.5 in
Capacitor Height	2.90 in
Automatic Restart	No

Operating and Electrical	
Input Voltage	120/220/240 V
Input Frequency	50 Hz
Input Current (Open Circuit)	2.4/1.3/1.2 A
Input Current (Starting)	0.9/0.5/0.45 A
Input Current (Short Circuit)	0.4-0.6/0.25-0.35/0.2-0.3 A
Secondary Short Circuit Current	2.1-2.6/2.1-2.6/2.1-2.6 A
Constant Wattage Deviation	Within Trapezoid
Ballast Factor (Nom)	1
Power Factor (Nom)	0.90
Open Circuit Voltage	120 V
Input Current (Nom)	1.2/0.65/0.6 A A
Input Power (Nom)	130 W
Rated Lamp Power	100 W

Wiring	
Wire Striplength	0.5 mm
Wire Length by Color	12"
Wire Type	Stranded
Remote Wiring Configuration Allowed	Yes

## Core & Coil (71A) HPS ~LT~ 200W

Max Ballast-Lamp Distance Remote	2'
Wiring	
Recommended Fuse Value	6/4/4 A
<b>Approval and Application</b>	
Open Circuit Voltage Test (Volts)	110-130 V
Approval Marks	ULR RoHS Compliant
Temperature Marking	A/A/A
UL Recognized	Yes
Hipot Test (1 Minute)	2000 V
Hipot Test (2 Seconds)	2500 V
UL Insulation Class	H(180°C)
UL Temperature Code	1029A

### Product Data

Order product name	CORE & COIL HID HPS BAL 100W S54 120/220/240/V 50HZ C&C
EAN/UPC - Product	781087026199
Order code	913700505011
Numerator - Quantity Per Pack	1
Numerator - Packs per outer box	4
Material Nr. (12NC)	913700505011
Net Weight (Piece)	5.496 kg

### Dimensional drawing

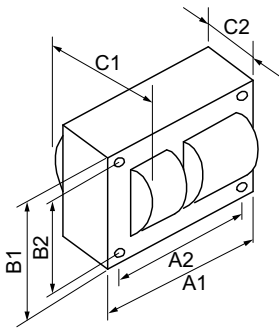

HPS BAL 100W S54 120/220/240/V 50HZ C&C

Product	C1	C2	A1	A2	B1	B2
CORE & COIL HID HPS BAL 100W S54 120/220/240/V 50HZ C&C	3.70 in	2.40 in	3.9 in	3.5 in	2.8 in	2.4 in

