



TuffGuard Coated T12

F96T12/CW/HO-O ALTO TG 15PK

When you select Philips TuffGuard™ Fluorescent lamp with ALTO® lamp technology, you are reducing the impact on the environment, while the coating helps to protect your customers, employees, and reputation. Philips TuffGuard™ fluorescent lamps meet sustainability requirements because they reduce the impact on the environment with low mercury, energy efficiency and long life. The patented green endcaps mean you're using ALTO low-mercury technology. The 16 mils thick coating on TuffGuard™ fluorescent lamps forms a protective seal from end to end and is guaranteed to last the average rated life of the lamp under specific conditions

Product data

General Information	
Base	R17D [R17d (RDC)]
Life 3-Hr Start [Hrs]	12000 h
Features	ALTO® (ALTO)
Footnotes Fluorescent/CFL 1	Meets the National Energy Policy Act of 1992 exemption for outdoor or cold temperature applications only. (223)

Light Technical	
Color Code	33
Initial lumen (Nom)	8800 lm
Color Designation	Cool White (CW)
Design Mean Lumens	7650 lm
Correlated Color Temperature (Nom)	4100 K
Color Rendering Index (Nom)	62

Operating and Electrical	
Power (Rated) (Nom)	110 W

Mechanical and Housing	
Cap-Base Information	Green Base
Nominal Length (Inch)	96

Approval and Application	
Energy Saving Product	Not Applicable
Mercury (Hg) Content (Nom)	6.8 mg

Product Data	
Order product name	F96T12/CW/HO-O ALTO TG 15PK
EAN/UPC - Product	046677163013
Order code	163014
Numerator - Quantity Per Pack	1
Numerator - Packs per outer box	15
Material Nr. (12NC)	927895203332
Net Weight (Piece)	0.001 kg

TuffGuard Coated T12

Warnings and Safety

- All HO lamps recommended for use only in open fixtures.
- Lamp contains mercury. Manage in Accord with Disposal Laws. See: www.lamprecycle.org or 1-800-555-0050

Dimensional drawing

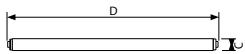

T12 Revised Double Contact

F96T12 110W/33 HO ALTO

Product

F96T12/CW/HO-O ALTO TG 15PK

