



Core & Coil (71A) LPS

CORE & COIL HID LPS BAL 35/55W L70/71 QUAD C&C

The basic ballast is the open core and coil which is most often used as a component within a lighting luminaire. The core and coil also forms the nucleus of Philips Advance's five other ballast configurations.

Product data

General Information		Input Current (Short Circuit)	
ANSI Code	L71	Input Current (Short Circuit)	0.36-0.54/0.23-0.34/0.2-0.3/0.16-0.25 A
Lamp Type	55W LPS	Secondary Short Circuit Current	0.5-0.7 A
Number of Lamps	1 piece/unit	Constant Wattage Deviation	10%
Circuit Type	HX-HPF	Ballast Factor (Nom)	1
Ballast Type	Magnetic HID	Power Factor (Nom)	0.90
Base Model	71A0490	Open Circuit Voltage	480 V
Core Size	3 X 4 (2 coil)	Input Current (Nom)	0.73/0.42/0.36/0.32 A A
Suitable For Outdoor Use	Yes	Input Power (Nom)	80 W
Capacitor Value	14 MFD	Rated Lamp Power	55 W
Capacitor Catalog Number	7C140M30RA	Wiring	
Capacitor Requirements	240V	Wire Striplength	0.5 mm
Capacitor Temperature Rating	105°C	Wire Length by Color	12"
Capacitor Diameter/Oval	1.65 in	Wire Type	Stranded
Dimensions		Remote Wiring Configuration	Yes
Capacitor Height	2.75 in	Allowed	
Automatic Restart	No	Max Ballast-Lamp Distance	Determined by AWG used
Operating and Electrical		Remote Wiring	
Input Voltage	120/208/240/277 V	Recommended Fuse Value	6/4/3/3 A
Input Frequency	60 Hz	Approval and Application	
Input Current (Open Circuit)	2.35/1.39/1.18/0.98 A	Open Circuit Voltage Test (Volts)	430-530 V
Input Current (Starting)	0.8/0.46/0.39/0.36 A	Approval Marks	ULR CSA certificate RoHS Compliant

Core & Coil (71A) LPS

Temperature Marking	A/A/A/A
UL Recognized	Yes
Hipot Test (1 Minute)	2000 V
Hipot Test (2 Seconds)	2500 V
UL Insulation Class	H(180°C)
UL Temperature Code	1029A

Product Data

Order product name	CORE & COIL HID LPS BAL 35/55W L70/71 QUAD C&C
--------------------	---

EAN/UPC - Product	781087119990
Order code	913700502041
Numerator - Quantity Per Pack	1
Numerator - Packs per outer box	6
Material Nr. (12NC)	913700502041
Net Weight (Piece)	3.071 kg

Dimensional drawing

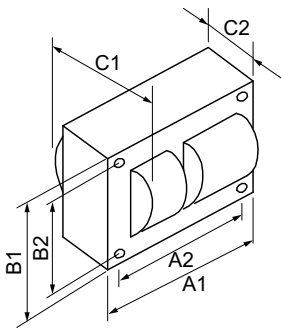

LPS BAL 35/55W L70/71 QUAD C&C

Product	C1	C2	A1	A2	B1	B2
CORE & COIL HID 71A0490500D	3.5 in	2.25 in	3.9 in	3.5 in	2.8 in	2.4 in

