

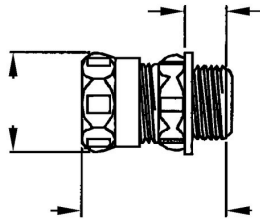

EMT RAINTIGHT COMPRESSION CONNECTORS

Compression Connectors, Raintight Steel
N/A

B07



Catalog #: 2960RT

APPLICATIONS

For use in wet locations to bond and secure EMT conduit to a box or enclosure
RACO Raintight Steel EMT Compression fittings have been designed to comply with the new U.L. Raintight test requirements and to comply with the requirements of the 2008 NEC 358.42 and 314.15

PRODUCT FEATURES

All steel construction insures mechanical protection for the raceway
Fittings are available in 1/2 in. to 4 in. trade sizes
Zinc electroplate finish
All fittings are marked "Wet Locations" to allow inspecting authorities to immediately determine that the installation is up to code
All connectors are supplied with a factory installed knockout seal. No need to add the expense of buying a gasket separately.
No need to disassemble the fitting prior to installation. RACO Raintight Steel EMT Compression fittings are designed so that when they come out of the carton they can be installed directly on the conduit. No need to waste time loosening compression nuts.
No need for special tools to install properly. Install these fittings like any other Steel EMT Compression fitting. No need for a torque wrench to insure proper installation.
N/A

CULUS

Standard 514B, UL Listed E195970, C22.2 No. 18

GENERAL PRODUCT INFORMATION

Sub Class: Insulated
Trade Size: 2-1/2 in.

DRAWING DIMENSIONS

Dimension A: 2.50 in.
Dimension B: .81 in.
Dimension C: 3.62 in.

PACKAGING

Package Type: Carton
Ship Carton Qty.: 1
Product UPC-A Labeled: No
Weight (Lbs. Per/C): 176.80
Ship Carton Length (in.): 6.25
Ship Carton Width (in.): 6.25
Ship Carton Height (in.): 5.00
Ctn Weight (Lbs.): 1.77
UPC Number: 050169501047
I2of5: 50050169501042