



Core & Coil (71A) HPS ~LT~ 200W

CORE & COIL HID HPS BAL 50W S68 QUAD KIT

The basic ballast is the open core and coil which is most often used as a component within a lighting luminaire. The core and coil also forms the nucleus of Philips Advance's five other ballast configurations.

Product data

General Information	
ANSI Code	S68
Lamp Type	50W HPS
Number of Lamps	1 piece/unit
Circuit Type	HX-HPF
Ballast Type	Magnetic HID
Base Model	71A7891
Core Size	3 X 4 (2 coil)
Suitable For Outdoor Use	Yes
Ignitor Catalog Number	LI551-H4
Ignitor Temperature Rating	105°C
Capacitor Value	5 MFD
Capacitor Catalog Number	7C050L30RA
Capacitor Requirements	300V
Capacitor Temperature Rating	105°C
Capacitor Diameter/Oval Dimensions	1.25 in
Capacitor Height	2.25 in
Automatic Restart	No

Operating and Electrical	
Input Voltage	120/208/240/277 V

Input Frequency	60 Hz
Input Current (Open Circuit)	1/0.57/0.5/0.45 A
Input Current (Starting)	0.65/0.37/0.32/0.3 A
Input Current (Short Circuit)	0.6-0.8/0.32-0.48/0.3-0.4/0.25-0.35 A
Secondary Short Circuit Current	1.3-1.9 A
Constant Wattage Deviation	Within Trapezoid
Ballast Factor (Nom)	1
Power Factor (Nom)	0.90
Open Circuit Voltage	125 V
Input Current (Nom)	0.61/0.35/0.31/0.26 A A
Input Power (Nom)	66 W
Rated Lamp Power	50 W

Wiring	
Wire Striplength	0.5 mm
Wire Length by Color	12"
Wire Type	Stranded
Remote Wiring Configuration Allowed	Yes
Max Ballast-Lamp Distance Remote	2'

Wiring	
--------	--

Core & Coil (71A) HPS ~LT~ 200W

Recommended Fuse Value	3/2/2/1 A
Approval and Application	
Open Circuit Voltage Test (Volts)	115-135 V
Approval Marks	ULR CSA certificate RoHS Compliant
Temperature Marking	A/A/A/A
UL Recognized	Yes
Hipot Test (1 Minute)	2000 V
Hipot Test (2 Seconds)	2500 V
UL Insulation Class	H(180°C)
UL Temperature Code	1029A

Product Data	
Order product name	CORE & COIL HID HPS BAL 50W S68 QUAD KIT
EAN/UPC - Product	781087087985
Order code	913701115201
Numerator - Quantity Per Pack	1
Numerator - Packs per outer box	1
Material Nr. (12NC)	913701115201
Net Weight (Piece)	1.937 kg

Dimensional drawing

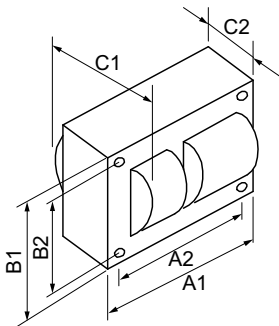

HPS BAL 50W S68 QUAD KIT

Product	C1	C2	A1	A2	B1	B2
CORE & COIL HID HPS BAL 50W S68 QUAD KIT	2.2 in	1 in	3.9 in	3.5 in	2.8 in	2.4 in

