

INSTALLATION INSTRUCTIONS FLUSH-FLOOR POKE-THROUGH FITTING SINGLE DUPLEX POWER

Cat. No. FPT449 & FPT450

Thomas & Betts

⚠ WARNING ⚠
ELECTRICAL HAZARD!
BE SURE POWER IS OFF!

IMPORTANT NOTES:

1. This flush POKE-THROUGH system is designed to maintain the hourly rating of concrete floors having ratings of 1 to 4 hours, when installed in accordance with these installation instructions.
2. To maintain fire resistance classification rating either of the following must be installed:
 - a) A complete Thomas & Betts service fitting, including the service fitting base and service fitting cover.
 - or
 - b) An abandonment kit, Catalog No. FPT415.
3. See product category "outlet boxes and fittings" classification for fire resistance standards. This can be found in the current Underwriters Laboratories, Inc. "Fire Resistance Directory," which includes a listing for the fire resistance classification of the Thomas & Betts Modular Poke-Through System.
4. All installations of UL listed Poke-Through service fittings have the following restrictions: "Minimum of 2 ft. on center and not more than one device per 65 sq. ft. of floor area in each span."
5. This through-floor fitting will mount several types of Thomas & Betts UL listed service fittings which will accommodate different combinations of power, telephone and data. Determine location and orientation of mounting screw holes for the specific service fitting chosen prior to installation. CONSULT THE ENCLOSED ADDENDUM FOR MORE DETAILS.

INSTALLATION INSTRUCTIONS

NOTE: It may be necessary to move or remove carpeting to allow proper installation of through-floor fitting.

- a) Core or bore a 3" diameter hole through floor.

IMPORTANT: See Note 4 above.

- b) Insert through-floor fitting into hole and orient plastic power tube into desired position. Make certain location bracket is flush with concrete floor.

NOTE: Careful consideration must be given to final pedestal location and orientation prior to engagement of retainer clips to ensure desired final pedestal installation.

IMPORTANT: Not for use on bare concrete or floor coverings less than 1/4" thick.

STEP 1

POWER WIRE ATTACHED TO DEVICE AND MOUNTING PLATE

PUTTY BOTH SIDES

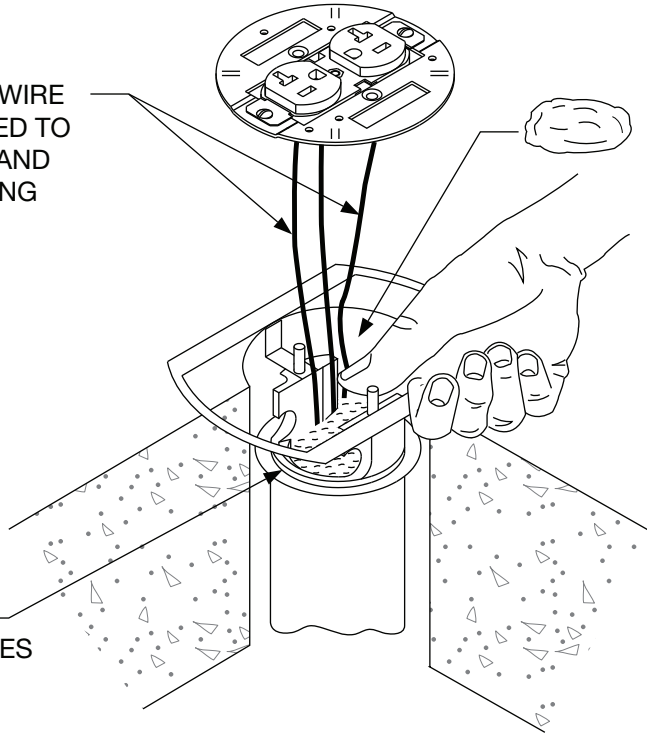

- a) Ensure that all electrical power is disconnected and that wires are de-energized. Feed power wires into power side of Poke-Through. Leave max. 4" of wire above floor.
- b) Fill inside of Poke-Through device with putty supplied. Press firmly into place around all wires. Use all putty material supplied.

STEP 2

MOUNTING PLATE

REPLACE 1/4" CARPET

5-1/4" CUT HOLE IN CARPET

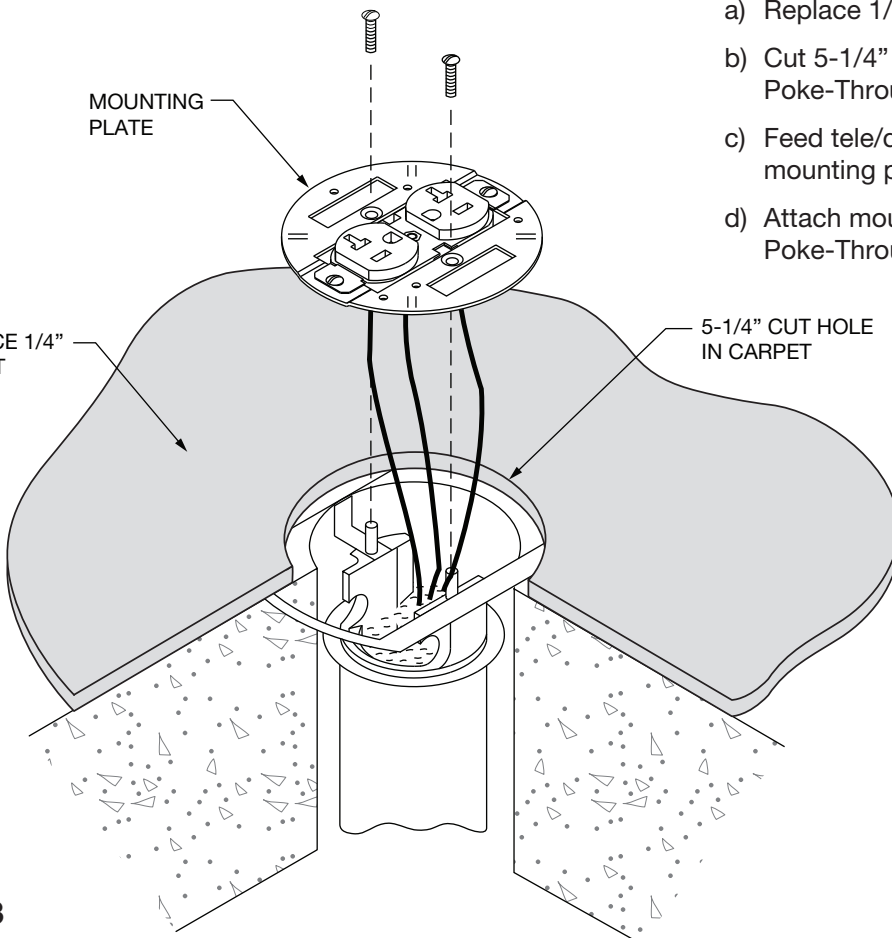

- a) Replace 1/4" thick carpet..
- b) Cut 5-1/4" hole in carpet over Poke-Through.
- c) Feed tele/data and power wire(s) into mounting plate as shown.
- d) Attach mounting plate to Poke-Through with screws furnished.

STEP 3

- a) To ensure scrub-water exclusion, apply a continuous bead of silicone sealant around mounting plate underneath cover.
- b) Attach cover and gasket to mounting plate with three flat head screws furnished.

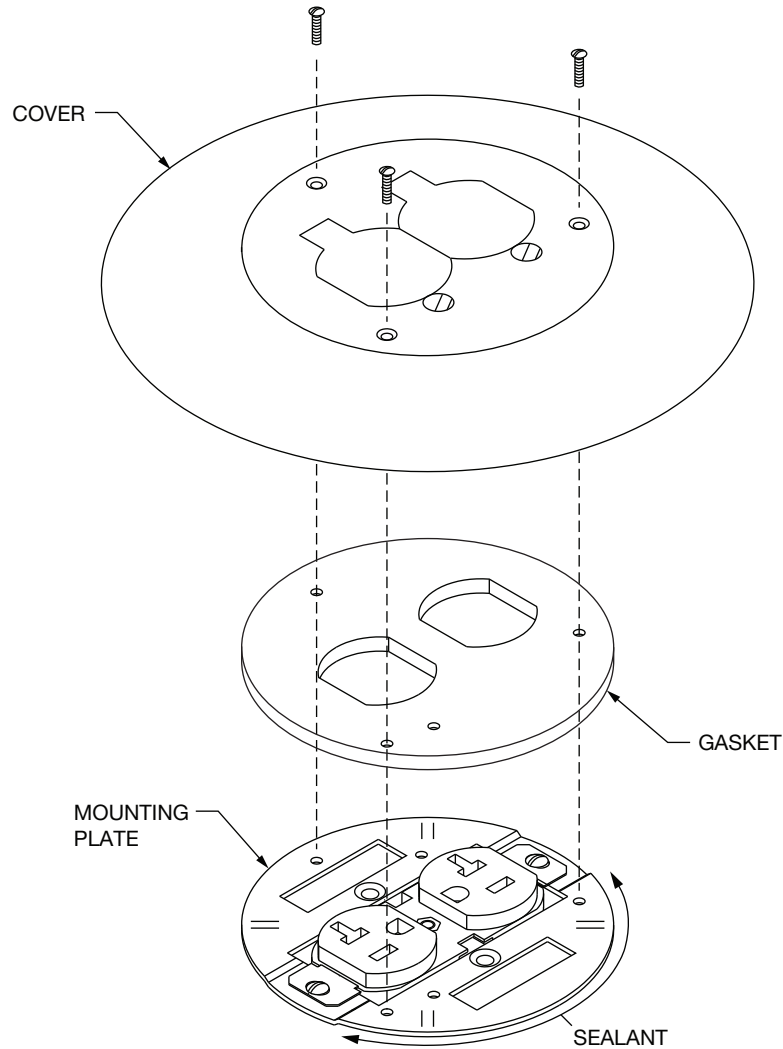

STEP 4

SEE LAST PAGE FOR REPLACEMENT INSTRUCTIONS

WARRANTY: Thomas & Betts sells this product with the understanding that the user will perform all necessary tests to determine the suitability of this product for the user's intended application. Thomas & Betts warrants that this product will be free from defects in materials and workmanship for a period of two (2) years following the date of purchase. Upon prompt notification of any warranted defect, Thomas & Betts will, at its option, repair or replace the defective product or refund the purchase price. Proof of purchase is required. Misuse or unauthorized modification of the product voids all warranties.

Limitations and Exclusions: THE ABOVE WARRANTY IS THE SOLE WARRANTY CONCERNING THIS PRODUCT, AND IS IN LIEU OF ALL OTHER WARRANTIES EXPRESS OR IMPLIED, INCLUDING BUT NOT LIMITED TO ANY IMPLIED WARRANTY OF MERCHANTABILITY OR FITNESS FOR A PARTICULAR PURPOSE, WHICH ARE SPECIFICALLY DISCLAIMED. LIABILITY FOR BREACH OF THE ABOVE WARRANTY IS LIMITED TO COST OF REPAIR OR REPLACEMENT OF THE PRODUCT, AND UNDER NO CIRCUMSTANCES WILL THOMAS & BETTS BE LIABLE FOR ANY INDIRECT, SPECIAL, INCIDENTAL OR CONSEQUENTIAL DAMAGES.

Thomas & Betts Corporation
 Memphis, Tennessee
 www.tnb.com

REPLACEMENT INSTRUCTIONS FOR OTHER T&B FIRE-RATED PEDESTALS

⚠ WARNING ⚠
ELECTRICAL HAZARD!
BE SURE POWER IS OFF!

- a) Remove receptacle and cover plate assembly by removing screws on top, see Figure 1R
- b) Disconnect power and ground cables from receptacle.

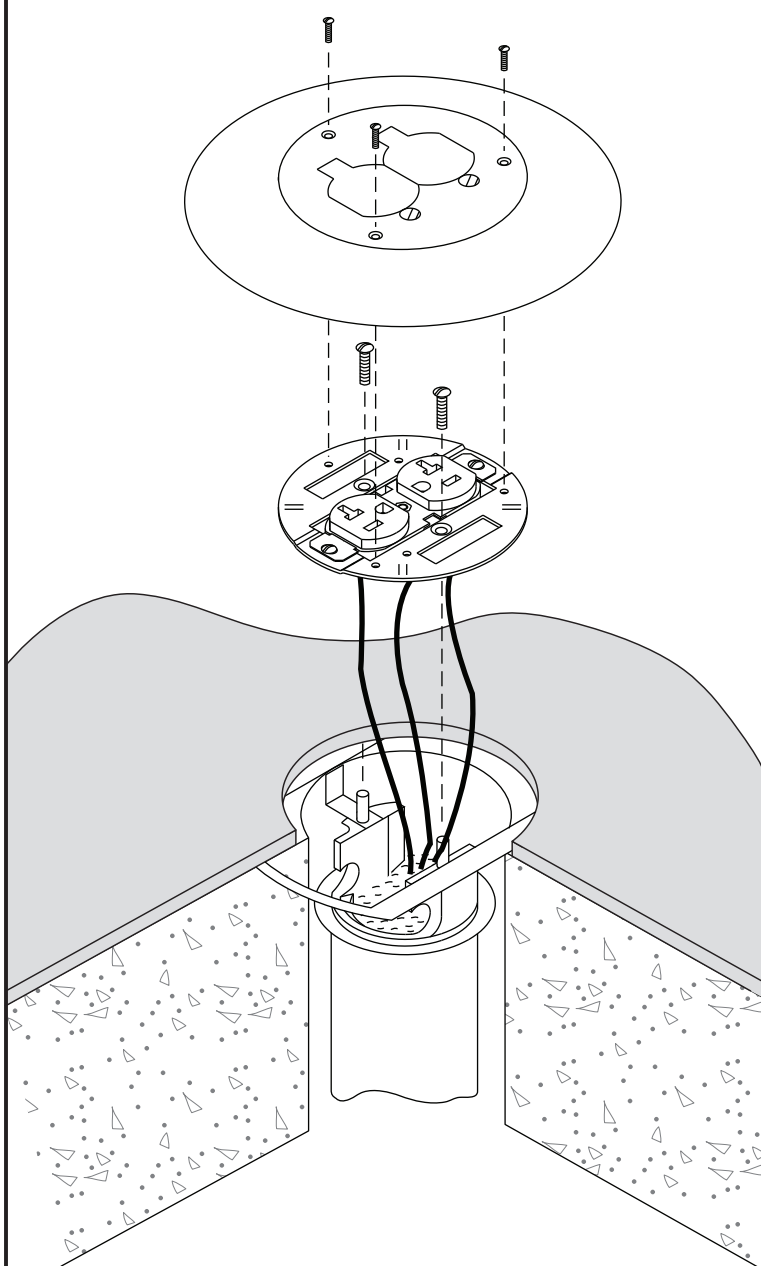

STEP 1R

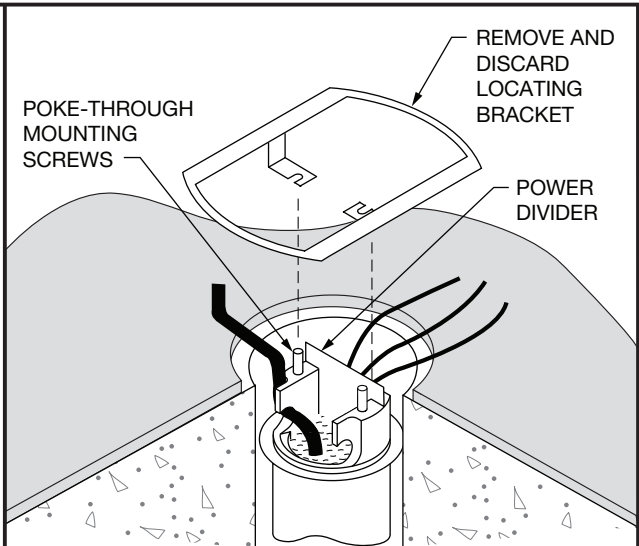

- a) Loosen Poke-Through mounting screws 3-4 full turns.
- b) Remove locating bracket by rotating clock-wise and lifting out. NOTE: It may be necessary to move or remove carpeting during retrofit installation.
- c) Tighten mounting screws.

STEP 2R

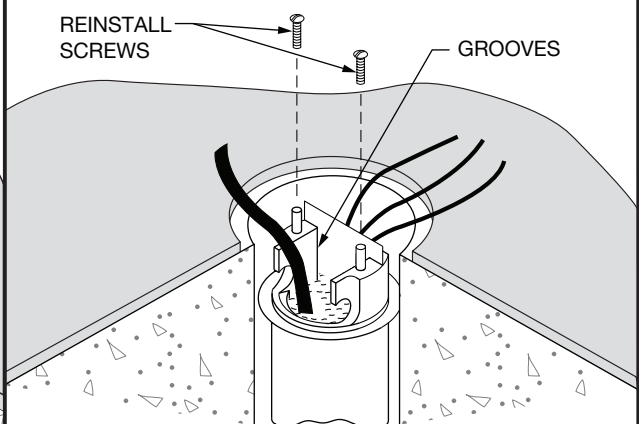

- a) Reinstall screws into Poke-Through device as shown.
- b) If carpeting was removed in Step 2R, replace carpet now.
- c) Install floor pedestal according to instructions supplied with pedestal.

STEP 3R