

Superstrut

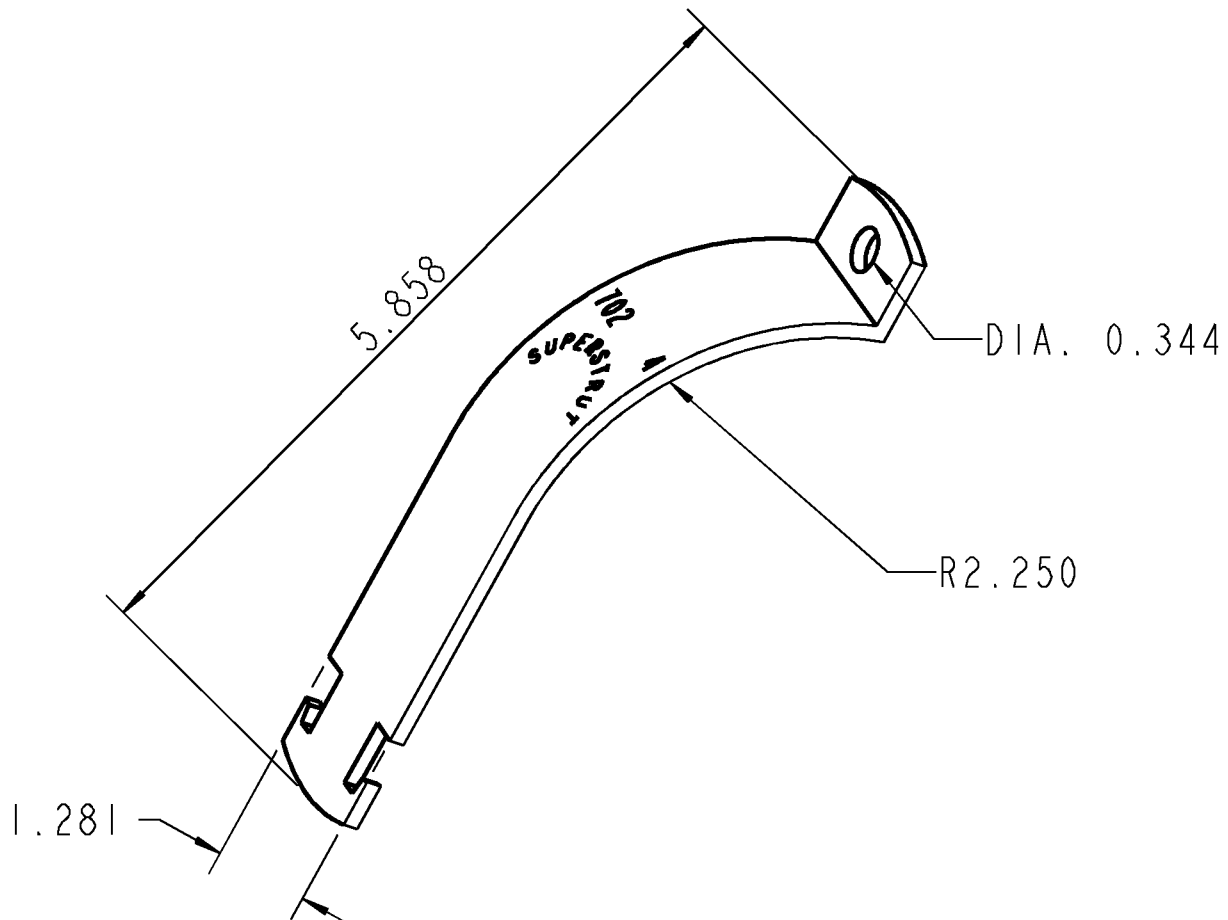

CONDUIT STRAP FOR USE WITH 4" EMT, IMC, RIGID CONDUIT AND STEEL PIPE (SS316)	702-4-SS316	NOTE 3	-
CONDUIT STRAP FOR USE WITH 4" EMT, IMC, RIGID CONDUIT AND STEEL PIPE	702-4-PI	NOTE 1	2
DESCRIPTION	CATALOG NO.	MATERIAL	FINISH

NOTES :

1. MATERIAL: .125 THK. HOT ROLLED LOW CARBON STEEL.
2. FINISH: ELECTRO-ZINC BASE WITH GOLD GUARD CHROMATE OUTER BARRIER
3. MATERIAL: .125 MIN THK, 316 STAINLESS STEEL

GENERAL NOTES		Thomas & Betts A Member of the ABB Group			
1. ALL DIMENSIONS ARE FOR REFERENCE ONLY. 2. DIMENSIONS IN BRACKETS [] ARE IN METRIC UNITS.		www.tnb.com			
REVISIONS		DESCRIPTION: CONDUIT STRAP FOR USE WITH 4" EMT, IMC, RIGID CONDUIT, AND STEEL PIPE			
- SEE ERN (****) FOR APPROVAL SIGNATURES & RELEASE DATE. PROJECT NO: ****		ORIGINAL PROJECT NO / (ERN NO) XM400032 / (2015693)	SHEET NO: 1 OF 1	REV. NO: -	DRAWING NO: WSD-001306

THIS DRAWING IS INTENDED FOR DESCRIPTIVE PURPOSES ONLY, AND THE RIGHT IS RESERVED TO DEViate FROM ANY OF THE DETAILS SHOWN HEREON.
COPYRIGHT THOMAS & BETTS CORPORATION. ALL RIGHTS RESERVED. PROPRIETARY AND CONFIDENTIAL.