

Job or Customer :	
Location :	
Engineer :	
<input type="checkbox"/> Complies with Spec <input type="checkbox"/> Alternate	Notes :
Contractor :	
HeatLink Rep :	
Submitted By :	Date :
Approved By :	Date :
P.O. Number :	Date :

Description

High Performance Polymer PEX F1960 plugs for use with PEX-a potable water expansion systems.

Qty	Stk. #	Size	Dimension, in/(mm)				Weight, lb/(kg)
			A	B	C	ID	
	EX15005	½"	0.712 (18.0)	0.140 (3.6)	0.844 (21.4)	0.41 (10.4)	0.007 (0.003)
	EX15022	¾"	0.943 (24.0)	0.142 (3.6)	1.094 (27.8)	0.61 (15.5)	0.013 (0.006)
	EX15028	1"	1.171 (29.7)	0.142 (3.6)	1.33 (33.8)	0.81 (20.6)	0.024 (0.011)

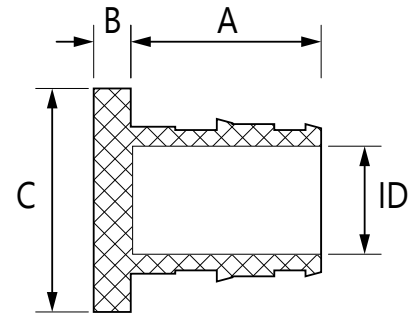

Technical Data

	Specifications
Material	PPSU
Operating Pressure rating	180°F @ 100psi (82.2°C @ 0.69MPa)

Listings

cNSFus-pw-G
Codes
IAPMO UPC

Standards

ASTM F1960 NSF/ANSI 14
ASTM F877 NSF/ANSI 61
CSA B137.5 NSF/ANSI 372

Installation

Installation must follow all of HeatLink's instructions and guidelines.

Related Documents

- PEX-a F1960 Potable Water Expansion System Installation Guide (L3240)
- HeatLink Limited Plumbing Warranty

This page is intentionally blank.