

SECTION H



Table of Contents



Single Pole Plugs and Receptacles



Spider® II Temporary Power Boxes



Temporary Lighting and Maintenance Worklights



| Single Pole Devices | Page |
|--|------|
| Series 15 - 150 Ampere, 600V AC/250V DC | |
| Features and Benefits | H-2 |
| Plugs, Receptacles, Protective Caps and Snap Back Covers | H-3 |
| Tees, Gender Reversing, Replacement Bodies and Accessories | H-4 |
| Series 16 - 300 and 400 Ampere, 600V AC/250V DC | |
| Features and Benefits | H-2 |
| Plugs and Receptacles | H-6 |
| Tees, 3-Fers, Gender Reversing Devices, and Distribution Block | H-8 |
| Protective Caps and Weather Protective Covers | H-8 |
| Replacement Parts, Snap Back Covers and Accessories | H-9 |

| Temporary Power | Page |
|---|------|
| Spider® II Temporary Power Boxes | |
| Features and Benefits | H-11 |
| 50A and 60A Spider® II Boxes | H-12 |
| Cable Sets, Receptacles and Replacement Parts | H-13 |
| Temporary Power Boxes and Power Cables | H-14 |
| Heavy-Duty Portable Outlet Boxes and Cover Plates | H-15 |
| Temporary Lighting | |
| Construction Site Lighting | H-16 |
| Maintenance Worklights, Accessories and Replacement Items | H-17 |
| Explosion Proof/Confined Space Lighting | H-17 |
| Pre-Wired Portable Outlet Boxes, Worklights and Accessories | H-18 |



Features and Benefits

Series 15 and 16 - 150, 300 and 400 Ampere, 600V AC/250V DC

Hubbell Wiring Device-Kellems offers a full line of innovative, high quality, Series 15 and Series 16 single pole plugs, receptacles and accessories.

Single pole devices are the right choice for supplying temporary electrical power distribution for entertainment, theme parks, carnival equipment, concerts, movie making, and numerous other applications requiring temporary power.

Single pole devices have been designed with ease of assembly and disassembly in mind, no special tools are required. A high strength non-conductive retaining screw is all that is needed to securely lock the contacts to the insulated sleeve.

- Special screw thread requires fewer turns than most competitors and reduces the risk of a conductive screw being substituted.



HBL15MBK



HBL15FBK



Housing Design

- Insulgrip® style housing for superior gripping conforms to the user's hand making it easy to connect and disconnect, even with gloves on
- Easily identifiable cable with cut off points for secure fit allows you to easily customize and cut the housing to the required/correct cable size. Accommodates wide range of cables



Assembly

- Special screw thread requires fewer turns than most competitors and reduces the risk of a conductive screw being substituted
- Non-conductive retaining screw locks contacts in place and allows for easy installation. Prevents contact movement within housing



Safety

- Rounded corners reduce the possibility of catching or snagging on structures or equipment
- Large Raised Alignment Arrow aids in the mating of devices and provides a visual indication that the devices are properly connected



Contacts

- Provides high contact pressure and vibration resistant connection, which helps reduce operating temperatures and extends product life
- Mounting screw recesses minimize screwdriver slippage



Identification

- Turn and lock symbol aids in the mating of devices and provides a clear indication that the devices are properly connected
- Alignment arrows and lock and unlock symbols provide a visual indication that devices are properly connected



Installation

- Strip gauge molded into every plug and receptacle housing. Simplifies installation and saves time
- Extra long non-conductive inner sleeve reduces force required to install housing over contacts. Easier to rotate contact in body for installing retaining screw

Single Pole Devices and Temporary Power



Series 15 - 150 Ampere, 600V AC/250V DC

Enclosure Types
3R, 4X, 12



Plugs, Male

| Description | Color | Male Plug |
|---|--------|-----------------|
| 150 amp, thermoplastic elastomer, cable size #8 - #2 AWG. | Black | HBL15MBK |
| | White | HBL15MW |
| | Green | HBL15MGN |
| | Red | HBL15MR |
| | Blue | HBL15MBL |
| | Brown | HBL15MBN |
| | Orange | HBL15MO |
| | Yellow | HBL15MY |
| | Gray | HBL15MGY |



Plugs, Female

| Description | Color | Female Plug |
|---|--------|-----------------|
| 150 amp, thermoplastic elastomer, cable size #8 - #2 AWG. | Black | HBL15FBK |
| | White | HBL15FW |
| | Green | HBL15FGN |
| | Red | HBL15FR |
| | Blue | HBL15FBL |
| | Brown | HBL15FBN |
| | Orange | HBL15FO |
| | Yellow | HBL15FY |
| | Gray | HBL15FGY |

Receptacles, Stud Type $1\frac{1}{16}'' \times \frac{3}{4}''$



| Description | Color | Female Receptacles | Male Receptacles |
|---|--------|--------------------|-------------------|
| 150 amp Panel Mount, thermoplastic, cable size #8 - #2 AWG. | Black | HBL15FRSBK | HBL15MRSBK |
| | White | HBL15FRSW | HBL15MRSW |
| | Green | HBL15FRSGN | HBL15MRSGN |
| | Red | HBL15FRSR | HBL15MRSR |
| | Blue | HBL15FRSBL | HBL15MRSBL |
| | Brown | HBL15FRSBN | HBL15MRSBN |
| | Orange | HBL15FRSO | HBL15MRSO |
| | Yellow | HBL15FRSY | HBL15MRSY |
| | Gray* | — | — |

Note: *Gray is available upon request.

Receptacles, Double Set Screw



| Description | Female Receptacles | Male Receptacles |
|---|--------------------|------------------|
| 150 amp Panel Mount, thermoplastic, cable size #8 - #2 AWG. | HBL15FRBK | HBL15MRBK |
| | HBL15FRW | HBL15MRW |
| | HBL15FRGN | HBL15MRGN |
| | HBL15FRR | HBL15MRR |
| | HBL15FRBL | HBL15MRBL |
| | HBL15FRBN | HBL15MRBN |
| | HBL15FRO | HBL15MRO |
| | HBL15FRY | HBL15MRY |
| | HBL15FRGY | HBL15MRGY |

Protective Caps



| Description | Color | Fits Female Devices | Fits Male Devices |
|-------------------------------------|-------|---------------------|--------------------|
| Fits 150 amp plugs and receptacles. | Black | HBL15FCAPBK | HBL15MCAPBK |
| | White | HBL15FCAPW | HBL15MCAPW |
| | Green | HBL15FCAPGN | HBL15MCAPGN |
| | Red | HBL15FCAPR | HBL15MCAPR |
| | Blue | HBL15FCAPBL | HBL15MCAPBL |
| | ** | | |

Note: **Additional colors are available upon request. Contact factory.

Weather Protective Covers



| Description | Color | Catalog Number |
|---|-------|------------------|
| Use with stud type or double set screw receptacles. | Clear | HBL15NCC |
| | Black | HBL15NCBK |
| | White | HBL15NCW |
| | Green | HBL15NCGN |
| | Red | HBL15NCR |
| | Blue | HBL15NCBL |

Tees



| Color | Tapping Tee (Female-Female-Male) | Paralleling Tee (Female-Male-Male) |
|-------|-------------------------------------|---------------------------------------|
| Black | HBL15TBK | HBL15PTBK |
| White | HBL15TW | HBL15PTW |
| Green | HBL15TGN | HBL15PTGN |
| Red | HBL15TR | HBL15PTR |
| Blue | HBL15TBL | HBL15PTBL |

Gender Reversing Devices



| Color | Double Male (Male-Male) | Double Female (Female-Female) |
|-------|----------------------------|----------------------------------|
| Black | HBL15DMBK* | HBL15DFBK* |
| White | HBL15DMW | HBL15DFW |
| Green | HBL15DMGN | HBL15DFGN |
| Red | HBL15DMR* | HBL15DFR* |
| Blue | HBL15DMBL* | HBL15DFBL* |

Note: *Not UL listed, consult factory for availability.

Replacement Bodies (25 Pack)



| Color | Male Body | Female Body |
|-------|------------------|------------------|
| Black | HBL15MBBK | HBL15FBBK |
| White | HBL15MBW | HBL15FBW |
| Green | HBL15MBGN | HBL15FBGN |
| Red | HBL15MBR | HBL15FBR |
| Blue | HBL15MBBL | HBL15FBBL |

Replacement Contacts (25 Pack)



| Description | Male Pin | Female Sleeve |
|------------------|-----------------|-----------------|
| Contact, 150 amp | HBL15RCM | HBL15RCF |

Accessories

| Description | Catalog Number |
|--|-------------------|
| Accessory Kit, retaining screw, copper foil, terminal screws and brass wire. | HBL15PK |
| Replacement retaining screw (100 pack). | HBL15RS |
| Copper foil (100 pack). | HBL15CF |
| Brass wire (100 pack). | HBL15BW |
| Terminal screw - inline (100 pack). | HBL15TS25 |
| Terminal screw - panel mount (100 pack). | HBL15TS375 |
| Ferrule #2 AWG (100 pack). | HBL15F2 |
| Ferrule #4 AWG (100 pack). | HBL15F4 |



HBL15PK



HBL15RS



HBL15CF



HBL15BW



HBL15TS25



HBL15TS375



HBL15F2
HBL15F4

Single Pole Devices and Temporary Power



Series 15 - 150 Ampere, 600V AC/250V DC

Specifications

| | |
|--------------------------|--|
| Electrical | |
| Voltage Ratings | 600V AC Maximum. 250V DC Maximum. |
| Amperage Rating | 150A Maximum. |
| Mechanical | |
| Terminal Accommodation | Plug: #8 to #2 AWG. Recept.: #8 to #2 AWG. |
| Product Identification | Ratings are a permanent part of device. |
| Base Compound | Plug: Thermoplastic Elastomer (TPE). Recept.: Polybutylene Terephthalate (PBT). |
| Contact Material | Brass. |
| Retaining Screw Material | Nylon. |

Certification / Environmental

UL and cUL Listed.
UL Enclosure Types 3R, 4X, 12.
UL 1691 standard for single pole locking-type separable connectors.
National Electric Code (NEC®), ANSI/NFPA 70.

Conductor Ampacity Chart (Type SC/PPC Wire)

| Cable Size | Ampacity* |
|------------|-----------|
| #8 | 80 |
| #6 | 105 |
| #4 | 140 |
| #2 | 190 |

Note: *90°C column NEC Table 400.5(A)(2).

Dimensions

Panel Mount Receptacles

| Threaded Stud | A | B | C | D | E | F | Mounting Hole | Termination |
|-------------------------|-----------------|-----------------|-----------------|----------------|----------------|-----------------|----------------------|------------------------------------|
| Male | 1.86" (47.2) | 1.37" (34.8) | 2.82" (71.6) | .86" (22.0) | .80" (20.4) | 1.20" (30.5) | Through 3x Ø .20" | 5/16-18 Threaded Stud |
| Female | 1.86" (47.2) | 1.37" (34.8) | 2.88" (73.1) | .86" (22.0) | .80" (20.4) | 1.26" (32.0) | Through 3x Ø .20" | 5/16-18 Threaded Stud |
| Double Set Screw | A | B | C | D | E | F | Mounting Hole | Termination |
| Male | 1.86" (47.2) | 1.37" (34.8) | 2.90" (73.6) | .86" (22.0) | .88" (22.2) | 1.20" (30.5) | Through 3x Ø .20" | (2) 5/32 Socket Head Set Screws |
| Female | 1.86" (47.2) | 1.37" (34.8) | 2.95" (74.9) | .86" (22.0) | .87" (22.2) | 1.26" (32.0) | Through 3x Ø .20" | (2) 5/32 Socket Head Set Screws |

Series 15 Threaded Stud

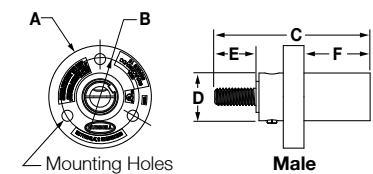

Series 15 Double Set Screw

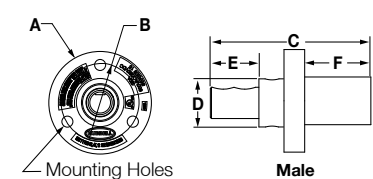

Inline Plugs

| | A | B | C | D |
|--------|-------------------|-----------------|----------------|-----------------|
| Male | 4.54" (115-.3) | 1.04" (26.4) | .86" (21.8) | 3.22" (81.7) |
| Female | 4.60" (116.8) | 1.11" (28.2) | .68" (17.3) | 3.28" (83.2) |

Series 15 Male Inline Plug

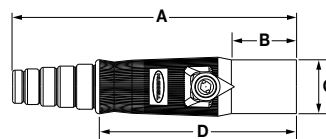

Series 15 Female Inline Plug

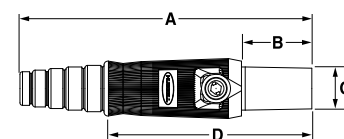

Gender Reversing Devices

| | A | B | C |
|---------------|------------------|-----------------|----------------|
| Double Male | 4.22" (107.3) | .86" (21.8) | — |
| Double Female | 4.22" (107.3) | 1.05" (26.7) | .68" (17.3) |

Series 15 Double Male

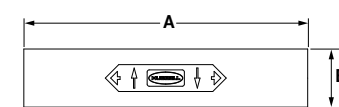

Series 15 Double Female

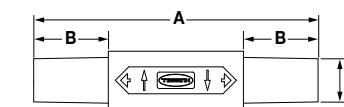

Tees

| | A | B | C |
|-----------------|-----------------|------------------|-----------------|
| Tapping Tee | 2.67" (67.9) | 4.28" (45.9) | .865" (21.9) |
| Paralleling Tee | 2.67" (67.9) | 4.22" (107.2) | .865" (21.9) |

Series 15 Tapping Tee

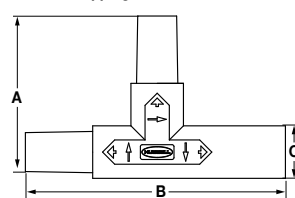

Series 15 Paralleling Tee

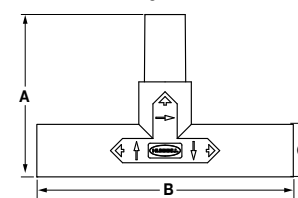

Weatherproof Cover

| | A | B | C |
|-----------|-----------------|-----------------|-----------------|
| Series 15 | 2.03" (51.5) | 1.14" (29.0) | 1.49" (37.9) |

Series 15 Weatherproof Cover

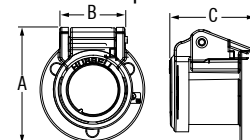

NEC® is a registered trademark of the National Fire Protection Association (NFPA).

Dimensions in Inches (mm)

Single Pole Devices and Temporary Power



Series 16 - 300 and 400 Ampere, 600V AC/250V DC

Enclosure Types
3R, 4X, 12



Plugs

| Description | Color | Male Plug | Female Plug |
|--|--------|------------------|------------------|
| 300 amp, thermoplastic elastomer, cable size #6 - 2/0 AWG. | Black | HBL300MBK | HBL300FBK |
| | White | HBL300MW | HBL300FW |
| | Green | HBL300MGN | HBL300FGN |
| | Red | HBL300MR | HBL300FR |
| | Blue | HBL300MBL | HBL300FBL |
| | Brown | HBL300MBN | HBL300FBN |
| | Orange | HBL300MO | HBL300FO |
| | Yellow | HBL300MY | HBL300FY |
| | Gray | — | — |



| Description | Color | Male Plug | Female Plug |
|---|--------|------------------|------------------|
| 400 amp, thermoplastic elastomer, cable size 2/0 - 4/0 AWG. | Black | HBL400MBK | HBL400FBK |
| | White | HBL400MW | HBL400FW |
| | Green | HBL400MGN | HBL400FGN |
| | Red | HBL400MR | HBL400FR |
| | Blue | HBL400MBL | HBL400FBL |
| | Brown | HBL400MBN | HBL400FBN |
| | Orange | HBL400MO | HBL400FO |
| | Yellow | HBL400MY | HBL400FY |
| | Gray | HBL400MGY | HBL400FGY |



Receptacles, Female Stud Type

| Description | Color | Through Hole Mounting | Threaded Mounting Holes |
|---|----------------|-----------------------|-------------------------|
| 400 amp Panel Mount, thermoplastic elastomer, mates with 300 and 400 amp plugs. | Black | HBLFRSBK | HBLFRSCBK |
| | White | HBLFRSW | HBLFRSCW |
| | Green | HBLFRSGN | HBLFRSCGN |
| | Red | HBLFRSR | HBLFRSCR |
| | Blue | HBLFRSBL | HBLFRSCBL |
| | Brown | HBLFRSBN | HBLFRSCBN |
| | Orange | HBLFRSO | HBLFRSCO |
| Yellow | HBLFRSY | HBLFRSCY | |



Receptacles, Male Stud Type

| Description | Color | Through Hole Mounting | Threaded Mounting Holes |
|---|----------------|-----------------------|-------------------------|
| 400 amp Panel Mount, thermoplastic elastomer, mates with 300 and 400 amp plugs. | Black | HBLMRSBK | HBLMRSCBK |
| | White | HBLMRSW | HBLMRSCW |
| | Green | HBLMRSGN | HBLMRSCGN |
| | Red | HBLMRSR | HBLMRSCR |
| | Blue | HBLMRSBL | HBLMRSCBL |
| | Brown | HBLMRSBN | HBLMRSCBN |
| | Orange | HBLMRSO | HBLMRSCO |
| Yellow | HBLMRSY | HBLMRSCY | |



Angled Receptacles, Stud Type

| Description | Color | Female Receptacles | Male Receptacles |
|---|--------|--------------------|------------------|
| 400 amp Panel Mount, thermoplastic elastomer, mates with 300 and 400 amp plugs. | Black | HBLFRASBK | HBLMRASBK |
| | White | HBLFRASBL | HBLMRASBL |
| | Green | HBLFRASBN | HBLMRASBN |
| | Red | HBLFRASGN | HBLMRASGN |
| | Blue | HBLFRASO | HBLMRASO |
| | Brown | HBLFRASR | HBLMRASR |
| | Orange | HBLFRASW | HBLMRASW |
| | Yellow | HBLFRASY | HBLMRASY |

Single Pole Devices and Temporary Power



Series 16 - 300 and 400 Ampere, 600V AC/250V DC

Enclosure Types
3R, 4X, 12

Receptacles, Double Set Screw



| Description | Color | Female Receptacles | Male Receptacles |
|--|--------|--------------------|------------------|
| 400 amp Panel Mount, thermoplastic elastomer, cable size #4 - 4/0 AWG, mates with 300 and 400 amp plugs. | Black | HBLFRBK | HBLMRBK |
| | White | HBLFRW | HBLMRW |
| | Green | HBLFRGN | HBLMRGN |
| | Red | HBLFRR | HBLMRR |
| | Blue | HBLFRBL | HBLMRBL |
| | Brown | HBLFRBN | HBLMRBN |
| | Orange | HBLFRO | HBLMRO |
| | Yellow | HBLFRY | HBLMRY |
| | Gray | HBLFRGY | HBLMRGY |

Angled Receptacles, Double Set Screw



| Description | Color | Female Receptacles | Male Receptacles |
|--|--------|--------------------|------------------|
| 400 amp Panel Mount, thermoplastic elastomer, cable size #4 - 4/0 AWG, mates with 300 and 400 amp plugs. | Black | HBLFRABK | HBLMRABK |
| | White | HBLFRAW | HBLMRAW |
| | Green | HBLFRASGN | HBLMRAGN |
| | Red | HBLFRAR | HBLMRAR |
| | Blue | HBLFRABL | HBLMRABL |
| | Brown | HBLFRABN | HBLMRABN |
| | Orange | HBLFRAO | HBLMRAO |
| | Yellow | HBLFRAY | HBLMRAY |
| | Gray | — | — |

Receptacles, Bus Bar Mount



| Description | Color | Female Receptacles | Male Receptacles |
|---|--------|--------------------|------------------|
| 400 amp Panel Mount, thermoplastic elastomer, mates with 300 and 400 amp plugs. | Black | HBLFRBBK | HBLMRBBK |
| | White | HBLFRBW | HBLMRBW |
| | Green | HBLFRBGN | HBLMRBGN |
| | Red | HBLFRBR | HBLMRBR |
| | Blue | HBLFRBBL | HBLMRBBL |
| | Brown | HBLFRBBN | HBLMRBBN |
| | Orange | HBLFRBO | HBLMRBO |
| | Yellow | HBLFRBY | HBLMRBY |

Angled Receptacles, Bus Bar Mount



| Description | Color | Female Receptacles | Male Receptacles |
|---|--------|--------------------|------------------|
| 400 amp Panel Mount, thermoplastic elastomer, mates with 300 and 400 amp plugs. | Black | HBLFRABBK | HBLMRABBK |
| | White | HBLFRABW | HBLMRABW |
| | Green | HBLFRABGN | HBLMRABGN |
| | Red | HBLFRABR | HBLMRABR |
| | Blue | HBLFRASBL | HBLMRABBL |
| | Brown | HBLFRABN | HBLMRABN |
| | Orange | HBLFRABO | HBLMRABO |
| | Yellow | HBLFRABY | HBLMRABY |

Receptacles, Offset Bus Bar Mount



| Description | Color | Female Receptacles | Male Receptacles |
|--|--------|--------------------|------------------|
| 400 amp Panel Mount, thermoplastic elastomer, cable size #4 - 4/0 AWG, mates with 300 and 400 amp plugs. | Black | HBLFOSBK | HBLMOSBK |
| | White | HBLFOSW | HBLMOSW |
| | Green | HBLFOSGN | HBLMOSGN |
| | Red | HBLFOSR | HBLMOSR |
| | Blue | HBLFOSBL | HBLMOSBL |
| | Brown | HBLFOSBN | HBLMOSBN |
| | Orange | HBLFOSO | HBLMOSO |
| | Yellow | HBLFOSY | HBLMOSY |

Angled Receptacles, Offset Bus Bar Mount



| Description | Color | Female Receptacles | Male Receptacles |
|---|--------|--------------------|------------------|
| 400 amp Mount, thermoplastic elastomer, mates with 300 and 400 amp plugs. | Black | HBLFOABK | HBLMOABK |
| | White | HBLFOAW | HBLMOAW |
| | Green | HBLFOAGN | HBLMOAGN |
| | Red | HBLFOAR | HBLMOAR |
| | Blue | HBLFOABL | HBLMOABL |
| | Brown | HBLFOABN | HBLMOABN |
| | Orange | HBLFOAO | HBLMOAO |
| | Yellow | HBLFOAY | HBLMOAY |

Single Pole Devices and Temporary Power



Series 16 - 300 and 400 Ampere, 600V AC/250V DC

Enclosure Types
3R, 4X, 12



Tees and 3-Fers

| Color | Tapping Tee (Female-Female-Male) | Paralleling Tee (Female-Male-Male) | 3-Fer (Male-Female- Female-Female) | 3-Fer (Female-Male- Male-Male) | Soft 3-Fer (Male-Female- Female-Female) | Soft 3-Fer (Female- Male-Male-Male) |
|--------|-------------------------------------|---------------------------------------|---------------------------------------|-----------------------------------|--|--|
| Black | HBLTBK | HBLPTBK | HBLM3FBK | HBLF3MBK | HBLM3FSBK | — |
| White | HBLTW | HBLPTW | HBLM3FW | HBLF3MW | — | — |
| Green | HBLTGN | HBLPTGN | HBLM3FGN | HBLF3MGN | — | HBLF3MSGN |
| Red | HBLTR | HBLPTR | HBLM3FR | HBLF3MR | — | — |
| Blue | HBLTBL | HBLPTBL | HBLM3FBL | HBLF3MBL | — | — |
| Brown | HBLTBN | HBLPTBN | HBLM3FBN | HBLF3MBN | — | — |
| Orange | HBLTO | HBLPTO | HBLM3FO | HBLF3MO | — | — |
| Yellow | HBLTY | HBLPTY | HBLM3FY | HBLF3MY | — | — |

Gender Reversing Devices



| Color | Double Male (Male-Male) | Double Female (Female-Female) |
|--------|----------------------------|----------------------------------|
| Black | HBLDMBK | HBLDFBK |
| White | HBLDMW | HBLDFW |
| Green | HBLDMGN | HBLDFGN |
| Red | HBLDMR | HBLDFR |
| Blue | HBLDMBL | HBLDFBL |
| Brown | HBLDMBN | HBLDFBN |
| Orange | HBLDMO | HBLDFO |
| Yellow | HBLDMY | HBLDFY |

Distribution Block (1-Male, 6-Females)



| Color | Catalog Number |
|--------|-----------------|
| Black | HBL7DBBK |
| White | HBL7DBW |
| Green | HBL7DBGN |
| Red | HBL7DBR |
| Blue | HBL7DBBL |
| Brown | HBL7DBBN |
| Orange | HBL7DBO |
| Yellow | HBL7DBY |

Protective Caps



| Color | Fits Female Devices | Fits Male Devices |
|--------|------------------------|----------------------|
| Black | HBLFCAPBK | HBLMCAPBK |
| White | HBLFCAPW | HBLMCAPW |
| Green | HBLFCAPGN | HBLMCAPGN |
| Red | HBLFCAPR | HBLMCAPR |
| Blue | HBLFCAPBL | HBLMCAPBL |
| Brown | HBLFCAPBN | HBLMCAPBN |
| Orange | HBLFCAPO | HBLMCAPO |
| Yellow | HBLFCAPY | HBLMCAPY |

Weather Protective Lift Covers



| Color | Catalog Number | All One Color Caps and Bodies |
|--------|----------------|----------------------------------|
| Clear | — | HBLNCC |
| Black | HBLNCBK | HBLNCABK |
| White | HBLNCW | HBLNCAW |
| Green | HBLNCGN | HBLNCAGN |
| Red | HBLNCR | HBLNCAR |
| Blue | HBLNCBL | HBLNCABL |
| Brown | HBLNCBN | HBLNCABN |
| Orange | HBLNCO | HBLNCAO |
| Yellow | HBLNCY | HBLNCAY |

Single Pole Devices and Temporary Power



Series 16 - 300 and 400 Ampere, 600V AC/250V DC

Enclosure Types
3R, 4X, 12

Replacement Bodies (10 Pack)



| Color | Male Body | Female Body |
|--------|----------------|----------------|
| Black | HBLMBBK | HBLFBBK |
| White | HBLMBW | HBLFBW |
| Green | HBLMBGN | HBLFBGN |
| Red | HBLMBR | HBLFBR |
| Blue | HBLMBBL | HBLFBBL |
| Brown | HBLMBBN | HBLFBBN |
| Orange | HBLMBO | HBLFBO |
| Yellow | HBLMBY | HBLFBY |

Replacement Contacts (20 Pack)



| Description | Male Pin | Female Sleeve |
|------------------|------------------|------------------|
| Contact, 300 amp | HBL300RCM | HBL300RCF |
| Contact, 400 amp | HBL400RCM | HBL400RCF |

Snap Back Covers



| Color | Through Hole Mounting | Threaded Mounting Holes |
|--------|-----------------------|-------------------------|
| Black | HBLSCBK* | HBLSCCBK* |
| White | HBLSCW* | HBLSCCW* |
| Green | HBLSCGN* | HBLSCCGN* |
| Red | HBLSCR* | HBLSCCR* |
| Blue | HBLSCBL* | HBLSCCBL* |
| Brown | HBLSCBN* | HBLSCCBN* |
| Orange | HBLSCO* | HBLSCCO* |
| Yellow | HBLSCY* | HBLSCCY* |

Note: *3R only.

Accessories



| Description | Catalog Number |
|---|----------------|
| Accessory Kit, retaining screw, copper foil, terminal screws and brass wire | HBLPK |
| Replacement retaining screw (500 pack) | HBLRS |
| Copper foil (500 pack) | HBLCF |
| Brass wire (500 pack) | HBLBW |
| Terminal screw - inline (500 pack) | HBLTS |
| Terminal screw - panel mount (500 pack) | HBLTSR |



Series 16 - 300 and 400 Ampere, 600V AC/250V DC

Specifications

| | |
|--------------------------|---|
| Electrical | |
| Voltage Ratings | 600V AC Maximum. 250V DC Maximum. |
| Amperage Rating | 400A Maximum. |
| Mechanical | |
| Terminal Accommodation | Plug- 300A - #6 to 2/0 AWG. Plug- 400A - 2/0 to 4/0 AWG. Recept.- 400A - #4 to 4/0 AWG. |
| Product Identification | Ratings are a permanent part of device. |
| Base Compound | Thermoplastic Elastomer (TPE). |
| Contact Material | Brass. |
| Retaining Screw Material | Nylon. |

Certification / Environmental

UL and cUL Listed.
UL Enclosure Types 3R, 4X, 12.
Flammability: HB per UL94 or CSA 22.2. 0.17.
UL 498 for attachment plugs and receptacles.
UL 1691 draft standard for single pin and sleeve devices intended for theatre, stage and studio applications (Series 16 pending).
National Electric Code (NEC®), ANSI/NFPA 70.

Conductor Ampacity Chart (Type SC/PPC Wire)

| Cable Size | Ampacity* |
|------------|-----------|
| #4 | 140 |
| #2 | 190 |
| 2/0 | 300 |
| 4/0 | 405 |

Note: *90°C column NEC Table 400.5(A)(2).

Dimensions

Series 16 Threaded Stud

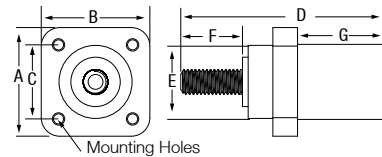

Series 16 Double Set Screw

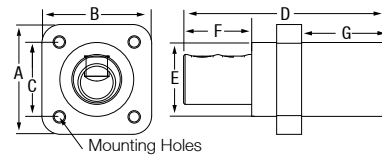

Series 16 Busbar Type

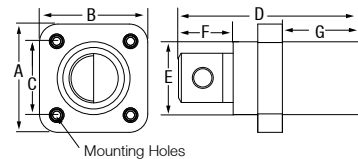

Panel Mount Receptacles

| Threaded Stud | A | B | C | D | E | F | G | Mounting Hole | Termination |
|--|--------------|--------------|--------------|---------------|--------------|--------------|--------------|--------------------|----------------------------------|
| Male & Female w/ through hole mounting | 2.20" (55.9) | 2.20" (55.9) | 1.50" (38.1) | 4.10" (104.3) | 1.48" (47.4) | 1.25" (31.7) | 1.74" (44.2) | Through 4x Ø .20" | 1/2-13 UNC-2A Threaded Stud |
| Male & Female w/ threaded mounting holes | 2.20" (55.9) | 2.20" (55.9) | 1.50" (38.1) | 3.67" (93.2) | 1.48" (47.4) | 1.11" (28.2) | 1.55" (39.4) | Threaded 4x #10-32 | 1/2-13 UNC-2A Threaded Stud |
| Double Set Screw | A | B | C | D | E | F | G | Mounting Hole | Termination |
| Male & Female w/ threaded mounting holes | 2.20" (55.9) | 2.20" (55.9) | 1.50" (38.1) | 4.10" (104.3) | 1.48" (47.4) | 1.36" (34.5) | 1.74" (44.2) | Threaded 4x #10-32 | (2) 7/32 Socket Head Set Screws |
| Busbar Type | A | B | C | D | E | F | G | Mounting Hole | Termination |
| Male & Female w/ threaded mounting holes | 2.20" (55.9) | 2.20" (55.9) | 1.50" (38.1) | 3.57" (90.7) | 1.48" (37.6) | 1.01" (25.7) | 1.55" (39.4) | Threaded 4x #10-32 | (1) 5/16-18 UNC-2B Threaded Hole |

Series 16 Inline Plug Male

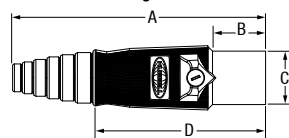

Series 16 Inline Plug Female

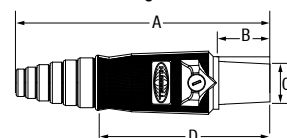

Series 16 Double Male

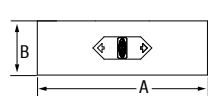

Series 16 Double Female

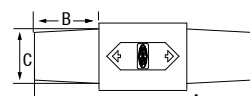

Series 16 Tapping Tee

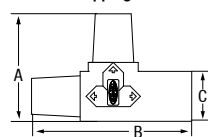

Series 16 Paralleling Tee

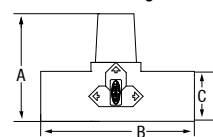

Series 16 3-FER

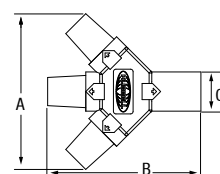

Series 16 Weatherproof Cover

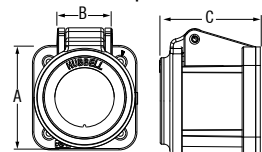

Series 16 Snap Back Cover

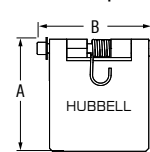

Inline Plugs

| | A | B | C | D |
|--------|---------------|--------------|--------------|---------------|
| Male | 7.01" (178.0) | 1.38" (35.1) | 1.48" (37.6) | 4.78" (121.4) |
| Female | 7.10" (180.5) | 1.44" (36.6) | 1.06" (27.0) | 4.90" (121.3) |

Gender Reversing Devices

| | A | B | C |
|---------------|---------------|--------------|--------------|
| Double Male | 4.65" (118.1) | 1.48" (37.6) | — |
| Double Female | 4.84" (122.9) | 1.44" (36.6) | 1.06" (27.0) |

Tees and 3-Fers

| | A | B | C |
|-----------------|---------------|---------------|--------------|
| Tapping Tee | 3.18" (80.8) | 4.74" (120.4) | 1.48" (37.6) |
| Paralleling Tee | 3.18" (80.8) | 4.65" (118.1) | 1.48" (37.6) |
| 3-Fer | 5.88" (149.3) | 5.78" (146.9) | 1.48" (37.6) |

Covers

| | A | B | C |
|---|---------------|---------------|--------------|
| Weatherproof Cover | 2.20" (55.88) | 1.16" (29.44) | 2.03" (51.5) |
| Snap Back Cover to be used with receptacles | 2.26" (57.4) | 2.37" (60.2) | — |

Dimensions in Inches (mm)

NEC® is a registered trademark of the National Fire Protection Association (NFPA).



Features and Benefits

Spider® II Temporary Power Boxes

Hubbell's Spider® II temporary power distribution system sets the safety and performance standard for temporary power needs. Construction sites and outdoor events place more demands on electrical power than ever before. Hubbell's Spider box steps up to the challenge by offering advanced electrical and safety features. The Spider II box incorporates the most advanced ground fault module technology available in the industry today, ensuring safe and reliable distribution of electrical power for a wide variety of temporary power applications.

Breadth of line and innovation, Hubbell manufactures a variety of Spider II Boxes and temporary power products for both indoor and outdoor power and lighting applications. Hubbell's Spider products incorporate the most innovative wiring devices in the Hubbell Safety-Shroud® Twist-Lock® system. The shrouded Twist-Lock design extends the life of the plug by protecting the blades from abuse and, more importantly, the shroud protects the user from arcing.



SBSB1A



Housing Design

- Individual GFCI modules
- Gasketed latching receptacle lift covers
- Replaceable legs



Assembly

- Compact electronic supervisory circuit
- Detailed wiring diagram
- Six 20 Amp straight blade or Twist-Lock® watertight receptacles



Safety

- Standard stab termination circuit breakers with gasketed lift cover
- All Pin and Sleeve, Twist-Lock and straight blade receptacles on each Spider box are protected when not in use by a gasketed, spring loaded flip lid



Receptacles

- Available with flush 50 Amp Twist-Lock® inlet or 60 Amp IEC reversed service Pin and Sleeve receptacle



Environmental Protection

- Spider II boxes have earned a TYPE 3R metallic enclosure rating and heavy duty, abuse resistant legs for outdoor rainproof applications
- Provides UL Type 4X rating when the receptacles are used with Watertight Safety-Shroud Twist-Lock plugs



Certifications

- Hubbell's Spider II Boxes meet NEC® requirements for personal protection against electrical shock on job sites and are listed to the latest UL1640 standard for portable power distribution equipment

NEC® is a registered trademark of the National Fire Protection Association (NFPA).



50A and 60A Spider® II Boxes



50A Spider® II



60A Spider® II



60A Class "L" Spider® II

Spider® II Temporary Power Boxes

| Rating | Type | Qty | Receptacle Ratings | Receptacle Components | Protection | | Catalog Number |
|----------------------------------|-------------------------|-----|--------------------|-----------------------|------------|-----|----------------|
| | | | | | Overload | GFI | |
| 30A, 120/240V AC (Maximum) | Straight Blade | 7 | 20A, 125V | HBL53R61 | Yes | Yes | SDSB1A |
| | Twist-Lock® (inlet) | 1 | 30A, 120/240V | HBL2715SWR | No | No | |
| | Twist-Lock® (outlet) | 1 | 30A, 120/240V | HBL2710 | No | No | |
| 50A, 120/240V AC (Maximum) | Straight Blade | 7 | 20A, 125V | HBL53R61 | Yes | Yes | SBSB1A |
| | Twist-Lock® (inlet) | 1 | 50A, 125/250V | HBL6375S | No | No | |
| | Twist-Lock® (outlet) | 1 | 50A, 125/250V | CS6369 | No | No | |
| 50A, 120/240V AC (Maximum) | Straight Blade | 6 | 20A, 125V | HBL53R61 | Yes | Yes | SBSB2 |
| | Twist-Lock® | 1 | 30A, 250V | HBL2620SW | Yes | Yes | |
| | Twist-Lock® (inlet) | 1 | 50A, 125/250V | HBL6375S | No | No | |
| | Twist-Lock® (outlet) | 1 | 50A, 125/250V | CS6369 | No | No | |
| 50A, 120/240V AC (Maximum) | Twist-Lock® | 7 | 20A, 125V | HBL2310SW | Yes | Yes | SBTL1A |
| | Twist-Lock® (inlet) | 1 | 50A, 125/250V | HBL6375S | No | No | |
| | Twist-Lock® (outlet) | 1 | 50A, 125/250V | CS6369 | No | No | |
| 50A, 120/240V AC (Maximum) | Twist-Lock® | 6 | 20A, 125V | HBL2310SW | Yes | Yes | SBTL2 |
| | Twist-Lock® | 1 | 30A, 250V | HBL2620SW | Yes | Yes | |
| | Twist-Lock® (inlet) | 1 | 50A, 125/250V | HBL6375S | No | No | |
| | Twist-Lock® (outlet) | 1 | 50A, 125/250V | CS6369 | No | No | |
| 60A, 3Ø 120/208V AC (Maximum) | Straight Blade | 6 | 20A, 125V | HBL53R61 | Yes | Yes | SCSB0* |
| | Pin and Sleeve (inlet) | 1 | 60A, 3ØY 120/208V | HBL560B9R | No | No | |
| | Pin and Sleeve (outlet) | 1 | 60A, 3ØY 120/208V | HBL560R9W | No | No | |
| 60A, 3Ø 120/208V AC (Maximum) | Twist-Lock® | 6 | 20A, 125V | HBL2310SW | Yes | Yes | SCTL0* |
| | Pin and Sleeve (inlet) | 1 | 60A, 3ØY 120/208V | HBL560B9R | No | No | |
| | Pin and Sleeve (outlet) | 1 | 60A, 3ØY 120/208V | HBL560R9W | No | No | |

Class "L" Spider® II Temporary Power Boxes

| Rating | Type | Qty | Receptacle Ratings | Receptacle Components | Protection | | Catalog Number |
|----------------------------------|--------------------|-----|--------------------|-----------------------|------------|-------|----------------|
| | | | | | Overload | GFI | |
| 60A, 3Ø 120/208V AC (Maximum) | Straight Blade | 6 | 20A, 125V | HBL53R61 | Yes | Yes** | SCSB0M2 |
| | Class "L" (inlet) | 1 | 60A, 3ØY, 120/208V | — | No | No | |
| | Class "L" (outlet) | 1 | 60A, 3ØY, 120/208V | — | No | No | |
| 60A, 3Ø 120/208V AC (Maximum) | Twist-Lock® | 6 | 20A, 125V | HBL2310SW | Yes | Yes** | SCTL0M2 |
| | Class "L" (inlet) | 1 | 60A, 3ØY, 120/208V | — | No | No | |
| | Class "L" (outlet) | 1 | 60A, 3ØY, 120/208V | — | No | No | |

Note: *60A units are UL and cUL only.
**GFCI protection on 4 devices only.

Dimensions

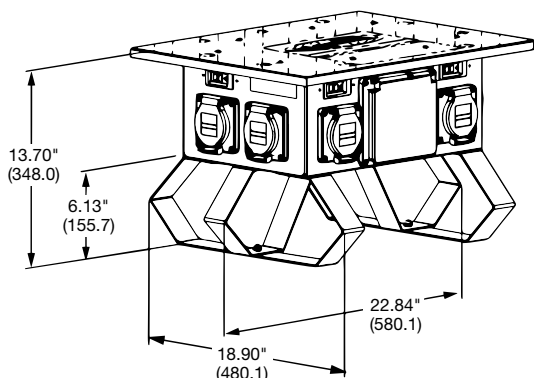

Dimensions in Inches (mm)

Specifications

Spider® II

| | |
|-----------------------|--|
| Listing/Certification | UL 1640 cUL and CSA, UL 943. |
| Environment | Indoor and outdoor wet and dry locations. |
| Enclosure Type | 3R, rainproof, suitable for use in damp locations. |
| Code Compliance | NEC®, ANSI/NFPA 70. |

NEC® is a registered trademark of the National Fire Protection Association (NFPA).



Features and Benefits

Temporary Power Accessories

Hubbell's SR50 is comprised of a pre-wired 50A receptacle, mounted in a fully non-metallic watertight FD wall box.

This weather resistant, UL listed, assembly provides significant labor savings for the contractor, because it's pre-wired with a 50A Twist-Lock® receptacle, installation time is significantly reduced. The 4 hole mounting pattern of the new FD box also provides added security for the device.



Cable Sets and Receptacles

| Description | Catalog Number |
|---|------------------|
| 50A pre-wired wall mounted receptacle, with 2 ft. wire leads. | SR50 |
| 50A cord set - 50 ft. cable (input/output). | SCB50 |
| 50A cord set - 100 ft. cable (input/output). | SCB100 |
| 60A cord set - 6 ft. cable (input/output). | SCC06 |
| 60A cord set - 50 ft. cable (input/output). | SCC50 |
| 60A, 3Ø 120/208V Pin and Sleeve wall mounted receptacle. | HBL560R9W |
| 1¼" hub 15 deg. non-metallic angle back box for 60A receptacle. | BB601W |
| 1½" hub 15 deg. metallic 4-way angle back box for 60A receptacle. | FW60100 |

Note: Consult factory for alternate cable lengths.



Replacement Parts

| Description | Catalog Number |
|--|--------------------|
| 20A, 125V straight blade receptacle. | HBL53R61 |
| 20A, 125V Safety-Shroud Twist-Lock® receptacle. | HBL2310SW |
| 30A, 250V Safety-Shroud Twist-Lock® receptacle. | HBL2620SW |
| 30A, Reverse Service Safety-Shroud connector. | HBL2713SR |
| 30A, Reverse Service inlet. | HBL2715SWR |
| 50A, 125/250V Twist-Lock® receptacle. | CS6369 |
| 50A, 125/250V Twist-Lock® inlet. | HBL6375S |
| 60A, 3Ø 120/208V Pin and Sleeve reversed service receptacle (inlet). | HBL560B9R |
| 60A, 3Ø 120/208V Pin and Sleeve receptacle (outlet). | HBL560R9W |
| 60A, 3Ø 120/208V Pin and Sleeve reversed service plug (female). | HBL560P9WR |
| 60A, 3Ø 120/208V Pin and Sleeve plug (male). | HBL560P9W |
| GFCI module. | GFM20 |
| 50A Spider supervisory kit. | SSK |
| 60A Spider supervisory kit. | SSK60 |
| Spider circuit breaker cover. | SCBC |
| Spider leg kit. | SLK |
| Spider leg kit, green. | SLKG |
| 50A receptacle cover plate. | HBL77CM74WO |





Features and Benefits

Temporary Power Distribution Boxes and Temporary Power Cables

- Durable Hi visibility yellow powder coated steel construction
- Hubbell 50 Amp Twist-Lock® receptacle and inlet
- Six 20 Amp straight blade or Twist-Lock® covered receptacles
- Individual GFCI modules
- NEMA 3R Enclosure
- Save space in the warehouse and on the truck with nesting leg design



TPDL – Twist-Lock®
TPDS – Straight Blade



TPC50 – 50' Cable
TPC100 – 100' Cable

Temporary Power Distribution Boxes

| Rating | Type | Qty | Receptacle Rating | Protection | | Catalog Number |
|----------------------------|----------------------|-----|-------------------|------------|-----|----------------|
| | | | | Overload | GFI | |
| 50A, 120/240V AC (Maximum) | Twist-Lock® | 6 | 20A, 125V | Yes | Yes | TPDL |
| | Twist-Lock® | 1 | 30A, 250V | Yes | No | |
| | Twist-Lock® (Inlet) | 1 | 50A, 125/250V | No | No | |
| | Twist-Lock® (Outlet) | 1 | 50A, 125/250V | No | No | |
| 50A, 120/240V AC (Maximum) | Straight Blade | 6 | 20A, 125V | Yes | Yes | TPDS |
| | Twist-Lock® | 1 | 30A, 250V | Yes | No | |
| | Twist-Lock® (Inlet) | 1 | 50A, 125/250V | No | No | |
| | Twist-Lock® (Outlet) | 1 | 50A, 125/250V | No | No | |

Temporary Power Cables

| Rating | Cable Type | Length | Male Device | Female Device | Weatherproof Boot | Catalog Number |
|---------------|------------|---------|-------------|---------------|-------------------|----------------|
| 50A, 125/250V | 6/3, 8/1 | 50 ft. | CS6365L | CS6364L | No | TPC50 |
| 50A, 125/250V | 6/3, 8/1 | 100 ft. | CS6365L | CS6364L | No | TPC100 |

Specifications

| Boxes | |
|-------------------------|---|
| Listings/Certifications | UL 1640, UL 943 |
| Operation | Indoor and outdoor wet and dry locations |
| Enclosure Type | 3R, rainproof, suitable for use in damp locations |
| Code Compliance | NEC®, ANSI/NFPA 70 |

| Cables | |
|-------------------------|--|
| Listings/Certifications | Connectors: UL/CSA; Cable: MSHA |
| Operation | Indoor and outdoor wet and dry locations |

Dimensions

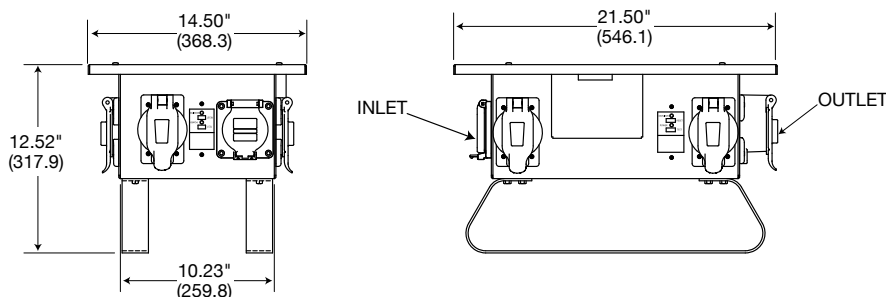

Dimensions in Inches (mm)

NEC® is a registered trademark of the National Fire Protection Association (NFPA).



Heavy-Duty Portable Outlet Boxes and Cover Plates

| Description | Catalog Number |
|---|------------------|
| Box with cord strain relief, with one blank cover plate. | HBLPOB1 |
| Box with cord strain relief, with one blank cover plate, black. | HBLPOB1BK |
| Box with cord strain relief, with two duplex (indoor) cover plates. | HBLPOB1D |
| Box with cord strain relief, with two duplex (indoor), yellow cover plates. | HBLPOB1DY |
| Blank, non-metallic FS cover plate with foam gasket, gray. | HBLP14FS |
| Duplex, non-metallic FS cover plate, gray. | HBLP8FS |
| Duplex, non-metallic FS cover plate, yellow. | HBLP8FSY |
| Single receptacle (1.39"), non-metallic FS cover plate, gray. | HBLP7FS |
| Single receptacle (1.56"), non-metallic FS cover plate, gray. | HBLP720FS |
| Rectangular opening, non-metallic FS cover plate, gray. | HBLP26FS |



HBLPOB1

Other Cover Plates and Devices

which may be used with Heavy-Duty Portable Outlet Boxes

| Description | Catalog Number |
|--|--|
| Duplex cover plate, weatherproof. | HBL5221, HBL52CM21 |
| Single receptacle (1.39") cover plate, weatherproof. | HBL7423WO, HBL74CM23WO |
| Single receptacle (1.56") cover plate, weatherproof. | HBL7425WOA, HBL74CM25WOA |
| Safety-Shroud Twist-Lock® surface receptacles. | HBL2310SR, HBL2320SR, HBL2330SR, HBL2610SR, HBL2620SR |



Cover Plates

Note: Standard product gray, CM yellow.

Deluxe Cord Grips Straight Male Thread Nylon Fittings, Stainless Steel Mesh, Liquidtight, for Insulated Cables

| Grip Diameter Range Inches (cm) | Thread Size NPT (inches) | Form Size | Catalog Number |
|------------------------------------|-----------------------------|--------------|------------------|
| .375"-.500" (.95-1.27) | 3/4" | F3 | 074011335 |
| .500"-.625" (1.27-1.59) | 3/4" | F3 | 074011336 |
| .625"-.750" (1.59-1.90) | 3/4" | F3 | 074011337 |

Gray Nylon Cord Connector Straight Male Thread

| Grip Diameter Range Inches (cm) | Thread Size NPT (inches) | Form Size | Catalog Number |
|------------------------------------|-----------------------------|--------------|------------------|
| .375"-.500" (.95-1.27) | 3/4" | F3 | SHC1035CR |
| .500"-.625" (1.27-1.59) | 3/4" | F3 | SHC1036CR |
| .625"-.750" (1.59-1.90) | 3/4" | F3 | SHC1037CR |



**Deluxe Cord Grips
(purchased separately)**

Specifications for Heavy-Duty Portable Outlet Boxes and Cover Plates

| | |
|-------------------------------------|---|
| UL Listed | UL514C, UL467 and UL50 Enclosures Types 1, 3R. |
| CSA Certified | C22.2 No. 18 and C22.2 No. 94 Enclosures Types 1, 3R and C22.2 No. 0.4 (Impedance). |
| Box Specifications: | |
| Moisture Resistance | Wet and damp locations, Enclosure Type 3R when used with weatherproof cover plates. Dry, indoors locations, Enclosure Type 1 with all other cover plates. |
| Flammability | UL94V-0, 94-5VA classification. |
| Operating Temperature | 80°C maximum; -35°C minimum. |
| UV Resistance | All materials are UV stabilized. |
| Impact and Crush Resistance | in accordance with UL514C, UL50, C22.2 No. 18 and C22.2 No. 94. |
| Material | Valox®. |
| Cord Connector Materials | Nylon nut; Nylon Gotcha® ring; Neoprene grommet. |
| Cord Diameter Range | .38" to .75" diameter. |
| Bonding Strap Material | Brass. |
| Threaded Inserts | Brass. |
| Grounding Screw Material | Brass. |
| Indoor Cover Plate Screws Material | Zinc Plated Steel. |
| Outdoor Cover Plate Screws Material | Stainless Steel. |
| Cover Plate Gasket Material | UL recognized closed-cell foam (aging and oil resistant). |



**Gray Nylon
Cord Connector**

Dimensions

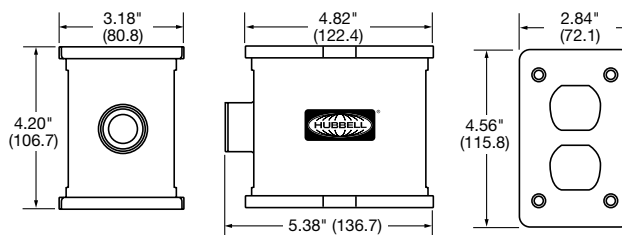

HBLPOB1

Valox® is a trademark of SABIC Innovative Plastics, acquired from General Electric Company.

Dimensions in Inches (mm)



Features and Benefits

Construction Site Lighting

Hubbell's outdoor approved construction site lighting line includes both heavy duty metal halide fixtures and light strings for working in rugged environments. The metal halide fixtures feature extremely strong and compact heads with bulbs rated to last 10,000 hours. All frames are powder-coated yellow for safety and are constructed of a durable 1.25 inch, 12 gauge steel tube.

We have light strings for all applications in a variety of models as well as a choice of metal or plastic guards. Light sockets are spaced 10 feet apart and all sockets, plugs, and connectors are molded for added durability. In addition, the highly impact-resistant material makes for easy transportation and storage when not in use. Bulbs can be incandescent, fluorescent or LED. Consider choosing LED lighting for a durable bulb that saves energy, provides instant illumination and are rated to last 50,000 hours.



HBLMH1000



HBLMH400



HBLLEDH120



HBL182S50LEDH



HBL142SJ100PS



HBLFS2549
Straps not Shown

Metal Halide and LED Lights

| Description | Rating | Watts | Lumen Output | Cord Length | Catalog Number |
|--|----------|-------|--------------|-------------|-------------------|
| 5 -10 ft. metal halide cart light with portable detachable ballast | 15A 125V | 1,000 | 110,000 | — | HBLMH1000 |
| 6 -12 ft. metal halide cart light | 15A 125V | 2,000 | 220,000 | — | HBLMH2000 |
| High bay metal halide light with wire guard | 15A 125V | 400 | 29,000 | 3 ft. | HBLMH400 |
| High bay LED light with wire guard | 15A 125V | 120 | 14,000 | 5 ft. | HBLLEDH120 |

LED Stringer Lights

| Description | No. of Fixtures | Rating | Cord Type | Lumen Output | Cord Length | Catalog Number |
|---|-----------------|----------|--------------|--------------|-------------|----------------------|
| 90 LEDs per fixture, light string with magnetic base included | 1 | 15A 125V | 18/2 SJTW | 450* | 20 ft. | HBL182S20LED |
| 90 LEDs per fixture, light string | 5 | 15A 125V | 18/2 SJTW | 450* | 50 ft. | HBL182S50LED |
| | 10 | 15A 125V | 18/2 SJTW | 450* | 100 ft. | HBL182S100LED |
| 60 LEDs per fixture, light string with magnetic base included | 1 | 15A 125V | 18/2 SJTW | 1,100* | 20 ft. | HBL182S20LEDH |
| | 5 | 15A 125V | 18/2 SJTW | 1,100* | 50 ft. | HBL182S50LEDH |
| 28W High power LED light string with inline ON/OFF switch | — | 15A 125V | 16 AWG SJTOW | 2,928 | 6 ft. | HBLLS2834 |
| Magnetic clip bracket for LED | — | — | — | — | — | HBLSTMC |

Note: *Lumens per fixture.

A Type (Edison) Twist-Lock® and Straight Blade Light Strings

| Description | Max Watts** | Rating | Cord Type | Fixtures | Cord Length | Catalog Number |
|--|-------------|----------|-----------|----------|-------------|----------------------|
| Twist-Lock® light string; plastic guards | 150 | 20A 125V | 12/3 STW | 10 | 100 ft. | HBL123S100PT |
| | 150 | 20A 125V | 12/3 STJW | 10 | 100 ft. | HBL123SJ100PT |
| Twist-Lock® light string; metal guards | 150 | 20A 125V | 12/3 STW | 10 | 100 ft. | HBL123S100MT |
| Straight Blade light string; plastic guards | 150 | 15A 125V | 14/2 STJW | 10 | 100 ft. | HBL142SJ100PS |
| | 150 | 15A 125V | 12/3 STW | 10 | 100 ft. | HBL123S100PS |
| | 150 | 15A 125V | 12/3 STJW | 10 | 100 ft. | HBL123SJ100PS |
| Straight Blade light string; metal guards | 150 | 15A 125V | 12/3 STW | 10 | 100 ft. | HBL123S100MS |
| Straight Blade light string; plastic guards | 150 | 15A 125V | 12/3 STW | 5 | 50 ft. | HBL123S50PS |
| Straight Blade light string; metal guards | 150 | 15A 125V | 12/3 STW | 5 | 50 ft. | HBL123S50MS |
| Replacement plastic guard for temporary light strings | — | — | — | — | — | HBLSTPG |
| Replacement heavy duty metal guard for temporary light strings | — | — | — | — | — | HBLSTMG |

Note: **Max watts per fixture. **HBL142SJ100PS** light strings are rated for 1875 Watts total. The total wattage must be considered when daisy chaining light strings to each other.

Fluorescent Light Strings

| Description | Wattage | Rating | Cord Type | Lumen Output | Cord Length | Catalog Number |
|--|---------|----------|--------------|--------------|-------------|------------------|
| Fluorescent light string, 34.5" single fixture with hanging straps | 50 | 15A 125V | 16 AWG SJTOW | 3,750 | 6 ft. | HBLFS5035 |
| Fluorescent light string, 48.5" single fixture with hanging straps | 25 | 15A 125V | 16 AWG SJTOW | 2,125 | 6 ft. | HBLFS2549 |



LED Maintenance Worklights

| Description | Outlet Rating | Rating | Wattage | Lumen Output | Cord Type | Cord Length | Catalog Number |
|--|---------------|----------|---------|--------------|------------|-------------|--------------------|
| LED Industrial maintenance light, 1 vertical hanging hook included | N/A | 15A 125V | 20 | 2400 | 16/3 SJEOW | 25 ft. | HBLML2825L |
| LED worklight with end light feature | N/A | 15A 125V | 9 | 920/120 | 18/2 SJTOW | 25 ft. | HBLWL25LED |
| LED worklight with end light feature and tool tap | 12 Amp | 15A 125V | 9 | 920/120 | 16/3 SJTOW | 25 ft. | HBLWL25LEDT |



Fluorescent Maintenance Worklights

| Description | Outlet Rating | Rating | Wattage | Lumen Output | Cord Type | Cord Length | Catalog Number |
|---|---------------|----------|---------|--------------|------------|-------------|------------------|
| Fluorescent worklight with straight blade plug | N/A | 15A 125V | 13 | 825 | 16/3 SJTOW | 25 ft. | TW25F1 |
| Fluorescent worklight with Twist-Lock® plug and tool tap | 12 Amp | 20A 125V | 13 | 825 | 16/3 SJTOW | 25 ft. | TW25F2 |
| Fluorescent maintenance light, 34.5 in., one vertical hanging hook included | N/A | 15A 125V | 50 | 3750 | 16/3 SJEOW | 25 ft. | HBLML5025 |
| Fluorescent maintenance light, 48.5 in. | N/A | 15A 125V | 25 | 2125 | 16/3 SJEOW | 25 ft. | HBLML2525 |
| Fluorescent worklight, 45 in., 2 horizontal plastic hangers, 1 attached metal hanging hook included | N/A | 15A 125V | 25 | 2125 | 16/3 SJTOW | 25 ft. | HBLWL2525 |



Accessories and Replacement Items

| Description | Catalog Number |
|--|----------------------|
| Magnetic mounting bracket for ML style lights, 82 lb. capacity | HBLMLMM |
| Magnetic mounting bracket for WL style lights, 58 lb. capacity | HBLWLMM |
| Replacement rough service fluorescent bulb for 13 watt style lamps | HBLREPPFB |
| Metal halide replacement bulb, 400 watts | HBLREP400MH |
| Metal halide replacement bulb, 1,000 watts | HBLREP1000MH |
| Replacement LED panel fixture, 90 LEDs, 450 lumen | HBLREP450LED |
| 5 base LED string only, 50 ft., 18/2 | HBLREP182S50 |
| 10 base LED string only, 100 ft., 18/2 | HBLREP182S100 |



Explosion Proof/Confined Space Lighting

Hazardous Location Lights

| Description | Wattage | Lumen Output | Cord Type | Cord Length | Catalog Number |
|--|---------|--------------|------------|-------------|--------------------|
| Fluorescent, Class 1, Div 1 Groups C & D, Class 2, Div 1 Groups F & G, 12V, inline transformer | 26 | 1800 | 16/3 SOW | 60 ft. | HBLXF6012V |
| Incandescent, Class 1, Div 1, Groups C & D, 12V, inline transformer | 75 | 720 | 16/3 SOW | 60 ft. | HBLXI6012V |
| Fluorescent, Class 1, Div 1 Groups C & D, Class 2, Div 1 Groups F & G, 120V, less plug | 26 | 1800 | 16/3 SOW | 50 ft. | HBLXF50120V |
| Incandescent, Class 1, Div 1 Groups C & D, 120V less plug | 100 | 1230 | 16/3 SOW | 50 ft. | HBLXI50120V |
| Fluorescent, non-explosion proof, wet location, 12V, inline transformer | 13 | 825 | 18/2 SJTOW | 60 ft. | HBLWT6012V |





Pre-Wired Portable Outlet Boxes, Worklights and Accessories



SPB1

Pre-Wired Portable Outlet Boxes

| Description | Catalog Number |
|--|----------------|
| 25 ft. with 2-15A, 125V, straight blade single receptacles and 1-15A, 125V straight blade plug and boot. | SPB1 |
| 25 ft. with 2-20A, 125V, Twist-Lock® single receptacles and 1-20A, 125V Twist-Lock® plug and boot. | SPB2 |



SPB2

Worklights and Accessories

| Description | Catalog Number |
|---|----------------|
| Temporary low voltage worklight with cigarette lighter plug, 20 ft. cord. | TWLV20F |
| Portable battery pack and charger for TWLV20F worklight. | TWBP |
| Non-metallic temporary worklight hook. | TWH |



TWLV20F

Specifications

Temporary Worklights

| | |
|-----------------------|---|
| Listing/Certification | UL298 and cUL Portable Electric Hand Lamps. |
| Environment | Dry, indoor locations. |
| Fluorescent Lamp | 13 watt twin tube only. |

Battery Pack and Charger

| | |
|-----------------------|-----------------------------------|
| Environment | Indoor and outdoor dry locations. |
| Fluorescent Lamp Life | Fully charged-5 hour approx. |
| Charge Time | Fully charged-16 hours approx. |
| Battery Rating | 12 volt. |



TWBP



TWH

Light Fixture

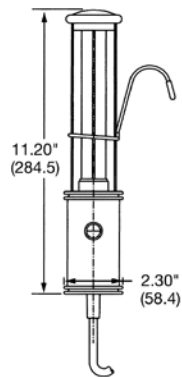

Worklight Hook

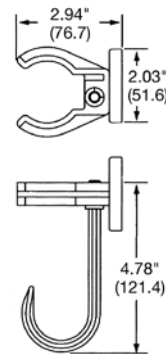

Battery Pack and Charger

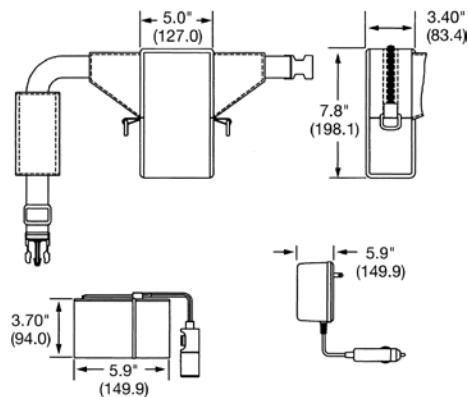

Dimensions in Inches (mm)