



Vibratone® Horns

Model 350

Model 350 Vibratone Horn produces a very loud horn tone by the electro-mechanical vibration of a diaphragm. Capable of reproducing coded blasts or sustained tones through the use of a number of control devices from a push button to a PLC. Federal Signal's Vibratone horn is excellent for general alarm, start and dismissal, coded paging, and process control signaling in areas of high ambient noise levels.

The Vibratone Model 350 is available in AC voltages; 12VAC, 24VAC, 120VAC and 240VAC. This model produces 100dBA @ 10', except for the 12VAC model which produces 94dBA @ 10'.

Vibratone mounting options provide for surface, flush or semi-flush mounting on walls, panels, in cabinets, on 4-inch square outlet boxes, or in concrete and deep wall constructions.

A Double Projector accessory (Model PR2) mounted on the front of the unit directs side sound output, optimizing signaling for long, narrow rooms or corridors.

Vibratone 350 horns are UL and cUL Listed, CSA Certified and FM Approved. They are designed and approved for use in Type 4X applications when installed with the Panel Mount Gasket Kit or Weatherproof Backbox (Model WB). They are approved for Type 4X and Type 12 applications when installed with the Surface Mount Trim Ring

The Vibratone 350 horn is enclosed in a zinc die-cast housing and sealed with grey powder-coat paint and features a stainless steel diaphragm. The rugged construction of the Vibratone horn resists vandalism and the effects of harsh industrial environments.

Compact size, loud output and heavy-duty construction make the 350 horn ideal for industrial and institutional signaling applications.

DESIGNED FOR ROUTINE SIGNALING

- Range of up to 200 feet
- Coded or sustained tones
- Available in – 12, 24, 120 and 240VAC
- Produces 100dBA at 10'
- Type 4X when installed with Panel Mount Gasket Kit or Weatherproof Backbox (Model WB); Type 4X and Type 12 when installed with Surface Mount Trim Ring (Model TR)
- UL and cUL Listed, CSA Certified and FM Approved

Model	Voltage	Operating Current	Decibels @	
			10'	1m
350-012-30	12VAC 50/60Hz	0.90 amps	94	104
350-024-30	24VAC 50/60Hz	0.90 amps	100	110
350-120-30	120VAC 50/60Hz	0.18 amps	100	110
350-240-30	240VAC 50/60Hz	0.09 amps	100	110



VIBRATONE® HORN (350)

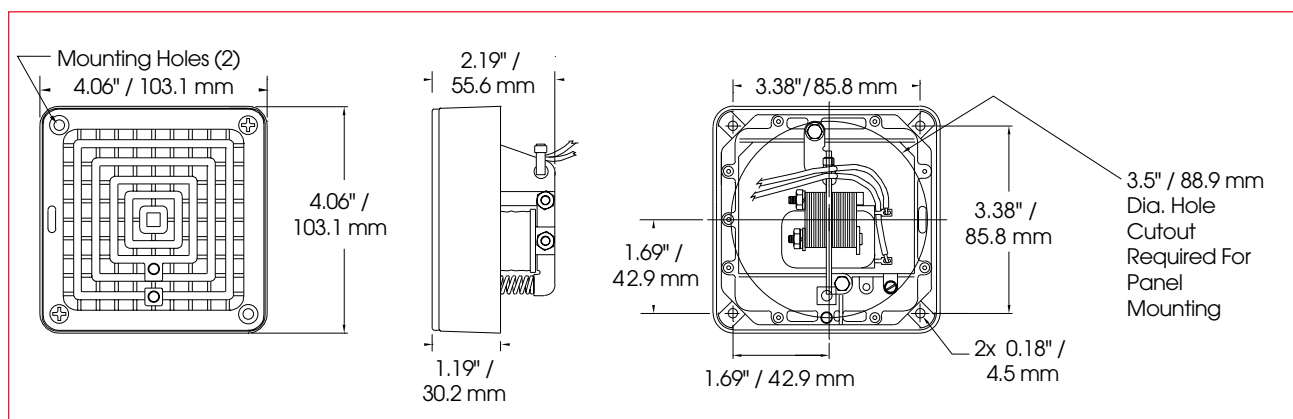

SPECIFICATIONS

Operating Temperature:	-65°F to 150°F	-54°C to 66°C
Net Weight:	1.4 lbs.	0.6 kg
Shipping Weight:	1.5 lbs.	0.7 kg
Height:	4.06"	103.1 mm
Width:	4.06"	103.1 mm
Depth:	2.19"	55.6 mm

HOW TO ORDER

- Specify model and voltage
- Specify accessories from list

ACCESSORIES

FB	Wall box for flush mounting the Vibratone® horn in stud, 4" block, or other shallow wall construction; 4 ³ / ₈ " square box; 2 ⁷ / ₈ " deep; shipping weight 2 lbs. (0.91 kg)
FBL	Same as FB, but 3 ¹³ / ₁₆ " deep for 6" x 8" concrete block, cinder block or other deep wall construction; shipping wt. 3 lbs. (1.36 kg)
FG	Flush grille which attaches to the basic unit and serves as the cover of the plastered-in FB flush box; 6" H x 6" W x 1 ¹ / ₈ " D; shipping wt. 1 lb. (0.45 kg)
K8435666A	Optional Panel Mounting Gasket Kit includes a gasket and hardware for surface or flush mounting the horn for NEMA Type 4X applications.
PR2	Double projector directs sounds to both sides when attached to the basic model units; ideal for use in hallways; 4" H x 11 ¹ / ₂ " W x 4" D; shipping weight 2 lbs. (0.91 kg)
SF	Stamped surface plate used for installations on plastered-in 4" outlet switch boxes for semi-flush mountings; 6" H x 6" W x 1 ¹ / ₂ " D; shipping weight 1 lb. (0.45 kg)
TR	Gasketed trim ring allowing surface mount installations of unit while maintaining Type 12 and Type 4X rating of enclosure.
WB	Cast aluminum neoprene-gasketed weatherproof housing for outside use, complete with mounting lugs; tapped for 1 ¹ / ₂ " , 3 ¹ / ₄ " conduit; 4 ³ / ₈ " square box; 2" deep mounting lugs on 4 ¹ / ₂ " centers; shipping weight 1 lb. (0.45 kg)

REPLACEMENT PARTS

<u>Description</u>	<u>Part Number</u>
Panel Mount Gasket Kit	K8435666A
Volume Control Kit	K8435663B
Coil, 120VAC	KFC1516C