

### Eye Nuts, 776-G Drop-forged Carbon Steel, Normalized

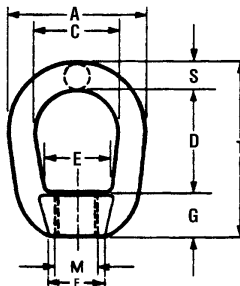

Size No.	A		C		D		E		F		G		S		T	
	in.	mm	in.	mm	in.	mm	in.	mm	in.	mm	in.	mm	in.	mm	in.	mm
1A	1¼	32	¾	19	1⅛	27	19/32	15	½	13	11/32	9	¼	6	121/32	42
2	1⅝	41	1	25	117/64	32	¾	19	9/16	14	15/32	12	5/16	8	23/64	52
3	2	51	1¼	32	1½	38	1	25	13/16	21	19/32	15	3/8	10	215/32	63
3A	2	51	1¼	32	1½	38	1	25	13/16	21	19/32	15	3/8	10	215/32	63
6	3½	89	2	51	29/16	65	1⅝	41	13/8	35	1	25	¾	19	45/16	110
8	4½	114	2½	64	3½	89	2⅛	54	113/16	46	15/16	33	1	25	513/16	148
10	5⅝	143	3⅝	79	41/16	103	2½	64	2¼	57	1½	38	1¼	32	613/16	173



#### ADVERTENCIA

Para prevenir la posibilidad de lesiones graves:

- **NO EXCEDA** el límite de carga de trabajo (WLL).
- **NO LA UTILICE** choque o golpee la carga.
- **NO USE** el accesorio si se ve deformado o desgastado.



#### WARNING

To prevent the possibility of serious bodily injury:

- **DO NOT EXCEED** the working load limit.
- **DO NOT** shock or impact load.
- **DO NOT USE** if the fitting is visibly distorted or worn.