

## For Residential and Commercial Applications

Job Name		Engineer / Architect	
Job Location		Wholesaler	
Submittal Date		Contractor	

### AU2 Male Gas Adapter - Male Flare x Male Iron Pipe

**Use:** For use with natural, manufactured, mixed, liquefied petroleum gases and LP gas-air mixtures.

**Operating Specifications:**

**Temperature:** -40° to 150° F

**Pressure:** Up to 1/2 psi maximum

MATERIAL SPECIFICATIONS	
<b>Brass Fittings</b>	<b>C36000 brass</b>
<b>Steel Fittings</b>	<b>Blue zinc plated 12L14 or 1010 steel</b>

PART DIMENSIONS (Inches)			
Model	DIA. A	DIM. B	DIM. C
AU2-8	0.438	1.81	7/8
AU2-8-6	0.438	1.61	3/4
AU2-6-8	0.312	1.78	7/8
AU2-6	0.312	1.55	11/16

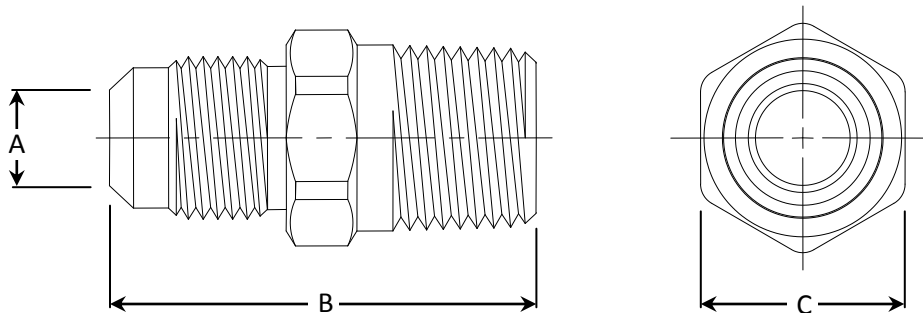

Brass Models



**Part Listing:**

- AU2-6                      3/8" OD Flare x 3/8" M.I.P. (1/8" F.I.P. tapped), brass
- AU2-6 B                    3/8" OD Flare x 3/8" M.I.P. (1/8" F.I.P. tapped), brass, bulk packed
- AU2-6S                    3/8" OD Flare x 3/8" M.I.P. (1/8" F.I.P. tapped), steel
- AU2-6-8                   3/8" OD Flare x 1/2" M.I.P. (3/8" F.I.P. tapped), brass
- AU2-6-8 BT               3/8" OD Flare x 1/2" M.I.P. (3/8" F.I.P. tapped), brass, generic bag
- AU2-6-8S                3/8" OD Flare x 1/2" M.I.P. (3/8" F.I.P. tapped), steel
- AU2-6-8S B              3/8" OD Flare x 1/2" M.I.P. (3/8" F.I.P. tapped), brass, bulk packed
- AU2-8-6                   1/2" OD Flare x 3/8" M.I.P., brass
- AU2-8-6S                1/2" OD Flare x 3/8" M.I.P., steel
- AU2-8-6S B              1/2" OD Flare x 3/8" M.I.P., steel, bulk

*This specification and all information contained herein is the confidential and exclusive property of BrassCraft Manufacturing, and shall not be disclosed to others without the written consent of BrassCraft. This specification must be returned to BrassCraft if requested.*



## AU2 Male Gas Adapter - Male Flare x Male Iron Pipe

**Part Listing (con't):**

<input type="checkbox"/>	AU2-8	1/2" OD Flare x 1/2" M.I.P. (3/8" F.I.P. tapped), brass
<input type="checkbox"/>	AU2-8 B	1/2" OD Flare x 1/2" M.I.P. (3/8" F.I.P. tapped), brass, bulk packed
<input type="checkbox"/>	AU2-8S	1/2" OD Flare x 1/2" M.I.P. (3/8" F.I.P. tapped), steel
<input type="checkbox"/>	AU2-8-12S	1/2" OD Flare x 3/4" M.I.P. (1/2" F.I.P. tapped), steel
<input type="checkbox"/>	AU2-14-12	7/8" OD Flare x 3/4" M.I.P. (1/2" F.I.P. tapped), brass
<input type="checkbox"/>	AU2-14-16	7/8" OD Flare x 1" M.I.P. (3/4" F.I.P. tapped), brass

**Listings & Certifications:**

- For use with CSA listed ANSI Z21.24 / CSA 6.10 connectors
- For use with CSA listed ANSI Z21.75 / CSA 6.27 connectors



*This specification and all information contained herein is the confidential and exclusive property of BrassCraft Manufacturing, and shall not be disclosed to others without the written consent of BrassCraft. This specification must be returned to BrassCraft if requested.*

**BrassCraft®**