

C-Taps



Cat. No.	Main	Tap	Dimensions in. (mm)		Dies for TBM14M, 13100A or TBM15I*	Crimps
			H	L		
CTP22	#6 Sol.-#2 Str.	#6 Sol.-#2 Str.**	1.16 (29.5)	0.75 (19.1)	HBKC	1
CTP202	#1 Str.-2/0 Str.		1.41 (35.8)			
CTP2020	#1 Str.-2/0 Str.	#1 Str.-2/0 Str.	1.54 (39.1)			
CTP25020	3/0 Str.-250 kcmil	#6 Sol.-2/0 AWG**	1.97 (50.0)		15G86R	
CTP250250		3/0 Str.-250 kcmil	2.06 (52.3)			
CTP50020	300-500 kcmil	#6 Sol.-2/0 AWG**	2.42 (61.5)	0.88 (22.4)	15G121R	2
CTP500250		3/0 Str.-250 kcmil	2.67 (67.8)			
CTP500500†		300-500 kcmil	2.91 (73.9)			1.10 (27.9)

* Cat. No. 15500 adaptor required if using TBM15I and 155XX series Dies.
 ** #6 AWG branch must be doubled.
 † Must use TBM15I tool
 Material: High-Conductivity Copper.

Copper C-Crimps Wire Combinations**

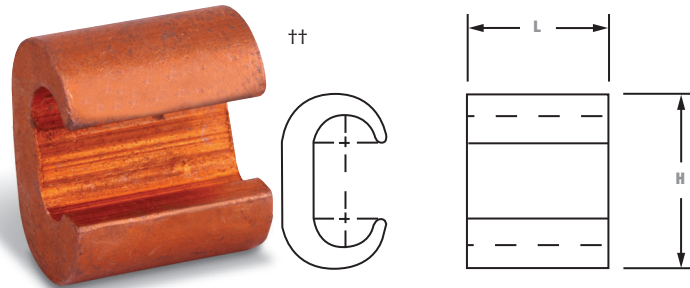
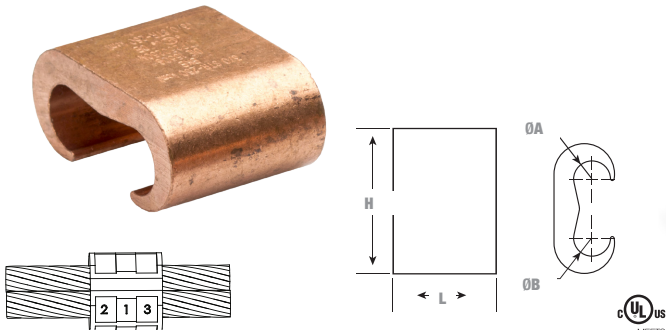

Figure 1 – Requires 3 crimps



Cat. No.	Ø A Cable	Ø B Cable	H (in.)	L (in.)	Crimps	Dies for Tools
CTP250250N	3/0 str.- 250 kcmil	3/0 str.- 250 kcmil	2-1/16	1-1/2	3	15506SS
CTP25020N	3/0 str.- 250 kcmil	#1 str. - 2/0 str.	1-31/32	1-1/2	3	15506SS
CTP2020N	#1 str.- 2/0 str.	#1 str. - 2/0 str.	1-9/16	1-1/2	3	15517SS
CTP202N	#1 str.- 2/0 str.	#6 sol. - #2 str.	1-13/32	1-1/2	3	15517SS
CTP22N	#6 sol.- #2 str.	#6 sol. - #2 str.	1-5/32	1-1/2	3	15514SS

All parts ending by the letter N are IEEE837-2014 compliant.
 Use hydraulic tool 13100A, TBM14M TBM14CR-LI, TBM15CR-LI, TBM15, or TBM15I with die indicated in chart.
 Must use TBM15, TBM15CR-LI, or TBM15I tool only. (See Figure 1)

Cat. No.	Run	Tap	Die Index	Manual Tool OD Series	Installing Die 14- and 15-Ton Tools	Dimensions in. (mm)	
						L	H
BC48	6 Sol.-4 Str.	8 Sol.-8 Str.	BG or 5/8	BY31	B58CS	0.64 (16.3)	0.56 (14.2)
BC46-BB		6 Sol.-6 Str.					0.75 (19.1)
BC44		4 Sol.-4 Str.					0.80 (20.3)
BC24	2 Sol.-2 Str.	8 Sol.-4 Str.	C	BY33	HBKC	0.75 (19.1)	0.98 (24.9)
BC22		2 Sol.-2 Str.					1.05 (26.7)
BC202	1/0 Sol.-2/0 Str.	8 Sol.-2 Str.	E or O	-	HO	0.94 (23.9)	1.31 (33.3)
BC2020-BB		1/0 Str.-2/0 Str.					1.34 (34.0)
BC402		3/0 Str.-4/0 Str.					6 Sol.-2 Str.
BC4020	1/0 Sol.-2/0 Str.						
BC4040	3/0 Sol.-4/0 Str.						

**Do not meet IEEE 837.

C-Taps

Small Size

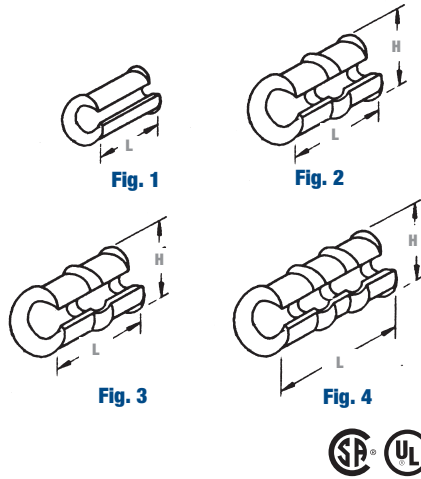
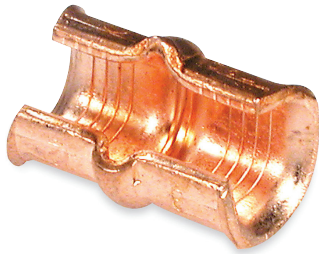

Large Size for Certified to 600 V

- More economical than other taps and split bolts in terms of purchase, inventory, installation time, insulation and maintenance.
- Color-coded for easy matching with proper die
- Barely larger than conductor insulation once installed

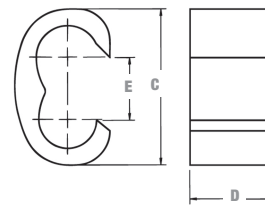

Material: High-Conductivity Wrought Copper
Finish: Plain



Cat. No.	Code Wire Comb. Cir. Area Range		Die		Group 2	Group 3	Insulation Choice		Dimensions in. (mm)		Colour Code			
	Main	Branch	Group 1	Smart™ Tools			Adhesive	Shrink Tubing	L	H				
54705	12	14	6TON21SS	TBM6221	Accommodates this range	↑	HS12-6		0.31	0.31	Red			
	14	16							(7.9)	(7.9)	Blue			
54710	10	10	6TON24SS	TBM6224					↓	HS12-6			0.56	0.44
	8	12									(14.2)		(11.2)	
54715	6	10, 12	6TON29SS	TBM6229					↓	HS12-6		0.56	0.63	Grey
	8	8										(14.2)	(16.0)	
54720	4 or 5	8, 10, 12	6TON33SS	TBM6233			↓	HS12-6		1.16	0.69	Brown		
	6	6, 8								(29.5)	(17.5)			
54725	3	6, 8, 10, 12***	6TON37SS	TBM6237			↓	HS12-6		1.16	0.81	Green		
	4 or 5	6, 5								(29.5)	(20.6)			
54730	2	6, 8, 10, 12	6TON42SS	TBM6242			↓	HS6-1		1.16	0.84	Pink		
	3	5								(29.5)	(21.3)			
	4	3												
54735	1	4, 5, 6, 8, 10, 12	6TON45SS	TBM6245	↓	HS6-1		0.06	0.88	Black				
	2	4, 5						(1.5)	(22.4)					
	3	3, 4												
54740	1/0	4, 5, 6, 8, 10, 12	6TON50SS	TBM6250	↓	HS6-1		1.69	0.97	Orange				
	1	3, 4						(42.9)	(24.6)					
	2	2, 3												
54745	2/0	3, 4, 5, 6, 8, 10, 12	6TON54SS	TBM6254	↓	HS4-30		1.69	1.06	Purple				
	1/0	2, 3						(42.9)	(26.9)					
54750	3/0	2, 3, 4, 5, 6, 8, 10, 12	6TON62SS	TBM6262	↓	HS4-30		1.69	1.19	Yellow				
	2/0	1, 2						(42.9)	(30.2)					
	1/0	1/0, 1												

Cat. No.	Wire Size		Dimensions in. (mm)			Installing Die		Die Code	No. of Crimps	Colour Code
	Main	Branch	C	D	E	Tool	Cat. No.			
54755	#1	#1	1.93 (49.0)	0.75 (19.1)	0.53 (13.5)	TBM14M TBM15I TBM12 13100A	15512SS 15512SS* TBM12D-4 15512SS	76 76 76 76	1	Blue
	1/0	2/0-#3								
	2/0	1/0-#6								
	3/0	#1-#8								
	4/0									
54760	2/0	2/0-#1	1.43 (36.3)	0.75 (19.1)	0.59 (15.0)	TBM14M TBM15I TBM12 13100A	15506SS 15506SS* TBM12D-3 15506SS	87H 87H 87H 87H	2	Brown
	3/0	3/0-#3								
	4/0	4/0-#4								
	250 kcmil	#1-#8								
54765	2/0	2/0-#1	1.68 (42.7)	1.00 (25.4)	0.64 (16.3)	TBM14M TBM15I TBM12 13100A	15505SS 15505SS* TBM12D-2 15505SS	99H 99H 99H 99H	2	Pink
	3/0	3/0-#2								
	4/0	4/0-#4								
	250 kcmil	3/0-#6								
54770	4/0	4/0-2/0	1.68 (42.7)	1.00 (25.4)	0.68 (17.3)	TBM14M TBM15I TBM12 13100A	15515SS 15515SS* TBM12D-2 15515SS	106H 106H 106H 106H	2	Black
	250 kcmil	250-#1								
	300 kcmil	4/0-#4								
54775**	250 kcmil	250 kcmil	1.88 (47.6)	1.25 (31.8)	0.81 (20.6)	TBM14M TBM15I TBM12 13100A	15504SS 15504SS* TBM12D-1 15504SS	115H 115H 115H 115H	2	Yellow
	300 kcmil	300-3/0								
	350 kcmil	350-1/0								
	400 kcmil	300-#2								
	450 kcmil	250-#4								
500 kcmil	250-#6									
54780	350 kcmil	350-4/0	2.18 (55.4)	1.25 (31.8)	0.82 (20.08)	TBM15I	15603	125H	2	N/A
	400 kcmil	400-2/0								
	450 kcmil	450-#1								
54785	450 kcmil	450-#1	2.12 (53.8)	2.00 (50.8)	1.00 (25.4)	TBM15I	15603	125H	3	N/A
	500 kcmil	500-#2								
54790	750 kcmil	4/0-#6	2.68 (68.1)	2.00 (50.8)	1.31 (33.3)	TBM15I	15603	125H	3	N/A
	750 kcmil	750-4/0								

*** When using 3 AWG on main and 12 AWG on branch with Smart™ Tools and dies, 12 AWG wire must be doubled (hair-pinned) and placed on branch for crimping.
Group 1 = TBM6H, TBM62PCR-LI, TBM62CR-LI, TBM6UNICR-LI.
Group 2 = TBM25S, TBM21E (require 2 compressions within each crimp area).
Group 3 = TBM4/4S, TBM5/5S, TBM6/6S, TBM8/8S, TBM6H (require 1 compression within each crimp area).

UL approved for direct burial.
For covers see Section B.
Taps can be supplied tin-plated. Add suffix "TP" to any Cat. No. (i.e. 54725TP).
* Cat. No. 15500TB adaptor required if using TBM15I and 155xx series dies.
** #6 AWG branch must be doubled.
Tooling and Die Selector Chart see Section E.