

For Residential and Commercial Applications

Job Name _____

Contractor _____

Job Location _____

Approval _____

Engineer _____

Contractor's P.O. No. _____

Approval _____

Representative _____

LEAD FREE*

Series 35 Quick-Connect Connectors

Watts Quick-Connect Connectors are designed and manufactured for many years of trouble free service. Produced of off white Polysulfone, a high performance thermal plastic material, the Watts Quick-Connect design allows for quick and easy connections without the use of installation tools.

Specifications

Connection shall be made using Watts Quick-Connect Series 35 fitting with Integral Collet and O-Ring guide. Fitting shall be able to fully rotate under pressure and allow for easy disconnect and reuse without the use of disconnection tools. Fitting must not disassemble to disconnect.

Approvals

NSF-61, NSF-14, CSA B137.5, ASTM F877, UPC, ASSE 1061

Ratings

100psi @ 180°F (6.8 bar @ 82°C)

250psi @ 75°F (17.3 bar @ 24°C)

Example

3501-0806

35 = Series 35 01 = Type 01 Male Connector

0806 = $\frac{3}{8}$ "CTS x $\frac{3}{8}$ "NPT

***The wetted surface of this product contacted by consumable water contains less than one quarter of one percent (0.25%) of lead by weight.**

Caution: The polysulfone material used in the Quick-Connect fittings can be compromised by exposure to volatile organic compounds (VOC's) and caustic chemicals. Therefore, **DO NOT** expose this product to any such substance, which would include exposure to the following products: **Pipe Dopes (thread sealants)**, bug sprays, lubricants, cleaners, paints, bleaches, acids, solder fluxes, plastic piping primers and cements, oxidizing agents, alkaline solutions, thinners, fuels, oil based caulks, hydrocarbons, spray foam or foaming agents (insulation).

It is also recommended that all threaded connections be made with Teflon® tape only.



3501



3510



3511



3513



3514



3515

Watts product specifications in U.S. customary units and metric are approximate and are provided for reference only. For precise measurements, please contact Watts Technical Service. Watts reserves the right to change or modify product design, construction, specifications, or materials without prior notice and without incurring any obligation to make such changes and modifications on Watts products previously or subsequently sold.

WATTS®

Dimensions – Weights – Weight and Dimensions are approximate (tolerance +/- 1/8)

Type 01 Male Connectors

MODEL	SIZE & CONNECTION	ITEM LENGTH		ITEM HEIGHT		ITEM WEIGHT	
		in.	mm	in.	mm	oz.	gr.
Package Type: Bulk							
3501-0806	3/8" CTS x 3/8" NPT	1 3/4	44	1	25	0.32	9.07
3501-1006	1/2" CTS x 3/8" NPT	2	51	1 1/8	29	0.48	13.61
3501-0808	3/8" CTS x 1/2" NPT	2	51	1 5/16	24	0.4	11.34
3501-1008	1/2" CTS x 1/2" NPT	2	51	1 1/8	29	0.6	17.01
3501-1012	1/2" CTS x 3/4" NPT	2 1/8	54	1 1/8	29	0.7	19.85
3501-1014	1/2" CTS x 3/4" MGHT	2 1/8	54	1 1/8	29	0.7	19.85
3501-1412	3/4" CTS x 3/4" NPT	2 1/2	64	1 3/8	35	1.1	31.19
3501-1816	1" CTS x 1" NPT	3	76	1 3/4	45	1.63	46.21
Package Type: Poly Bag							
3501B-0806	3/8" CTS x 3/8" NPT	1 3/4	44	1	25	0.32	9.07
3501B-1006	1/2" CTS x 3/8" NPT	2	51	1 1/8	29	0.48	13.61
3501B-0808	3/8" CTS x 1/2" NPT	2	51	1 5/16	24	0.4	11.34
3501B-1008	1/2" CTS x 1/2" NPT	2	51	1 1/8	29	0.6	17.01
3501B-1012	1/2" CTS x 3/4" NPT	2 1/8	54	1 1/8	29	0.7	19.85
3501B-1014	1/2" CTS x 3/4" MGHT	2 1/8	54	1 1/8	29	0.7	19.85
3501B-1412	3/4" CTS x 3/4" NPT	2 1/2	64	1 3/8	35	1.1	31.19
3501B-1816	1" CTS x 1" NPT	3	76	1 3/4	45	1.63	46.21

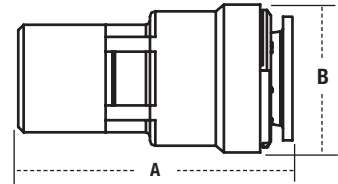

Type 10 Female Connectors

MODEL	SIZE & CONNECTION	ITEM LENGTH		ITEM HEIGHT		ITEM WEIGHT	
		in.	mm	in.	mm	oz.	gr.
Package Type: Bulk							
3510-0808	3/8" CTS x 1/2" NPS	1 7/8	48	1 1/4	32	0.6	17.01
3510-1008	1/2" CTS x 1/2" NPS	2 1/8	54	1 1/8	29	0.7	19.85
3510-1012	1/2" CTS x 3/4" NPS	2 3/16	56	1 5/16	33	1	28.35
3510-1013	1/2" CTS x 3/4" Closet	2 5/16	59	1 5/8	41	0.9	25.52
3510-1014	1/2" CTS x 3/4" FGHT	2 1/8	54	1 5/16	33	1.2	34.02
3510-1412	3/4" CTS x 3/4" NPS	2 5/16	59	1 3/8	35	1.2	34.02
3510-1816	1" CTS x 1" NPS	2 1/4	57	1 3/4	45	1.7	48.19
Package Type: Poly Bag							
3510B-0808	3/8" CTS x 1/2" NPS	1 7/8	48	1 1/4	32	0.6	17.01
3510B-1008	1/2" CTS x 1/2" NPS	2 1/8	54	1 1/8	29	0.7	19.85
3510B-1012	1/2" CTS x 3/4" NPS	2 3/16	56	1 5/16	33	1	28.35
3510B-1013	1/2" CTS x 3/4" Closet	2 5/16	59	1 5/8	41	0.9	25.52
3510B-1014	1/2" CTS x 3/4" FGHT	2 1/8	54	1 5/16	33	1.2	34.02
3510B-1412	3/4" CTS x 3/4" NPS	2 5/16	59	1 3/8	35	1.2	34.02
3510B-1816	1" CTS x 1" NPS	2 1/4	57	1 3/4	45	1.7	48.19

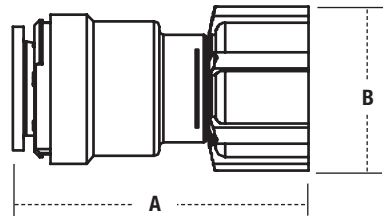

Type 11 Stackable Hose Barb Unions

MODEL	SIZE & CONNECTION	ITEM LENGTH		ITEM HEIGHT		ITEM WEIGHT	
		in.	mm	in.	mm	oz.	gr.
Package Type: Bulk							
3511-1008	1/2" CTS x 1/2" Barb	2 5/16	59	.7	18	0.3	8.51
Package Type: Poly Bag							
3511B-1008	1/2" CTS x 1/2" Barb	2 5/16	59	.7	18	0.3	8.51

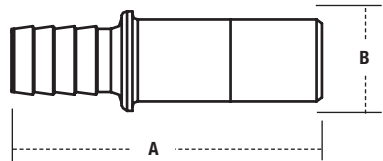

Type 13 Hose Barb Fittings

MODEL	SIZE & CONNECTION	ITEM LENGTH		ITEM HEIGHT		ITEM WEIGHT	
		in.	mm	in.	mm	oz.	gr.
Package Type: Bulk							
3513-1008	1/2" CTS x 1/2" Barb	2 5/16	59	1 1/8	29	0.6	17.01
3513-1412	3/4" CTS x 3/4" Barb	2 1/2	64	1 1/2	38	1	28.35
3513-1816	1" CTS x 1" Barb	3	76	1 3/4	45	1.3	36.85
Package Type: Poly Bag							
3513B-1008	1/2" CTS x 1/2" Barb	2 5/16	59	1 1/8	29	0.6	17.01
3513B-1412	3/4" CTS x 3/4" Barb	2 1/2	64	1 1/2	38	1	28.35
3513B-1816	1" CTS x 1" Barb	3	76	1 3/4	45	1.3	36.85

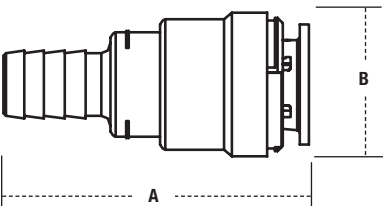

Type 14 Reducing Stems

MODEL	SIZE & CONNECTION	ITEM LENGTH		ITEM HEIGHT		ITEM WEIGHT	
		in.	mm	in.	mm	oz.	gr.
Package Type: Bulk							
3514-1008	1/2" CTS x 3/8" CTS	2 1/2	64	15/16	24	0.5	14.18
3514-1410	3/4" CTS x 1/2" CTS	2 13/16	71	1 1/8	29	0.6	17.01
3514-1810	1" CTS x 1/2" CTS	2 3/4	70	1 3/16	30	0.8	22.68
3514-1814	1" CTS x 3/4" CTS	2 3/4	70	1 1/2	38	1.1	31.19
Package Type: Poly Bag							
3514B-1008	1/2" CTS x 3/8" CTS	2 1/2	64	15/16	24	0.5	14.18
3514B-1410	3/4" CTS x 1/2" CTS	2 13/16	71	1 1/8	29	0.6	17.01
3514B-1810	1" CTS x 1/2" CTS	2 3/4	70	1 3/16	30	0.8	22.68
3514B-1814	1" CTS x 3/4" CTS	2 3/4	70	1 1/2	38	1.1	31.19

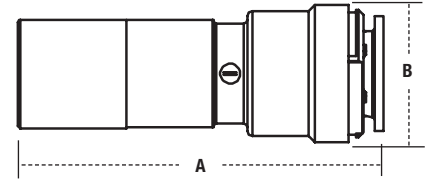

Type 15 Union Connectors

MODEL	SIZE & CONNECTION	ITEM LENGTH		ITEM HEIGHT		ITEM WEIGHT	
		in.	mm	in.	mm	oz.	gr.
Package Type: Bulk							
3515-08	3/8" CTS	2 1/4	51	15/16	24	0.5	14.18
3515-10	1/2" CTS	2 11/16	68	1 1/8	29	0.8	22.68
3515-14	3/4" CTS	3 1/8	79	1 3/8	35	1.5	42.52
3515-18	1" CTS	3	76	1 1/2	38	2.4	68.04
Package Type: Poly Bag							
3515B-08	3/8" CTS	2 1/4	57	15/16	24	0.5	14.18
3515B-10	1/2" CTS	2 11/16	68	1 1/8	29	0.8	22.68
3515B-14	3/4" CTS	3 1/8	79	1 3/8	35	1.5	42.52
3515B-18	1" CTS	3	76	1 1/2	38	2.4	68.04

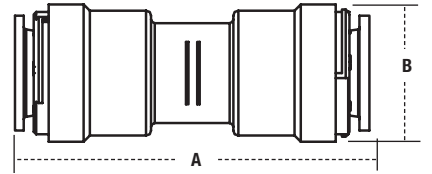

Type 15R Reducing Union Connectors

MODEL	SIZE & CONNECTION	ITEM LENGTH		ITEM HEIGHT		ITEM WEIGHT	
		in.	mm	in.	mm	oz.	gr.
Package Type: Bulk							
3515R-1004	1/2" CTS x 1/4" OD	2 13/16	71	1 1/8	29	0.8	22.68
3515R-1008	1/2" CTS x 3/8" CTS	2 1/2	64	1 1/8	29	0.7	19.85
3515R-1410	3/4" CTS x 1/2" CTS	3	76	1 1/2	38	1.2	34.02
3515R-1814	1" CTS x 3/4" CTS	3 1/4	83	1 1/2	38	2	56.70
Package Type: Poly Bag							
3515RB-1004	1/2" CTS x 1/4" OD	2 13/16	71	1 1/8	29	0.8	22.68
3515RB-1008	1/2" CTS x 3/8" CTS	2 1/2	64	1 1/8	29	0.7	19.85
3515RB-1410	3/4" CTS x 1/2" CTS	3	76	1 1/2	38	1.2	34.02
3515RB-1814	1" CTS x 3/4" CTS	3 1/4	83	1 1/2	38	2	56.70

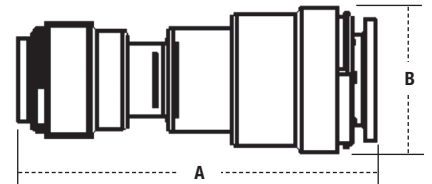



A Watts Water Technologies Company

