



BULB CHANGER INSTRUCTIONS

TO REMOVE BULB

- Turn power off.
- Slowly press the Bulb Changer onto light bulb until the rubber fingers grip the bulb.
- Unscrew and remove.

TO REPLACE BULB

- Insert new bulb into Bulb Changer.
- Screw bulb into ceiling outlet.
- Pull gripping fingers away from the bulb.

TO CONNECT BULB CHANGER TO POLE

- Insert end into Tele-pole tube and align locking tabs with holes.

TO ADJUST BULB CHANGER FINGERS

- Gently bend inward or outward to fit different sized bulbs.

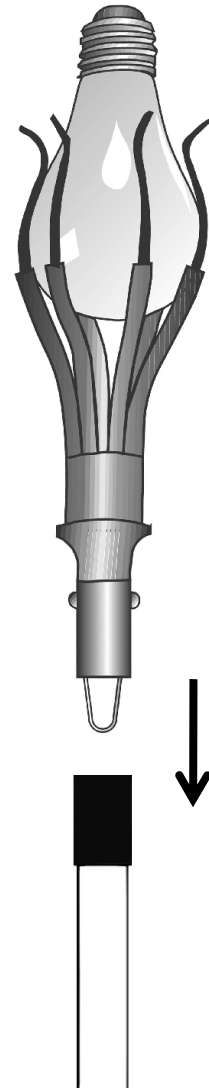

Works on standard and compact fluorescent light bulbs