



EZSAND[®] Polymeric Sand for paver joints



UPDATE

February 16, 2021

Make sure that you have an up-to-date technical data sheet in hand by consulting our website: techniseal.com
U.S.A. and Canada: dial 1 866 725-7383

APPLICATIONS

- General use
- For interlocking pavers
- Residential installations: driveways, walkways, patios, etc.

PROPERTIES

- Reduces Weed Growth
- Resists Joint Washout
- Resists Insect Penetration

DESCRIPTION

EZSAND[®] is a state-of-the-art mix of graded sand and binder that flows smoothly down joints for a fast and effective installation of concrete pavers on surfaces exposed to normal traffic. It is specially formulated for residential projects such as walkways, patios and driveways with regular joints. Easy to use, **EZSAND**[®] offers great resistance to weed growth, insect invasion and erosion.

MINIMUM JOINT WIDTH: 3 mm (1/8")
MAXIMUM JOINT WIDTH: 13 mm (1/2 ")
MINIMUM JOINT DEPTH: 4 cm (1.5")

DRYING: Ideally 24 hours before being exposed to water (rain).
DOWNTIME: Pedestrians: none – Vehicles: 24 to 48 Hours

Necessary Tools:

- Street broom with semi-rigid bristles
- Plate compactor (or rubber mallet if plate compactor is not available)
- Leaf blower
- Spray nozzle and garden hose

COMPACTION INFORMATION:

Mechanical compaction is **MANDATORY** when using **EZSAND®** Polymeric Sand. Failure to do so may compromise joint integrity and performance.

Plate compactor such as Multiquip's Mikasa MVB series, Wacker Neuson's VP and WP series, Toro's FP series are examples of models that can be used to ensure proper mechanical compaction. Use of a teflon coated plate or paving pad is important to help protect the surface.

Plate compactor – Ideally, the plate compactor should have a maximum centrifugal force of 25 kN (5,000 lbf) and a frequency between 80 and 100 Hz. The weight of the plate compactor should not exceed 100 kg (220 lb). A smaller machine can be used for repair work and joint replacement.

BEFORE YOU BEGIN!

Before proceeding with the installation, make sure to consult the technical data sheet available at techniseal.com for detailed instructions.

Installation Conditions: Bedding must be made of dense graded sand. Install over a drainage base and bed (sand-set).

- Temperature must be above 32°F (0°C) for 48 hours following installation.
- Surface and joints must be dry. If the pavers are damp the polymer will leave a stain on the pavers.
- Sprinkler system must be turned off.
- It is recommended to plan for 24 hours without rain in order to obtain optimal performances.
- Product may take up to 72 hours to harden. Set time depends on weather, moisture, width and depth of joint.
- Product must be tested on a small area to ensure that texture and color meet expectations.

IMPORTANT:

- Wear appropriate safety gears.
- Do not mix product with cement, sand or any other material.
- Plate compactor will give optimal results over use of a rubber mallet.
- Joints become soft when humid but become hard again when dry.
- Bedding layer needs to be able to drain properly in order to allow for the **EZSAND®** Jointing Sand to dry properly. Certain type of bedding or screening materials may not drain properly which will trap moisture and may cause issues.
- The hardscape products should be installed following the manufacturer's recommendation.
- Because product comes from a natural source, colour and grain size may vary.
- Failure to have recessed joint could lead to premature joint degradation.
- **If the application procedure is not followed properly, a light haze may be left on the surface**, which can be easily removed with the appropriate Techniseal cleaner. To avoid this unnecessary secondary step, please follow these instructions precisely.
- Do not sweep product over asphalt.
- This product starts repelling water a few minutes after initial wetting. Make sure to complete each section per detailed installation instructions before moving to the next one.
- Wet no more than 20 m² (200 sq ft.) of surface at a time.
- Not for use on submerged or constantly wet surfaces.
- The use of cleaning devices (high pressure washer, etc.) is restricted during the first 30 days. It should be noted that too direct and violent jets can create alterations, so it is best to consult the machine manufacturers in order to use the specific accessories with soft jets.
- Ensure that joint has hardened before cleaning and sealing the surface. Depending on climate and type of installation, typical recommended wait time is a minimum of 30 days.
- Proper maintenance is paramount to maintaining joints in optimal condition. Excessive moisture, shade, inadequate cleaning and maintenance, presence of soil and organic matters (including grass trimmings) left on the joints may contribute to growth of moss, mold or mildew and a premature deterioration of the jointing product.

INSTALLATION

IMPORTANT: Do not use this product as capping sand.

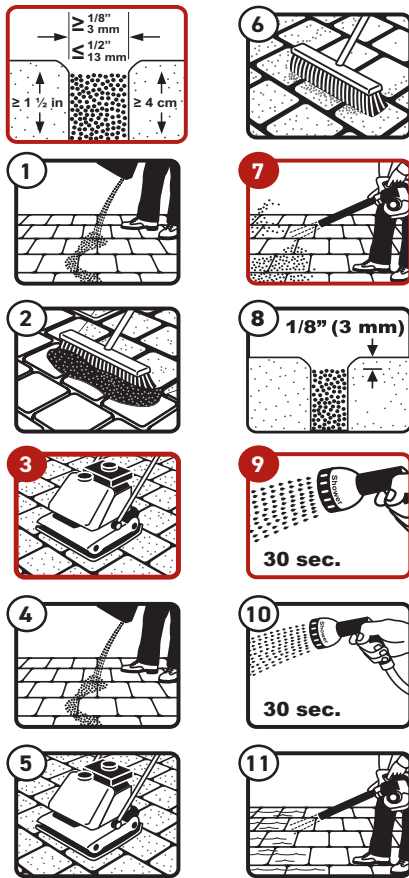

1. Spread product evenly on a small surface.
2. Using the street broom, fill joints completely - Sweep sand over short distances.
3. Pass the plate compactor over the entire surface to compact the sand.
4. Spread more product to fill joints again.
5. Pass a plate compactor over the entire surface a second time.
6. Remove excess sand from the surface with the broom.
7. Remove all sand residue with the leaf blower.
8. Sand level must be at least 1/8" (3 mm) below top of pavers or at bottom of chamfer.
9. Starting from bottom of the slope, shower a 200 sq. ft. section for 30 seconds.
10. Wait a few seconds and wet the same section again for another 30 seconds or until joints are saturated (water can no more penetrate the sand). Avoid run-off and foaming. Check for water accumulation at the surface of the jointing sand as a cue to stop watering. Wait until there is no free water at the surface of the joint and verify the depth of activation.
11. On textured pavers, use a leaf blower to blow the excess water off and into the joints. This will help prevent a possible haze.

COVERAGE

Interlocking paver regular joints (1/8" to 1/2" (3 mm to 13 mm)): 45 to 55 sq. ft. (4.8 to 5.5 m²).

The required quantity will depend on the shape and size of the pavers or slabs, as well as the width and depth of the joints.

STORAGE

Ideally, store product in a dry place. Can be stored outside in its original packaging.

SAFETY WARNINGS

KEEP OUT OF REACH OF CHILDREN. Use only with adequate ventilation. Do not swallow. Do not get in eyes or on skin or clothing. Do not breathe dust. Keep container tightly closed and sealed until ready for use. Wash thoroughly after handling.

FIRST AID TREATMENT

Contains: Crystalline silica and Hydraulic cement.

Eye contact Call physician immediately. Check for and remove any contact lenses. Immediately flush eyes with plenty of water for at least 15 minutes, occasionally lifting the upper and lower eyelids.

Skin contact In case of contact, immediately flush skin with plenty of water while removing contaminated clothing and shoes. Get medical attention. Wash clothing before reuse. Clean shoes thoroughly before reuse.

Inhalation Move exposed person to fresh air. If not breathing, if breathing is irregular or if respiratory arrest occurs, provide artificial respiration or oxygen by trained personnel. Loosen tight clothing such as a collar, tie, belt or waistband. Get medical attention.

Ingestion Call physician immediately. Wash out mouth with water. DO NOT induce vomiting unless directed to do so by medical personnel. Never give anything by mouth to an unconscious person.

EMERGENCY PHONE: CHEMTREC 800-424-9300 or 703-527-3887 outside of the USA

For additional information, visit techniseal.com to request the safety data sheet or call technical service at 1 866 725-7383.

⚠ WARNING: This product can expose you to chemicals including Crystalline Silica, which is known to the State of California to cause cancer, and Methanol, which is known to the State of California to cause birth defects or other reproductive harm. For more information go to www.P65Warnings.ca.gov.

SHIPPING

N/A.

PACKAGING

Polymeric Sand	Product Code	Color	Retail Size	Units per pallet
EZSAND®	40100398	Gray	18.1 kg / 40 lb (bucket)	36
	40100399	Tan	18.1 kg / 40 lb (bucket)	36

LIMITED WARRANTY

Manufacturer, having no control over the use of the materials, does not guarantee finished work. Replacement of any defective product shall be the buyer's sole remedy under this warranty. Before using this product, user shall determine the suitability of the product for its intended use and user alone assumes all risks and liability whatsoever in connection therewith. User shall test product in a small inconspicuous area (approx. 4 sq. ft. (0.4 m²)) under projected conditions of use. In the event that no test was carried out, the warranty will only apply to 4 sq. ft. (0.4 m²). This limited warranty excludes any liability for any consequential, incidental, indirect or special damages. Except for the limited warranty made above, manufacturer specifically disclaims and excludes any other express warranty, any implied warranty of merchantability of goods and any implied warranty of fitness of goods for any particular purpose.