

DOOR CLOSER INSTALLATION PROCEDURE

1 Determine door installation (standard, parallel, top jamb). Drill holes into frame and door as per template.

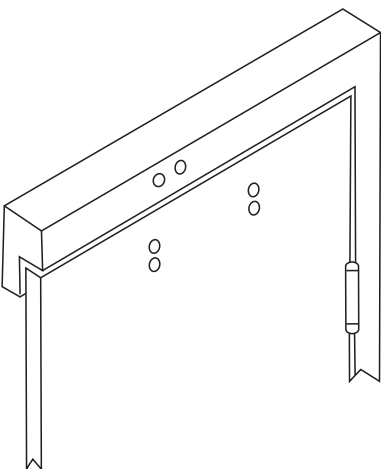

2 Separate main arm from connecting arm by removing elbow washer and screw.

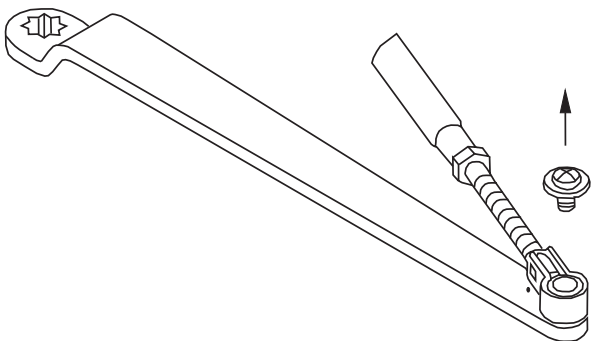

3 Attach main arm to door closer body.

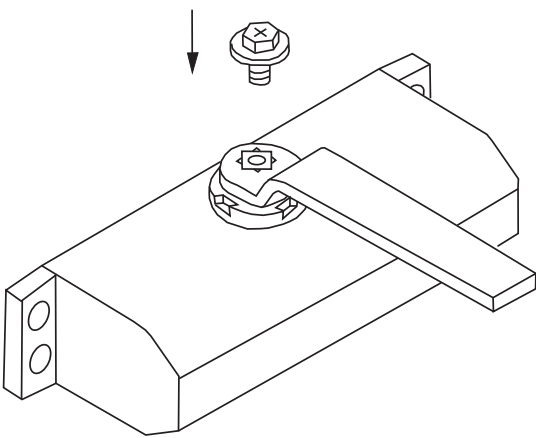

4 Using either the provided wood screws or machine screws (for wood frame or metal door application) mount door closer body to door, and adjustable arm to frame.

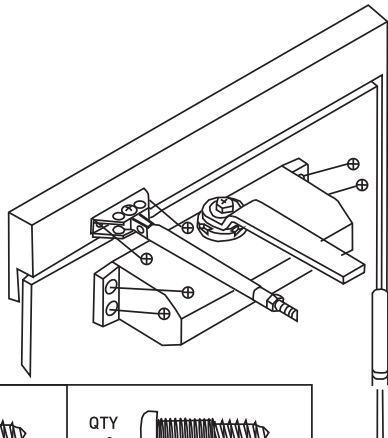

QTY
x 4
DOOR

QTY
x 2
FRAME

5 Pull main arm out to 90 deg from surface of door and attach to connecting arm using screw from step 2. Adjust connecting arm length as required.

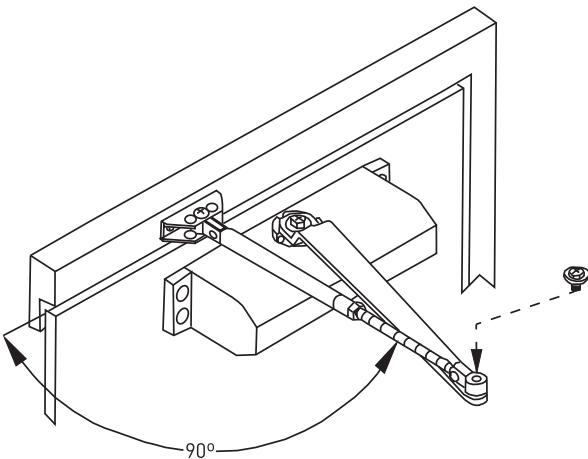

6 Snap dust cap into place, over the pinion on opposite side from where the main arm attaches to door closer body. Adjust closing and latch speeds as required.

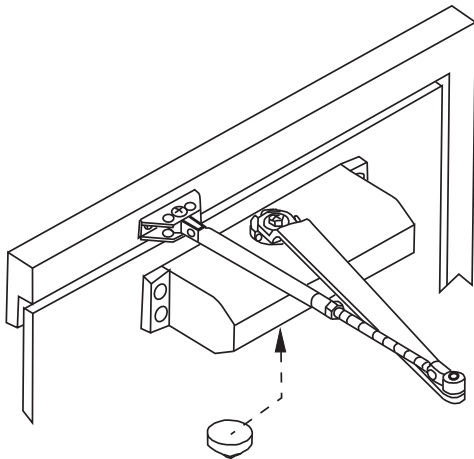

INSTALLATION INSTRUCTIONS

14-600 SERIES DOOR CLOSERS

CHART TO DETERMINE HANDING OF DOOR

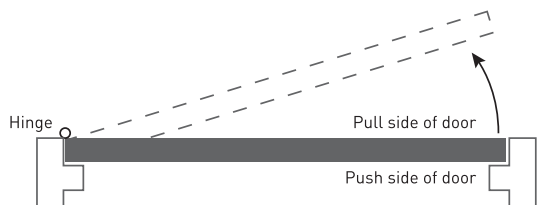

LEFT HAND DOOR

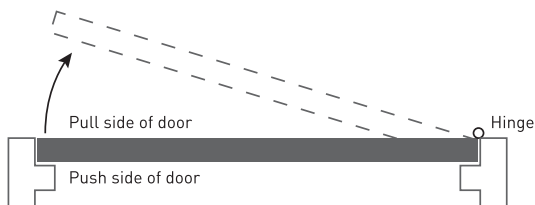

RIGHT HAND DOOR

STANDARD ARM - LEFT HAND DOOR

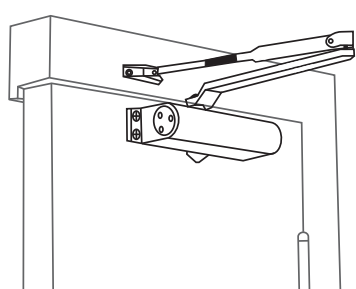

PARALLEL ARM - LEFT HAND DOOR

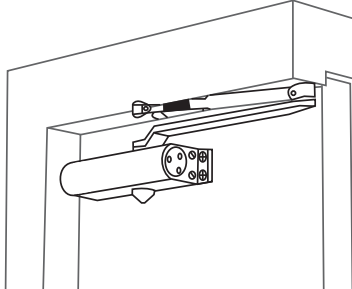

TOP JAMB - LEFT HAND DOOR

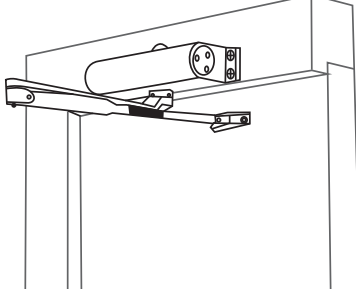

STANDARD ARM - RIGHT HAND DOOR

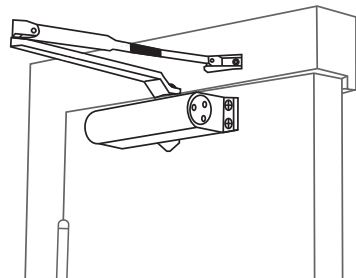

PARALLEL ARM - RIGHT HAND DOOR

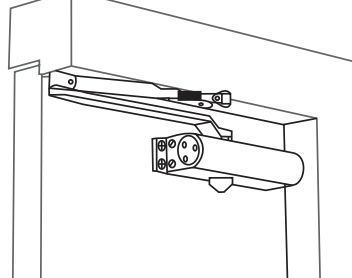

TOP JAMB - RIGHT HAND DOOR

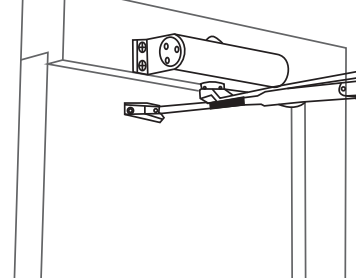

ADJUSTMENT PROCEDURE

CLOSING AND LATCHING SPEED

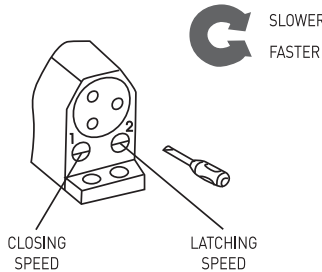

INSTALLATION INSTRUCTIONS

14-600 SERIES DOOR CLOSERS

STANDARD ARM INSTALLATION

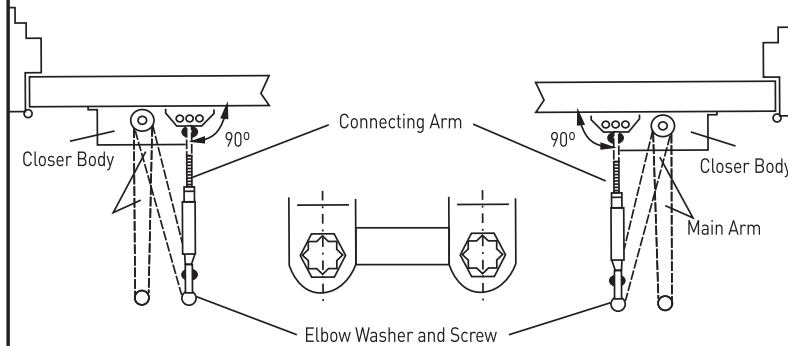
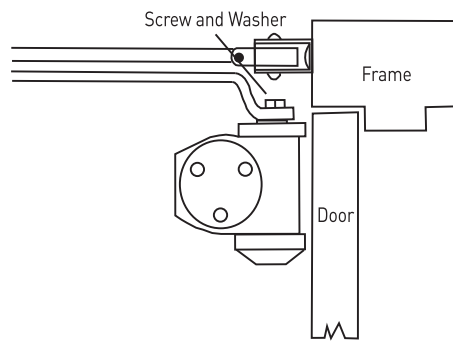
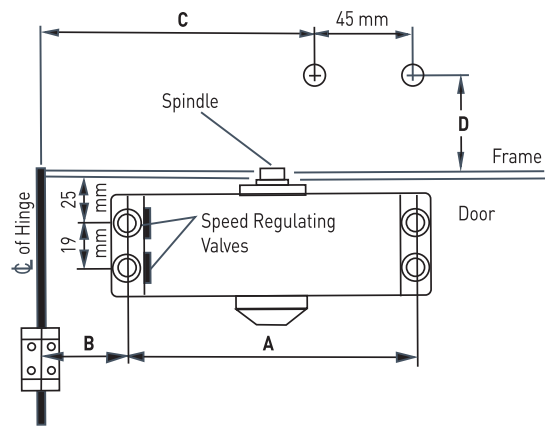

DIMENSIONS* MODEL NO.	A	FOR OPENING TO 120°		FOR OPENING 120° TO 180°		D
		B	C	B	C	
14-602	168	100	225	70	195	22
14-603	208	155	300	125	270	28
14-604	230	155	300	125	270	28

*All dimensions are listed in millimetres

PARALLEL ARM INSTALLATION

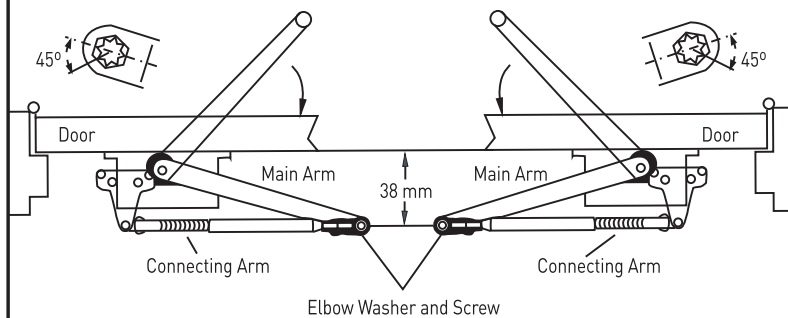
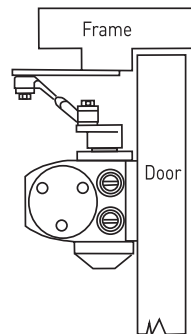
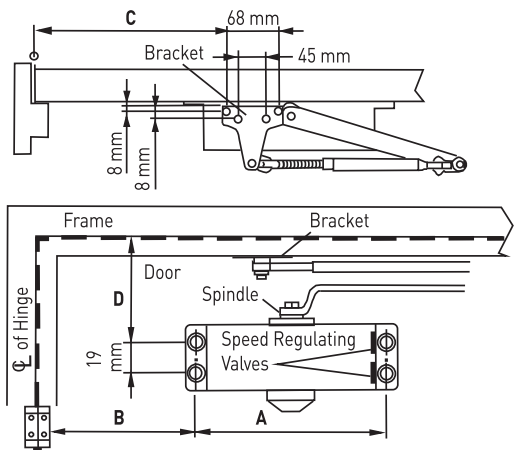

DIMENSIONS* MODEL NO.	A	FOR OPENING TO 120°		FOR OPENING 120° TO 180°		D
		B	C	B	C	
14-602	168	120	150	90	120	68
14-603	208	185	210	155	180	73
14-604	230	160	210	130	180	73

*All dimensions are listed in millimetres

TOP JAMB INSTALLATION

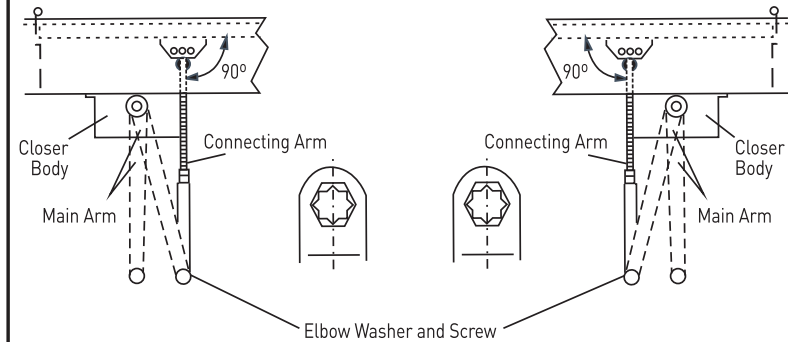
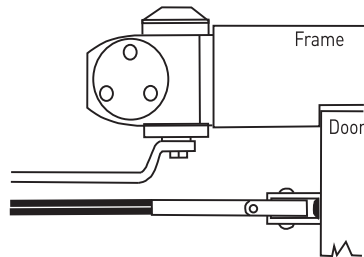
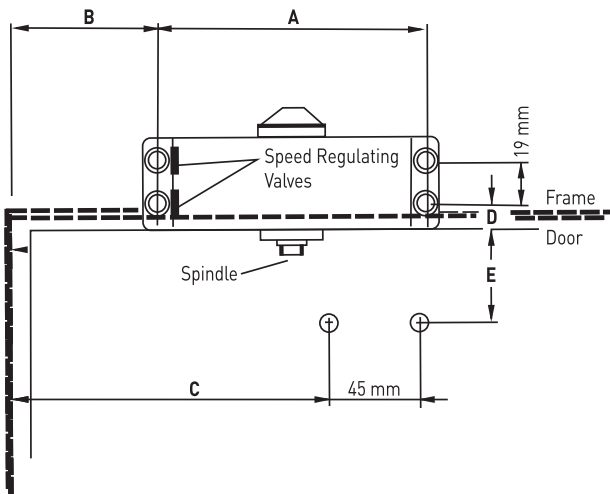

DIMENSIONS* MODEL NO.	A	FOR OPENING TO 120°		FOR OPENING 120° TO 180°		D	E
		B	C	B	C		
14-602	168	100	225	70	195	11	39
14-603	208	155	300	125	270	13	43
14-604	230	155	300	125	270	13	43

*All dimensions are listed in millimetres