

SPEEDWAY
Start-to-Finish



ALL TERRAIN TRICYCLE

Model: 53483/ 53484/ 53485



**Actual product may vary slightly*

Please carefully read and save these instructions before attempting to assemble, maintain, install, or operate this product. Observe all safety information to protect yourself and others. Failure to observe the instructions may result in property damage and/or personal injury. Please keep instructions for future reference.

For warranty purchases, please keep your dated proof of purchase. File or attach to the manual for safe keeping.

Assembly Instructions

PRE-ASSEMBLY

You will need a phillips screwdriver, hex screwdriver and an adjustable wrench for assembly.

Make sure to assemble the product by following this instruction completely and properly.

MAINTENANCE

For the sake of safety, periodically inspect all moveable parts of the unit, and perform proper maintenance if necessary.

WHEEL HUB COLOR

- 53483 Red wheel hub
- 53484 Green wheel hub
- 54485 Pink wheel hub

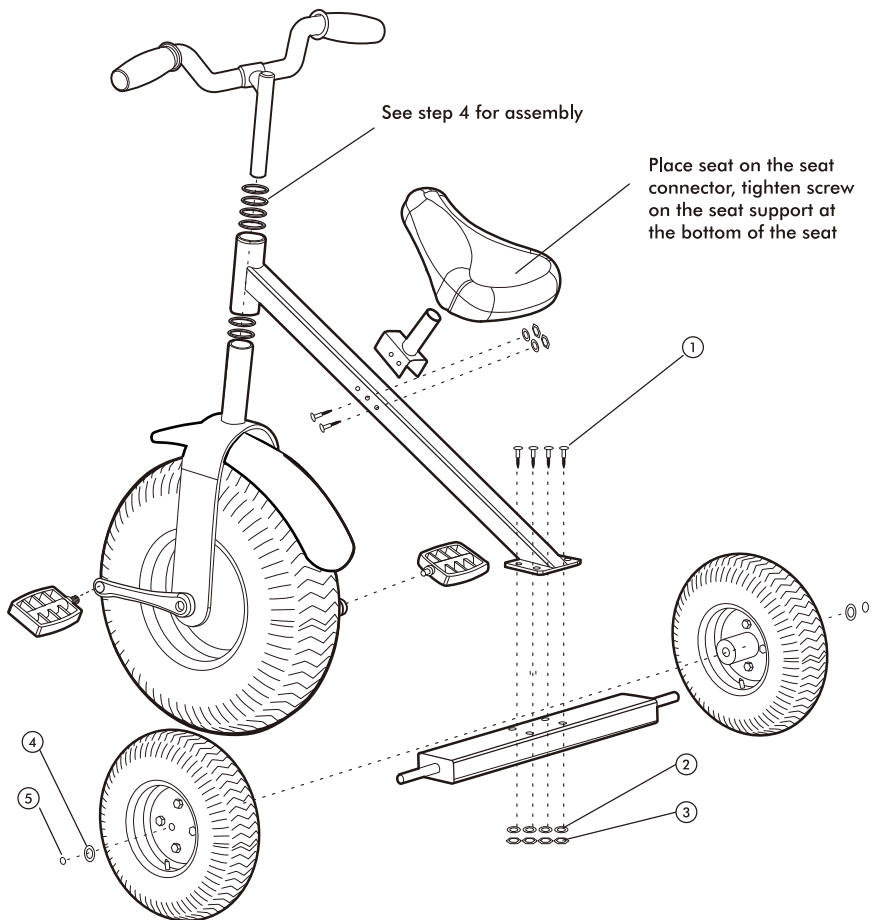

Assembly Instructions

STEP 1.

Place the back wheel onto the back axle (A), put a flat washer (4) on the axle, use pin (5) to lock the back wheel in place. Repeat step 1 to assemble other back wheel.

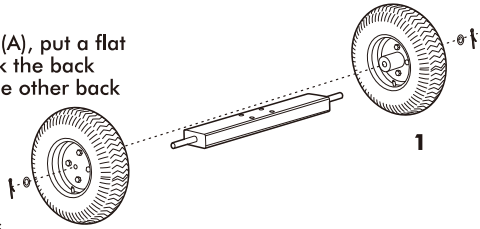

STEP 2.

Attach the back axle (A) to the fork and frame, (H) secure the back axle (A) with bolts, washers and nuts by a phillips screwdriver and wrench.

STEP 3.

Use wrench to secure the pedal (D) onto the threaded crank adjacent to the front wheel (G). repeat step 3 to install the second pedal.

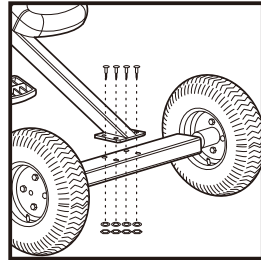

STEP 4.

Follow diagram 4 to put nuts, washer, rings, fork and frame together.

STEP 5.

To assemble the handlebars (F), align the "nut boss" with the slot into the tube, tighten the top screw by hand. Insert the handlebars (F) into the hole of the front axle, use a hex screwdriver to tighten top screw. Please ensure over minimum insertion marking position when tighten the top screw.

2

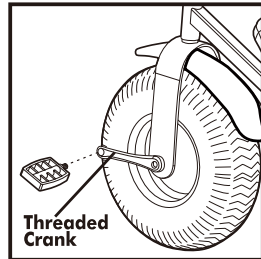

3

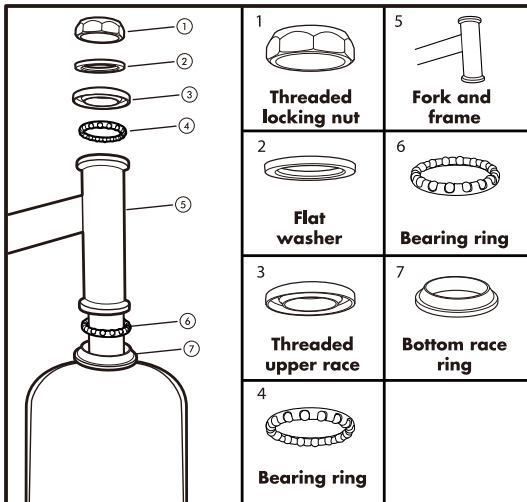

4

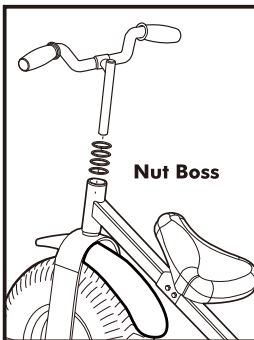

5

Assembly Instructions

STEP 6.

To adjust the seat position, unscrew screws, place seat connector to match holes to the desired position, tighten screws to lock seat in place.

NOTE: While seat installation/adjustment, reverse seat connector to desired position, make sure all three holes were covered after assembly.

STEP 7.

Test the Tricycle by checking all bolts and fittings, make sure everything is securely tightened. Roll the tricycle to check for proper wheel operation. Periodically check tire pressures, for front and rear tires, do not exceed 35 (front) and 30 (rear) PSI respectively.

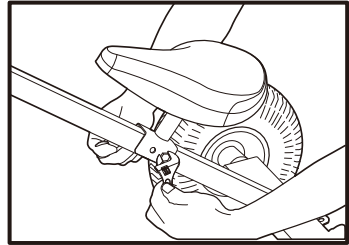

6

Part List:

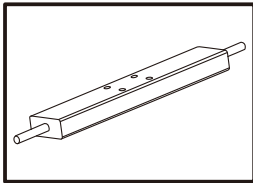

A. Back Axle X1

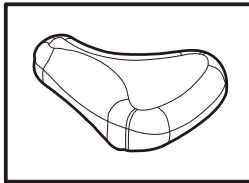

B. Seat X1

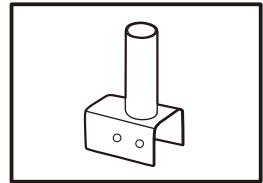

C. Seat Connector X1

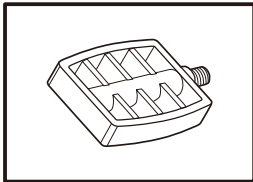

D. Pedals X2

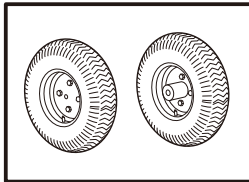

E. Back Wheels X2

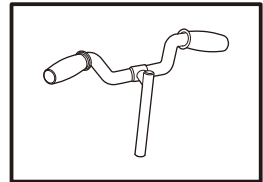

F. Handlebars X1

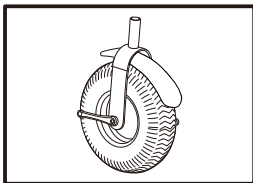

G. Front Wheel X1

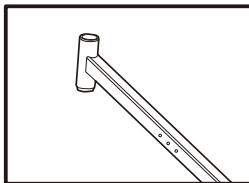

H. Fork and Frame X1

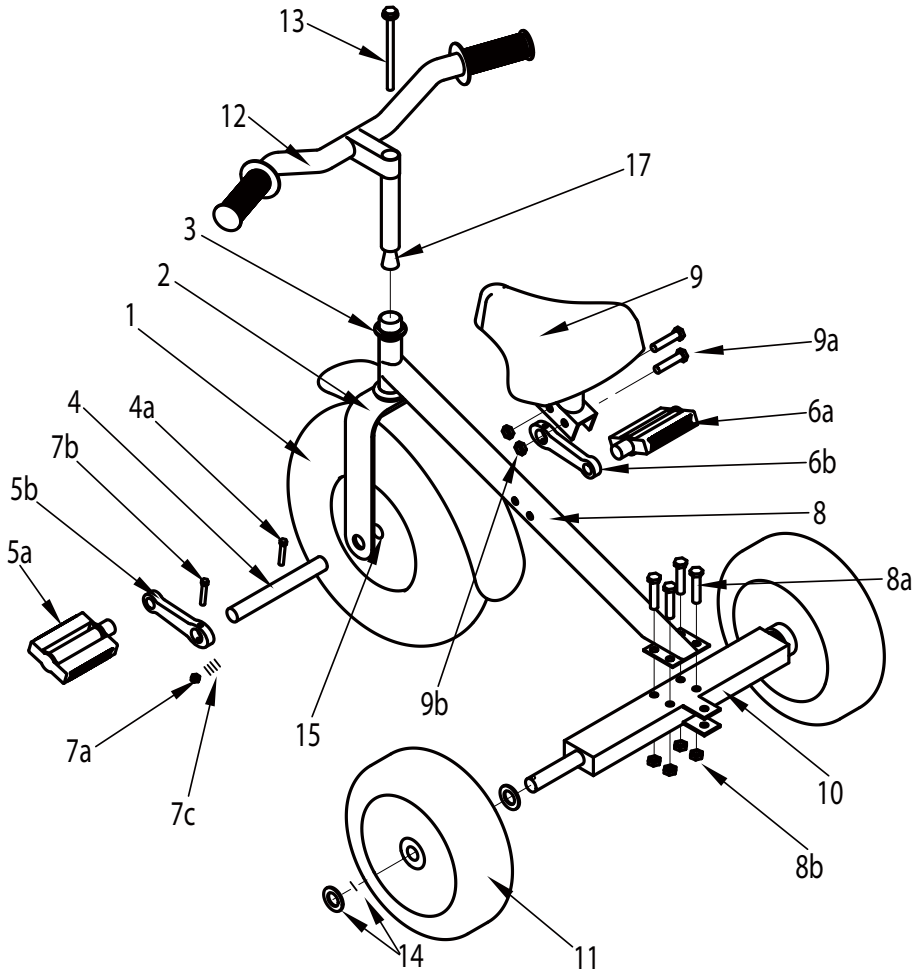

Part	Description	Qty
1	Front Wheel	1
2	Front Fork & Fender	1
3	Bearing Head Set	1
4	Front Wheel Axle Shaft	1
4a	M8 Bolt of Axle Shaft	1
5a	Pedal(Left side,normal threads)	1
5b	Crank(Left side,normal threads)	1
6a	Pedal(Right side,reverse threads)	1
6b	Crank(Right side,reverse threads)	1
7a	Crank Nut	2
7b	Crank Pin	2
7c	Washer for Crank Nut	16
8	Frame	1

Part	Description	Qty
8a	Frame Install Bolt	4
8b	Frame Install Nut	4
9	Seat	1
9a	Seat Install Bolt	2
9b	Seat Install Nut	2
10	Rear Frame	1
11	Rear Wheel	2
12	Handle Bar	1
13	Socket Head Cap Screw & Nut	1
14	Cover & Washer	2 set
15	Bushing(Front Wheel)	2
16	Bearing(not shown,inside Rear Wheel)	2
17	insert	1

Limited Manufacturer Warranty

North American Tool Industries (NATI) makes every effort to ensure that this product meets high quality and durability standards. NATI warrants to the original retail consumer a 1-year limited warranty from the date the product was purchased at retail and each product is free from defects in materials. Warranty does not apply to defects due directly or indirectly to misuse, abuse, negligence or accidents, repairs or alterations, or a lack of maintenance. This product is intended for personal use. The warranty will be voided if used in commercial, rental, or industrial applications. NATI shall in no event be liable for death, injuries to persons or property, or for incidental, special or consequential damages arising from the use of our products. To receive service under warranty, the original manufacturer part must be returned for examination by an authorized service center. Shipping and handling charges may apply. If a defect is found, NATI will either repair or replace the product at its discretion.

DO NOT RETURN TO STORE

For Customer Service:

Email feedback@natitools.com or

Call **1-800-348-5004**