

PSCL/PSCA Panel Sheathing Clips

Simpson Strong-Tie® panel sheathing clips are used to brace unsupported sheathing edges and provide a 1/8" gap to address shrinkage and expansion of roof sheathing.

Material: 33 mil (20 ga.)

Finish: Galvanized

Installation:

- Use the same size sheathing clip as the panel thickness
- Maximum spans may be reduced for low slopes or high uniform loads; refer to manufacturer's installation instructions

Codes: See p. 11 for Code Reference Key Chart

Span Rating	Panel Thickness (in.)	Model No.	Maximum Roof Sheathing Span		No. of Clips Per Span	Code Ref.
			With Clip	Without Clip		
24/0	3/8	PSCL3/8	24	20	1	180
24/16	7/16	PSCA7/16	24	24	1 ²	
24/16	7/16	PSCL7/16	24	24	1	
32/16	15/32	PSCA15/32	32	28	1 ²	
32/16	15/32	PSCL15/32	32	28	1	
32/16	1/2	PSCA1/2	32	28	1 ²	
32/16	1/2	PSCL1/2	32	28	1	
40/20	5/8	PSCL5/8	40	32	1	
40/20	19/32	PSCL19/32	40	32	1	
48/24	3/4	PSCL3/4	48	36	2	

1. Span rating and Maximum Roof Sheathing Spans are for reference only, refer to 2015 IBC Table 2304.8 (3) for additional important information.

2. Maximum roof sheathing span with single PSCA is 24". For spans > 24" use two PSCAs.

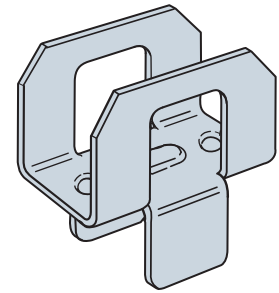

PSCL
(PSCA similar)

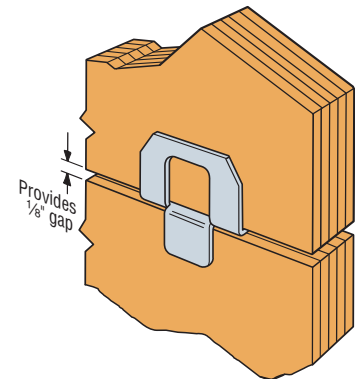

Typical PSCL Installation