

LTS/MTS/HTS Twist Straps

Twist straps provide a tension connection between two members. They resist uplift at the heel of a truss economically. LTS/ MTS have a 2"-bend section and HTS has a 3¾"-bend section that eliminates interference at the transition points between the two members.

Material: See table

Finish: Galvanized. Some products available in stainless steel and ZMAX®; see Corrosion Information, pp. 18-21

Installation:

- Use all specified fasteners; see General Notes.
- LTS, MTS and HTS are available with the bend reversed. Specify “-REV” after the model number, such as MTS16-REV.

Codes: See p. 11 for Code Reference Key Chart

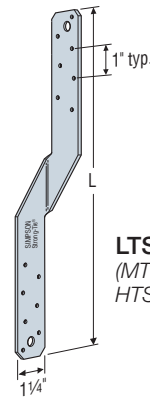

LTS12
(MTS and HTS similar)

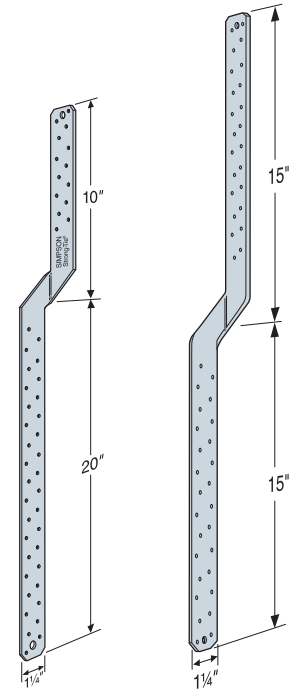

MTS30
(HTS30 similar)

MTS30C
(HTS30C similar)

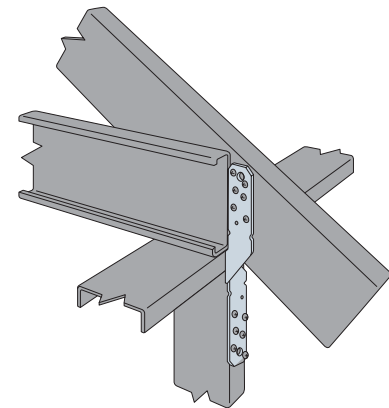

Typical MTS Installation
Truss to Steel Studs

Model No.	Connector Material Thickness mil (ga.)	L (in.)	Fasteners ⁶ (Total)			Allowable Tension Load (lb.)	Code Ref.
			Rafter/Stud/Joist Thickness				
			33 mil (20 ga.)	43 mil (18 ga.)	54 mil (16 ga.)	33 mil (20 ga.)	
LTS12	43 (18)	12	(10) #10	(6) #10	(6) #10	775	IP1, FL, L2
LTS16		16	(10) #10	(6) #10	(6) #10	775	
LTS18		18	(10) #10	(6) #10	(6) #10	775	
LTS20		20	(10) #10	(6) #10	(6) #10	775	
MTS12	54 (16)	12	(12) #10	(8) #10	(6) #10	995	
MTS16		16	(12) #10	(8) #10	(6) #10	995	
MTS18		18	(12) #10	(8) #10	(6) #10	995	
MTS20		20	(12) #10	(8) #10	(6) #10	995	
MTS30		30	(12) #10	(8) #10	(6) #10	995	
MTS24C		24	(12) #10	(8) #10	(6) #10	995	
MTS30C		30	(12) #10	(8) #10	(6) #10	995	
HTS16		68 (14)	16	(16) #10	(12) #10	(6) #10	
HTS20	20		(18) #10	(12) #10	(6) #10	1,450	
HTS24	24		(18) #10	(12) #10	(6) #10	1,450	
HTS30	30		(18) #10	(12) #10	(6) #10	1,450	
HTS30C	30		(18) #10	(12) #10	(6) #10	1,450	

These products are available with additional corrosion protection. Additional products on this page may also be available with this option. Check with Simpson Strong-Tie for details.

1. Not all fastener holes need to be filled, as additional fastener holes are provided. Install fasteners symmetrically.
2. Install half of the fasteners on each end of strap to achieve full loads.
3. All straps except the MTS30 and HTS30 have the twist in the center of the strap.
4. Twist straps do not have to be wrapped over the truss to achieve the load.
5. May be installed on the inside face of the stud.
6. See pp. 138 through 171 for more information on Simpson Strong-Tie fasteners.