

Please be sure to read the enclosed Shark® Owner's Guide prior to using your unit.

Shark®

Navigator™ LIFT-AWAY® PRO

QUICK START GUIDE

WHAT'S INSIDE

- A** Portable Lift-Away® Pod
- B** Floor Nozzle
- C** Extension Wand
- D** Handle with Stretch Hose
- E** Accessory Holder
- F** Crevice Tool
- G** Upholstery Tool

ASSEMBLY

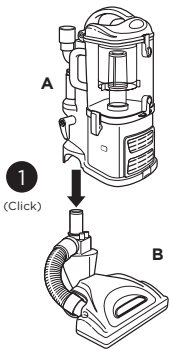

Insert pod onto motorized floor nozzle.

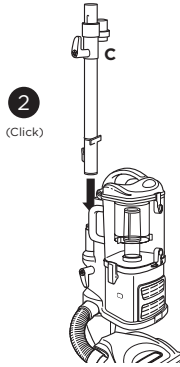

Insert wand into the pod.

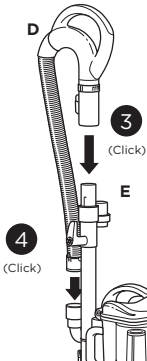

4
(Click)

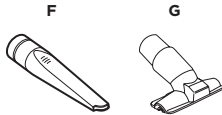

Connect the handle to the top of the wand, pressing until it clicks into place. Connect hose to the back of the pod, pressing until it clicks into place.

FLOOR CLEANING

- 1 Plug In Vacuum**
Then place your foot gently on the floor nozzle and tilt the handle back.



- 2 Choose Setting**
Slide the Power/Surface switch to the appropriate floor setting and start cleaning.

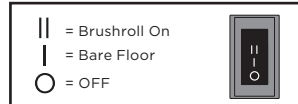

BRUSHROLL ON/OFF:

- 1** Press the **Power/Surface** switch at the top of the pod to **Setting I** to vacuum bare floors (straight suction only) or to use Lift-Away® mode. To vacuum carpets and rugs, use **Setting II** to engage the motorized brushroll.
- 2** Step on the floor nozzle and tilt the handle back towards you to engage the brushroll.

LIFT-AWAY® MODE

1 Plug In Vacuum

Press Lift-Away button to lift pod off floor nozzle. You are now ready to clean those hard-to-reach places.



To clean above-floor areas with the handle, detach it from the wand by pressing the Handle button.



To clean with a longer reach, detach the wand from the floor nozzle by pressing the Wand Release button.

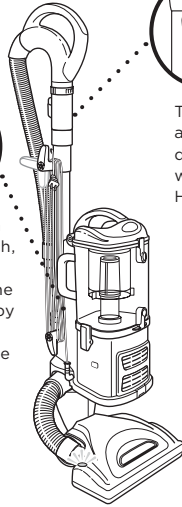

2 Attach desired cleaning accessory.

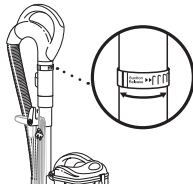
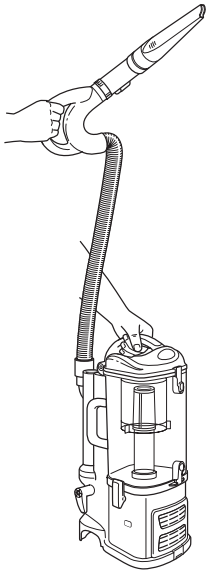

SUCTION CONTROL

Adjust the suction by rotating the suction release collar on the handle counterclockwise to reduce the suction or clockwise to increase suction.

Attach accessories to handle or wand.

For additional parts and accessories, visit sharkaccessories.com



MAINTENANCE

Empty dust cup after each use

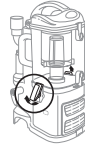

Pull up on Dust Cup Release latch and lift dust cup off pod.



Hold dust cup over a trash bin and press the empty-release latch on the bottom.



Turn the dust cup upside down over the trash and press the top release button. To remove debris from the dust screen, tap gently or wipe with a dry cloth as needed.

Cleaning Filters

Pre-Motor



Post-Motor

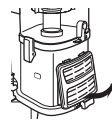

MAINTENANCE:

Rinse pre-motor filters every 3 months, and post-motor filter once a year.

Rinse with water only, and allow all filters to air-dry completely before reinstalling.

Pre-Motor (foam and felt):

With the dust cup removed, take out pre-motor filters and rinse them with water only.

Post-Motor (HEPA):

To access the HEPA filter, pull the latch under the filter cover and lift off the cover. Remove the HEPA filter, rinse it with water only. Let all filters air-dry completely before reinstalling.

Easy brushroll maintenance

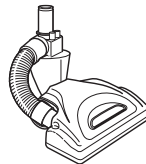

Detach the floor nozzle from the portable Lift-Away pod.

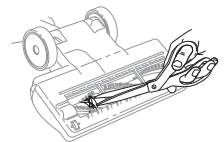

Remove any string, carpet fibers, or hair that may be wrapped around the brushroll.

For additional parts and accessories, visit sharkaccessories.com

For questions or to register your product, visit us online at sharkclean.com



@sharkcleaning

©2019 LIFT-AWAY and SHARK are registered trademarks of SharkNinja Operating LLC.

NAVIGATOR is a trademark of SharkNinja Operating LLC