

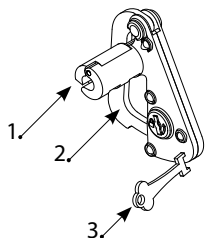

First Line™ Security Swing Lock

The Swing Lock attaches to existing scan hooks (from .186" through .250" wire diameters), and features a durable metal swing arm that secures the lock around the hook, preventing removal of product.

1. Hinge-feature allows for easy installation.
2. Metal swing arm for durability.
3. Universal Key.



Part #	Dimensions	Finish	Pack	Price Per	Under 100	100	500
RSHL-001	3"H x 1.75"W x 1.75" D	Gray	10	1	2.52	2.24	2.13

Additional volume discounts available. Call for pricing.



First Line™ Security Hook Lock

This economical solution utilizes a durable plastic construction that securely snaps onto the scan arm (from .186" through .250" wire diameters) and ratchets around the scan hook, requiring a key to access merchandise.

1. Ratchet design for secure fit.
2. Reinforced plastic arm snaps onto scan arm of hook.
3. Universal Key.

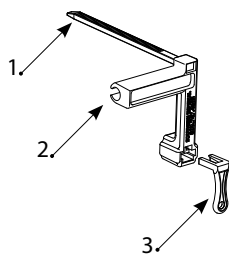

Part #	Dimensions	Finish	Pack	Price Per	Under 100	100	500
RSHL-003	2.375" H x .625" W x 2" D	Gray	10	1	0.80	0.70	0.66

Additional volume discounts available. Call for pricing.



First Line™ Security Peg Back Lock

The Peg Back Lock secures the hook to the pegboard. Simply slide it over the bottom wire of a scan hook and use the included push pins to lock it in place.

1. Easily slide over lower arm of scan hook.
2. Steel construction for durability.
3. Push pin design expands on entry into pegboard and locks in place.

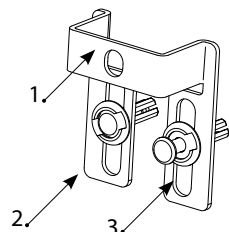

Part #	Dimensions	Finish	Pack	Price Per	Under 100	100	500
RSHL-004	2" H x 1.5" W	Galv.	10	1	0.62	0.56	0.50

Additional volume discounts available. Call for pricing.