

# sol<sup>o</sup>®

**CHEMICAL APPLICATORS**

**COMMERCIAL QUALITY**





Since 1948, Solo® has earned global recognition as a leading manufacturer of superior quality spraying equipment. Solo has combined small engine expertise and world-class blow molding technology to produce the finest chemical applicators and power equipment. Solo sprayers are repairable and are sold and serviced throughout the US. Consumers can order parts directly from Solo as needed.

### SUPERIOR BY DESIGN

Choosing the right sprayer for the job can generate tremendous savings in material and labor costs. Solo industrial sprayers offer the following features:

- Chemical-resistant seals and gaskets to resist the harmful effects of harsh chemicals.
- High-density polyethylene (HDPE) tanks designed to stand up to the toughest jobs.
- Translucent tanks for easy monitoring of fill levels.
- Large tank openings for easy filling and cleaning.
- Extra long, nylon-reinforced hoses for outstanding reach and durability.
- Large pump handles with built-in wand retainers for comfort and convenience.
- Commercial lock-on/lock-off shut-off valves are comfortable to use and easy to maintain.
- Long unbreakable wands do not corrode and provide excellent reach.
- Interchangeable TeeJet® compatible nozzles allow fast nozzle changes for a variety of applications.
- Most sprayer maintenance can be performed without tools.
- 1-year commercial warranty on all tank and backpack sprayers; 90-day commercial warranty on one-hand sprayers.

### LABOR SAVINGS

Throughout the janitorial/sanitation industry, it is not uncommon that 90% of your total budget is spent on labor. Our sprayers are designed specifically for the challenges of your industry and to reduce your operating costs.

Compared to the industry standard “trigger” pump sprayers, Solo Applicators will benefit you and your employees in three ways:

1. **Time Savings** – Efficient Pump Design requires less time and effort to complete spraying tasks, especially for larger areas.
2. **Chemical Savings** Our pumps develop and maintain a higher pressure longer to better

atomize the chemicals, requiring less chemical to complete any task.

3. **Ergonomic Design** – Complaints of the annoying hand fatigue common with trigger sprayers are a thing of the past. In addition, the bending and stretching necessary for cleaning hard-to-reach areas is virtually eliminated by the swivel nozzles and wand extensions on many of the Solo sprayers.

This equates not only to substantial savings in labor and chemical usage, but also better job performance and happier employees. **Shouldn't you be using Solo Applicators?**



## MULTI-PURPOSE ONE-HAND SPRAYERS

Lightweight and versatile, Solo one-hand pressure sprayers are perfect for pest control, carpet spot treating, cleaning, and more. All offer many of the same features as our larger tank sprayers.

- Unique drift/drip guard provides added control for spot treatment.
- Multi-directional nozzle.
- Locking trigger reduces user fatigue.
- Viton® seals provide superior chemical resistance.
- 7" Metal wand provides added reach (419).
- Telescoping wand adjusts from 16" to 23" which improves access while reducing effort (420).



418



418-2L



419



420

## ECONOMY ONE-HAND SPRAYERS

- Large tank opening.
- Large pump knob.
- Piston pump.
- Plastic adjustable nozzle.



415



403

404

## SPECIALTY ONE-HAND SPRAYERS

### 404-V INDUSTRIAL SPRAYER

- All Viton® seals for use with bleach and other harsh chemicals to ensure long service and durability.
- Ergonomically designed carrying handle with trigger lock-on feature.
- Includes adjustable and flat spray nozzles.
- TeeJet® Compatible.



404-V

### 404-VF FOAMING SPRAYER

- All Viton® seals and foaming nozzle for use with foaming chemicals.
- Ergonomically designed carrying handle with trigger lock-on feature.
- Includes foaming nozzle for increased dwell time.
- TeeJet® Compatible.



404-VF

Model #	UPC # 720 343	Capacity	Wand	Pump	Weight	Carton Size	Cubic Feet	Case Pack
415	41500 1	1 L	N/A	Piston	0.75 lbs	20" x 14.5" x 11.6"	1.96	12*
418	41810 1	1 L	3.5"	Piston	1.2 lbs	10" x 7.5" x 5"	0.22	20
418-2L	41802 6	2L	3.5"	Piston	1.5 lbs	11.25" x 7" x 6.25"	0.28	16
419	41900 9	2 L	7"	Piston	1.5 lbs	11.25" x 7" x 6.25"	0.28	16
420	42000 5	2 L	16"-23"	Piston	1.55 lbs	11.25" x 7" x 6.25"	0.28	16
403	01403 7	1.25 L	N/A	Piston	1.4 lbs	12" x 6.5" x 6"	0.26	10
404	00404 5	2 L	N/A	Piston	1.6 lbs	13.5" x 6.75" x 6.5"	0.28	10
404-V	01403 7	2 L	N/A	Piston	1.6 lbs	13.5" x 6.75" x 6.5"	0.28	10
404-VF	00404 5	2 L	N/A	Piston	1.6 lbs	13.5" x 6.75" x 6.5"	0.28	10

\* Sold only in case packs



### PROFESSIONAL HANDHELD SPRAYERS

Engineered specifically for the professional. Ideal for applying degreasers, waterproofing, carpet care chemicals, disinfectants, and many other compounds.

- Extra large, heavy-duty pump pressurizes the tank with far fewer strokes; as much as 50% more efficient than the competition.
- Large 4.5" tank opening makes filling and cleaning easier.
- 28" unbreakable wand with commercial shut-off valve.
- Automatic pressure relief valve releases pressure at 45 psi.
- Equipped with all Viton<sup>®</sup> seals for superior chemical resistance.
- Includes .4 gpm brass 80° flat fan, plastic adjustable, jet stream and hollow cone nozzles.
- No-drip check valve eliminates nozzle drip after pressure is released.



Model #	UPC # 720 343	Capacity	Wand	Hose	Pump	Weight	Carton Size	Cubic Feet	Pallet Quantity
454-HD	45402 4	1.5 gal	28"	48"	Piston	5 lbs	22" x 8.5" x 8.5"	0.89	100
456-HD	45602 8	2.25 gal	28"	48"	Piston	6 lbs	22" x 8.5" x 8.5"	0.89	100
457-HD	45702 5	3 gal	28"	48"	Piston	7 lbs	23.75" x 8.5" x 8.5"	1.19	75

## PROFESSIONAL BACKPACK SPRAYERS

Designed to make even the largest spraying jobs manageable. Unique fluid-driven pump design pressurizes to working pressure with as few as eight to ten strokes. Easily provides consistent pressure when precision application is required.

- High-performance piston pump for liquid formulation (425-HD)
- High-performance diaphragm pump for wettable powder, liquid formulations and bleach solutions (475-B-HD).
- Adjustable pressure regulator with four settings: 15, 30, 45, 60 psi.
- Durable professional grade brass adjustable, brass fan, hollow cone, jet stream nozzles (425-HD). In addition to these 4 nozzles, 475-B-HD also includes plastic adjustable nozzle for use with bleach solutions.
- No-drip check valve eliminates nozzle drip after pressure is released.
- Viton® seals in critical locations for superior chemical resistance.
- Extra large carrying handle with wand retainers for easy portability and storage (425-HD).
- Deluxe shoulder straps and waist belt for user comfort (425-HD).



425-HD



475-B-HD



Model #	UPC # 720 343	Capacity	Wand	Hose	Pump	Weight	Carton Size	Cubic Feet	Pallet Quantity
425-HD	42577 2	4 gal	28"	48"	Piston	11 lbs	20.25" x 14.75" x 9.25"	1.57	60
475-B-HD	47501 2	4 gal	28"	48"	Diaphragm	11 lbs	20.25" x 14.75" x 9.25"	1.57	60

### HIGH VOLUME FOAMING SPRAYER

Specifically designed for work with foaming chemicals and “green” cleaning formulations that require additional dwell time. Ideal for controlling termites and other pests hidden within wall voids. Can also be used to eradicate mold and mildew – especially on vertical surfaces.

- Special foam applicator nozzle for surface cleaning applications.
- Pressure gauge for monitoring pressure during application.
- Brass wand for added durability.
- All Viton® seals for superior chemical resistance.
- Optional flexible wall void applicator available for treating within wall voids (part #4900643).
- Optional brass void foam injector available for treating within crevices (part # 4900644).



### ACID SPRAYER

Specifically designed for use with harsh, acidic chemicals. Special acid resistant materials are used at all liquid contact points to provide long life and trouble free use.

- Funnel top design for easy filling.
- Adjustable nozzle adjusts from cone to stream patterns for multi-purpose spraying.
- Acid resistant, nylon-reinforced hose for added durability.
- Viton® seals in critical locations for superior chemical resistance.



### HEAVY-DUTY HANDHELD SPRAYERS

Designed for general spraying tasks. These sprayers offer some professional features at competitive prices.

- Chemical resistant seals for applying harsh chemicals.
- Easy-to-fill funnel top can be removed to reveal a large, secondary opening for easy cleaning.
- 28” unbreakable wand with commercial shut-off valve.
- Five-nozzle assortment: plastic adjustable, flat fan, jet stream, hollow cone and brass fan nozzles for multiple spraying tasks.
- No-drip-check valve eliminates nozzle drip after pressure is released.
- Automatic pressure relief valve releases pressure at 45 psi.
- Unique storage compartment for extra nozzles.



Model #	UPC # 720 343	Capacity	Wand	Hose	Pump	Weight	Carton Size	Cubic Feet	Pallet Quantity
456-F	45610 3	2 gal	28”	48”	Piston	6.25 lbs	24” x 9” x 8.75”	1.09	75
462	00462 5	2.25 gal	25”	40”	Piston	11 lbs	23.5” x 8.25” x 8.25”	1.57	40
430-1G-HD	43001 1	1 gal	28”	48”	Piston	3 lbs	22” x 8.5” x 8.5”	0.89	100
430-2G-HD	43002 2	2 gal	28”	48”	Piston	4 lbs	22” x 8.5” x 8.5”	0.89	100
430-3G-HD	43003 5	3 gal	28”	48”	Piston	5 lbs	24” x 8.25” x 8.25”	1.24	75

# GENERAL-DUTY SPRAYERS



A full-featured sprayer in an economical package. Perfect for wood deck cleaners, as well as algae and mildew removers.

## 400-1G ECONOMY SPRAYER

- Durable 21" plastic wand and shut-off valve assembly.
- 34" PVC hose.
- Easy-to-fill funnel top.
- Ergonomically-designed pump / carrying handle.
- Pressure relief valve vents excess pressure.
- Plastic adjustable spray nozzle adjusts from stream to mist.



## 405-US / 406-US MULTI-PURPOSE SPRAYERS

- Durable 24" poly wand and shut-off valve assembly.
- 45" PVC hose.
- Easy-to-fill funnel top.
- Plastic adjustable spray nozzle included. TeeJet® compatible.
- Large pump handle with a built-in wand retainer.
- Pressure relief valve.



Model #	UPC # 720 343	Capacity	Wand	Hose	Pump	Weight	Carton Size	Cubic Feet	Pallet Quantity
400-1G	04001 2	1 gal	21"	34"	Piston	2.5 lbs	14.75" x 7.75" x 7.75"	0.60	120
405-US	00405 2	1 gal	24"	45"	Piston	4 lbs	17" x 8" x 8"	0.67	120
406-US	01406 8	2 gal	24"	45"	Piston	4 lbs	21.25" x 9" x 9"	1	72

Solo specialty applicators are designed for specific applications that differ from basic spraying tasks. All feature Solo world-class quality components and manufacturing know-how to help the user get the job done efficiently and easily.



### 405-B BLEACH SPRAYER

Safely sprays bleach solutions to remove mildew, algae, and other unwanted materials caused by flooding. Perfect for cleaning and removing algae, dirt and mildew stains from decks and patios, driveways and sidewalks, siding, outdoor furniture, fences and stucco, and also for cleaning, disinfecting hard finished surfaces such as toilet facilities, tile showers, and food preparation areas.

- All-poly construction.
- Durable poly wand with poly nozzle that adjusts from straight stream to a fine mist.
- Viton® seals provide greater chemical resistance.

457 Rollabout



### 457-ROLLABOUT

Chemical application made easy – just roll the sprayer to your work area! Large tank is designed to make quick work of big jobs. Includes the features of the 450 series handheld sprayers plus:

- Heavy-duty wheels designed to handle rough terrain and add stability when the tank is upright.
- Extra long 72" hose makes it convenient to park the sprayer and go about remote spraying tasks.
- Oversized pump handle doubles as a pull handle.
- Viton® seals in key locations for greater chemical resistance.
- Built-in air inflation valve allows pressurizing sprayer using a compressor.

469



### STAINLESS STEEL SPRAYER

Designed for a variety of spraying tasks. Ideal for spraying pesticides, herbicides, and general spraying. Corrosion resistant tank is perfect for applying harsh chemicals.

- Extra large D-style pump handle and heavy-duty pump.
- 48" nylon-reinforced hose provides extended reach and increased durability.
- 29" durable stainless steel wand with commercial shut-off valve.
- Brass adjustable nozzle adjusts from cone to stream patterns.
- Jet stream, flat fan and hollow cone nozzles also included.

421-S



### PRECISION SPREADER

The 421-S chest-mounted broadcast spreader is designed for spreading a variety of dry materials over irregular terrain more conveniently than a wheeled spreader. Ideal for applying granular materials like ice melt, oil absorbents, pesticides, herbicides, fertilizers, and seed. Handles particles of a wide variety of sizes.

- Rugged polyethylene and stainless steel components provide optimal corrosion resistance.
- Fully-enclosed lubricated gears ensure long life.
- Large opening allows easy filling and cleaning.
- Fingertip levers effortlessly control direction and volume.
- Over 20 lb capacity hopper with cap protects operator from chemicals and dust.

Model #	UPC # 720 343	Capacity	Wand	Hose	Pump	Weight	Carton Size	Cubic Feet	Pallet Quantity
405-B	02405 0	1 gal	21"	34"	Piston	3.25 lbs	18" x 8" x 8"	0.67	120
457-Rollabout	45705 6	3 gal	28"	72"	Piston	10 lbs	23" x 12" x 12"	1.92	60
469	46901 1	2 gal	29"	48"	Piston	7 lbs	23.75" x 8.5" x 8.5"	0.89	50
421-S	42100 2	20 lbs	N/A	N/A	N/A	7 lbs	19.6" x 10.25" x 11"	1.28	64



Designed specifically for use in concrete preparation and treatment. With its rugged polyethylene tank and unbreakable wand, the concrete sprayers provide outstanding performance, efficiency, and durability. Performs as efficiently as traditional steel sprayers at a fraction of the cost.

## CONCRETE SPRAYER

Designed specifically for use with curing compounds, form release agents and general spraying tasks. Can apply up to 35% solids.

- Viton® seals for durability and safety with a wide variety of chemicals.
- HDPE tank with ultra-violet inhibitors; will not dent, crack, or corrode.
- 48" nylon-reinforced hose for extended reach.
- Built-in air inflation valve allows pressurizing the sprayer using a compressor.
- Large pump pressurizes the sprayer as much as 50% faster than the competition.
- Automatic pressure relief valve releases pressure at 45 psi.
- 28" unbreakable wand and commercial shut-off valve.
- Fitted with a 1 gpm, 110° flat fan nozzle for spraying higher solid content curing compounds.
- Includes jet stream, flat fan, hollow cone and plastic adjustable nozzles.
- 4.5" opening allows easy filling and thorough cleaning.



## ACETONE SPRAYER

Designed specifically for applying Acetone-based formulations, most alcohols and ammonia.

- EPDM seals for excellent protection against the effects of Acetone.
- HDPE tank with ultra-violet inhibitors; will not dent, crack, or corrode.
- Extra long 72" Acetone resistant hose for extended reach.
- Built-in air inflation valve allows pressurizing the sprayer using a compressor.
- Large pump pressurizes the sprayer as much as 50% faster than the competition.
- Automatic pressure relief valve releases excess pressure at 45 psi.
- 20" brass wand provides chemical resistance to Acetone.
- Brass nozzles: .4 gpm cone, .2 gpm cone, and .5 gpm fan nozzles.
- 4.5" opening allows easy filling and thorough cleaning.

Model #	UPC # 720 343	Capacity	Wand	Hose	Nozzles	Pump	Weight	Carton Size	Cubic Feet	Pallet Quantity
407-CI	40600 9	3 gal	20" plastic	48"	1 gpm flat fan 4-nozzle assortment	Piston	7.25 lbs	23.75" x 8.5" x 8.5"	1	75
487-CI	00478 8	3 gal	20" brass	72"	.4 gpm cone, .2 gpm cone, .5 gpm fan	Piston	7.25 lbs	23.75" x 8.5" x 8.5"	1	75

For over 65 years, Solo has produced premium, high-performance power equipment designed with the professional user in mind. Solo power equipment excels with its rugged commercial grade 2-cycle engines. German engineered, all Solo power equipment is covered by some of the best warranties in the industry.



### BACKPACK MIST BLOWER

Ideal for applying plant protection chemicals, or for mosquito, pest and parasite control in storage areas, containers, or animal herds. Creates a fine mist, applying chemicals over large areas more efficiently than manual spraying.

- Powerful 66.5 cc Solo engine with Nikasil<sup>®</sup> cylinder coating.
- Extra-large polymer impeller produces high air volume at a lower RPM, reducing fuel consumption and noise level.
- 3 gal translucent formula tank.
- Single, multi-function operating handle with lockable throttle lever.

### BACKPACK AIR BLOWER

The quietest backpack blowers in the industry. Designed specifically for large jobs. Quickly and easily blow leaves, trash, and other debris in warehouses, stadiums, and other large areas.

- Powerful 66.5 cc engine with Nikasil<sup>®</sup> cylinder coating to generate a fan air volume of max. 824 cfm.
- Aluminum crankcase and high quality engine components for increased power output.
- Quiet! Low dB(A) rating.
- Single, multi-function operating handle with lockable throttle lever.



### MOTORIZED BACKPACK SPRAYER

Can reach extremely high operating pressures and achieve fine mist application even at extreme distances.\*

- 5 gallon UV-resistant HDPE tank.
- Four-stroke 25 cc Honda<sup>®</sup> engine.
- Pressure gauge for monitoring pressure levels.
- Minimum spray pressure of 14.5 psi; maximum of 435 psi for a wide range of applications.
- Electronic ignition and anti-vibe system.



\* requires optional spray wand (part # 4900185)

Model #	UPC # 720 343	Bat. / Engine	Displacement	Power	Capacity	Weight	Carton Size	Cubic Feet
451	45100 9	2-cycle	66.5 cc	2.1 / 2.9 hp	3 gal	23.8 lbs	30" x 22.75" x 12"	4.74
467	46700 0	2-cycle	66.5 cc	2.1 / 2.9 hp	N/A	22.5 lbs	23.5" x 19" x 12"	3.10
433	43333 3	4-cycle	25 cc	1 hp	5.3 gal	20.5 lbs	16" x 13.5" x 25"	3.13

## BATTERY-POWERED BACKPACK SPRAYERS

Designed for a variety of spraying tasks, including enclosed spaces such as greenhouses and office buildings when extended spraying applications are required. Ideal for spraying pesticides, herbicides, and for general spraying. These battery-powered backpack sprayers are free of emissions and are whisper quiet.

### 416-Li PROFESSIONAL SPRAYER

- Impressive spray performance with 12 V pump.
- Maintenance free 11 V 7.8Ah lithium-ion battery, fully charges in 5.5 hours.
- 5 gal translucent formula tank.
- Pressure gauge allows easy monitoring of pressure level.
- Adjust pressure and output volume with two-step toggle switch.
- 36" telescopic carbon fiber wand.

### 417 ECONOMY SPRAYER

- Impressive spray performance with 12 V pump.
- Maintenance free 12 V lead-gel battery, fully charges in 5 hours.
- 6.6 Gal translucent formula tank.
- Adjust pressure and output volume with two-step toggle switch.
- Standard straps.



417

416-Li



## CUT-OFF SAWS

880/881 cut-off saws lead the competition with the Auto-choke, the innovative multi-stage air filter system with patented twin-pipe-interceptor, and the iLube® intelligent lubrication system (Model 881).



- World's first Intelligent Lubrication system (iLube®). Oil is metered to the fuel by an electronically-controlled pump (881).
- SOLO high performance 81 cc engine is equipped with a Nikasil®-coated cylinder and 2-ring piston.
- Ergonomic advantages: optimum weight distribution, compact design, anti-vibration system with steel springs, rubber covered handles, tank caps with protection against over-tightening (green: oil tank on model 881).
- Electronic ignition system with auto choke.
- Equipped for wet cutting with water hose adapter or optional water trolley (part # 8000150).
- Decompression valve for easier cold starts.

Model #	UPC # 720 343	Bat. / Engine	Displacement	Power	Capacity	Weight	Carton Size	Cubic Feet
416-Li	41601 5	12V	N/A	7.8 Ah	5 gal	14 lbs	28" x 16" x 11.75"	3.05
417	41700 5	12V	N/A	9.2 Ah	6.6 gal	17 lbs	25" x 17.5" x 11.5"	2.90
880-12	88012 0	Solo 2-cycle	4.94 cu / 81 cc	5.44 HP / 4.0 kW	N/A	22.26 lbs	29" x 11" x 17"	3.14
880-14	88014 4	Solo 2-cycle	4.94 cu / 81 cc	5.44 HP / 4.0 kW	N/A	22.49 lbs	29" x 11" x 17"	3.14
881-12	88112 7	Solo 2-cycle	4.94 cu / 81 cc	5.44 HP / 4.0 kW	N/A	22.92 lbs	29" x 11" x 17"	3.14
881-14	88114 1	Solo 2-cycle	4.94 cu / 81 cc	5.44 HP / 4.0 kW	N/A	23.15 lbs	29" x 11" x 17"	3.14



# ACCESSORIES AND PARTS KITS

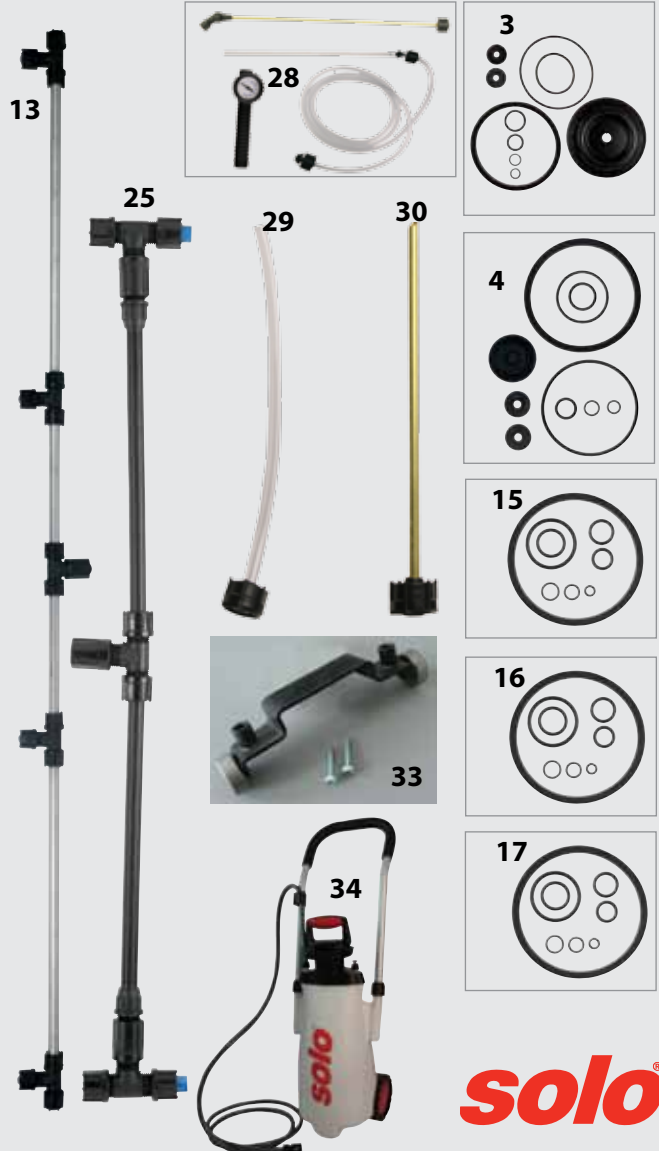

#	Part #	Description	Fits
1	8956-N	21" Universal Wand Assembly	All
2	42047	Telescoping Tube	419, 420
3	0610406-K	Diaphragm Pump Repair Kit	475, 485, 473-D, 473-ECS
4	0610407-K	Piston Pump Repair Kit	425, 435, 473-P
5	0610410-P	Brass Adjustable Nozzle Kit	All except 405-N & SLC series
6	0610456-P	Nozzle Assortment	All except 405-N & SLC series
7	2700316	No-drip-check Valve	All except 405-N & SLC series
8	4074654	1/4" and 3/8" Hose Barb	For 4800170
9	4074666-P	Multi-pattern "Speed Tip" Nozzle	All except 405-N & SLC series
10	4800170-P	Shut-off Valve	All except 405-N & SLC series
11	4900110	Snap on Wheels	456, 457
12	4900170N	28" Universal Wand Assembly	All
13	4900299	4-Nozzle Spray Boom	All except 405-N & SLC series
14	4900622	Pressure Gauge	All except 405-N & SLC series
15	4900405-K	Pump Repair Kit	454, 456, 457
16	4900406-K	Pump Repair Kit, EPDM	487-CI
17	4900407-K	Pump Repair Kit, Viton®	454-HD, 456-HD, 457-HD, 407-CI
18	4900421	20" Brass Wand	All except 405-N & SLC series
19	4900445	47"-90" Telescoping Spray Wand	All except 405-N & SLC series
20	4900449	48" Spray Wand	All except 405-N & SLC series
21	4300343	Deluxe Shoulder Saver Harness	425, 473-P, 473-D, 435, 475, 485
22	4900477	Double Spray Nozzle	All except 405-N & SLC series
23	4900478	20"-40" Brass Telescoping Wand	All except 405-N & SLC series
24	4900513	20" Extension Tube	All except 405-N & SLC series
25	4900514	2-Nozzle Spray Boom	All except 405-N & SLC series
26	4900527	Plastic Adjustable Nozzle	All except 405-N & SLC series
27	4900528	60" Brass Wand	All except 405-N & SLC series
28	4900642	Foamer Conversion Kit	456, 457
29	4900643	Flexible Wall Void Adapter	456-F, 457-F
30	4900644	Foam Injector	456-F, 457-F
31	4900645-P	21" Stainless Steel Wand	All except 405-N & SLC series
32	4900647-P	29" Universal Stainless Wand Assembly	All
33	29000108	Wheel Set for Cut-off Saws	880-12, 880-14, 881-12, 881-14
34	8000150	Water Tank for Cut-off Saws	880-12, 880-14, 881-12, 881-14



5100 Chestnut Ave. Phone: (757) 245-4228 Order Desk Phone: (757) 245-5531  
 Newport News, VA 23605 Fax: (757) 245-0800  
 www.SoloUSA.com