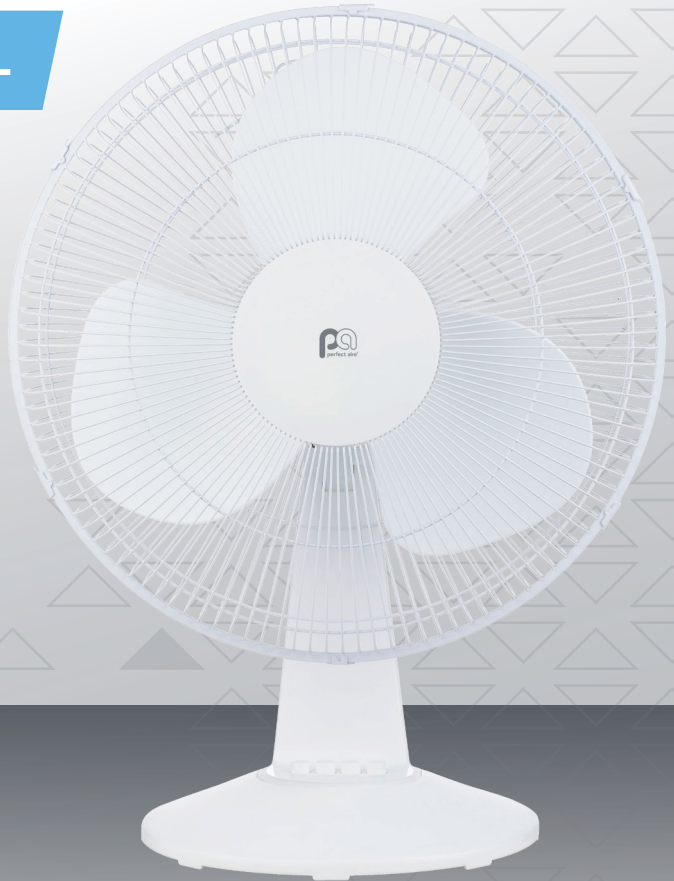



TABLE FAN

USER MANUAL

FOR MODEL:
1PAFD16



Before using your fan, please read this manual carefully and keep it for future reference, along with your receipt.

SAFETY GUIDELINES

When using any electrical appliances, basic safety precautions should always be followed. Failure to follow these safety guidelines may result in personal injury, property damage, fire or shock.

WARNING

1. Do not use this fan with any solid state speed control device.
2. This unit has a polarized plug (one blade is wider than the other). To reduce the risk of electric shock, this plug is intended to fit in a polarized outlet only one way. If the plug does not fit into the outlet, reverse the plug. If it still does not fit, contact a qualified electrician. Do not attempt to bypass this safety feature.
3. Use only a dedicated, grounded 115-120V AC outlet, making sure the unit is plugged in firmly and completely. Plug and unplug the unit with dry hands only.
4. This fan is not intended to be used by children or persons with reduced physical, sensory or mental capabilities, without adult instruction or supervision.
5. Do not leave the fan running unattended.

IMPORTANT SAFETY INFORMATION

1. Important information about the cord and plug below:
 - (1) This fan employs an overload protection fuse in the plug. A blown fuse indicates an overload or short-circuit. If the fuse blows, unplug the fan from the outlet. Replace the fuse according to the User Servicing Instructions (on page 3), plug the unit back in and turn it on. If the fuse blows again, the fan may have a short-circuit; leave it unplugged and contact Customer Service.
 - (2) Check the power cord and plug for damage. If the cord or plug are damaged, contact Customer Service before using the unit.
 - (3) Do not cover the cord with carpeting, throw rugs, runners, or similar coverings. Do not run the cord under furniture or appliances. Keep the cord away from any areas where it can be stepped on or tripped over.
2. The fan should only be operated under the rated voltage.
3. The fan must be fully assembled before plugging it into the wall outlet.
4. Never insert fingers, pencils, or any other objects through the guard when the fan is running.
5. Unplug the fan when moving it from one place to another, before removing the guards for cleaning, and when it's not in use.
6. Position the fan on a stable, level surface to avoid overturning during operation.
7. Do not use the fan in window; rain may create an electric shock hazard.

SAVE THESE INSTRUCTIONS FOR FUTURE REFERENCE

ASSEMBLY INSTRUCTIONS

■ PARTS DIAGRAM

Front Guard

Rear Guard

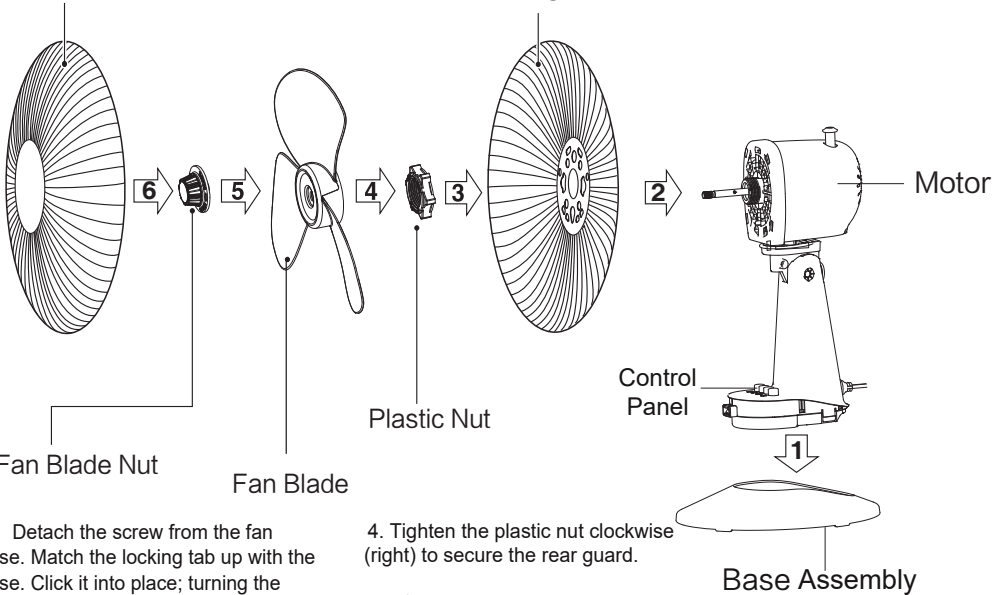

1. Detach the screw from the fan base. Match the locking tab up with the base. Click it into place; turning the screw to secure the fan to the base.

2. Turn the plastic nut counterclockwise (left) to remove it.

3. Put the rear guard into position with the handle up.

4. Tighten the plastic nut clockwise (right) to secure the rear guard.

5. After installing the Fan Blade, turn it by hand to endure normal movement.

6. Tighten the Fan blade Nut by turning it counterclockwise. Then install the Front Guard as instructed.

Front and Rear Guard Installation

1. Place the Front Guard upright, with the Positioning Clip aligned with the Rear Guard as illustrated.

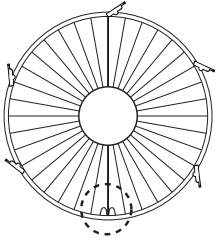

2. Press down all the Buckles to fasten the Front Guard to the Rear Guard.

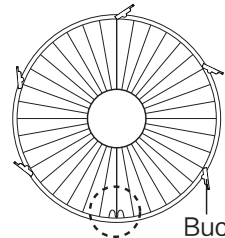
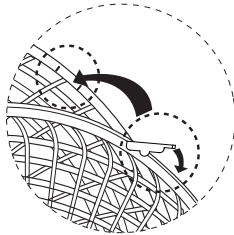

OPERATING INSTRUCTIONS

■ Fan Controls

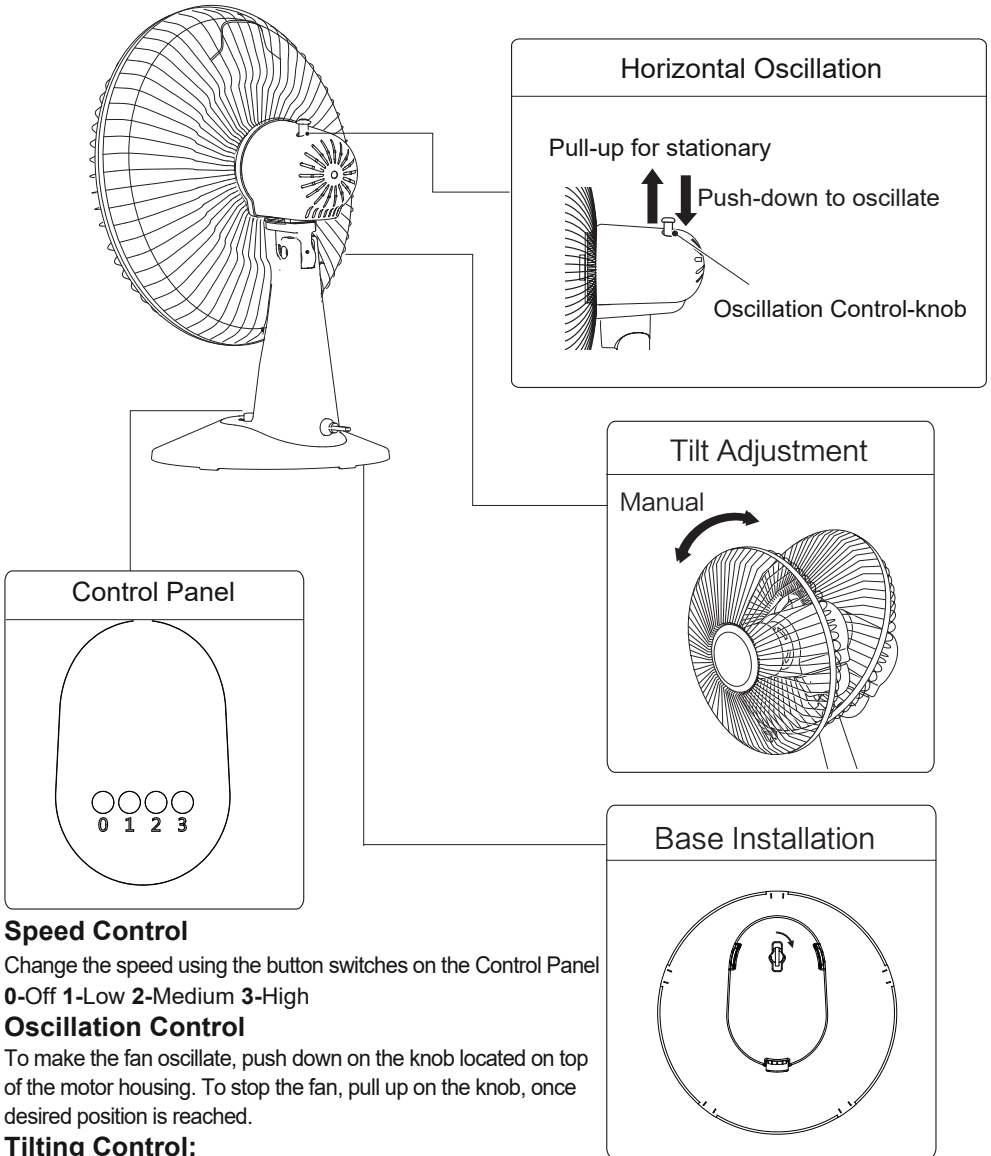

Speed Control

Change the speed using the button switches on the Control Panel
0-Off 1-Low 2-Medium 3-High

Oscillation Control

To make the fan oscillate, push down on the knob located on top of the motor housing. To stop the fan, pull up on the knob, once desired position is reached.

Tilting Control:

Tilt the fan head forward or backward to adjust the vertical angle of airflow.

USER SERVICING INSTRUCTIONS

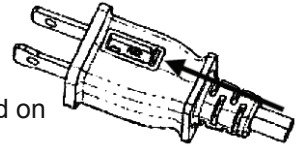

1. Grip the plug and remove from the outlet. Never pull on the cord to remove it.
2. Open the fuse cover by sliding the access cover found on top of the plug towards the blades.
3. Remove the fuse carefully by pushing the fuse from one side to the other, or turning the fuse holder over.
4. Risk of fire: Use only 2.5 Amp, 125 Volt fuses (provided) as replacements.
5. Close fuse cover by sliding the access cover on top of the plug to hide it.
6. Risk of fire: Do not replace the plug as it contains a safety device (fuse) that should not be removed. Contact customer service if the plug, or cord, is damaged.

- Notice:**
1. To avoid the risk of damage or personal injury, when replacing a fuse, don't plug in or turn on the unit until the access cover has been closed.
 2. If you're unable to insert the fuse into the plug, make sure it's being inserted the correct way.

MAINTENANCE INSTRUCTIONS

The fan contains no serviceable parts. To reduce the risk of electrical shock, do not attempt to open the motor.

1. Before cleaning and assembling, make sure fan is unplugged.
2. To ensure adequate air flow to the motor, keep the vents on the motor housing free from dust, dander, etc. Once unplugged, use a vacuum to clean these vents. Do not disassemble the fan to remove any dust.
3. Clean the outer surfaces using a mild detergent with a soft cloth. Avoid abrasive detergent or solvents to avoid damage to the surface. Do not use the following as cleansers: gasoline, alcohol, thinner.
4. Do not allow water or other liquids to get into the motor housing or interior parts.

CLEANING

1. Before cleaning and assembling, make sure the fan is unplugged
2. Clean plastic parts with mild soap and water using a soft cloth or sponge, gently removing all soap film with clean water.
3. Do not allow water or other liquids to get inside the motor.
4. Dry all parts completely before reassembling the fan and plugging it back in.

SERVICE & SUPPORT

In the event of a warranty claim or if service is required for this product, please contact us at:

Toll Free: 844-4PA-AIRE / 844-472-2473

Email us at: support@perfectaire.us

For questions or comments, please write to:

Perfect Aire

Customer Care Center

5401 Dansher Rd

Countryside, IL 60525

For your records, staple your sales receipt to this manual and record the following:

DATE OF PURCHASE: _____

PLACE OF PURCHASE: _____

(STAPLE SALES RECEIPT HERE)

**NOTE: PROOF OF PURCHASE IS REQUIRED FOR ALL
WARRANTY CLAIMS
PRINTED IN CHINA**

Distributed by:



Perfect Aire, LLC
5401 Dansher Rd.
Countryside, IL 60525

844-4PA-AIRE | 844-472-2473
www.perfectaire.us

PA/User_1PAFD16/05222020

Specification and performance data is subject to change without notice.

Printed in China