



ULTRASONIC COOL MIST HUMIDIFIER

USER MANUAL

FOR MODEL:
PAU132



Before using your ultrasonic humidifier, please read this manual carefully and keep it for future reference, along with your receipt.

Product Introduction

Note

- The pictures of the Manual are for reference only, and the actual product in the packing box shall prevail

Name of Parts

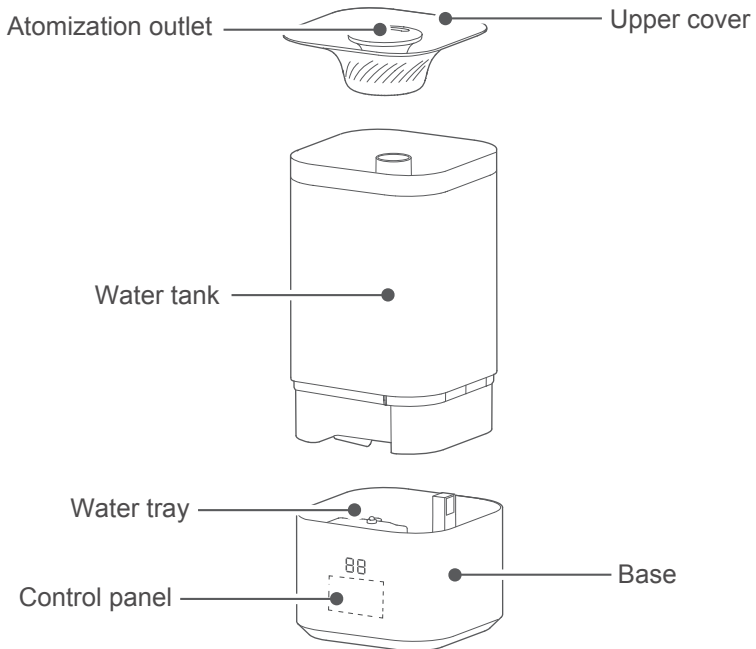

A list of Accessories









Manual×1

Control Panel



The current environmental humidity is displayed by default
Humidity value
Unit: %RH

Buttons	Function description
 On/Off button	After power up, the appliance can be set to be on/idle. Under normal working conditions short press to enter the idle status.
 Atomization adjustment	Under working conditions, the humilation and atomization amount can be set to three levels (small, medium and large)
 Lamp control	Short press this button while the appliance is working, to switch the light switch.
 Timing button	Under working conditions, the timed shutdown can be set at 1H, 2H, 4H and 8H. Flash three times, which indicates successful timing.
 Humidity setting	The humidity value can be set from 40% to 60%. After the maximum value is achieved, press this button again to display F (indicating continuous humidification). Press this button again to recover to 40%.
 Sleep mode	When the sleep mode is activated, the atmosphere lamp is automatically turned off. In sleep mode, press the sleep mode button to exit the sleep mode.

Instruction for Use

⚠ Notes

- Please be sure to unplug the power cord before filling water.
- The level of the water added shall not be higher than the highest water level;
- Please be not to add the water in the atomization outlet when the water is added;
- Please be not to lift the transparent part of the upper end of the water tank by hands when the water is added;
- Please do not add additives like essential oil, perfume, drug, etc. to the water. But you can add aromatherapy liquid in the built-in aromatherapy box.
- Please use the purified water below 104°F (40°C) (Do not use distilled water).

Water Filling (Three Methods)

- 1 Fill the water tank directly through the water filling inlet;

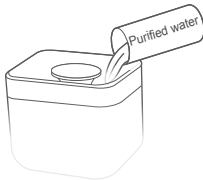

- 2 Remove the upper cover and fill the water tank;

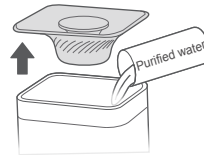

- 3 Remove the upper cover, hold the water tank with both hands and take it out, and place the water tank under the faucet to add water;

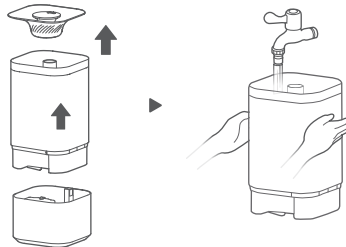

Installation of the water tank

If the third method is used to add water, when the water tank is installed back to the base, the LOGO side of the water tank faces toward the same side as the control panel.

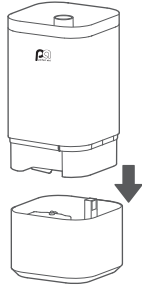

Atomizing direction adjustment

The atomization outlet can be rotated by 360°, which can be adjusted according to your own needs, so that atomizing direction satisfies your needs.

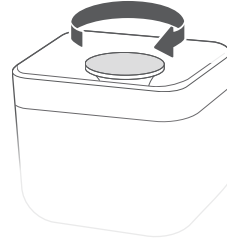

Cleaning and Maintenance

△ Notes

- Please be sure to unplug the power cord before cleaning.
Please be sure to remove scale and debris in the humidifier tank regularly, and it is recommended to clean it once every 2~3 weeks.

Water tank cleaning

Wipe the tank directly with a clean, soft wet cloth.



Water tray and atomizer cleaning

Add detergent or water to clean, and then rinse thoroughly after cleaning.

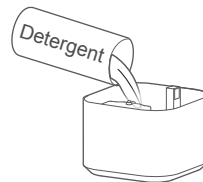

Aromatherapy Cotton Cleaning

Take the aromatherapy cotton out the aromatherapy box, wash it with water and dry it.

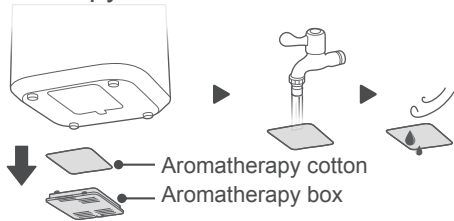

Aromatherapy Box Cleaning

Wash the aromatherapy box with clean water and dry it.



Product Parameters

⚠ Notes

- The following are the design parameters of PAU132. The measured parameters are subject to the product; The humidification amount will vary, depending on the temperature and humidity in the room. Actual humidification amount is no less than 90% of the standard 210 ml/h.

Model	PAU132
Rated voltage (v~)	120
Rated frequency (Hz)	60
Rated power (W)	26
Rated humilation amount (mL/h)	210
Noise dB(A)	38
Volume of water tank (L)	5
Net product weight (kg)	1.55

Service Guide

Fault Handling

Notes

If the humidifier does not work properly after the following treatments, please contact the customer service center or local service station.

Fault phenomenon	Possible causes	Handling method
The humidifier does not work	The power plug is not plugged well	The power plug is plugged well
	There is no water in the water tank	The water is added to the tank
	The water tank is not in place	The water tank is fastened in place
The atomized water is smelly	The water is dirty or storage duration is too long	The clean water is refilled, or the water tank and water tray are cleaned
The humidifying effects are not ideal.	The air inlet filter is blocked by dust	Clean the filter screen
There is abnormal noise	The appliance is not in place, tilted or unstable	The appliance is placed on a solid surface or a flat place
The water tank shows water shortage, but is filled with water; the humidifier does not work for a long time.	Excessive tilting of the appliance at an angle causes the water level in the water tank to be judged as low water level, so the appliance automatically starts protection mode and stops.	The appliance is put on a flat and firm place, and kept steady
The display screen shows "--"	The water tank is short of water and the water in the tank is flowing to the water tray	It does not need to be handled
The display screen shows "P1"	The water tank is short of water	The water is added to the tank

Safety Warning

Safety Precautions

- In the case of power up, do not plug or unplug the power cord with wet hands to avoid electric shock;
- Do not force the water tank to work in the case of no water;
- Do not add any additives not produced or supervised by the company to the water tank;
- Do not put or place anything or pets into the water tank;
- Do not add water to the atomization outlet;
- When the humidifier is working, do not touch the water in the water tray or the parts sank in the water;
- Do not cover the atomization outlet, and please keep it clear above the outlet;
- Do not replace the power cord without authorization, or connect the power cord halfway or use other appliances in parallel;
- Do not place the appliance near water source;
- Do not disassemble, modify or repair internal parts without authorization;
- Do not climb or sit on the appliance;
- Do store flammable or explosive materials around the humidifier. Do not place it near heat source;
- Do not directly flush the humidifier with water;
- Do not turn off the humidifier by unplugging the power cord directly.

Matters that may cause minor injury or property damage

- Please use purified water for humidification;
- Please do not use a damaged or worn power cord; Do not replace the power cord without authorization. If the power cord is damaged, it must be replaced by the manufacturer, its service department or professional from similar department to avoid danger.
- The power must be cut off in thunderstorm;
- When an abnormal phenomenon (like a burnt smell) occurs, the operation must be stopped and the power supply is cut off.
- Please unplug the power cord and clean the water tank, when the appliance is not used for a long time;
- This appliance has aromatherapy function. If it is not used for a long time, you should first clean the aromatherapy cotton in the aromatherapy box and add a new aromatherapy liquid;
- To avoid bacterial growth, please always change the water in the water tank and the water in the water tray;
- When the appliance is moved, please unplug the power cord to keep the water tank stable and to prevent the water from overflowing in the water tank;
- If the appliance is tilted when filled with water, be sure to unplug the power cord immediately and send it for inspection.
- Suitable temperature for this product: 41°F-104°F(5°C-40°C); relative humidity: less than 80% RH (please fill purified water with water temperature below 104°F (40°C))



Distributed by:



Perfect Aire, LLC
5401 Dansher Rd.
Countryside, IL 60525

844-4PA-AIRE | 844-472-2473
www.perfectaire.us

PA/User_PAU132/06032019

Specification and performance data is subject to change without notice.

Printed in China