

Service Manual

Ventilating Fan
(North America Market)

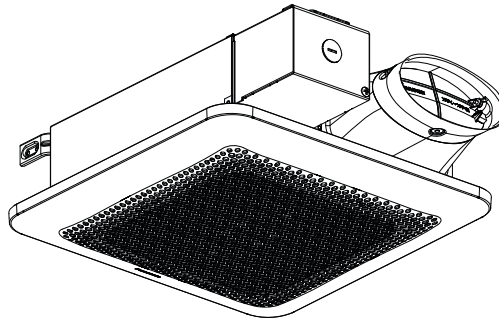

RG-T810A

⚠ WARNING

This service information is designed for experienced repair technicians only and is not designed for use by the general public. It does not contain warnings or cautions to advise non-technical individuals of potential dangers in attempting to service a product. Products powered by electricity should be serviced or repaired only by experienced professional technicians. Any attempt to service or repair the product or products dealt with in this service information by anyone else could result in serious injury or death.

IMPORTANT SAFETY NOTICE

There are special components used in this equipment which are important for safety. These parts are marked by ⚠ in the Schematic Diagrams, Exploded Views and Replacement Parts List. It is essential that these critical parts should be replaced with manufacturer's specified parts to prevent shock, fire or other hazards. Do not modify the original design without permission of manufacture.
We suggest to handle such parts after the static electricity prevention.
It is forbidden to touch the PCB parts by bare hands during the repairing process.

CONTENTS	PAGE
1.Specifications-----	1
2.Parts Identification-----	2~4
3.Wiring Diagram-----	5
4.Parts List-----	6, 7

1. Specifications

Model No.	Air direction	Voltage (V)	Frequency (Hz)	Duct diameter (inches)	Air volume (CFM)	Noise (sones)	Speed (rpm)	Power (W)	Weight lb (kg)
RG-T810A	Exhaust	120	60	4	80	0.5	881	8.9	7.9 (3.6)
					100	1.1	993	13.2	

HVI Certified performance based on HVI Procedures 915, 916, and 920, at 0.1" WG.

2. Parts Identification

RG-T810A

Main Body Section

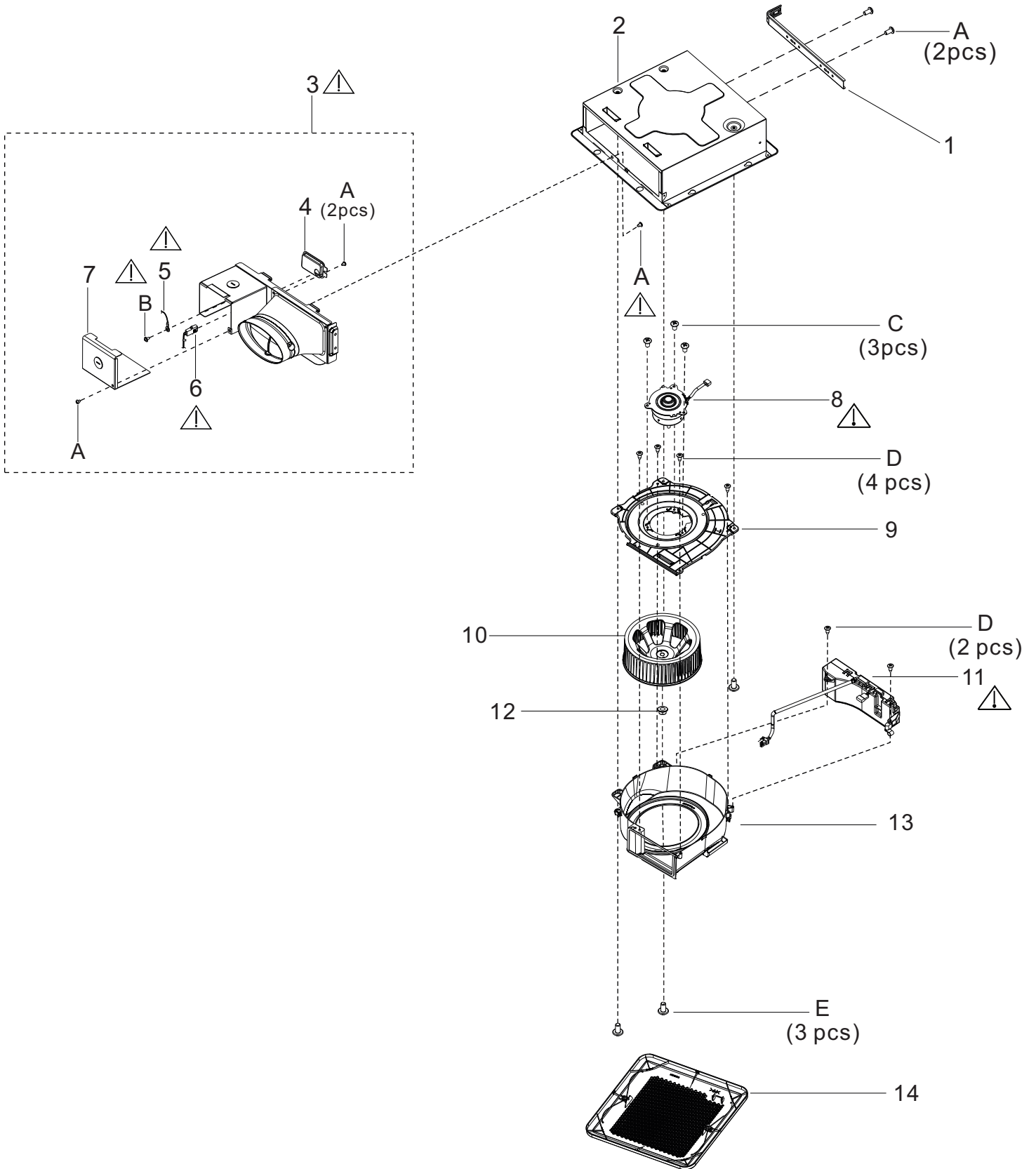

2. Parts Identification

RG-T810A

Main PCB Section

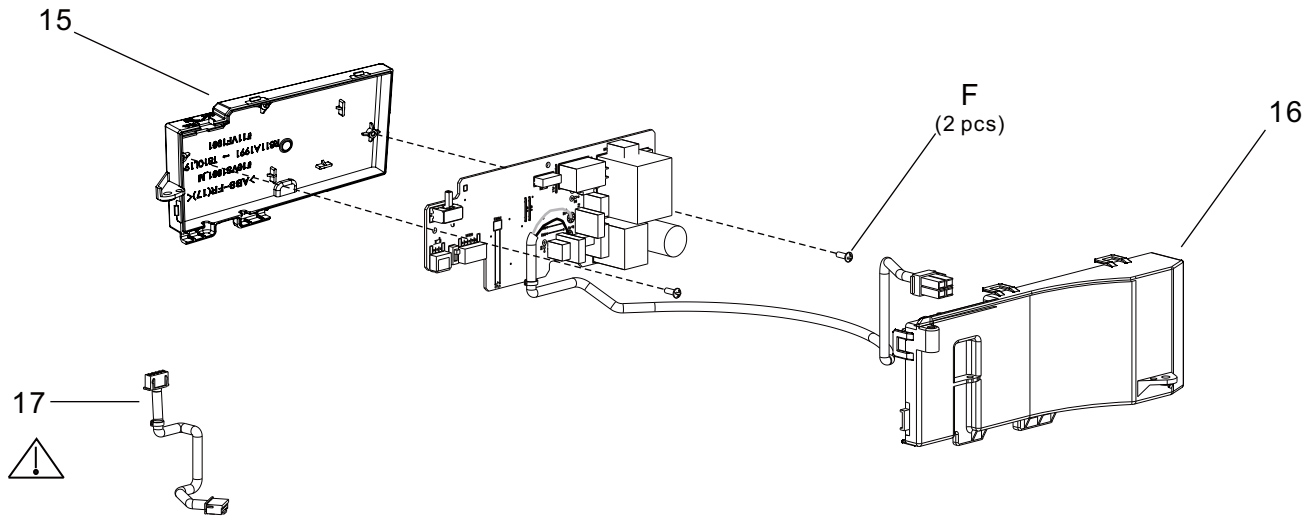

Main Labels

Panasonic Ventilating Fan

Model No. **RG-T810A** (M)
 AC 120 V 60 Hz
 0.39 A

Lot No. _____

	CFM	Sones	CFM	Sones
0.1" SP	100	1.1	80	0.5

Panasonic Corporation of North America
 Assembled in Mexico

18

ATTENTION

Circuit board assembly inside, do not drill the can/housing. For details, please refer to installation instructions.

ATTENTION

Carte de circuit imprimé à l'intérieur, ne percez pas le boîtier. Pour plus de détails, consultez les instructions d'installation.

19

E78414

LISTED FAN

21

TESTED/CERTIFIED
2100
 Home Ventilating Institute

ENERGY STAR

Not for use in cooking area-See installation instructions./Non destiné à la zone de cuisson-Voir instructions d'installation./No usar en áreas donde se cocina - Consulte las instrucciones de instalación.

20

2. Parts Identification

RG-T810A

Packing Section

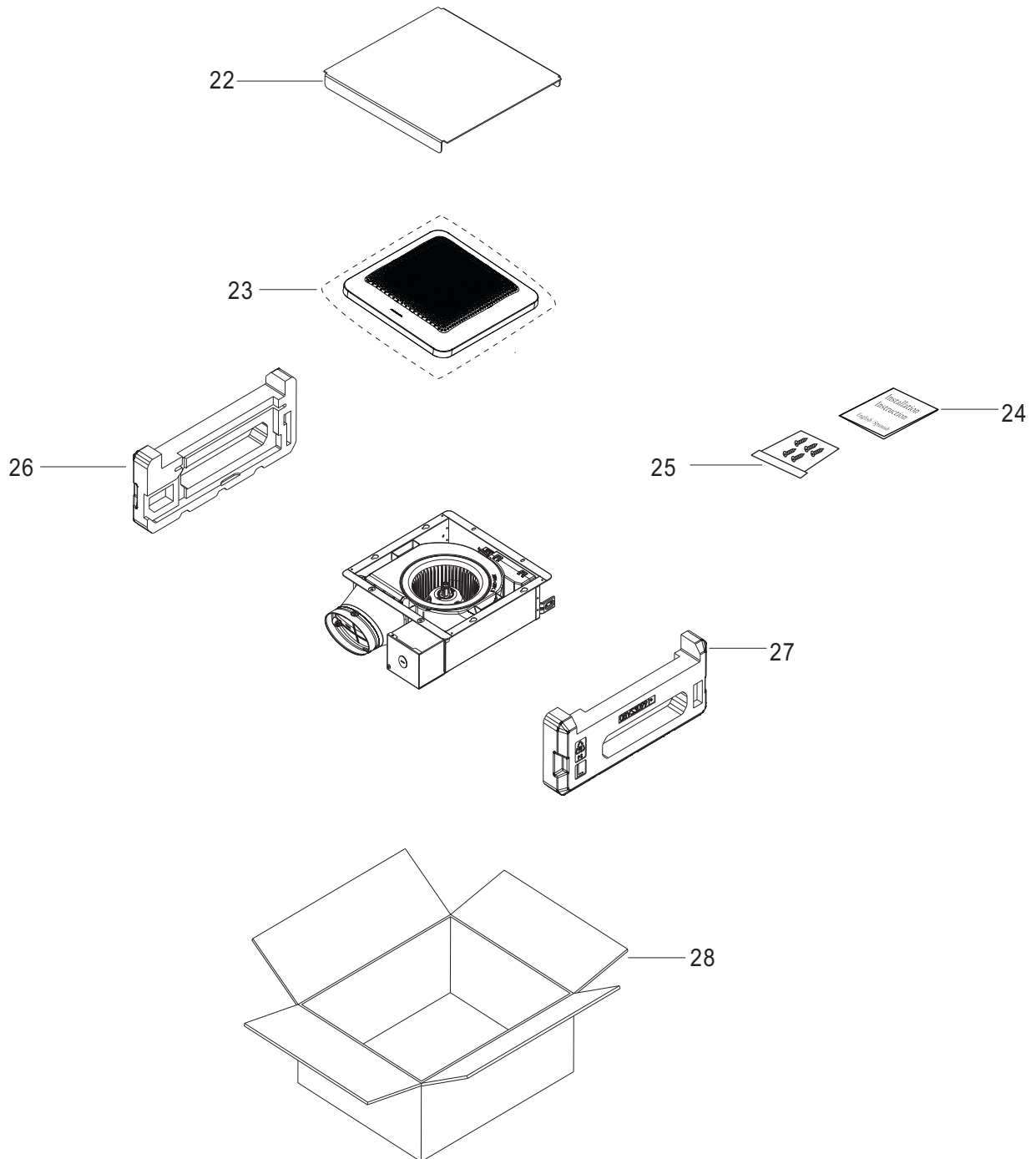

3. Wiring Diagram



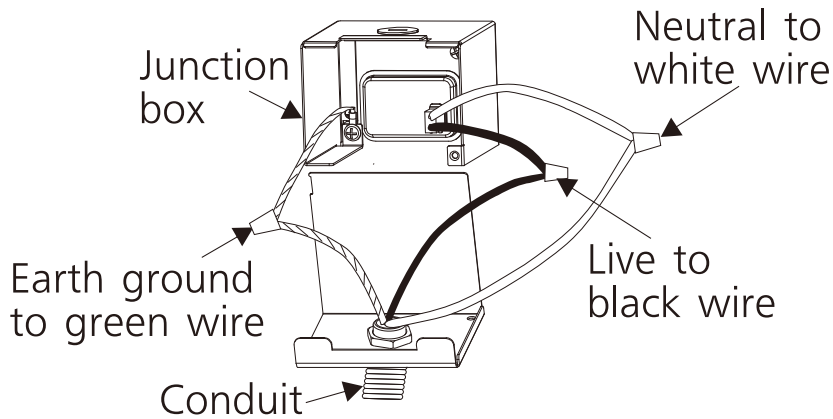
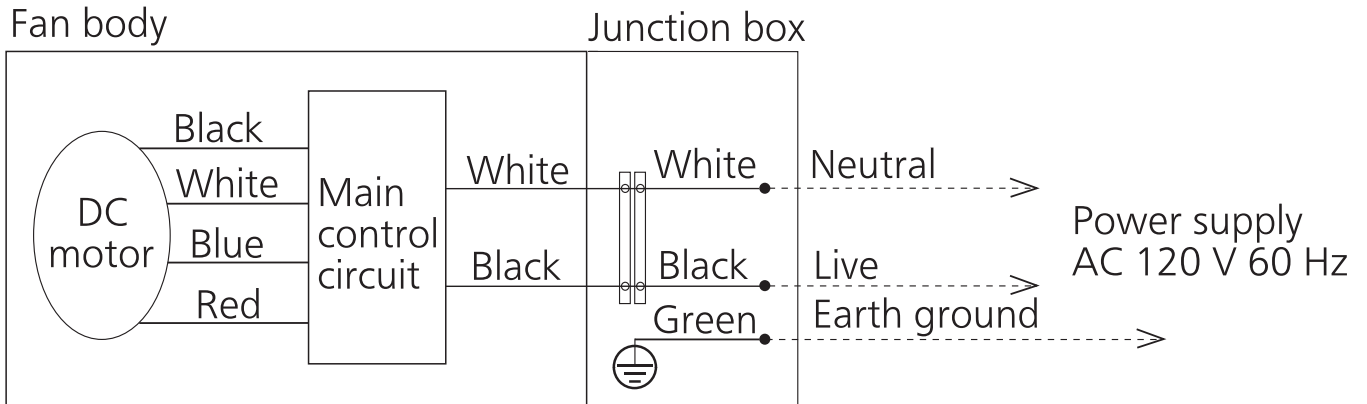
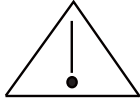



RG-T810A



4. Parts List

RG-T810A

Main Body Section

No.	Part No.	Part Name	Q'ty	Remark
1	FFV5710025S	Suspension Bracket	1	
2	FFV1600159S	Frame Assy	1	
3	FFV0000166S	Adapter Assy	1	
4	FFV0900052S	Connector Plate	1	
5	FFV3450010S	Ground Wire	1	
6	FFV0900072S	Connector Assy(V)	1	
7	FFV2800020S	Junction Cover	1	
8	FFV10VS1M2	Motor Assy	1	
9	FFV510VS19	Motor Support	1	
10	FFV510VS18	Blade	1	
11	FFV0810RS2	Main PCB Assy	1	
12	FFV7020021S	Nut	1	
13	FFV510VS10	Casing	1	
14	FFV1315A810	Grill Assembly	1	
A	FFV7000108S	Truss Tap Screw	5	
B	FFV7000227S	Earth Screw Assy	1	
C	FFVXTT48GFJ	Bind Tap Screw	3	
D	FFVXTT412GFJ	Bind Tap Screw	6	
E	FFV7000202S	Bind Tap Screw	3	

Main PCB Section

No.	Part No.	Part Name	Q'ty	Remark
15	FFVT810L199	Main PCB Box	1	
16	FFV510VS1992	Main PCB Cover	1	
17	FFV510VS112	Motor Lead Wire	1	
F	FFVXTN268GFJ	Screw	1	

4. Parts List

RG-T810A

Main Labels

No.	Part No.	Part Name	Q'ty	Remark
18	FFVT810A105	Name Plate	1	
19	FFV6730110S	Warning Label	1	
20	FFV0810011S	Caution Label 1	1	
21	FFV2260003S	UL Mark	1	

Packing Section

No.	Part No.	Part Name	Q'ty	Remark
22	FFV4710381S	Louver Case Assy	1	
23	FFV4650016S	Poly Cover	1	
24	FFVT810A14	Installation Instructions (ES)	1	
25	FFV0010231S	Accessory A	1	
26	FFV4710369S	Right Pad	1	
27	FFV4710370S	Left Pad	1	
28	FFVT810A140	Packing Case Assy	1	