

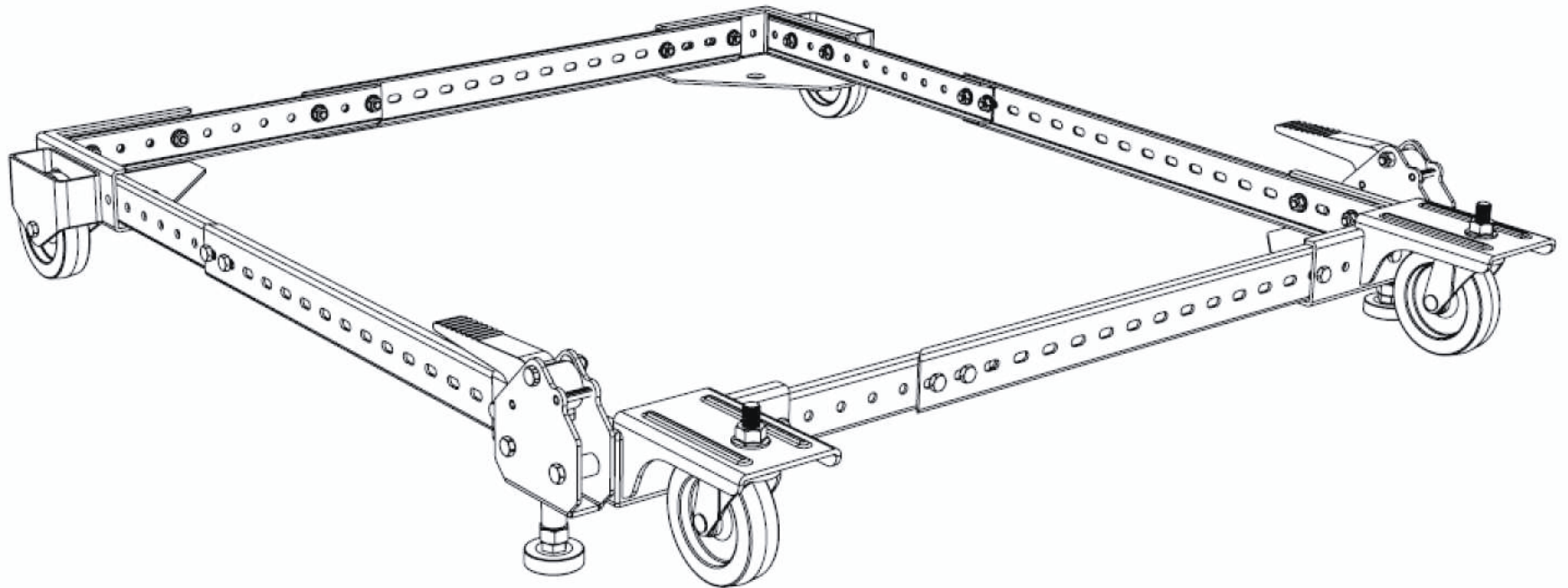

# PROTOCOL™

## PRODUCT MANUAL UNIVERSAL ROLLING BASE



TO REDUCE THE RISK OF INJURY, USER MUST READ AND UNDERSTAND OPERATOR'S MANUAL. SAVE THESE INSTRUCTIONS FOR FUTURE REFERENCE.

## **SAFETY WARNING**

**WARNING:** Be sure to read and understand all safety instructions in this manual, including all safety alert symbols such as “DANGER”, “WARNING” and “CAUTION”, before using this power tool accessory. Failure to follow all instructions listed in the manual may result in electric shock, fire and/or serious personal injury.

## **GENERAL SAFETY INSTRUCTIONS**

Using power tools of any kind can be dangerous if safe operating procedures are not followed. Recognizing the hazards of each tool and using them with the respect and caution considerably limit the possibility of personal injury. However, if safety precautions are ignored, personal injury will likely result. Always use common sense – your personal safety is your responsibility.

1. Know your power tool. Read and understand the Operator's Manual and observe the warnings and instruction labels affixed to the tool.
2. Remove adjusting keys and wrenches.
3. Keep work area clean and dry.
4. Keep children away.
5. Wear safety glasses/goggles.
6. Never stand or sit on tools.
7. Replace damaged components immediately.
8. Make sure your work platform is sufficiently sturdy to do the specific job at hand.

## **SAFETY INSTRUCTIONS FOR MOBILE BASES**

1. Place base on a level surface and adjust levelers before placing the machine in position.
2. Test for stability in both the down (on the casters) and the up positions. Use caution when testing the stability of top heavy machines.

3. Unplug any power tool before moving your tool.
4. Always test your set-up for stability after repositioning.
5. Care should be taken when planning the orientation of the machine onto the universal mobile base. Transfer of weight off of the levelers to the casters will result in the machine tilting 1/2" toward the fixed wheels. When positioning top heavy tools such as a drill press or band saw, take advantage of the center of gravity and position so that it will remain stable while on casters.
6. Always raise the machine onto the non-skid levelers before operating.
7. When moving, always push the base, not the machine.

## PARTS LIST

PART #	DESCRIPTION	QTY
1	Bracket A Right	1 set
2	Bracket A Left	1 pc
3	Bracket B Right	1 pc
4	Bracket B Left	1 pc
5	Long Bar	4 pcs
6	Shor Bar	4 pcs
7	Foot Housing	2 pcs
8	Cam Lock Lever	2 pcs
9	Wheel	2 pcs
10	Castor Wheel	2 pcs
11	Foot Pad Bolt	2 pcs
12	Foot Guide	2 pcs
13	Foot Spring	2 pcs
14	Spring Pin	4 pcs
15	Foot Bracket Spacer	4 pcs
16	Plastic Bushing Wheel	2 pcs
17	M6 x 12N General Purpose Nut	22 pcs
18	M6 x 40N Bolt for Cam Housing	4 pcs
19	M6 x 32N Bolt for Cam	2 pcs
20	M8 x 45N Hex Bolt Rear Wheel	2 pcs
21	M6 General Purpose Nut	26 pcs
22	M6 Washer for Cam	4 pcs
23	M10 - Nut for Caster	2 pcs
24	M10 - Nut for Foot Adjustment	2 pcs
25	M8 Lock Nut	2 pcs
26	M6 Lock Nut	2 pcs

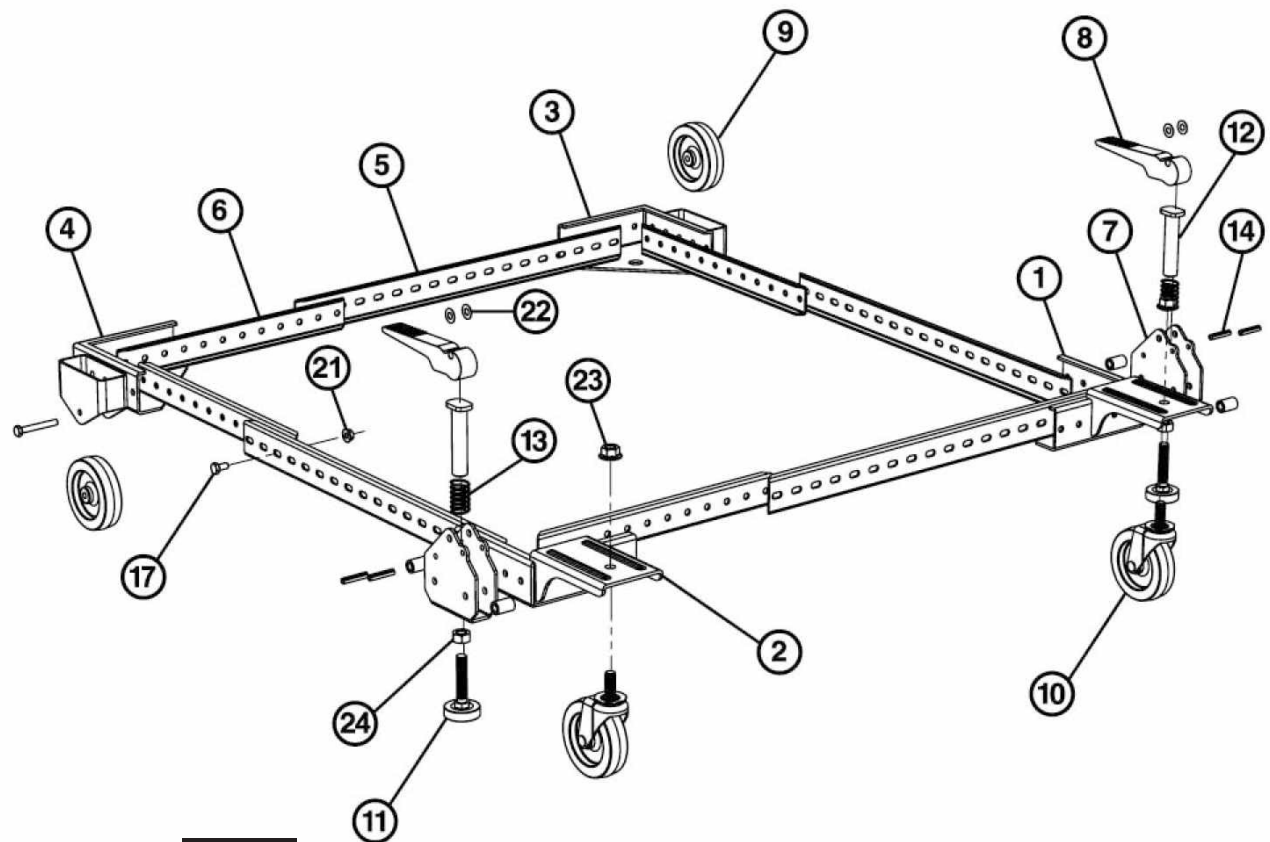

FIG 1

## ASSEMBLY INSTRUCTIONS

Read all assembly instructions completely before attempting assembly.

1. Unpack and identify all components and hardware. Make sure there are no missing parts and that there is no shipping damage.
2. Carefully measure the footprint of your machine (or whatever you are mobilizing) and add about 1" to the dimension.
3. Carefully review assembly examples shown to help you determine the fixed wheel, caster and leveler placement. You should determine what best suits your particular machine's requirements for stability.
4. Select and arrange the Corners and the Side Rails as necessary to assemble the base to your machine's requirements for safety.
5. Bolt the Side Rails to the corners and each other using these simple rules:
  - A. All connections require the use of (2) M6 x 12 bolts ⑰ and (2) M6 nuts 22at each end of the connections.
  - B. Position Side Rails into corners
  - C. It is recommended you keep your machine stand symmetrical by using the same size and positioning of the Side Rails on opposite sides. For maximum strength, use ⑤ Long Bar along the side whenever possible to connect the swivel corner to the rest of the base.

**NOTE:** INSERT BOLTS SO THAT THE NUTS ARE ON THE INSIDE OF THE MOBILE BASE.

6. Re-check dimensions, then tighten all bolts and nuts.

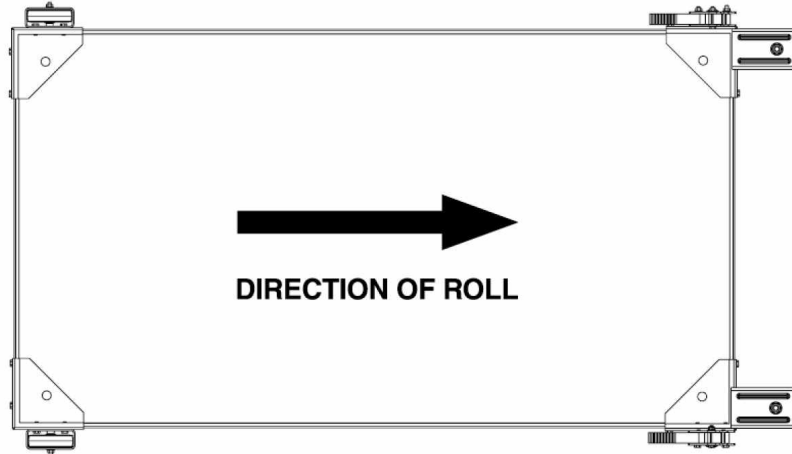

**FIG 2a**

A long, narrow base, such as on a jointer, would benefit from this arrangement. Most machines may be arranged to the convenience of the user.

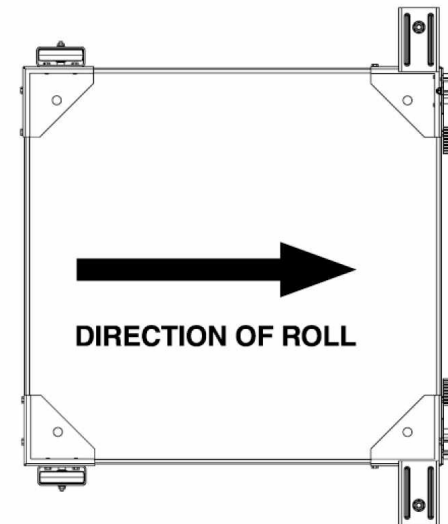

**FIG 2b**

A short narrow base, such as found on a drill press or bandsaw, may benefit from this arrangement. Due to swivel rotation base may sit out of level. Rotate swivel wheel away from base to correct.

## ASSEMBLY INSTRUCTIONS

Keep in mind the actual operation of your machine and the effect it has on overall stability. A short narrow base, such as that found on a drill press or band saw, may benefit from this arrangement. Due to swivel rotation, the base may sit out of level. Rotate swivel wheel away from base to correct.

## ATTACHING WHEELS AND CASTERS

1. Review the diagrams for wheel, caster, and leveler placement.
2. Attach Foot Housing Assembly (7) to the (1) Bracket A Right using (2) (18) M6 x 40N bolts and (2) (21) Nuts. Make sure (2) (15) Spacers are installed in the Housing assembly and that the (18) bolts pass through the Spacers. For proper orientation, refer to Figure 4.
3. Attach swivel caster (10) to Bracket A (2) using (1) (23) M10 nut.
4. Spin one (24) M10 nut onto the top of the threaded rubber foot (11). Insert threaded rubber foot (11) into the threaded hole on the bottom of (7) Foot housing assembly.
5. Repeat steps 1 through 4 on the Bracket A Left (2).
6. Slip wheel (9) into position on left and right corners ((3) and (4)). Refer to Figure 4.
7. Insert (20) M8 x 45 bolt through hole in the outer edge of wheel housing (4) through wheel (9), through nylon bushing (16), and secure to corner using (25) self-locking nut. Use care not to over tighten. Over tightening will prevent the wheel from turning.

**TIP:** INSERT EXTRA BOLT INTO THE AXLE HOLE FROM THE INSIDE OF THE CORNER. INSERT THE BOLT INTO THE WHEEL HOUSING JUST FAR ENOUGH TO ACT AS A GUIDE FOR THE NYLON WASHER. CAREFULLY ALIGN THE WHEEL AND INSTALL THE AXLE BOLT, PER ABOVE.

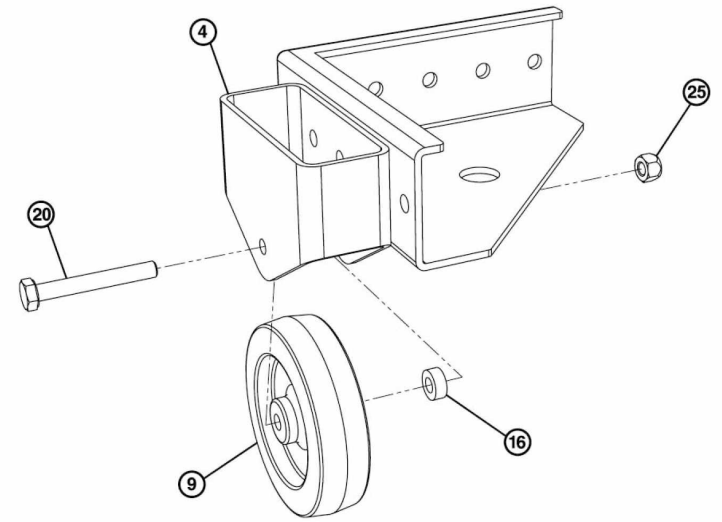

FIG 3

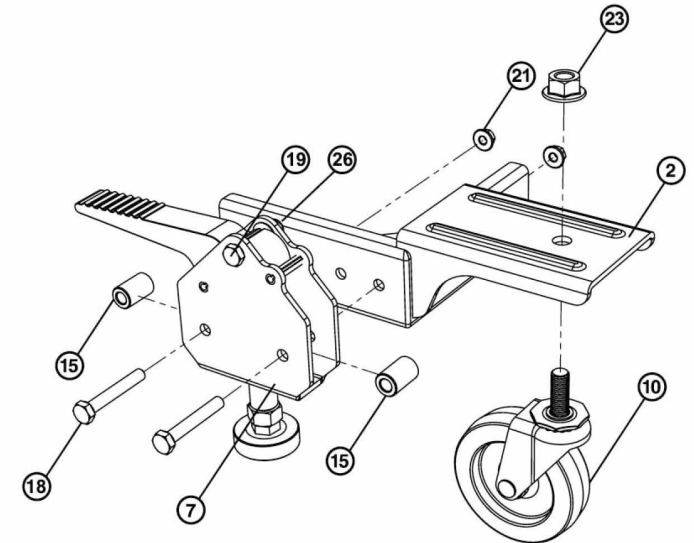

FIG 4

## MAINTENANCE

Avoid using solvents when cleaning. Most items are susceptible to damage from various types of commercial solvents. Use clean clothes to remove dirt, dust, oil, grease, etc.



## LIFETIME | LIMITED WARRANTY

PROTOCOL™ Universal Rolling Base is backed by a Limited Lifetime Warranty. This warranty covers manufacturer defects and workmanship. The warranty excludes misuse or abuse and normal wear and tear. Exclusion is not allowed in some states and may not apply. This warranty gives you specific legal rights, and you may have other rights, which vary from state to state.

JS PRODUCTS, INC. | 6445 MONTESSOURI STREET | LAS VEGAS, NV 89113  
800.255.7011 | FAX: 775.898.8773 | FOR MORE PRODUCTS AND ACCESSORIES GO TO [WWW.PROTOCOLEQUIPMENT.COM](http://WWW.PROTOCOLEQUIPMENT.COM)