

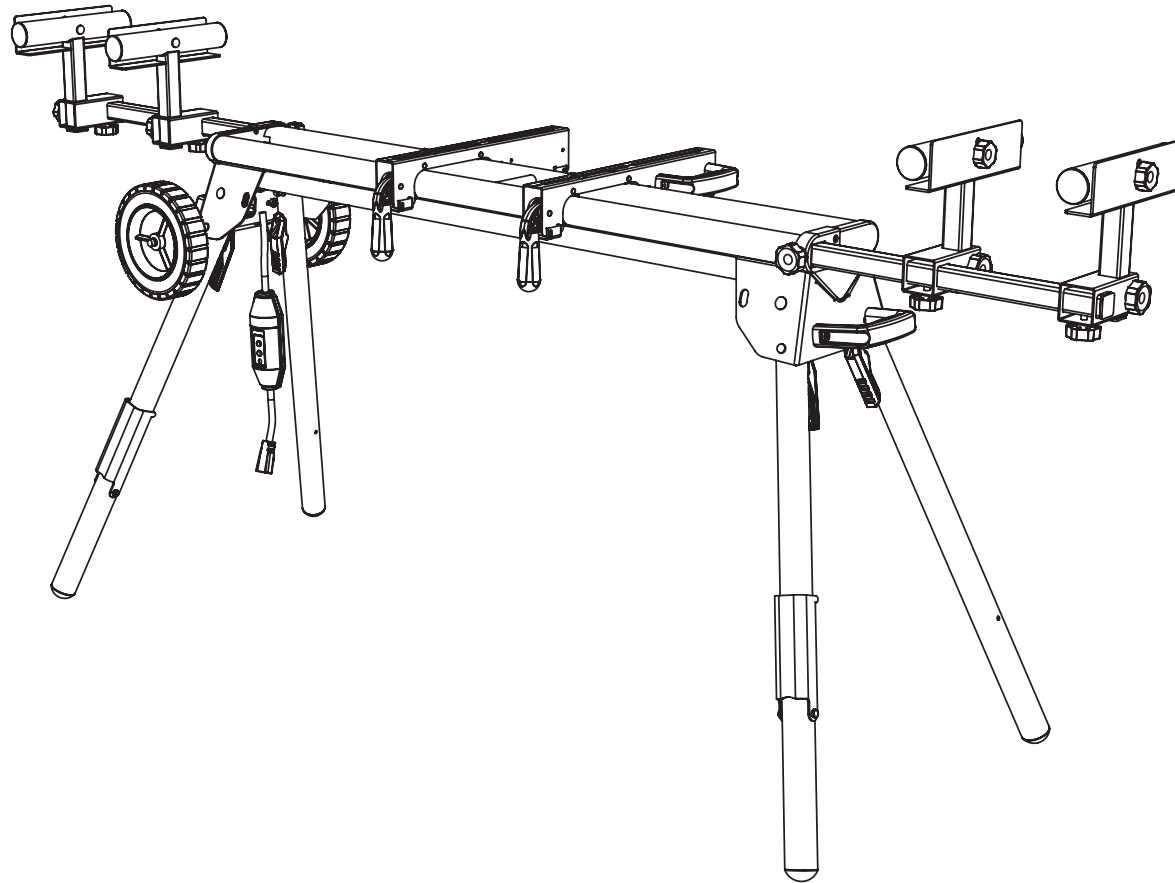

PROTOCOL

PRODUCT MANUAL UNIVERSAL WORK STATION



OVERVIEW

You have just purchased a Universal Work Station. This product has been specifically designed to assist you in the use of your 10-12" miter saw, as well as increasing efficiency with other bench top tools such as table saws, band saws, planers, etc.

SAFETY WARNING

WARNING: Be sure to read and understand all safety instructions in this manual, including all safety alert symbols such as “DANGER”, “WARNING” and “CAUTION”, before using this power tool accessory. Failure to follow all instructions listed in the manual may result in electric shock, fire and/or serious personal injury.

GENERAL SAFETY INSTRUCTIONS FOR POWER TOOLS

Using power tools of any kind can be dangerous if safe operation procedures are not followed. Recognizing the hazards of each tool and using them with respect and caution will considerably limit the possibility of personal injury. However, if safety precautions are ignored, personal injury will likely result. Always use common sense – your personal safety is your responsibility.

1. Know your power tool. Read and understand the Product Manual and observe the warnings and instruction labels affixed to the tool.
2. Properly ground all tools.
3. Keep guards in place.
4. Remove adjusting keys and wrenches.
5. Keep work area clean and dry.
6. Keep children away.
7. Never leave running machines/tools unattended.
8. Disconnect tools from service.
9. Use correct tools for the job.
10. Never force a tool.
11. Wear safety apparel.
12. Wear safety glasses/goggles.

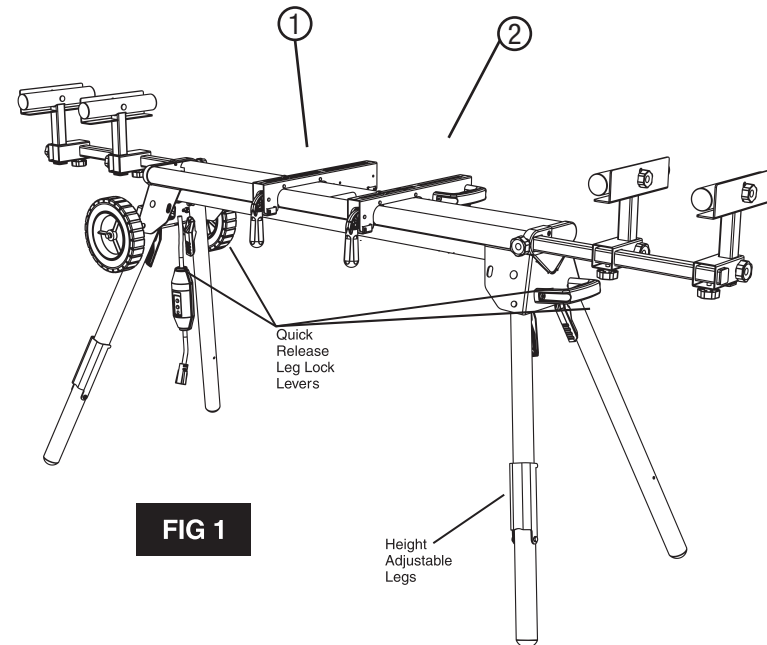

FIG 1

13. Never stand or sit on tools.
14. Replace damaged components immediately.
15. Make sure your work platform is sufficiently sturdy to do the specific job at hand.
16. Properly anchor blade for job being done.
17. Use correct blade for job being done.
18. Think safety. Safety is a combination of operator awareness, common sense and alertness at all times.

SAFETY INSTRUCTIONS FOR MITER SAW STANDS

1. Use caution when folding or unfolding legs to limit any finger pinch points.
2. Place stand on flat and level surface to keep from rocking or tipping.
3. Make sure that work support extensions (if included) are within safe operating limits, and are properly locked in place before using tool. Do not exceed the rated capacity on main frame table.
4. Test the setup for stability before proceeding with work.
5. Be sure the miter saw is tightened securely at all mountings before use for folding the work station for transport.

PARTS LIST

| PART # | DESCRIPTION | QTY |
|--------|------------------|-------|
| 1 | MITER SAW STAND | 1 pcs |
| 2 | RAPID TOOL CLAMP | 2 pcs |
| 3 | MOUNT ADAPTER | 2 pcs |
| 4 | ROLLER ACCESSORY | 4 pcs |
| 5 | L PLATE | 4 pcs |
| 6 | ROLLER ELBOW | 4 pcs |
| 7 | WHEEL | 2 pcs |
| 8 | AXLE PLATE | 1 pcs |
| 9 | HANDLE | 1 pcs |
| 10 | KNOBS M8*35 | 2 pcs |

| PART # | DESCRIPTION | QTY |
|--------|---------------------|--------|
| 11 | KNOBS M8*25 | 8 pcs |
| 12 | KNOB NUTS M6 | 4 pcs |
| 13 | CARRIAGE BOLT M8*55 | 2 pcs |
| 14 | CARRIAGE BOLT M8*20 | 2 pcs |
| 15 | NUT M8 | 12 pcs |
| 16 | CARRIAGE BOLT M8*60 | 4 pcs |
| 17 | WASHER #8 | 12 pcs |
| 18 | SPRING WASHER #8 | 12 pcs |
| 19 | BOLT M8*25 | 4 pcs |
| 20 | C-CLIP | 4 pcs |

| PART # | DESCRIPTION | QTY |
|--------|--------------------------|-------|
| 21 | GFCI | 1 pcs |
| 22 | GFCI STRAIN RELIEF PLATE | 1 pcs |
| 23 | GFCI FACE PLATE | 1 pcs |
| 24 | OUTLET PLUG | 1 pcs |

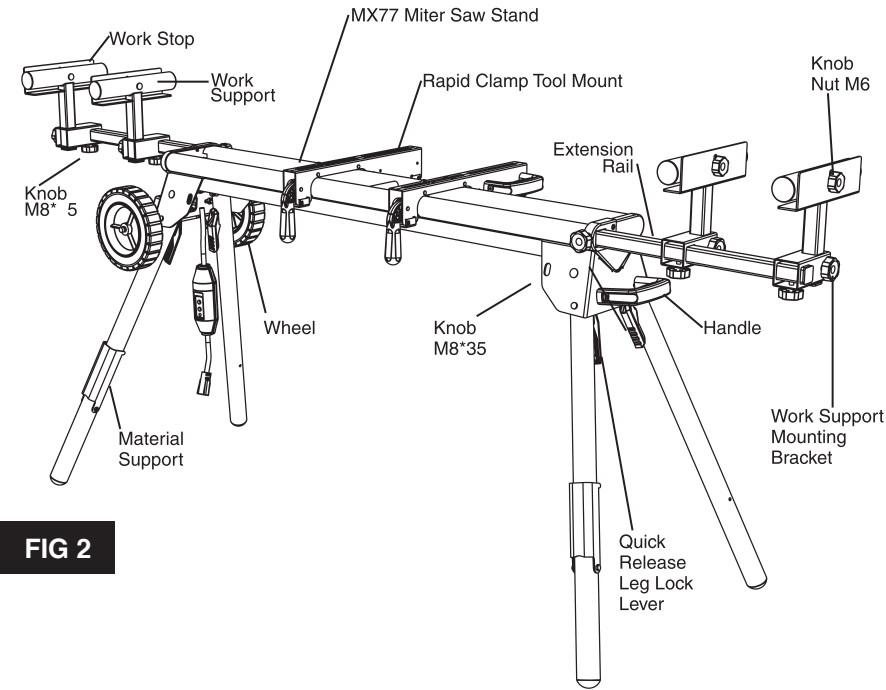

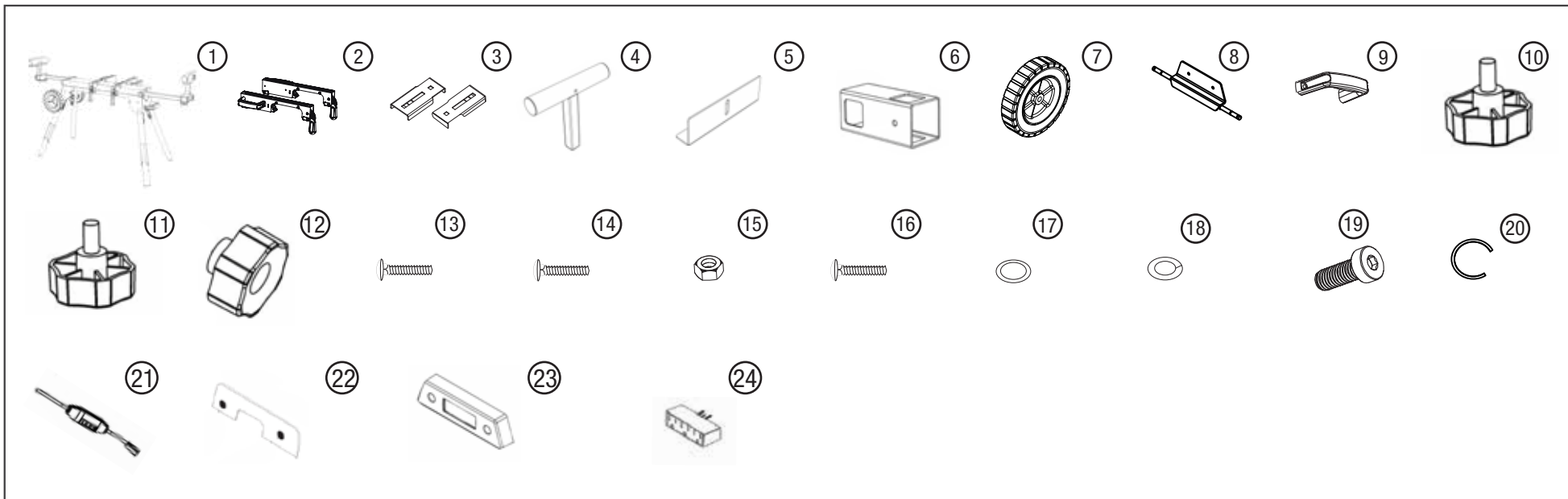

FEATURES

Your Universal Work Station is loaded with standard features all designed and engineered to maximize the functionality and flexibility of your Work Station.

STANDARD FEATURES

- Rapid Clamp Tool Mounts (2)
- Height Adjustable Legs
- Outlets Power Center (3)

ASSEMBLY INSTRUCTIONS

Read all assembly instructions completely before attempting assembly.

ATTACHING THE WHEELS

See Figure 2

1. Using pliers squeeze an C-clip over the inner groove closest to the miter saw stand
2. Place the wheel onto the axle and secure it using another C-clip toward the end of the axle
3. The C-clips should snap into place and hold the wheel onto the axle.

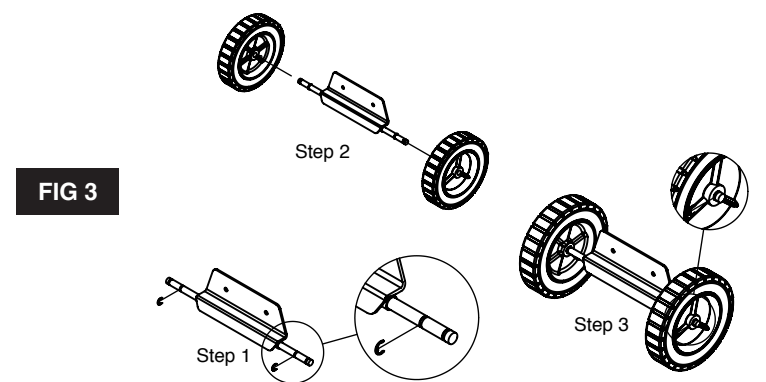

FIG 3

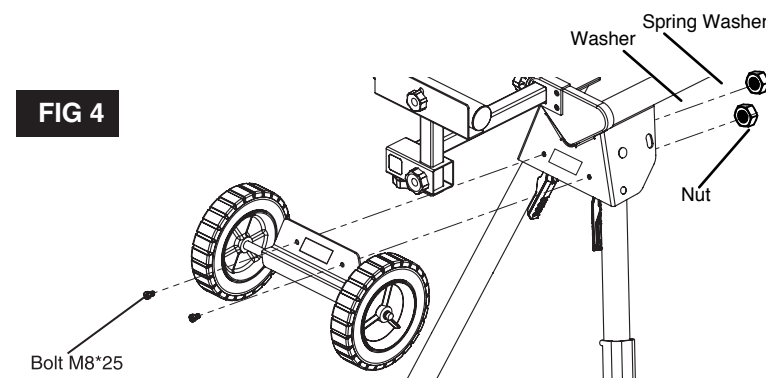

FIG 4

ATTACHING THE AXLE PLATE

See Figure 3

1. Place (2) M8 bolts through the holes in the axle plate
2. Place the axle plate onto the end of the miter saw stand making sure that the bolt run through the holes on the miter saw stand.
3. Place the washer and spring washer over each bolt on the back side of the miter saw stand
4. Lift the miter saw stand in the upright position
5. Tighten M8 nut over the washer until secure

ATTACHING THE PULL HANDLE

See Figure 5

1. Place (2) M8 bolts through the holes in the plastic handle.
2. Place the handle onto the end of the miter saw and stand and make sure the M8 bolts pass trough holes in the body
3. Place a washer and spring washer over each bolt exposed on the backside of the miter saw stand
4. Lift the stand and place it in a n upright position
5. Tighten M8 nut over the washers until secure.

ATTACHING THE GFCI OUTLET

See Figure 6 & 7

Read all assembly instructions completely before attempting assembly.
Assembly instruction for placing GFCI in place.

1. Align outlet plug and GFCI face plate
2. Place bolt M8*20 bolt through the GFCI face plate and bolt holes in miter saw stand body

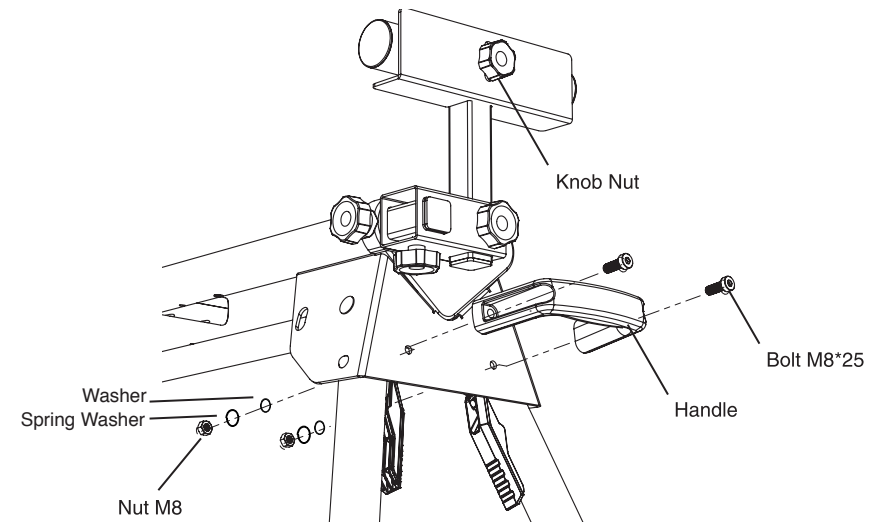

FIG 5

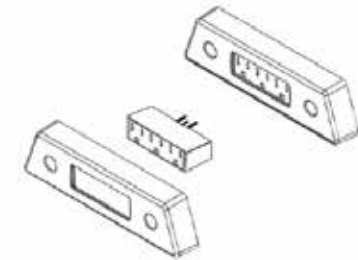

FIG 6

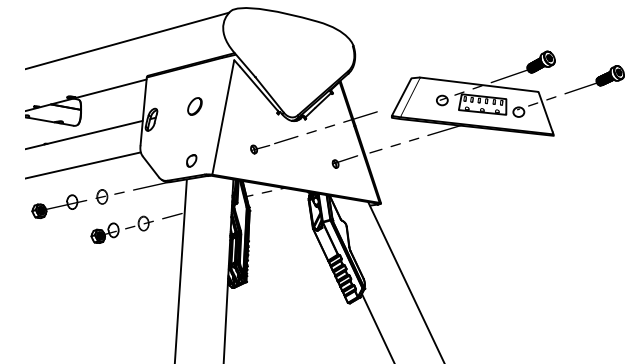

FIG 7

3. Plug in GFCI into back of outlet
4. Place GFCI strain relief bracket over the GFCI and end of bolts on the back side of miter saw stand end plate
5. Apply M8 washer then the M8 spring washer to the bolts in the in the GFCI assembly
6. Apply M8 nuts to the bolts holing the GFCI assembly together and hand tighten
7. Adjust the assembly to line up and tighten the GCFI assembly

PREPARING THE STAND

See Figure 8

1. Lay the stand's top surface down on the floor with the folded legs on top.
2. Press the Quick Release Leg Lock Lever and rotate that leg up until the locking pin clicks into place.
3. Repeat with the remaining three legs.
4. Lift the stand and place it in an upright position.
5. Check to ensure the stand is stable and all the legs have the locking pins engaged.

ASSEMBLING AND INSTALLING MATERIAL WORK SUPPORTS

See Figure 9

1. Slide a carriage bolt (m6 x 55mm) through the square hole in the work support and extend through the other side.
2. Place the work stop over the end of the bolt.
3. Thread a work stop adjustment knob over the end of the bolt and tighten to secure.
4. Slide the work support rail through the hole in the top of the work support mounting bracket.
5. Insert the height adjustment knob through the small hole on the side of the work support mounting bracket and tighten to secure.

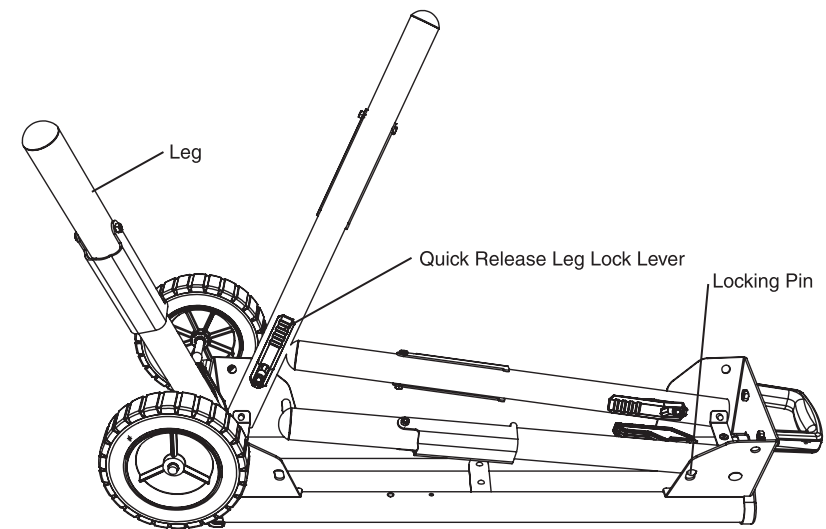

FIG 8

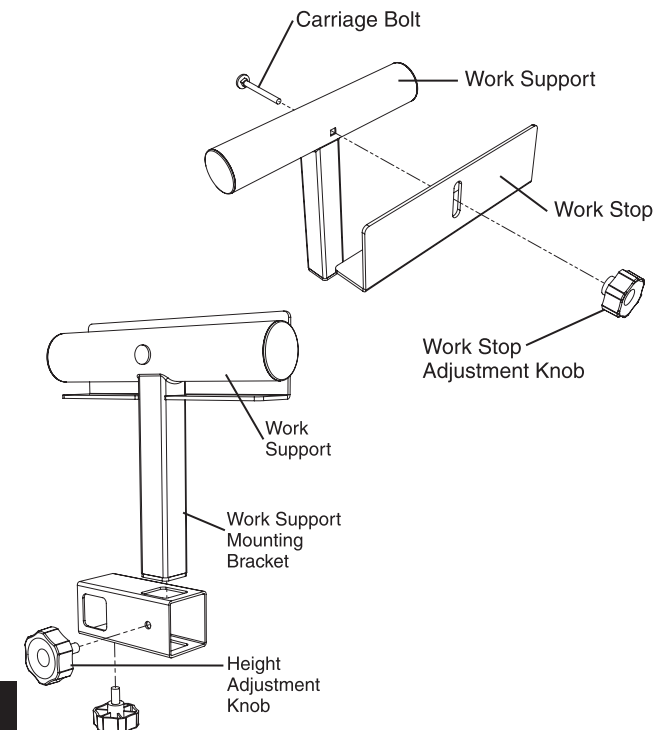

FIG 9

6. Next, slide the work support mounting bracket over the extension rail so that the extension rail extends through the opening in the bracket. Position the work support at the desired location on the extension rail.
7. Insert a length adjustment knob through the opening in the bottom of the work support mounting bracket tighten to secure.
8. Repeat with the other supports.

MOUNTING THE MITER SAW TO THE STAND

See Figure 10

Use the handles located at the rear of the tool mounts to aid in installing or removing saw and tool mount assembly.

1. Lift the saw and tool mount assembly, allowing the assembly to tilt slightly toward your body.
2. While still tilted toward you, hook the front edge of the tool mount assembly onto the front rail of the stand.
3. Lower the tool mount assembly to allow the rear edge of the tool mount to seat fully over the rear rail.
4. Lock the tool mounts in position by lowering the locking levers.

NOTE: Continue to hold the tool mount assembly with one hand until both levers are securely locked.

5. Check position and adjust, if necessary to make sure the weight of the saw is evenly balanced over the rails.
6. Ensure the saw is seated and locked in position, then securely tighten the four nuts holding the saw to the tool mounts.

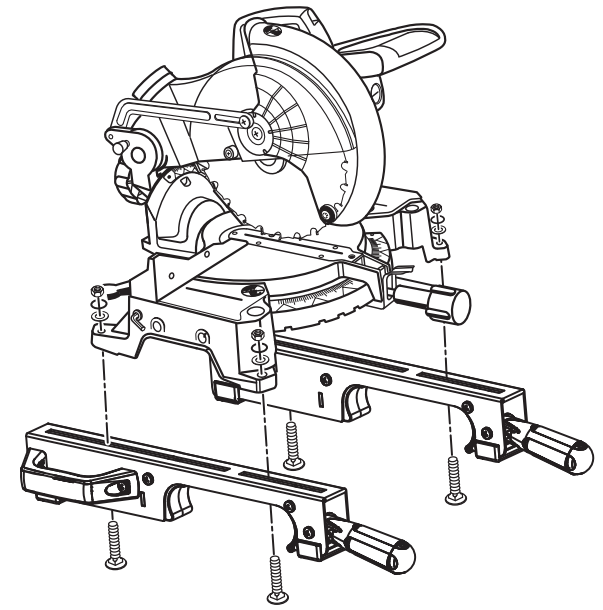

FIG 10

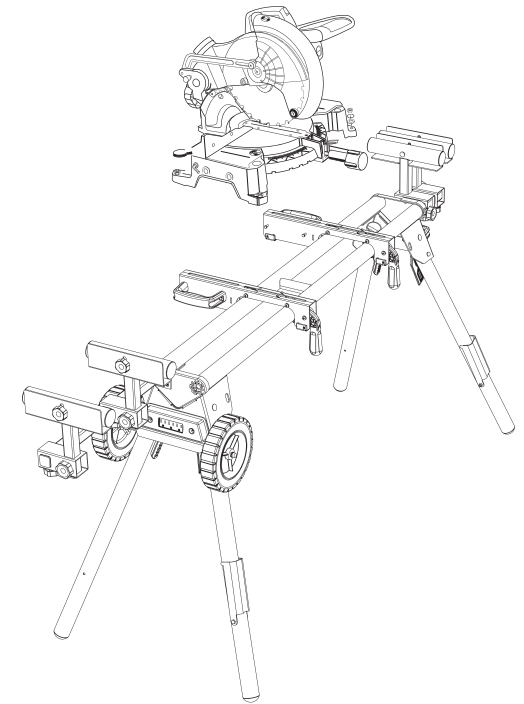

FIG 11

OFFSET MOUNTING

See Figure 12

Offset Mounting Bracket for Miter Saws and/or Power Tools with an irregular mounting hole pattern.

Instructions: Secure offset mounting brackets as shown. Brackets can be used on the front or rear of the Rapid Clamp Tool Mounts.

TO REMOVE SAW FROM STAND

See Figure 13

1. Raise the locking levers to unlock the saw and tool mounts.
2. Lift away from the rear rail of the stand to disengage.
3. With the assembly tilted slightly toward you, lift the assembly to disengage from the front rail of the work station.

TRANSPORTING AND STORING

1. Before storing or transporting, make sure all attachments are secure and bench top tool is removed.
2. Collapse legs and make sure they are locked into the up position.
3. Use the handle that is located in the center of the product for carrying.

TOOL MOUNT ADJUSTMENT SCREW

Most plastic tool mounts are designed to fit snugly over the stand rails. With the locking levers in the lowered (locked) position, you should not be able to remove the saw and tool mount assembly from the rails. If the saw and tool mount can be removed from the rails when the levers are locked, the tool mount adjustment screws need to be tightened. If the saw and the tool mount assembly will not fit over both rails, the bracket adjustment screws need to be loosened.

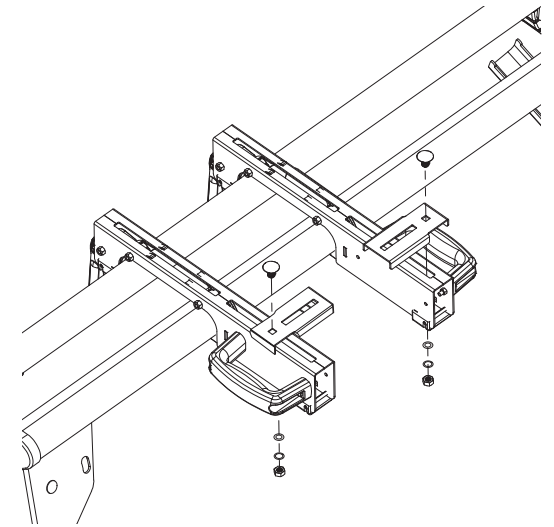

FIG 12

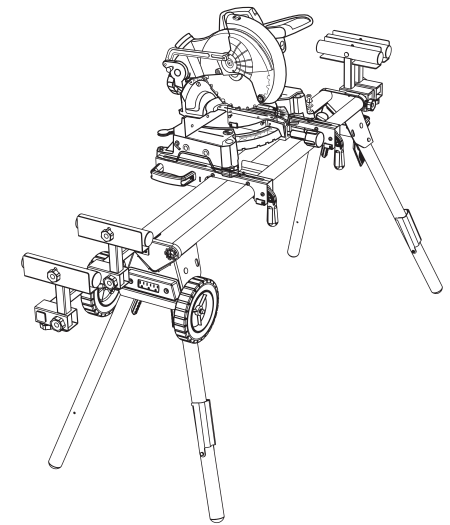

FIG 13

NOTE: The saw should be removed from the tool mounts before attempting to tighten or loosen the tool mount adjustment screws.

TO ADJUST

See Figure 14

1. Use a wrench to slightly loosen the nut.
2. Turn the screw with a Phillips screwdriver. Rotate clockwise if the tool mount assembly needs to be tightened or counterclockwise if the assembly needs to be loosened.
3. Install the tool mount on the Universal Work Station rails and lower the locking lever to check the adjustment.
4. When the correct position is achieved, tighten the nut with a 10mm open-ended wrench to secure.
5. Repeat steps 1 through 4 to attach the second tool mount.

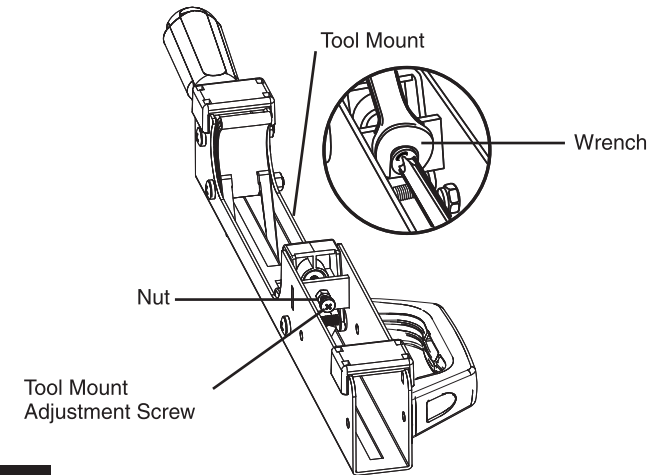

FIG 14

GENERAL MAINTENANCE

Avoid using solvents when cleaning plastic parts. Most plastics are susceptible to damage from various types of commercial solvents and may be damaged by their use. Use clean cloths to remove dirt, dust, oil, grease, etc.



LIFETIME | LIMITED WARRANTY

PROTOCOL Universal Work Station is backed by a Limited Lifetime warranty. This warranty covers manufacturer defects and workmanship. The warranty excludes misuse or abuse and normal wear and tear. Exclusion is not allowed in some states and may not apply. This warranty gives you specific legal rights, and you may have other rights, which vary from state to state.

JS PRODUCTS, INC. | 6445 MONTESSOURI STREET | LAS VEGAS, NV 89113
800.255.7011 | FAX: 775.898.8773 | FOR MORE PRODUCTS AND ACCESSORIES GO TO WWW.PROTOCOLEQUIPMENT.COM