

PARTS INCLUDED:

A POSTS (2)

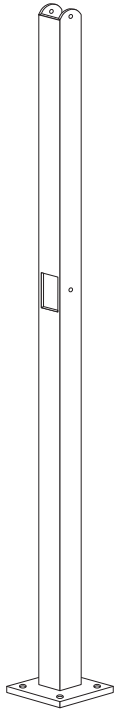

B HAND RAIL (1)

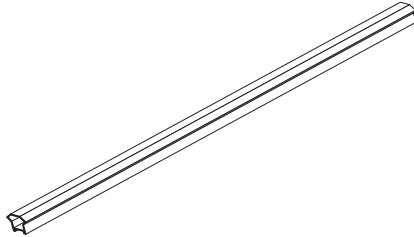

C CENTRE SUPPORT BAR (1)

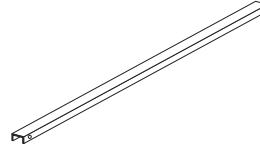

D POST BASE COVERS (2)

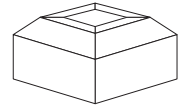

E SWIVEL BRACKETS (2)

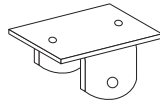

F SCREW (9)

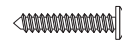

G SCREW (5)



H POST ANCHORS (FOR CONCRETE) (8)

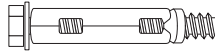

I POST LAG BOLTS (FOR WOOD AND COMPOSITE) (8)

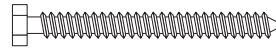

TOOLS REQUIRED:

- Tape measure
- Drill
- Carbide bit
- Hammer drill
- 7/16" Concrete drill bit
- Pencil
- 1/2" Socket

FOR A SUCCESSFUL INSTALLTION:

- Read the instructions completely before beginning the installation.
- Plan your railing project.
- Check local building codes to ensure compliance.
- Check carton(s) to determine part count is complete.
- Installation is best accomplished with two people.
- Wear personal protection equipment; safety glasses, etc.
- Use care not to over-torque the screws.
- If installing to other surfaces the installer must acquire the appropriate hardware as needed for proper installation on any other type of surfaces.

HANDRAIL KIT | STOOP RAILING SYSTEM INSTALLATION:

1. Install cover plate over the top of both posts.

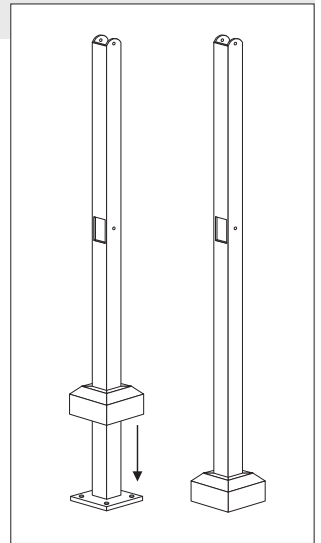

2. Install swivel brackets on top of both posts and attach them using (4) of Screw F.

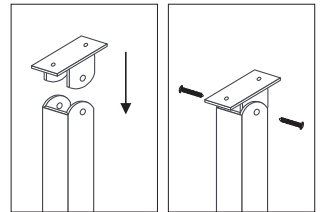

3. Install the center support into the openings mid-way down both posts using (4) of Screw F.

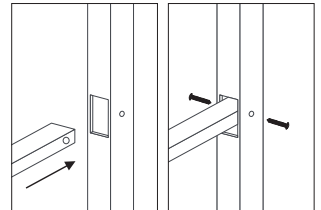

4. Slide top rail onto the swivel brackets that were installed on the top of the post in Step 2.

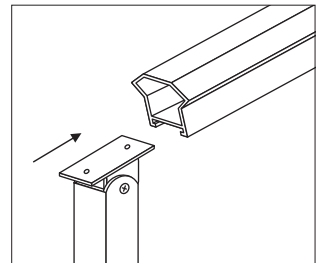

5. Determine how much of the top rail you want to stick out on each side as this may vary slightly by project.

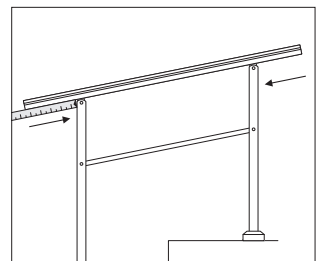

6. Once you determine your length, measure the distance between the post at the top and bottom. Make sure the measurements are the same as this will keep your posts straight.

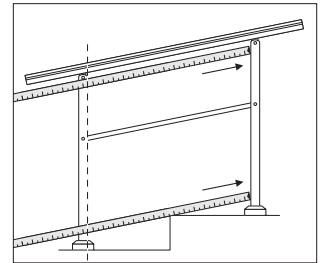

7. Screw the top rail to the swivel brackets using (4) of Screw G.

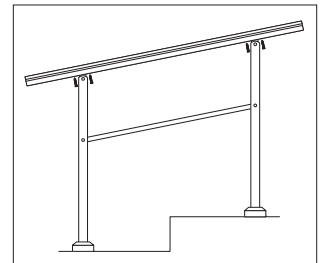
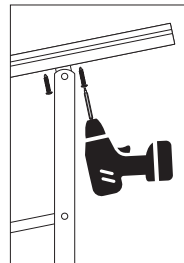

8. FOR CONCRETE:

Next, attach and secure the railing to your stairs. Start by placing your posts where they'll be installed and mark the holes.

Drill a hole in the concrete using a carbide bit and a hammer drill. The diameter of the carbide bit is the same diameter as the anchor being used, 7/16".

The hole needs to be drilled to a depth minimum of 1/2" deeper than the anchor will penetrate. This will allow space for debris to fall during the installation process.

Place your railing back in place. Hammer the anchors (H) into the holes and tighten using a 1/2" socket.

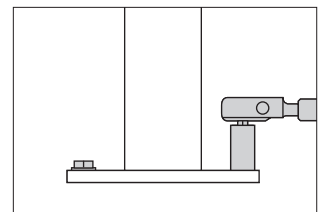
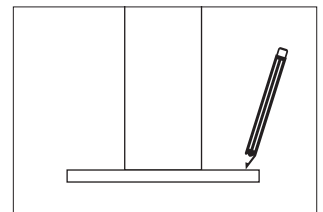

FOR WOOD:

Remove the railing system and drill 3/16" pilot holes.

Then, using the provided lag bolts (I), attach the posts to your steps.

9. Finally, slide the plate covers down to cover your post bases for a polished look to your railing system.

