



**M-D Building  
Products**

**WEATHERIZATION PRODUCTS • FLOOR TRIMS & ACCESSORIES • TOOLS**

# **PRODUCT CATALOG**

**Effective January 1, 2011**



## THE M-D STORY

M-D Building Products is a diverse manufacturing company that has been part of the Oklahoma City landscape since 1920. Founded as the Macklanburg-Duncan Company, M-D has a rich history of product innovation, development and quality manufacturing expertise. This legacy of products used by contractors, professionals and homeowners alike continue to protect, enhance and beautify homes across America and around the world.

Today, M-D Building Products is a leading domestic manufacturer of a wide variety of home energy related and remodeling products including Weatherstrip, Thresholds, Floor Trims and Tools. Our products are available at local home improvement retailers across the United States, Canada and Mexico.

At M-D Building Products, we have a knack for success. We take pride in our ability to draw strength from your inspiration, to provide a healthy dose of innovation with 90 years of ingenuity, and to ultimately generate creative solutions for your product needs.

**M-D Building Products...American made since 1920.**



# CONTENTS

**TERMS & CONDITIONS** ..... 2

**GREEN STATEMENT** ..... 2

**NEW PRODUCTS** ..... 3

**WEATHERSTRIP, THRESHOLDS & DOOR ACCESSORIES**

**RESIDENTIAL**

Rolled Packaged Door & Window Weatherstrip ..... 10

Window Specialty Weatherstrip ..... 12

Garage Door Weatherstrip ..... 13

Air Conditioner Weatherstrip and Covers ..... 15

Specialty Application Weatherstrip ..... 16

Pipe Insulation ..... 17

Door Sweeps ..... 18

Door Bottoms & Drip Caps ..... 20

Rigid Door Jamb Weatherstrip Kits ..... 22

Bronze Spring Sealing Door Weatherstrip Kits ..... 24

Adjustable Height Thresholds ..... 24

Aluminum Thresholds w/Vinyl Seal ..... 24

Hardwood Thresholds ..... 26

Saddle Thresholds ..... 27

Bumper Thresholds for Outswing Doors ..... 27

Sill Nosings ..... 28

Vinyl Replacement Inserts For Thresholds ..... 28

Weatherstrip & Thresholds – Commercial ..... 30

**ULTRA COMMERCIAL DOOR COMPONENTS**

Code Acceptability ..... 30

ULTRA Commercial Thresholds ..... 31

ULTRA Commercial Door Bottoms & Sweeps ..... 32

ULTRA Commercial Weatherstrip/Smoke Seals ..... 33

**ULTRA RESIDENTIAL DOOR COMPONENTS**

ULTRA Residential Prehung/Millwork

    Sills ..... 33

    Door Bottoms & Sweeps ..... 34

ULTRA Residential Thresholds ..... 36

ULTRA Residential – Weatherstrip/Astragals ..... 38

**DOOR ACCESSORIES**

Screen Door Grilles ..... 40

Mail Slots ..... 40

**SMARTTOOL™**

Levels and Modules ..... 42

Digital Levels (Domestic) Inches per Foot ..... 42

Digital Levels (International) Millimeters per Meter ..... 42

ADA Digital Slope Walker™ ..... 42

SMARTLASER™ ..... 42

Carrying Cases ..... 42

**FLOORING INSTALLATION TOOLS**

Tile Installation Tools ..... 44

Carpet Installation Tools ..... 52

**FLOORING PRODUCTS**

Aluminum Floor & Carpet Trim ..... 56

Hardwood Floor Trim ..... 62

Ceramic Tile Edging ..... 64

Floor & Carpet Accessories ..... 66

Vinyl Wall Base ..... 68

Vinyl Flooring Accessories ..... 69

Stick 'n Step ..... 70

**DECORATIVE MOULDINGS**

Decorative Aluminum Mouldings ..... 72

**ALUMINUM SHAPES & METAL SHEETS**

Aluminum Shapes ..... 76

Metal Sheets ..... 82

**ASSORTMENTS**

**WEATHERSTRIP, THRESHOLDS & DOOR ACCESSORIES**

Weatherstrip Assortments ..... 86

Threshold, Door Bottoms, Sweeps and Door Jamb Assortments .. 86

Ultra Residential Door Weatherstrip Assortments ..... 87

Door Grille Assortment ..... 87

**FLOORING INSTALLATION TOOLS**

Tile Installation Tool Assortments ..... 88

**FLOORING PRODUCTS**

Aluminum Carpet Trim Assortments ..... 89

Hardwood Floor Trim Assortment ..... 89

Ceramic Tile Edging Assortment ..... 90

Wall Base Assortments ..... 90

Stick 'n Step Assortments ..... 90

**ALUMINUM SHAPES & METAL SHEETS**

Aluminum Shapes Assortments ..... 91

Metal Sheets Assortments ..... 91

**INDEX** ..... 92

## TERMS & CONDITIONS

M-D Building Products, Inc. is a national supplier of building material products. We sell to the retail and wholesale building material market for the following types of customers:

- Lumber Yards
- Building Supply Centers
- Building Material Suppliers
- Building Material Wholesalers
- Home Centers
- Hardware Stores

We do not sell directly to contractors or consumers and do not accept COD's.

### ORDERING

All orders are subject to acceptance by M-D Building Products, Inc. in Oklahoma City, Oklahoma. Prices and terms of sale are subject to change without notice. M-D reserves the right to discontinue any product without notice.

All M-D products will be invoiced at M-D's current price. At anytime M-D reserves the right to change prices, make changes regarding product design, materials, specifications, and to discontinue any product or products without notice.

Minimum order \$250; any order less than \$250 will not be accepted.

### PHONE

Local: 405-528-4411

Within the US call Toll Free:

800-654-8454 (Customer Service)

800-654-0003 (Credit Dept)

800-654-0007 (Automated Switchboard)

e-mail: [orderentry@mdteam.com](mailto:orderentry@mdteam.com)

### FAX

Local: 405-557-3568

Within the US call Toll Free:

800-557-3568

### LIMITED WARRANTY

All M-D products are warranted to be free from defects in material and workmanship if installed and used in strict accordance with our installation instructions. Our liability is limited to our sale price of any products proven to be defective or, at our option, to the replacement of such products upon their return to us.

### TRANSPORTATION

Orders are shipped prepaid and M-D reserves the right to ship all merchandise in the most efficient manner. In the event a customer requests specific routing or expedited special handling, M-D will charge in accordance with current transportation rates.

### DELIVERY

**Back Orders:** M-D Building Products reserves the right to cancel back orders.

**Returned Goods:** Written authorization from M-D Customer Service is required prior to returning goods. Only unopened cartons, not priced for resale, are eligible for authorization.

Authorized returns must be shipped freight prepaid to the location designated by M-D. Credit will be issued from original invoice price, less a 20% restocking charge. Merchandise which is obsolete, discontinued and/or older than one year is not eligible for return.

**Claims:** Claims resulting from loss, shortages or damage-in-transit must be acknowledged on the delivery receipt. Concealed damages must be filed with M-D Building Products within 15 days of delivery. The recipient's signing the delivery receipts transfers ownership of product from M-D Building Products to you, the customer. Make written notes on delivery receipt to help protect yourself from liability for loss, damage, etc. Please report any shipping problems as soon as possible to M-D at 1-800-654-8454.

### REMITTANCE

The buyer is responsible for any taxes, fees, excises, duties or other charges resulting from the buyer's purchase of M-D Products.

**Payment Terms:** M-D Building Products' terms are 1% 30, net 45. Remittance by mail should be sent to: M-D Building Products, Inc., P.O. Box 269075, Oklahoma City, OK 73126. We also accept MasterCard and Visa.

**Credit Limits:** All orders are subject to credit approval at time of placement.

### INTERNATIONAL TERMS

Export order minimum is \$750 USD Ex-Works Oklahoma City, OK. Customer is responsible for all charges from Oklahoma City, OK to destination. \$1000 minimum order for prepaid freight – FOB any continental US port or US border. All products are quoted in US dollars. Export orders require payment in advance via bank draft or wire transfer. Customer will provide M-D Building Products, Inc. with the information pertaining to freight forwarder/customs broker and required shipping instructions.

The freight forwarder/customs broker will be expected to refuse any shipment that arrives at the FOB point in an unsatisfactory condition. The freight forwarder/customs broker will provide the freight carrier written documentation of condition of shipment at the time that it arrives if it is refused. Acceptance of a shipment by the freight forwarder/customs broker cancels any and all claims against damage, or any irregularities that can be encountered by the ultimate consignee upon receipt of goods at final destination. The responsibility for an FOB export shipment transfers from M-D Building Products, Inc. to the consignee's designated agent at the FOB point within the continental US port or US border upon delivery and acceptance. The responsibility for an Ex-Works export shipment is assumed by the consignee and the designated carrier as soon as the goods are picked up at M-D Building Products, Inc. dock in Oklahoma City, OK.

## GREEN STATEMENT

M-D Building Products makes efforts to operate our business in an environmentally and socially responsible manner. We recognize that reducing the environmental impact of our products and operations is an important part of the value we deliver to our customers. We strive to achieve environmental excellence and work with our employees, customers, partners and suppliers to meet these environmental commitments.

M-D Building Products is committed to providing quality products that help the American Homeowner save money by saving energy. At the same time, M-D Building Products has embarked on an on-going effort to reduce the amount of energy we consume in our manufacturing processes, reduce our corporate waste-stream to nearly zero and use as much recycled material as is available for our products and packaging. Finally, for 90 years M-D Building Products has maintained American manufacturing operations resulting in the lowest transportation carbon footprint of any company in our category.

# NEW PRODUCTS





### Weatherizing for Dummies™ (#50060)

Weatherizing for Dummies is a smart and easy way for consumers to make their home more comfortable and save hundreds of dollars a year on utility bills. Kit includes products and instructions to easily seal common areas of energy loss plus money saving rebates on other energy saving products.

### Garage Door Threshold Kit (#50100, #50101)

Designed to help keep your garage clean and more comfortable by forming a weathertight seal under your garage door. It helps prevent drafts, dust, moisture, debris and insects from entering under the door. Produced from high quality, durable vinyl. It will provide years of service on residential garage floor applications. Included with the kit is a premium quality silicone adhesive to insure a strong bond to both concrete and the vinyl and will bridge any imperfections in the garage floor.



### Garage Door Insulation Kit (#43157)

M-D's Garage Door Insulation kit uses a radiant foil insulation to help make your garage more comfortable and reduce energy costs in your home.

Helps keep your garage warmer in the winter by preventing warm air from escaping through your garage door to help keep your garage and home warmer.

Helps keep your garage cooler in the summer by blocking up to 97% of the sun's radiant energy to help keep your garage and home cooler.





**Expand 'N Seal Waterproof Foam Weatherseal (#03100)**

Expands to seal seams and joints. When fully compressed Expand 'N Seal provides a waterproof seal. Use to seal out drafts, moisture, dust and pests. Seals a variety of areas including air conditioner units, around foundations, siding, gutters and flashings.



**MetalDecor™ Finish Door Sealing Products**

M-D's exclusive MetalDecor™ finish provides the durability of aluminum with the beauty of finished hardwood. We are now offering two of our best selling items – M-D's Deluxe Aluminum & Vinyl Threshold and M-D's Deluxe Door Sweep with the MetalDecor™ Oak finish. M-D's exclusive MetalDecor™ process, allow these door weatherization products to complement existing hardwood doors or flooring.



**Shrink n' Seal® Window Film Bulk Roll with Tape (#43100, #43101)**

Our new bulk rolls of film are an easy and economical way to seal multiple windows in a home. Reduced packaging and longer rolls of film saves money and reduces waste. Available in 64 in x 25 ft rolls or 84 in x 25 ft. Each roll includes enough film and two sided tape to seal multiple windows.

### NEW SmartTool™ Products and New Features:

**New International Version** – Provides rise over run measurement in mm/M.

**Angle Copy Mode** – Allows end user to set the beeper to sound at any angle (not just at level & plumb).

**Alternate Zero Mode** – Allows end user to reset the reference angle “0” to any angle.

**Directional Beep** – Audible tone and rate increases as target angle approaches, guiding user when display cannot be seen.

**Go to [smarttoollevels.com](http://smarttoollevels.com) for additional information**



### 1 HP Fusion Wet Saw (#48191)

Our 1 HP Fusion Wet Saw, with a 3600 RPM direct drive motor, cuts through the toughest stone, porcelain, ceramic, marble, and granite tiles. Includes a patented rigid steel frame to protect all of the wet saw’s vital components. It features adjustable rip guide that mounts securely to the heavy-duty cast aluminum cutting table, tilting table for miter cuts, drain plug for easy water change, and slip resistant feet.

### 7" Wet Saw Replacement Blade (#48088)

7" continuous rim diamond replacement blade fits both ¾ HP and 1 HP M-D Fusion Wet Saws, 5/8" Arbor.



**Ceramic Floor Tile Installation Bucket Kit (#49834)**

The new Ceramic Floor Tile Installation Bucket Kit is perfect for the DIY'er. It's complete with all the essential professional grade items needed to install ceramic floor tile.

Installation Bucket Kit includes a tile installation trowel, tile nippers, grout float, sponge, gloves, tile spacers and sturdy reusable 2.5 gallon plastic bucket. The bucket serves as a mixing bucket for grouts and mortars and allows you to store your tools together when the job is complete.



**14" & 20" Tile Cutters (#49194, #49195)**

New 14" and 20" manual tile cutters for cutting floor and wall tiles. Both are equipped with dual chrome plated steel rails and a high leverage handle to make clean, efficient cuts. Body of the cutters are padded with durable rubber to prevent tile from slipping. Replaceable tungsten carbide cutting wheel.

**MetalDecor™ Stair Edging**

Our popular oak and cherry MetalDecor™ finishes have been added to our standard Stair Edging floor trims! Durable aluminum with the beauty of finished hardwood. Available in 36" and 72" lengths.





### Carpet Seaming Tapes (#31142, #31143, #31144)

New line of three professional hot melt carpet seaming tapes: Standard M-D 20, Premium M-D 40, & Ultra M-D 50. Quick melting adhesives for easy attachment to popular carpet backings in the marketplace.

### 1" Extra-Wide Tack Strip (#75312, #75314)

Intended for all-purpose residential and commercial use, our new tack strip is now 1" wide in both wood nail and concrete nail styles.

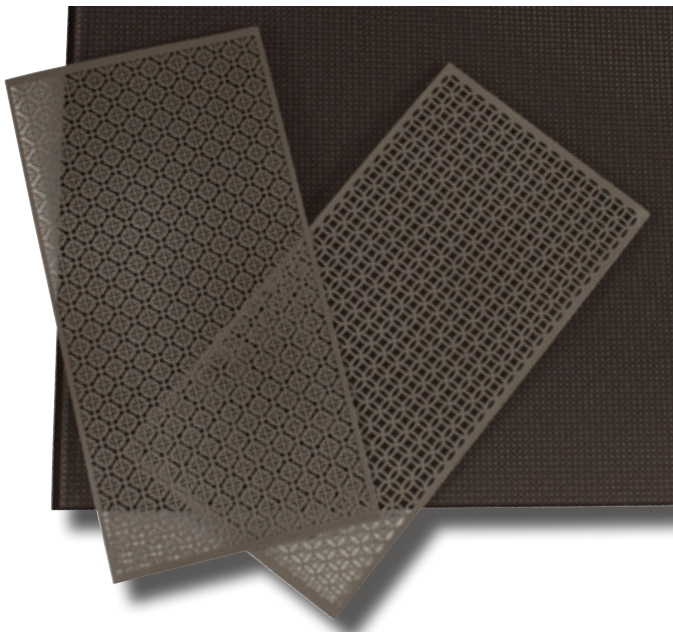

### Aluminum Sheets – New Elliptical & Mosaic Patterns in Satin Nickel Finish (#57010, #57005) and New Venetian Bronze Finish (#57015)

Updated perforated sheets patterns Elliptical & Mosaic (in Satin Nickel finish) now available in 1ft x 2ft sheets and new Venetian Bronze finish (Lincane 3ft x 3ft).

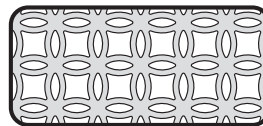

ELLIPTICAL

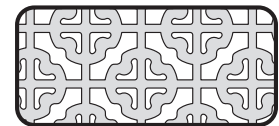

MOSAIC

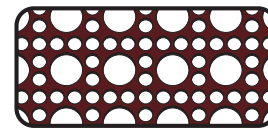

LINCANE – VENETIAN BRONZE

# WEATHERSTRIP THRESHOLDS DOOR ACCESSORIES



### ROLLED PACKAGED DOOR & WINDOW WEATHERSTRIP



#### Weatherizing for Dummies™

A smart and easy way to weatherize a home and reduce utility costs. Includes products and instructions to seal common areas of energy loss – plus money saving rebates for other energy saving products.

50060	WEATHERIZING FOR DUMMIES™ KIT		4
-------	-------------------------------	--	---

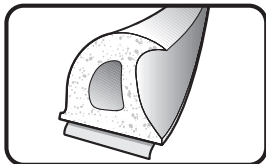

#### All-Climate ThermalBlend® Weatherstrip

Durable Silicone/EPDM ThermalBlend® rubber stays flexible in extreme cold or hot temperatures. The unique “Wave” profile adjusts to fill a variety of gaps around doors and windows. **Lifetime Warranty**

##### WAVE PROFILE 3/8" thick x 3/8" wide

43846	17'	WHITE	12
43848	17'	BROWN	12

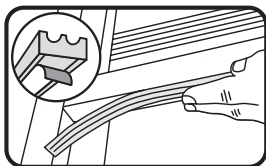

#### All-Climate EPDM Rubber Weatherstrip

High quality EPDM rubber seals out drafts, dust and moisture around doors and windows. Self-adhesive application. Remains flexible from -40°F to 140°F. Guaranteed to remain flexible for 10 years.

##### K PROFILE (for small gaps) 1/8" thick x 3/8" wide

02592	17'	ADHESIVE	BROWN	12
02618	17'	ADHESIVE	WHITE	12

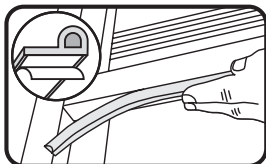

##### P PROFILE (for medium gaps) 7/32" thick x 3/8" wide

02550	17'	ADHESIVE	BROWN	12
02576	17'	ADHESIVE	WHITE	12

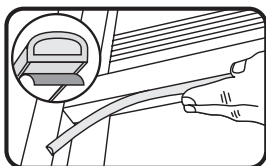

##### D PROFILE (for large gaps) 5/16" thick x 11/32" wide

63602	17'	ADHESIVE	BROWN	12
63628	17'	ADHESIVE	WHITE	12

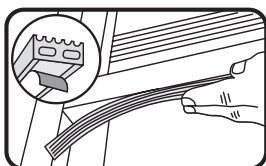

##### ALL PROFILE (for extra large gaps) 5/16" thick x 19/32" wide

63644	10'	ADHESIVE	BROWN	12
63669	10'	ADHESIVE	WHITE	12

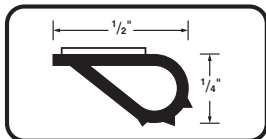

#### Commercial Grade – Silicone Door Seal

##### WS 108

Silicone gasketing. UL listed and tested to limit air and smoke infiltration. Not affected by mildew, fungus or UV light.



##### 1/4" thick x 1/2" wide

68510	20'	BROWN	6
68668	20'	BLACK	6
68676	20'	WHITE	6

M-D# DESCRIPTION COLOR PACK QTY

**ROLLED PACKAGED DOOR & WINDOW WEATHERSTRIP**

**Expand 'N Seal**

Waterproof Expandable Foam Weatherseal. Expands to seal seams and joints. Waterproof seal when compressed.

1/4" thick x 1" wide x 13' long

03100 EXPANDS TO 1" THICKNESS

6

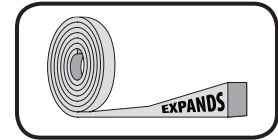

**Premium Sponge Rubber Weatherstrip Tape**

High density, self adhesive weatherproofing tape. Tough sponge rubber ensures long lasting seal.

T x W x L				
06577	1/4" X 1/2" X 10'	ADHESIVE	BLACK	12
06593	1/4" X 3/4" X 10'	ADHESIVE	BLACK	12
43155	1/4" X 1" X 10'	ADHESIVE	BLACK	6
06619	3/8" X 1/2" X 10'	ADHESIVE	BLACK	12
06635	3/8" X 3/4" X 10'	ADHESIVE	BLACK	12
43154	3/8" X 1-1/4" X 10'	ADHESIVE	BLACK	6

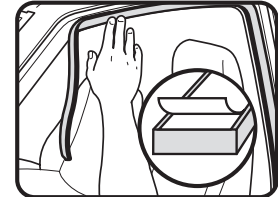

**High Density Foam Tape – Closed-Cell**

Closed-cell, PVC foam. A self-adhesive weatherproofing foam tape for eliminating air and moisture leaks.

T x W x L				
02238	1/8" X 1/4" X 17'	ADHESIVE	GRAY	12
02253	3/16" X 3/8" X 17'	ADHESIVE	GRAY	12
02279	1/4" X 1/2" X 17'	ADHESIVE	GRAY	12
02295	3/8" X 1/2" X 10'	ADHESIVE	GRAY	12
02311	1/2" X 3/4" X 10'	ADHESIVE	GRAY	12
02790	3/16" X 3/8" X 17'	ADHESIVE	BROWN	12
02816	1/4" X 1/2" X 17'	ADHESIVE	BROWN	12
02733	3/16" X 3/8" X 17'	ADHESIVE	WHITE	12
02758	1/4" X 1/2" X 17'	ADHESIVE	WHITE	12

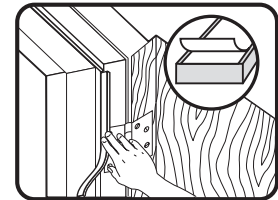
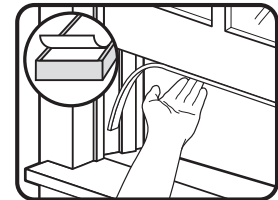

**2 ROLL BONUS PACK**

02873	3/16" X 3/8" X 34'	ADHESIVE	BROWN	12
02899	1/4" X 1/2" X 34'	ADHESIVE	BROWN	12
02832	3/16" X 3/8" X 34'	ADHESIVE	WHITE	12
02857	1/4" X 1/2" X 34'	ADHESIVE	WHITE	12

**Low Density Foam Tape – Open-Cell**

A self-adhesive resilient open-cell foam tape that compresses flat to form a tight seal.

T x W x L				
02055	3/16" X 3/8" X 17'	ADHESIVE	GRAY	12
02071	1/4" X 1/2" X 17'	ADHESIVE	GRAY	12
02097	3/8" X 1/2" X 17'	ADHESIVE	GRAY	12
02113	1/2" X 3/4" X 17'	ADHESIVE	GRAY	12

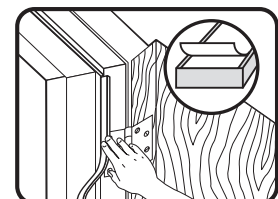
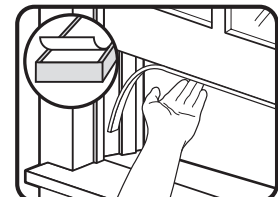

### ROLLED PACKAGED DOOR & WINDOW WEATHERSTRIP

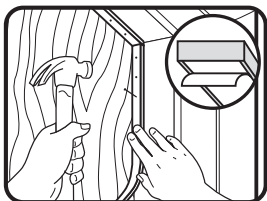

**Felt Weatherstrip**  
Economical multi-purpose felt weatherstrip

**MULTI-PURPOSE**

	T x W x L	COLOR	PACK QTY
03335	3/16" X 5/8" X 17'	GRAY	12
03350	3/16" X 1-1/4" X 17'	GRAY	6

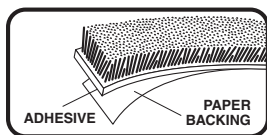

**Storm Door & Window Replacement Weatherstrip**  
Tight woven pile seals out air, moisture and dust. Self-adhesive back holds weatherstrip in place. Use as replacement for pile weatherstrip in storm doors and windows.

04267	17'	ADHESIVE	GRAY	6
-------	-----	----------	------	---

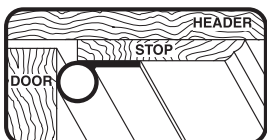

**Vinyl Gasket Weatherstrip**  
Flexible vinyl "bulb" seals around doors and windows. May be nailed or stapled in place.

78394	1/2" X 17'	WHITE	6
78196	1/2" X 17'	BROWN	6

### WINDOW SPECIALTY WEATHERSTRIP

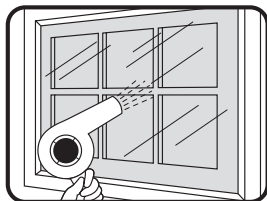

**Shrink & Seal® Indoor Window Kits**  
See through film and tape. Installs around entire window or patio door. Eliminates drafts and frost build-up. Creates dead air space to increase insulating R-Value.

**WINDOW INSULATION KITS**

04184	42" X 62" SHEET - FITS ONE STANDARD SIZE WINDOW	CLEAR	12
04440	3 - 42" X 62" SHEETS - FITS THREE STANDARD SIZE WINDOWS	CLEAR	12
04200	62" X 210" SHEET - FITS FIVE STANDARD SIZE WINDOWS	CLEAR	6
04283	84" X 110" SHEET - FITS ONE PATIO DOOR OR PICTURE WINDOW	CLEAR	6



**Shrink & Seal® Window Film Bulk Roll With Tape**

43100	64" X 25' WITH 1/2" X 120' TAPE	CLEAR	12
43101	84" X 25' WITH 1/2" X 180' TAPE	CLEAR	12

**Replacement Tape for Shrink & Seal® Indoor Window Kits**

31203	18' REPLACEMENT WINDOW TAPE - INDOOR/OUTDOOR	CLEAR	12
04598	54' REPLACEMENT WINDOW TAPE - INDOOR/OUTDOOR	CLEAR	12

**Economy Storm Window Kits**

08264	3' X 6' X 1.25 MIL (1 WINDOW)	CLEAR	36
08273	3' X 6' X 1.25 MIL (4 WINDOW)	CLEAR	18

WEATHERSTRIP, THRESHOLDS & DOOR ACCESSORIES

M-D# DESCRIPTION COLOR PACK QTY

WINDOW SPECIALTY WEATHERSTRIP

**Transparent Weatherstrip Tape**

Clear polyethylene. A heavy duty tape for sealing air and moisture leaks around windows.

03509	2" X 25'	ADHESIVE	CLEAR	12
04630	2" X 100'	ADHESIVE	CLEAR	12

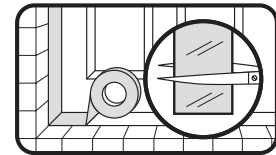

**Plastic Sheeting – Clear Film**

Clear heavy duty vinyl film is clear for a variety of interior/exterior household uses.

04762	36" X 25'	4MIL	CLEAR	12
04770	48" X 25'	4MIL	CLEAR	12
04788	36" X 25'	8MIL	CLEAR	6
04796	48" X 25'	8MIL	CLEAR	6

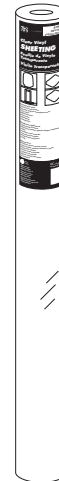

**Snap Lock Framing Strips Kit – White**

08286	7 PIECES – 26" LONG		WHITE	24
-------	---------------------	--	-------	----

**Economy Nail-On Framing Strips**

Fiber framing strips for storm window (includes nails).

07766	3/4" X 36"	18 PIECES	BROWN	24
-------	------------	-----------	-------	----

GARAGE DOOR WEATHERSTRIP

**Garage Door Threshold Kit**

Durable vinyl threshold forms a weather tight seal under garage door. Helps block drafts, dust and moisture from entering under the door. Silicone adhesive tube included.

50100	10' SINGLE DOOR		GRAY	2
50101	20' DOUBLE DOOR		GRAY	2



**Garage Door Insulation Kit**

Radiant foil insulation. Helps keep garage cooler in the summer and warmer in the winter. Reduces energy loss. Kit is designed for a single car garage door. Includes double-sided adhesive tape.

43157	22" X 40'	SEALS SINGLE CAR GARAGE DOOR	WHITE/SILVER	2
-------	-----------	------------------------------	--------------	---



### GARAGE DOOR WEATHERSTRIP

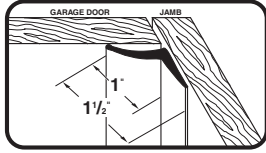

#### Vinyl Garage Door Seal for Top & Sides

Extruded vinyl. Designed to seal the sides and top of overhead garage doors.

03822	30'	NAILS	WHITE	6
-------	-----	-------	-------	---

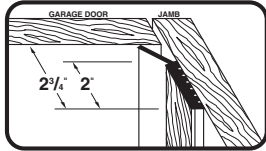

#### Dual Vinyl Garage Door Seal for Top & Sides

Flexible vinyl seal formed with firm vinyl base to provide an excellent garage door weatherstrip. Nail around garage door to seal out air, moisture and dust. Can be painted to match trim.

87726	7'		BROWN	10
87742	9'		BROWN	10
87684	7'		WHITE	10
87700	9'		WHITE	10
08472	7'		BEIGE	10
08456	9'		BEIGE	10

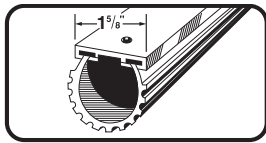

#### Universal Aluminum & Rubber Garage Door Bottom

Low temperature vinyl seal closes gaps up to 3/4" at bottom of garage door to seal out air, moisture and dust. Stays flexible to -30°. Seal insert is held in place with a sturdy aluminum extrusion fastened to bottom of door with screws (included).

87643	9'	SCREWS	BLACK	3
87668	18'	SCREWS	BLACK	3

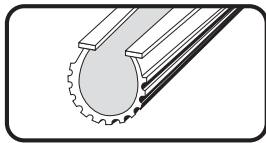

#### Replacement Vinyl for Universal Garage Door Bottom

08460	9'		BLACK	6
08462	18'		BLACK	6

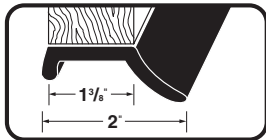

#### Premium Rubber Garage Door Bottom

An insulating premium rubber door seal that cushions shock as garage door is closed. Remains flexible at low temperatures. Seals out moisture and weather.

03723	9'	NAILS	BLACK	6
03749	16'	NAILS	BLACK	6



M-D# DESCRIPTION COLOR PACK QTY

**AIR CONDITIONER WEATHERSTRIP AND COVERS**

**Air Conditioner Covers**

Durable polyethylene blocks out water, ice, dust and leaves during off season.

**WINDOW UNITS**

	H x W x L		COLOR	PACK QTY
03392	18" X 27" X 16"	FOR UNITS UP TO 10,000 BTU	SILVER	12
50042	18" X 27" X 22"	FOR UNITS 10,000 TO 15,000 BTU	SILVER	12
87619	20" X 28" X 30"	FOR UNITS 15,000 BTU AND LARGER	SILVER	6

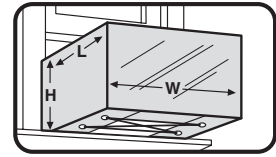

**CENTRAL AIR UNITS – ROUND**

03426	34" X 30"		SILVER	6
-------	-----------	--	--------	---

**CENTRAL AIR UNITS – SQUARE**

03772	34" X 34" X 30"		SILVER	6
-------	-----------------	--	--------	---

**Interior Window Air Conditioner Cover**

"Stretch to fit" cover for interior face of A/C unit. Fits most sizes of window units.

50040	ECONOMY – PLASTIC		CLEAR	12
-------	-------------------	--	-------	----

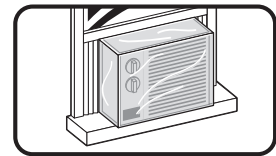

**Air Conditioner Side Panel Kit**

Foam panels insulate and reduce vibration. Can be trimmed to fit most sizes of A/C units. Self-adhesive installation strips included.

08308	9" X 18" X 7/8" THICK	2 PANELS	GRAY	6
-------	-----------------------	----------	------	---

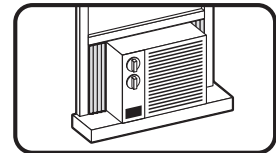

**Air Conditioner Filters**

Open cell foam filter can be trimmed to fit most sizes of A/C units. Washable and reusable.

08311	24" X 15" X 1/4" THICK	OPEN CELL FOAM	GRAY	24
-------	------------------------	----------------	------	----

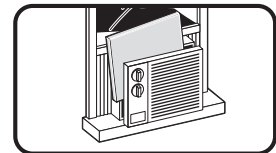

**Air Conditioner Weatherstrip**

**HIGH DENSITY FOAM**

Premium, high density foam tape. A compressible strip for sealing out air, insects and dust around window air conditioners. Colors match most window trim.

50005	1-3/8" X 1/2" X 42"		BEIGE	12
50007	1-3/8" X 1/2" X 42"		BROWN	12

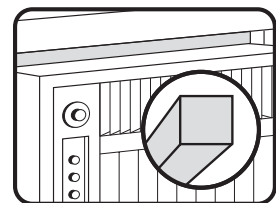

**OPEN CELL FOAM**

Resilient, open cell foam tape. A compressible strip for sealing out air, insects and dust around window air conditioners. Cushions vibrations.

02006	1-1/4" X 1-1/4" X 42"		GRAY	12
02535	2-1/4" X 2-1/4" X 42"		GRAY	6

### SPECIALTY APPLICATION WEATHERSTRIP

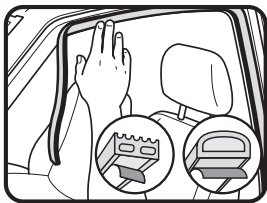

#### All Climate – Auto & Marine EPDM Rubber Weatherstrip

##### D PROFILE

5/16" thick x 11/32" wide

01025	17'	ADHESIVE	BLACK	12
-------	-----	----------	-------	----

##### ALL PROFILE

5/16" thick x 19/32" wide

01033	10'	ADHESIVE	BLACK	12
-------	-----	----------	-------	----

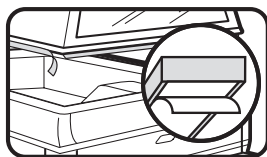

#### Camper Seal Self-Adhesive Foam Tape

High density, self-adhesive PVC foam tape. Designed to seal between truck bed and camper. Also recommended for use to cushion truck tool boxes. Extra wide foam cushions vibrations, blocks out air and moisture.

02352	3/16" X 1-1/4" X 30'		GRAY	6
-------	----------------------	--	------	---

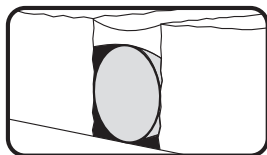

#### Backer Rod for Gaps & Joints

Non-absorbent, closed-cell polyethylene pre-caulking material. Use before caulking to fill gaps and openings larger than 1/2" x 1/2". Prevents 3-point bonding.

71464	3/8" X 20'			12
71480	1/2" X 20'			12
71506	5/8" X 20'			12

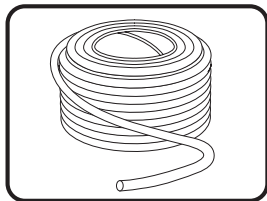

#### Replaceable Cord Weatherstrip

Forms a flexible seal inside or outside. Requires no tools. Easy to apply.

71522	30 FT		GRAY	8
71548	90 FT		GRAY	6

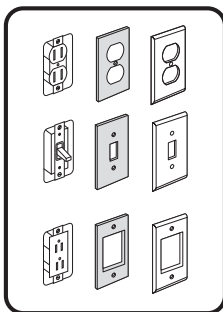

#### Switch & Wall Plate Sealers

Closed-cell foam sealers. UL and CSA approved.

03434	6 LIGHT SWITCH SEALERS		WHITE	12
87916	6 OUTLET PLATE SEALERS		WHITE	12
06668	6 ROCKER SWITCH/ GFCI OUTLET SEALERS		WHITE	12

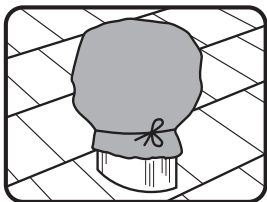

#### Turbine Vent Cover – Plastic

Heavy duty polyethylene. Black plastic with tie strings.

03376	FITS MOST TURBINES		BLACK	12
-------	--------------------	--	-------	----

M-D# DESCRIPTION COLOR PACK QTY

PIPE INSULATION

**Faucet Cover**

Insulates and protects faucet in cold weather

03939 FAUCET COVER WHITE 100



**Insulated Foam Pipe Wrap**

PVC foam with aluminum shell. Aluminum foil shell reflects heat. Closed-cell foam insulates and protects.

02378 1/8" X 2" X 15' ADHESIVE BLACK/SILVER 6  
02394 1/8" X 2" X 30' ADHESIVE BLACK/SILVER 12

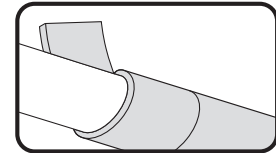

**Fiberglass Pipe Wrap**

Features 1/2" thick fiberglass insulation. Includes clear plastic wrap to provide moisture barrier.

04929 3" X 25' YELLOW 24  
04937 6" X 25' YELLOW 12

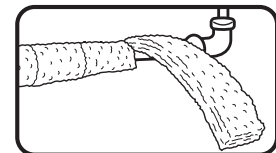

**Tube Pipe Insulation**

Blocks heat loss or gain to save energy. Use on hot or cold pipes. Stops condensation on cold pipes to prevent water damage.

**PACKED 4 PER PACKAGE**

Polyethylene (3/8") thickness

			COPPER	IRON	PVC	
50140	1/2" X 3'	FITS	1/2"	3/8"	3/8"	24
50142	3/4" X 3'	FITS	3/4"	1/2"	1/2"	18
50144	1" X 3'	FITS	1"	3/4"	3/4"	14

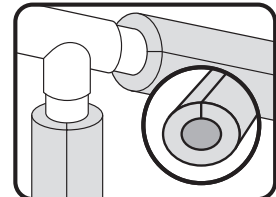

**BULK PACKED**

Polyethylene (3/8") thickness

			COPPER	IRON	PVC	
50148	1/2" X 6'	FITS	1/2"	3/8"	3/8"	70
50150	3/4" X 6'	FITS	3/4"	1/2"	1/2"	50
50154	1" X 6'	FITS	1"	3/4"	3/4"	40

**Self-Sealing Tube Pipe Insulation**

Blocks heat loss or gain to save energy. Use on hot or cold pipes. Stops condensation on cold pipes to prevent water damage. Pre-cut, self-sealing slits for easy application.

			COPPER	IRON	PVC	
50158	1/2" X 6'	FITS	1/2"	3/8"	3/8"	70
50162	3/4" X 6'	FITS	3/4"	1/2"	1/2"	50
50164	1" X 6'	FITS	1"	3/4"	3/4"	40

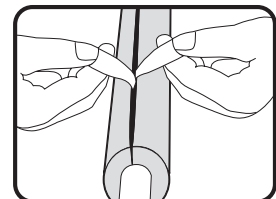

M-D#

DESCRIPTION

COLOR

PACK QTY

### PIPE INSULATION

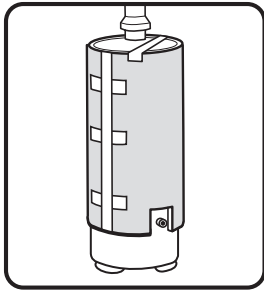

#### Water Heater Insulation Blankets

Designed for gas, oil or electric heaters. White vinyl backed fiberglass blanket. Includes adhesive tape for easy installation. Fits up to 60 gallons.

04663	R-6.7 INSULATING VALUE 2" X 48" X 75"	NEW - LOWER PRICE	4
04689	R-11 INSULATING VALUE 3" X 48" X 75"	NEW	4

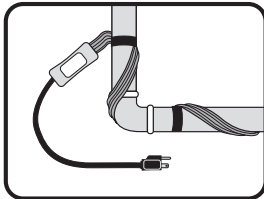

#### Pipe Heating Cable w/Thermostat

UL and CSA approved pipe heating cable designed to prevent water line freeze up. Ready to install, grounded cord and plug, thermostat controlled, with pilot light.

04309	3'		5
04325	6'		5
64386	9'		5
04341	13'		5
64428	18'		5
04366	24'		5
64444	30'		5

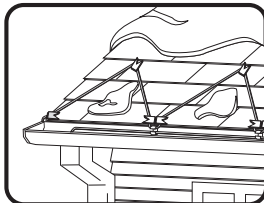

#### Roof & Gutter Cable

UL and CSA approved roof & gutter cable designed to prevent ice dams and water damage. Includes fasteners.

64469	40'		5
64394	80'		3
64501	100'		3

### DOOR SWEEPS

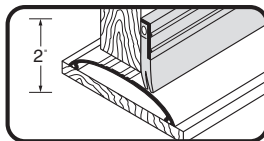

#### Deluxe Aluminum & Vinyl Door Sweep

Heavy duty door sweep seals gaps up to 3/4" high. Slotted holes for easy adjustment.

05389	36"	ALUMINUM	6
05413	48"	ALUMINUM	6



#### PREMIUM FINISH

43153	36"	METALDECOR™ OAK	6
48996	36"	SATIN NICKEL	6
05744	36"	BRITE GOLD	6
05652	36"	BRONZE	6
05769	36"	WHITE	6

NEW MetalDecor™ Finish

WEATHERSTRIP, THRESHOLDS & DOOR ACCESSORIES

M-D# DESCRIPTION COLOR PACK QTY

DOOR SWEEPS

**Triple Fin Aluminum & Vinyl Door Sweep**

Triple fin vinyl seal provides superior seal for uneven floor surfaces. Slotted holes for easy adjustment.

05090 36" ALUMINUM 6

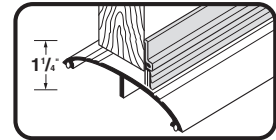

**PREMIUM FINISH**

05702 36" BRITE GOLD 6  
 05173 36" BRONZE 6  
 05215 36" WHITE 6

**Aluminum & Felt Door Sweep**

05017 36" ALUMINUM 6



**PREMIUM FINISH**

05058 36" BRITE GOLD 6

**Hardwood & Vinyl Door Sweep**

Unfinished hardwood doorsweep with triple fin vinyl seal blocks drafts. Can be stained or painted to match door.

06411 36" UNFINISHED 6

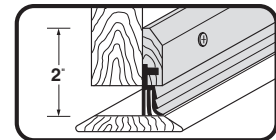

**Self-Adhesive Door Sweep**

**ECONOMY**

Rigid vinyl with soft vinyl sweep. Sticks to all doors. Flexible to compensate for carpet or uneven doors.

05603 36" BROWN 24  
 05587 36" WHITE 24

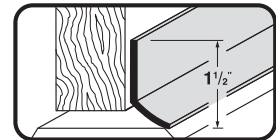

**Economy Aluminum & Vinyl Door Sweep**

**ECONOMY**

05629 36" ALUMINUM 20

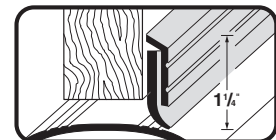

**Flex-O-Matic Automatic Door Sweep**

As the door opens, the spring action door sweep automatically raises to clear the carpet. When the door is closed, the door sweep automatically lowers to firmly press against floor or carpet.

07237 36" ALUMINUM 6



**PREMIUM FINISH**

07153 36" BRONZE 6  
 07179 36" WHITE 6

M-D#

DESCRIPTION

COLOR

PACK QTY

### DOOR SWEEPS

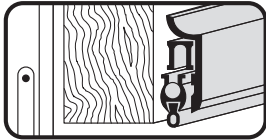

#### Seal-O-Matic Automatic Door Sweep

Weatherproofs and soundproofs. Vinyl bottom raises automatically to clear carpet when door opens. Vinyl bottom lowers automatically to make tight seal when door closes.

07039	36"	ALUMINUM	6
-------	-----	----------	---

### DOOR BOTTOMS & DRIP CAPS

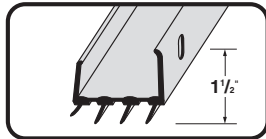

#### U-Shaped Door Bottom w/Vinyl Fins

Durable vinyl door bottom has soft vinyl fins to seal against top of threshold and sill. Great for steel doors.

**FITS MOST 1-3/4" STEEL OR WOOD DOORS**

05991	36"	BROWN	6
06528	36"	WHITE	6

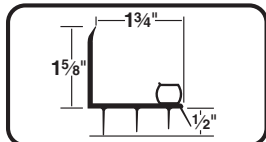

#### Replacement Door Bottom w/Vinyl Fins

Fits most brands of entry doors.

**L-SHAPED - FITS A VARIETY OF 1-3/4" STEEL OR WOOD DOORS**

82578	36"	BROWN	6
43816	36"	WHITE	6

82578/43816

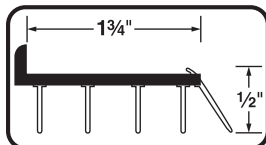

82586

**FITS A VARIETY OF 1-3/4" STEEL OR WOOD DOORS**

82586	36"	SCREW OR NAIL-ON	BROWN	6
-------	-----	------------------	-------	---

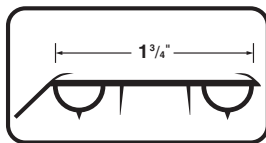

47000

**FITS A VARIETY OF 1-3/4" STEEL OR WOOD DOORS**

47000	36"	SCREW OR NAIL-ON	BROWN	6
-------	-----	------------------	-------	---

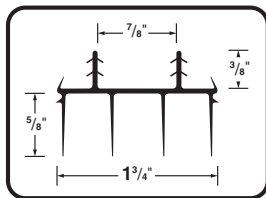

67967

**KERF STYLE - FITS A VARIETY OF DOORS WITH NOTCHED KERFS**

67967	35-3/4"	BROWN	6
-------	---------	-------	---

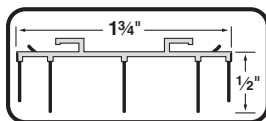

82594

**FITS PEASE STYLE DOORS**

82594	35-3/4"	BEIGE	6
-------	---------	-------	---

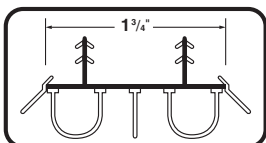

43820

**KERF STYYLE - FITS A VARIETY OF DOORS WITH NOTCHED KERFS**

43820	35 3/16"	BEIGE	6
-------	----------	-------	---

M-D# DESCRIPTION COLOR PACK QTY

**DOOR BOTTOMS & DRIP CAPS**

**U-Shaped Door Bottom w/Vinyl Seal**

FITS 1-3/4" DOORS

05322 36" U-SHAPED ALUMINUM 6

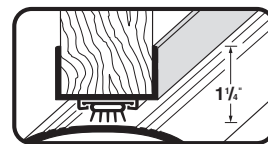

**L-Shaped Door Bottom w/Drip Cap**

L-shaped door bottom with drip cap, fits both 1-3/8" and 1-3/4" doors. Seals between bottom of door and threshold to block out air and moisture. Slotted fastener holes allow easy installation and adjustment.

06015 36" ALUMINUM 6

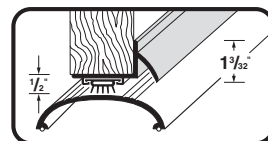

**PREMIUM FINISH**

48998 36" SATIN NICKEL 6  
 06098 36" BRITE GOLD 6  
 06056 36" BRONZE 6  
 06395 36" WHITE 6

**U-Shaped Door Bottom w/Drip Cap**

U-shaped door bottom with drip cap. Seals between bottom of door and threshold to block out air and moisture. Slotted fastener holes allow easy installation and adjustment.

FITS 1-3/8" DOORS

06114 36" ALUMINUM 6

FITS 1-3/4" DOORS

06155 36" ALUMINUM 6

**PREMIUM FINISH**

49000 36" SATIN NICKEL 6  
 06478 36" BRITE GOLD 6  
 06197 36" BRONZE 6  
 06403 36" WHITE 6

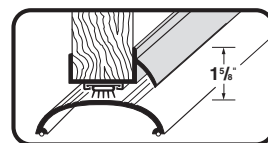

**Concealed Door Bottom w/Vinyl Seal**

Extruded aluminum with vinyl seal.

05512 36" ALUMINUM 6

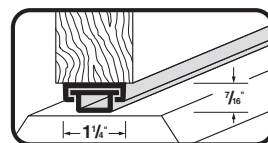

**Drip Cap w/Vinyl Seal**

Drip cap with flap seal to block out air and moisture. Slotted holes for easy adjustment.

05546 36" ALUMINUM 6

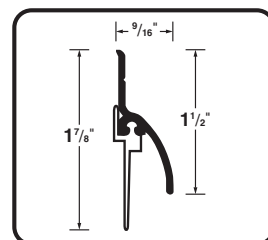

### DOOR BOTTOMS & DRIP CAPS

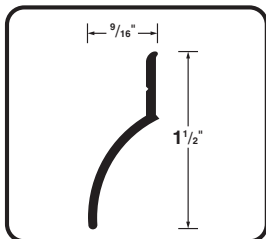

#### Aluminum Drip Cap

Aluminum drip cap diverts rainwater away from bottom of door. Slotted holes for easy adjustment.

06247	36"	ALUMINUM	6
-------	-----	----------	---

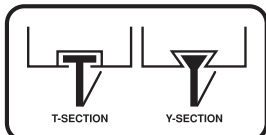

#### Storm Door Bottom Vinyl Replacement

A vinyl replacement for aluminum storm doors.

04226	37"	T SECTION	GRAY	12
04242	37"	Y SECTION	GRAY	12

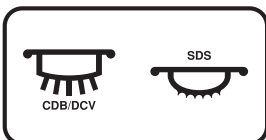

#### Vinyl Replacement Inserts For Door Bottoms

06304	36"	FOR L-SHAPE AND U-SHAPED ALUMINUM DOOR BOTTOMS	GRAY	10
25756	36"	FOR L-SHAPE AND U-SHAPED ALUMINUM DOOR BOTTOMS	BLACK	10
05520	36"	FOR CONCEALED ALUMINUM DOOR BOTTOM – SDS	GRAY	10

### RIGID DOOR JAMB WEATHERSTRIP KITS

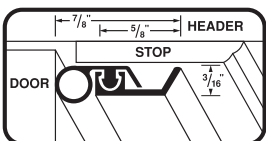

#### Universal Door Jamb Weatherstrip Kit

Aluminum and vinyl. Nail fasteners for wood frame doors, screw fasteners for wood or steel frame doors. Fasteners included. Install on doorstop. Slotted fastener holes ensure easy installation and adjustment.

01040	36" X 84"	NAILS	ALUMINUM	10
01073	36" X 84"	SCREWS	ALUMINUM	10

#### PREMIUM FINISH

49002	36" X 84"	SCREWS	SATIN NICKEL	10
01156	36" X 84"	SCREWS	BRONZE	10
01958	36" X 84"	SCREWS	WHITE	10
01271	36" X 84"	SCREWS	BRITE GOLD	10

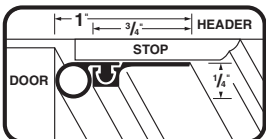

#### Flat Profile Door Jamb Weatherstrip Kit

Aluminum and vinyl. Flat design recommended for commercial or residential application. Screw fasteners for wood or steel frame doors. Fasteners included. Install on doorstop. Slotted fastener holes ensure easy installation and adjustment.

01438	36" X 84"	SCREWS	ALUMINUM	10
-------	-----------	--------	----------	----

#### PREMIUM FINISH

01677	36" X 84"	SCREWS	BRONZE	10
87635	36" X 84"	SCREWS	WHITE	10
01669	36" X 84"	SCREWS	BRITE GOLD	10



M-D# DESCRIPTION COLOR PACK QTY

**RIGID DOOR JAMB WEATHERSTRIP KITS**

**Extreme Temperature Door Jamb Weatherstrip Kit**

Aluminum and santoprene. Ideal product for extremely cold or hot climates. Screw fasteners for wood or steel frame doors. Fasteners included. Install on doorstop. Santoprene seal remains flexible at -40°, resists drying and cracking in hot temperatures. Slotted fastener holes ensure easy installation and adjustment.

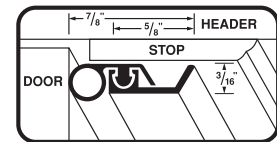

**PREMIUM FINISH**

01750	36" X 84"	SCREWS	WHITE	10
-------	-----------	--------	-------	----

**Wood & Vinyl Door Jamb Weatherstrip Kit**

Wood with flexible vinyl bulb provides a weathertight seal. Installs on doorstop. Pre-Primed Wood may be painted.

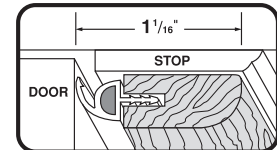

43818	36" X 84"	NAILS	PRIMED WOOD	10
-------	-----------	-------	-------------	----

**Compression Weatherstrip w/ Wood Stop Door Jamb Kit**

Straight grained wood with foam and vinyl seal. For residential use. Fasteners included. Install on doorstop or use to replace doorstop. Pre-Primed Wood may be painted.

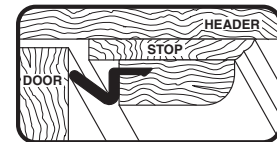

91884	36" X 84"		BROWN / PRIMED WOOD	6
87981	36" X 84"		WHITE / PRIMED WOOD	6

**Compression Weatherstrip w/Aluminum Stop Door Jamb Kit**

Aluminum with foam and vinyl seal. For commercial or residential use. Screw fasteners for wood or metal frame doors. Fasteners included. Install on doorstop. Slotted fastener holes ensure easy installation and adjustment.

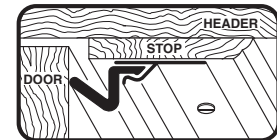

**PREMIUM FINISH**

91850	36" X 84"	SCREWS	WHITE	6
87783	36" X 84"	SCREWS	BRONZE	6

**Compression Replacement Weatherstrip**

Vinyl clad foam. Recommended for commercial or residential use. Kerf installation.

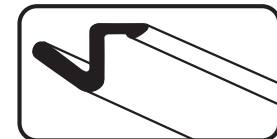

91868	81"	KERF	WHITE	20
87767	81"	KERF	BROWN	20
91800	81"	KERF	BEIGE	20

**Steel Door Magnetic Weatherstrip**

For steel entry doors. Installed in kerf / slot in doorstop. Magnetic pulling power, along with flexible gasket, compensates for unevenness in doors. For door frames with kerfs of at least 3/8" and doorstop width of 7/16". Three piece set.

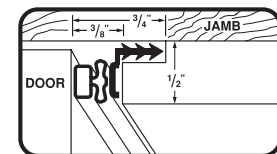

**LOW TEMPERATURE T.P.E. VINYL – STEEL DOOR MAGNETIC WEATHERSTRIP SET**

01610	36" X 81"	KERF	BEIGE	6
01636	36" X 81"	KERF	BROWN	6

**VINYL CLAD FOAM – STEEL DOOR MAGNETIC WEATHERSTRIP SET**

47002	36" X 81"	KERF	BEIGE	6
-------	-----------	------	-------	---

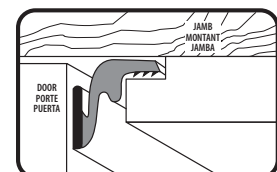

### BRONZE SPRING SEALING DOOR WEATHERSTRIP KITS

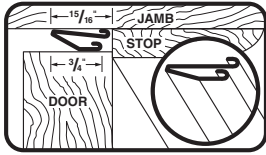

#### H-4 Door Weatherstrip

Install on wood doorjamb. Bronze strips may be cut to fit smaller doors. V-shape presses seal against door to block out air and moisture. Fasteners included.

#### THE ORIGINAL WEATHERSTRIP

.005" THICKNESS

01305	36" X 84"	NAILS	BRONZE	10
-------	-----------	-------	--------	----

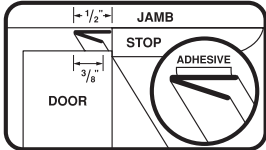

#### V-Flex Weatherstrip

Polypropylene with adhesive back. A superior self-adhesive V-shaped plastic weatherstrip for sealing doors and windows.

03541	7/8" X 17'	ADHESIVE	BROWN	12
03525	7/8" X 17'	ADHESIVE	WHITE	12

### ADJUSTABLE HEIGHT THRESHOLDS

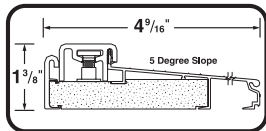

#### Adjustable/Thermal Break Threshold

Set screws allow for easy adjustment to seal uneven gaps between bottom of door and floor for a weathertight seal. "Thermal-break" design prevents frost build-up on interior surface of threshold.

WIDTH 4-9/16" – adjusts from 1-3/8" to 1-5/8" high

43822	36"		ALUMINUM	3
-------	-----	--	----------	---

#### PREMIUM FINISH

49008	36"		SATIN NICKEL	3
-------	-----	--	--------------	---

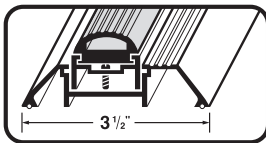

#### Adjustable Aluminum Threshold w/ Vinyl Seal

Set screws allow for easy adjustment to seal uneven gaps between bottom of door.

08664	36"		ALUMINUM	6
-------	-----	--	----------	---

### ALUMINUM THRESHOLDS W/VINYL SEAL

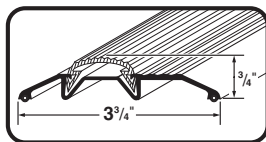

#### Deluxe Low Threshold w/Vinyl Seal

A deluxe low threshold available in premium finishes. Heavy extruded aluminum design with replaceable vinyl insert. Vinyl caulking feet seal bottom of threshold.

WIDTH 3-3/4" – HEIGHT 3/4"

08086	32"		ALUMINUM	6
08102	36"		ALUMINUM	6
08151	72"		ALUMINUM	6

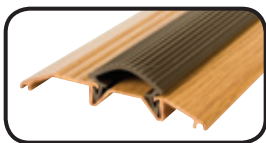

NEW MetalDecor™ Finish

#### PREMIUM FINISH

43151	36"		METALDECOR™ OAK	6
49004	36"		SATIN NICKEL	6
09043	36"		BRITE GOLD	6
09159	72"		BRITE GOLD	6
10116	36"		BRONZE	6

M-D# DESCRIPTION COLOR PACK QTY

ALUMINUM THRESHOLDS W/VINYL SEAL

**Deluxe High Threshold w/Vinyl Seal**

A deluxe high threshold available in premium finishes. Heavy extruded aluminum design with replaceable vinyl insert. Vinyl caulking feet seal bottom of threshold.

WIDTH 3-3/4" – HEIGHT 1-1/8"

08003	32"	ALUMINUM	6
08029	36"	ALUMINUM	6
08078	72"	ALUMINUM	6

**PREMIUM FINISH**

49006	36"	SATIN NICKEL	6
09365	36"	BRITE GOLD	6
10017	36"	BRONZE	6

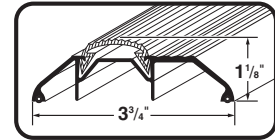

**Deluxe Extra High Threshold w/Vinyl Seal**

A deluxe extra high threshold. Heavy extruded aluminum design. Replaceable vinyl insert. Vinyl caulk feet seal bottom of threshold.

WIDTH 3-3/4" – HEIGHT 1-1/2"

08185	36"	ALUMINUM	6
-------	-----	----------	---

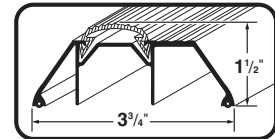

**Low Mini Threshold w/Vinyl Seal**

Extruded aluminum threshold with replaceable vinyl insert. Installs on door bottom or on top of existing wooden threshold.

WIDTH 1-3/8" – HEIGHT 7/16"

08243	36"	ALUMINUM	6
-------	-----	----------	---

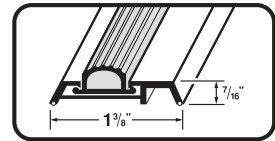

**Standard Duty Low Threshold w/Vinyl Seal**

Extruded aluminum threshold with vinyl seal. Vinyl caulking strips under legs.

WIDTH 3-3/8" – HEIGHT 3/4"

08383	36"	ALUMINUM	6
-------	-----	----------	---

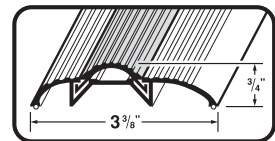

**Standard Duty High Threshold w/Vinyl Seal**

Extruded aluminum threshold with vinyl seal. Vinyl caulking strips under legs. Designed for use with thick pile carpet.

WIDTH 3-3/8" – HEIGHT 1-1/8"

08409	36"	ALUMINUM	6
-------	-----	----------	---

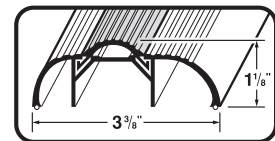

**Economy Low Threshold w/Vinyl Seal**

Economy aluminum threshold, low style, with vinyl seal.

WIDTH 3" – HEIGHT 3/4"

08748	36"	ALUMINUM	10
-------	-----	----------	----

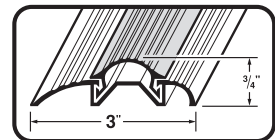

### HARDWOOD THRESHOLDS

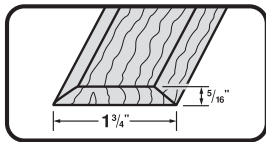

#### 1-3/4" Flat Hardwood Threshold

Hardwood.

WIDTH 1-3/4" – HEIGHT 5/16"

11882	36"	UNFINISHED	6
-------	-----	------------	---

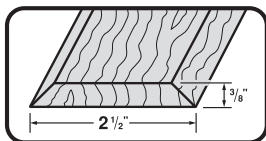

#### 2-1/2" Flat Hardwood Threshold

Hardwood.

WIDTH 2-1/2" – HEIGHT 3/8"

11908	36"	UNFINISHED	6
-------	-----	------------	---

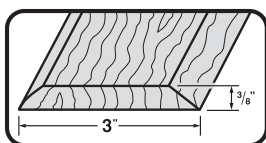

#### 3" Flat Hardwood Threshold

Hardwood.

WIDTH 3" – HEIGHT 3/8"

11924	36"	UNFINISHED	6
-------	-----	------------	---

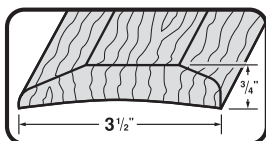

#### Hardwood Low Threshold

Attractive, hardwood provides a durable residential threshold. Low thermal transfer coefficient of wood helps save energy.

WIDTH 3-1/2" – HEIGHT 3/4"

11742	36"	UNFINISHED	6
11874	72"	UNFINISHED	6

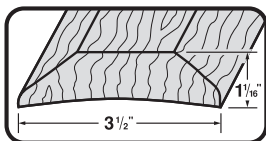

#### Hardwood High Threshold

Attractive, hardwood provides a durable residential threshold. Low thermal transfer coefficient of wood helps save energy.

WIDTH 3-1/2" – HEIGHT 1-1/16"

11767	36"	UNFINISHED	6
-------	-----	------------	---

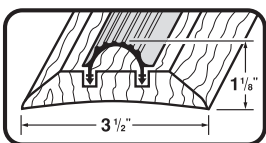

#### Hardwood Low Threshold w/Replaceable Vinyl Seal

Attractive, hardwood with flexible vinyl seal provides an attractive seal to block out cold air.

WIDTH 3-1/2" – HEIGHT 1-1/8" - LOW

11783	36"	UNFINISHED	6
-------	-----	------------	---

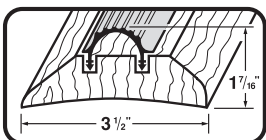

#### Hardwood High Threshold w/Replaceable Vinyl Seal

PREMIUM

Attractive, hardwood with flexible vinyl seal provides an attractive seal to block out cold air.

WIDTH 3-1/2" – HEIGHT 1-7/16" - HIGH

11809	36"	UNFINISHED	6
-------	-----	------------	---

M-D# DESCRIPTION COLOR PACK QTY

**SADDLE THRESHOLDS**

**1-3/4" Flat Top**

Extruded aluminum smooth flat top threshold.

WIDTH 1-3/4" – HEIGHT 1/8"

11056 36" ALUMINUM 6

**PREMIUM FINISH**

49010 36" SATIN NICKEL 6

09563 36" BRITE GOLD 6

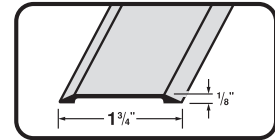

**2-1/2" Flat Top**

Extruded aluminum smooth flat top threshold.

WIDTH 2-1/2" – HEIGHT 1/4"

11072 36" ALUMINUM 6

**PREMIUM FINISH**

09613 36" BRITE GOLD 6

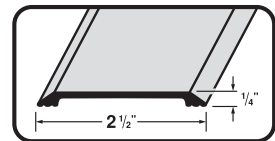

**Low Dome Top**

Extruded aluminum threshold with vinyl caulking strips under legs.

WIDTH 3-1/2" – HEIGHT 5/8"

11205 36" ALUMINUM 6

**PREMIUM FINISH**

09415 36" BRITE GOLD 6

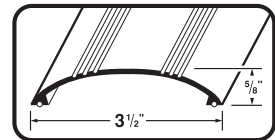

**NOTE:** Additional sizes and finishes available in M-D Ultra line on pages 36-37.

**High Dome Top**

Extruded aluminum threshold with vinyl caulking strips under legs.

WIDTH 3-1/2" – HEIGHT 1"

11346 36" ALUMINUM 6

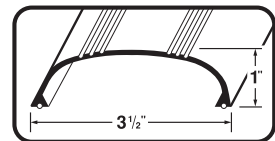

**NOTE:** Additional sizes and finishes available in M-D Ultra line on pages 36-37.

**BUMPER THRESHOLDS FOR OUTSWING DOORS**

**Deluxe Low Bumper Threshold – 5/8"**

A top quality extruded aluminum low threshold with replaceable vinyl insert and vinyl caulking strips under legs.

WIDTH 3-3/16" – HEIGHT 5/8"

08433 36" ALUMINUM 6

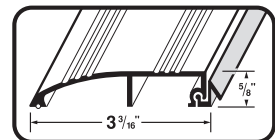

**Low Bumper Threshold – 3/4"**

Quality extruded aluminum threshold with replaceable vinyl inserts. Vinyl caulking strips under legs.

WIDTH 3-1/2" – HEIGHT 3/4"

08599 36" ALUMINUM 6

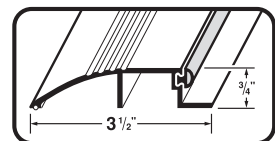

### BUMPER THRESHOLDS FOR OUTSWING DOORS

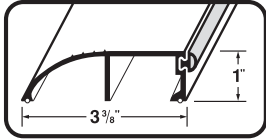

#### High Bumper Threshold – 1"

Quality extruded aluminum threshold with replaceable insert. Vinyl caulking strips under legs.

#### WIDTH 3-3/8" – HEIGHT 1"

08631	36"	ALUMINUM	6
08656	72"	ALUMINUM	6

#### PREMIUM FINISH

09548	36"	BRITE GOLD	6
10322	36"	BRONZE	6

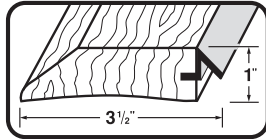

#### Hardwood Bumper Threshold – 1"

Attractive, hardwood bumper threshold with vinyl seal blocks out air and moisture.

#### WIDTH 3-1/2" – HEIGHT 1"

13748	36"		6
-------	-----	--	---

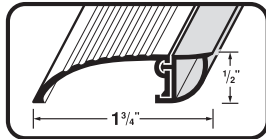

#### Low Mini Bumper Threshold – 1/2"

Vinyl insert designed to deflect water away from door.

#### WIDTH 1-3/4" – HEIGHT 1/2"

08904	36"	ALUMINUM	6
-------	-----	----------	---

#### PREMIUM FINISH

94091	36"	SATIN NICKEL	6
-------	-----	--------------	---

### SILL NOSINGS

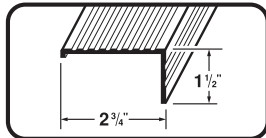

#### WIDTH 2-3/4" – HEIGHT 1-1/2"

13029	36"	ALUMINUM	6
-------	-----	----------	---

#### WIDTH 4-1/2" – HEIGHT 1-1/2"

13094	36"	ALUMINUM	6
-------	-----	----------	---

**NOTE:** Additional sizes and finishes available in M-D Ultra line on pages 37-38.

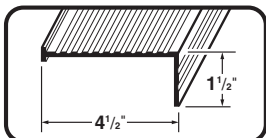

**NOTE:** Additional sizes and finishes available in M-D Ultra line on pages 37-38.

### VINYL REPLACEMENT INSERTS FOR THRESHOLDS



#### Fits Deluxe Aluminum Thresholds w/Vinyl Seal

43824	36"	GRAY	6
43826	72"	GRAY	6

M-D# DESCRIPTION COLOR PACK QTY

VINYL REPLACEMENT INSERTS FOR THRESHOLDS

**Fits Thresholds w/Metal Retainer Strip**

13219 36" GRAY 6

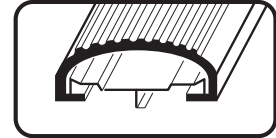

**Fits Deluxe Bumper Thresholds with "Flap" style insert**

13383 36" GRAY 6



**Fits Bumper Thresholds with "Bulb" style insert**

13409 36" GRAY 6



**Fits a variety of threshold styles**

13417 36" GRAY 10

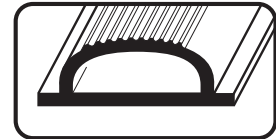

**Fits Standard and Economy style Aluminum Thresholds w/Vinyl Seal**

13466 36" GRAY 10

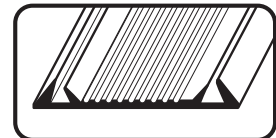

**Fits Hardwood Thresholds with vinyl seals**

13565 36" BRONZE 10

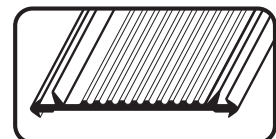

**For Adjustable Height Aluminum Thresholds w/Vinyl Seals**

13524 36" GRAY 6

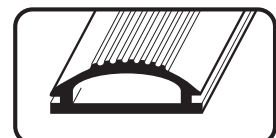

**Weatherstrip Assortments**

See Assortment Catalog for Assortment Contents and Costs

09427600 4 FT PACKAGED WEATHERSTRIP ASSORTMENT

09427618 8 FT PACKAGED WEATHERSTRIP ASSORTMENT

**Threshold, Door Bottoms Sweeps and Door Jamb Assortments**

See Assortment Catalog for Assortment Contents and Costs

09417470 4 FT THRESHOLDS / SWEEPS / DOOR JAMB ASSORTMENT

09417471 8 FT THRESHOLDS / SWEEPS / DOOR JAMB ASSORTMENT

09416553 VINYL CLAD WEATHERSTRIP ASSORTMENT

M-D#

DESCRIPTION

COLOR

PACK QTY

### WEATHERSTRIP & THRESHOLDS – COMMERCIAL

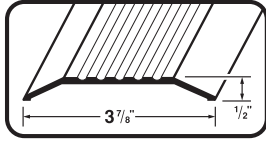

#### Fluted Top

Extruded aluminum saddle threshold.



WIDTH 3-7/8" – HEIGHT 1/2"

08763

36"

ALUMINUM

6

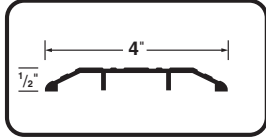

#### 4" Heavy Duty Fluted Top

##### COMMERCIAL

Ideal for commercial use. Heavy duty aluminum fluted top threshold.



##### EXTRA HEAVY DUTY

WIDTH 4" – HEIGHT 1/2"

11502

36"

ALUMINUM

6

11544

72"

ALUMINUM

6

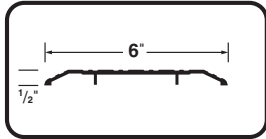

#### 6" Heavy Duty Fluted Top

##### COMMERCIAL

Extruded aluminum fluted top threshold.



##### HEAVY DUTY

WIDTH 6" – HEIGHT 1/2"

11619

36"

ALUMINUM

6

### ULTRA COMMERCIAL THRESHOLDS



**FIRE LABELED** – Products displaying this symbol are labeled as Gasketing Material FOR FIRE DOORS CLASSIFIED BY UNDERWRITERS LABORATORIES INC.



INTENDED FOR APPLICATION TO SWINGING TYPE FIRE DOORS; RATED UP TO 3 HOURS. Tested in accordance with **ASTM E-152, NFPA 252, UL-10B, UBC-432, CAN4-S104-M80.**

These products have been labeled and classified resulting from testing done by Underwriters Laboratories Inc. that these gasketing products do not adversely affect the fire resistance of the door or frame according to its rating in UL Building Materials Directory. All products are continuously monitored by UL to ensure compliance under the follow-up inspection service.



**HANDICAPPED** – Products displaying this symbol are 1/2" high or less and have no more than 1/4" vertical rise with slope portions not greater than 1:2. Meets requirements of **ADAAG-1992, CABO/ANSI A 117.1-1992, Title 24, CAC Sec 2-3303(i).** All products meet or exceed ADA requirements.



**SMOKE TESTED** – Meets requirements of: **NFPA-105-1989.** Products displaying this symbol have been successfully tested for smoke and draft. Performance evaluated with testing procedures defined by NFPA-105-1989. All products meet or exceed the performance criteria for allowable air leakage as specified by NFPA 105-1989 installation of Smoke-Control Door Assemblies. See below for test results.



**AIR INFILTRATION** – Tested to **ASTM E-283 and SDI 116.** Products displaying this symbol have been Air Infiltration tested in accordance with the requirements of ASTM E-283 Rate of Air Leakage Through Exterior Windows, Curtain Walls & Doors and SDI 116 Test Procedure and acceptance of Rate of Air Flow Through Closed Steel Door and Frame Assemblies (Steel Door Institute). All products shown with this symbol are well below the maximum leakage allowed.



**SOUND/LIGHT** – Products displaying this symbol are designed for use in openings where reduction of light and/or sound is necessary. Due to the variety of door and frame combinations, these products may vary in their performance. Tested to **ASTM E 90-90 and ASTM E-1408-91.**



M-D# DESCRIPTION COLOR PACK QTY

ULTRA COMMERCIAL THRESHOLDS

**Fluted Saddle Thresholds – 1/2" Height**

TH014

1/2" X 4" fluted saddle.



68288	36"	MILL	6
68296	72"	MILL	6
68304	36"	BRONZE	6
68312	72"	BRONZE	6



**Fluted Saddle Thresholds – 1/2" Height**

TH015

1/2" X 5" fluted saddle.



68320	36"	MILL	6
68338	72"	MILL	6
68346	36"	BRONZE	6
68353	72"	BRONZE	6

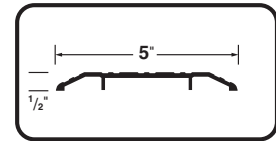

**Fluted Saddle Thresholds – 1/2" Height**

TH019

1/2" x 6" fluted saddle.



68635	36"	MILL	6
68692	72"	MILL	6
69828	36"	BRONZE	6
69833	72"	BRONZE	6

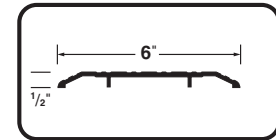

**Fluted Saddle Thresholds – 1/4" Height**

TH041

1/4" X 4" fluted saddle.



68361	36"	MILL	6
-------	-----	------	---



**Fluted Saddle Thresholds – 1/4" Height**

TH042

1/4" X 5" fluted saddle.



68387	36"	MILL	6
69808	72"	MILL	6
68395	36"	BRONZE	6
69811	72"	BRONZE	6

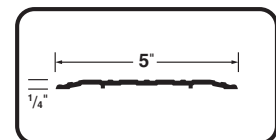

M-D#

DESCRIPTION

COLOR

PACK QTY

### ULTRA COMMERCIAL THRESHOLDS

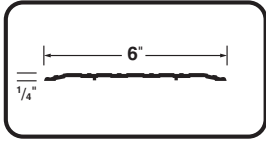

#### Fluted Saddle Thresholds – 1/4" Height

TH043

1/4" X 6" fluted saddle.



68627	36"	MILL	6
68684	72"	MILL	6
69816	36"	BRONZE	6
69824	72"	BRONZE	6

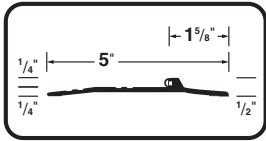

#### Panic Exit – Latch Track

TH040

1/2" X 5" panic exit.



68403	36"	MILL	6
69791	72"	MILL	6

### ULTRA COMMERCIAL DOOR BOTTOMS & SWEEPS

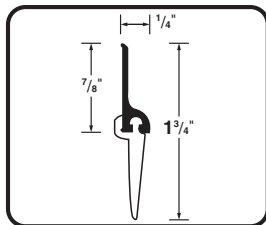

#### Door Sweeps

DB005

1-3/4" door sweep. Vinyl insert.

68601	36"	MILL	6
-------	-----	------	---

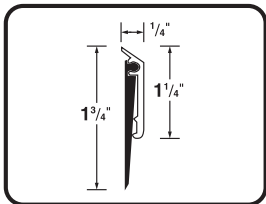

#### Commercial Grade Door Sweep

DB006

1-1/4" door sweep. EPDM rubber insert.



68247	36"	MILL	6
69604	48"	MILL	6
68254	36"	BRONZE	6
69609	48"	BRONZE	6

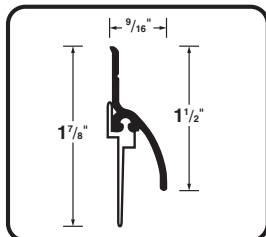

#### Door Sweeps w/Drip Caps

DB037

1-7/8" door sweep with drip cap. Vinyl insert.



68726	36"	MILL	6
68734	36"	BRONZE	6

WEATHERSTRIP, THRESHOLDS & DOOR ACCESSORIES

M-D# DESCRIPTION COLOR PACK QTY

ULTRA COMMERCIAL DOOR BOTTOMS & SWEEPS

**Door Bottoms**

DB054

1-3/4" extended door shoe. Vinyl insert.



68593 36"

MILL/VINYL

3

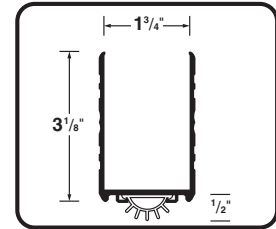

ULTRA COMMERCIAL WEATHERSTRIP/SMOKESEALS

**Silicone Smoke Seal Gasketing**

WS108

Silicone gasketing. U.L. listed and tested to limit air and smoke infiltration. Not affected by mildew, fungus or UV light.



1/4" THICK X 1/2" WIDE

68510 20'

BROWN

6

68668 20'

BLACK

6

68676 20'

WHITE

6

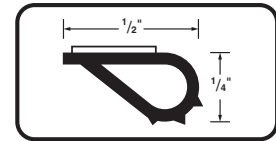

ULTRA RESIDENTIAL PREHUNG/MILLWORK – SILLS

**Fixed Vinyl Sills – Inswing**

TH397

1-1/8" x 5-3/4" fixed sill-rigid vinyl top.

78691 36"

ALUMINUM MILL

6

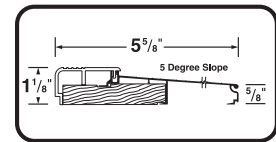

**Fixed Aluminum & Hardwood Sills – Outswing Bumper**

TH184

1" x 5-3/8" outswing sill. Foam insert.

78840 36"

MILL

6

78873 36"

BRONZE

6

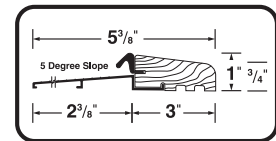

**Adjustable Aluminum & Hardwood Sills – Inswing**

TH393

1-1/8" x 4-9/16" aluminum & hardwood adjustable sill. Adjustment to 1-3/8" - slope 5 degrees.

76265 36"

MILL

6

76281 73"

MILL

6

77792 36"

BRONZE

6

77800 73"

BRONZE

6

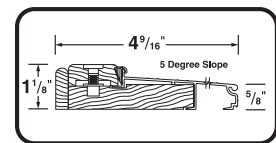

M-D#

DESCRIPTION

COLOR

PACK QTY

### ULTRA RESIDENTIAL PREHUNG/MILLWORK – SILLS

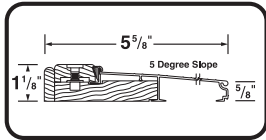

#### Adjustable Aluminum & Hardwood Sills – Inswing

TH394

1-1/8" x 5-5/8" aluminum & hardwood adjustable sill. Adjustment to 1-3/8" - slope 5 degrees.

78600	36"	MILL	6
78618	73"	MILL	6
78634	36"	BRONZE	6

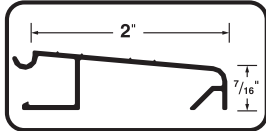

#### Inswing Extenders

TH200

2" aluminum sill extender (for TH394 and TH397 style sills).

67106	36"	MILL	3
67109	72"	MILL	3
67107	36"	BRONZE	3
67110	72"	BRONZE	3

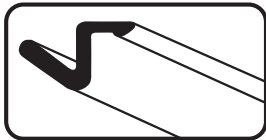

#### Kerf Weatherstrip

WS089

Vinyl clad foam. Recommended for commercial or residential use. Kerf installation.

70056	96"	BROWN	50
70068	96"	WHITE	50

### ULTRA RESIDENTIAL PREHUNG/MILLWORK – DOOR BOTTOMS & SWEEPS

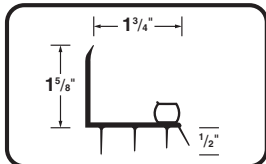

#### Door Bottoms

DB 347

Adjustable 1-3/4" door bottom (undersized 5/16" door size). PVC insert.

78899	36"	BROWN	6
78907	36"	WHITE	6

M-D# DESCRIPTION COLOR PACK QTY

**ULTRA RESIDENTIAL PREHUNG/MILLWORK – DOOR BOTTOMS & SWEEPS**

**Heavy Duty Door Sweep w/Vinyl Seal**

DB038

2-1/4" door sweep. Vinyl insert.

69612	36"	MILL	6
69620	48"	MILL	6
69633	36"	BRONZE	6
69638	48"	BRONZE	6
69644	36"	WHITE	6
69648	48"	WHITE	6
69652	36"	BRITE-DIP GOLD	6
25716	36"	SATIN NICKEL	6
25718	48"	SATIN NICKEL	6

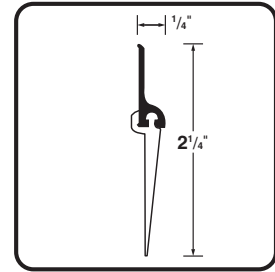

**L-Shaped Door Bottom w/Drip Cap**

DB001

1-3/8" or 1-3/4" L-shaped door shoe with drip. Vinyl insert.



81901	36"	MILL	6
69500	48"	MILL	6
81927	36"	BRONZE	6
69505	48"	BRONZE	6
81935	36"	WHITE	6
69514	48"	WHITE	6
81919	36"	BRITE-DIP GOLD	6
69521	48"	BRITE-DIP GOLD	6
25706	36"	SATIN NICKEL	6
25708	48"	SATIN NICKEL	6

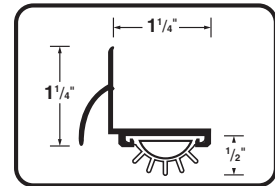

**U-Shaped Door Bottom w/Drip Cap**

DB002

1-3/8" U-shaped door shoe with rain drip. Vinyl Insert.



80622	36"	MILL	6
80630	36"	BRONZE	6

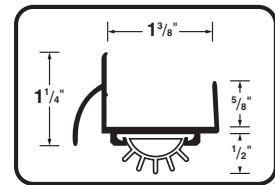

M-D#

DESCRIPTION

COLOR

PACK QTY

### ULTRA RESIDENTIAL PREHUNG/MILLWORK – DOOR BOTTOMS & SWEEPS

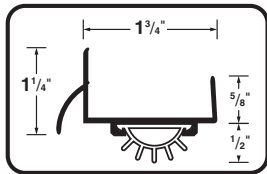

**DB003**

1-3/4" U-shaped door shoe with rain drip. Vinyl insert.



69539	36"	MILL	6
69547	48"	MILL	6
69554	36"	BRONZE	6
69562	48"	BRONZE	6
69570	36"	WHITE	6
69588	48"	WHITE	6
69591	36"	BRITE-DIP GOLD	6
69596	48"	BRITE-DIP GOLD	6
25710	36"	SATIN NICKEL	6
25714	48"	SATIN NICKEL	6

**Vinyl Replacement Insert For Door Bottoms**

25756	36"	FOR L-SHAPE AND U-SHAPED ALUMINUM DOOR BOTTOMS	BLACK	10
-------	-----	--	-------	----

### ULTRA RESIDENTIAL THRESHOLDS

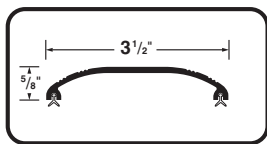

**Low Dome Top Threshold**

**TH008**

5/8" X 3-1/2" all purpose.



79996	36"	MILL	6
79962	72"	MILL	6
80374	36"	BRONZE	6
79988	72"	BRONZE	6
80465	36"	WHITE	6
81661	72"	WHITE	6
80317	36"	BRITE-DIP GOLD	6
79970	72"	BRITE-DIP GOLD	6
25734	36"	SATIN NICKEL	6
25736	72"	SATIN NICKEL	6

M-D# DESCRIPTION COLOR PACK QTY

ULTRA RESIDENTIAL THRESHOLDS

**High Dome Top Threshold**

TH009

1" X 4" all purpose.



81679	36"	MILL	6
81687	72"	MILL	6
81810	36"	BRONZE	6
70077	72"	BRONZE	6
81828	36"	WHITE	6
69737	72"	WHITE	6
81697	36"	BRITE-DIP GOLD	6
81703	72"	BRITE-DIP GOLD	6
25740	36"	SATIN NICKEL	6
25742	72"	SATIN NICKEL	6

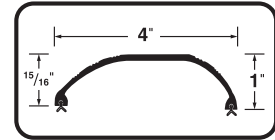

**Extra High Dome Top Threshold**

TH010

1-1/4" X 4" all purpose.



69733	36"	MILL	6
69745	72"	MILL	6
69749	36"	BRONZE	6
69752	72"	BRONZE	6

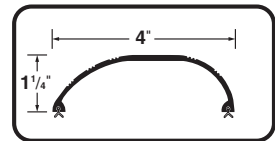

**Bumper Threshold**

TH153

1-1/4" X 4" all purpose.



69694	36"	MILL	6
69698	72"	MILL	6
69703	36"	BRONZE	6
69709	72"	BRONZE	6

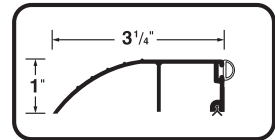

### ULTRA RESIDENTIAL THRESHOLDS

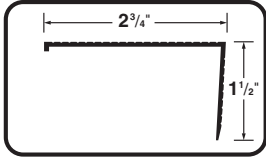

#### Sill Nosing

##### TH026

2-3/4" X 1-1/2" Sill Nosing.

81869	36"	MILL	6
81877	72"	MILL	6
77891	36"	BRONZE	6
81893	72"	BRONZE	6
77883	36"	WHITE	6
69839	72"	WHITE	6
77909	36"	BRITE GOLD	6
81885	72"	BRITE-DIP GOLD	6
25744	36"	SATIN NICKEL	6
25748	72"	SATIN NICKEL	6

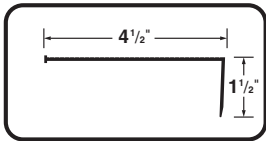

#### Sill Nosing

##### TH083

4-1/2" X 1-1/2" Sill Nosing.

69848	36"	MILL	6
69844	72"	MILL	6
69851	36"	BRONZE	6
69858	72"	BRONZE	6
69860	36"	WHITE	6
69867	72"	WHITE	6
69875	36"	BRITE-DIP GOLD	6
69871	72"	BRITE-DIP GOLD	6
25750	36"	SATIN NICKEL	6
25752	72"	SATIN NICKEL	6

### ULTRA RESIDENTIAL - WEATHERSTRIP/ASTRAGALS

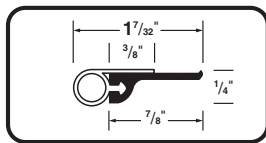

#### Flat Profile Door Jamb Weatherstrip Kits

##### WS003

1/4" x 7/8" jamb strip.



68429	36" X 84"	MILL	10
69909	72" X 84"	MILL	10
69901	72" X 96"	MILL	10
68437	36" X 84"	BRONZE	10
69911	72" X 84"	BRONZE	10
69918	72" X 96"	BRONZE	10
69923	36" X 84"	WHITE	10
69927	72" X 84"	WHITE	10
69938	72" X 96"	WHITE	10
69935	36" X 84"	BRITE-DIP GOLD	10
69940	72" X 84"	BRITE-DIP GOLD	10
69945	72" X 96"	BRITE-DIP GOLD	10
25730	36" X 84"	SATIN NICKEL	10
25732	72" X 96"	SATIN NICKEL	10



WEATHERSTRIP, THRESHOLDS & DOOR ACCESSORIES

M-D# DESCRIPTION COLOR PACK QTY

ULTRA RESIDENTIAL – WEATHERSTRIP/ASTRAGALS

**Wedge Style Door Jamb Weatherstrip Kits**

WS268

Wedge weatherstrip. 3/8" thick vinyl bulb.



77768 36" X 80" FLAP MILL 10

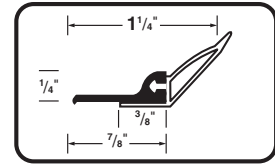

**T-Astragal**

WS009

3/4" x 7/8" astragal. Vinyl insert.

69956	84"	MILL	6
69969	84"	BRONZE	6
69962	84"	WHITE	6
69974	84"	BRITE-DIP GOLD	6
25722	84"	SATIN NICKEL	6
25724	96"	SATIN NICKEL	6

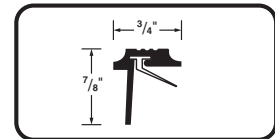

**T-Astragal**

WS011

7/8" x 1-5/16" astragal. Vinyl insert.

68544	84"	MILL	3
69989	84"	WHITE	3

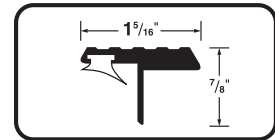

**Aluminum Locking Slide Bolt Combination Astragal**

WS059

Surface mount astragal. Vinyl insert for a weathertight seal. Locking bolt for security.

01560	80"	CLEAR ANODIZED	2
01586	80"	BRONZE	2
70023	96"	BRONZE	2
87791	80"	WHITE	2
70031	96"	WHITE	2
87809	80"	BRITE-DIP GOLD	2
25726	80"	SATIN NICKEL	2

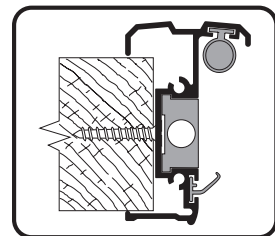

**Threshold, Door Bottoms Sweeps and Door Jamb Assortments**

See Assortment Catalog for Assortment Contents and Costs

- 09417472 2 FT ULTRA RESIDENTIAL THRESHOLD & DOOR BOTTOM ASSORTMENT
- 09417473 2 FT ULTRA JAMB-UP / INSERTS / DOOR BOTTOMS ASSORTMENT
- 09417474 4 FT ULTRA THRESHOLDS / SWEEPS / DOOR BOTTOMS ASSORTMENT
- 09417475 8 FT ULTRA THRESHOLD / DOOR BOTTOM ASSORTMENT

### DOOR ACCESSORIES

#### Screen Door Grilles

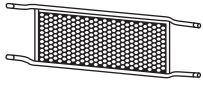

#### PUSH GRILLES

33167	8" X 32"	MILL	3
33209	8" X 36"	MILL	3

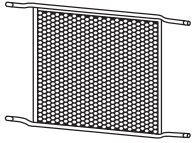

#### DOOR GRILLES

33282	19" X 32"	MILL	3
33308	19" X 32"	WHITE	3
33324	19" X 32"	BRONZE	3
33340	19" X 36"	MILL	3
33365	19" X 36"	WHITE	3
33381	19" X 36"	BRONZE	3

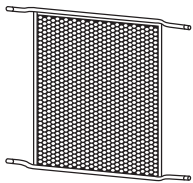

#### PATIO GRILLES

33605	30" X 36"	MILL	3
33118	30" X 36"	WHITE	3
33621	30" X 36"	BRONZE	3

#### Door Grille Assortment

See Assortment Catalog for Assortment Contents and Costs

09945346 DOOR GRILLE ASSORTMENT

### MAIL SLOTS

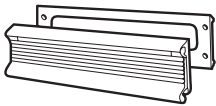

#### Mail Slots

#### ALUMINUM MAIL SLOTS – FLAP & BACK PLATE

28472	10"	SILVER	3
28787	10"	BRITE BRASS (ALUMINUM)	3
28506	13"	SILVER	3
28795	13"	BRITE BRASS (ALUMINUM)	3

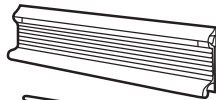

#### ALUMINUM MAIL SLOTS – FLAP & HOOD

28555	13"	SILVER	3
28571	13"	BLACK	3
28803	13"	BRITE BRASS (ALUMINUM)	3

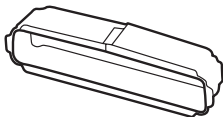

#### Mail Slot Liners

28639	FOR 10" MAIL SLOT & 1-3/4" DOOR		6
28654	FOR 13" MAIL SLOT & 1-3/4" DOOR		6

# SMARTTOOL™



### SMARTTOOL™ LEVELS & MODULES

Go to [smarttoollevels.com](http://smarttoollevels.com) for additional information

## SMARTTOOL™ THE DIGITAL LEVEL LEADER FOR OVER 20 YEARS

### SmartTool™ Levels and Modules

Digitally displays all angles (not just level and plumb) in degrees, % slope or rise/run. Runs for over five-hundred hours on included 9 volt battery. SmartTool beeps at any angle you choose. Custom sensor is manufactured in the USA for unmatched accuracy.

### SmartTool™ Digital Levels (Domestic) Inches Per Foot

92346	BUILDER'S ANGLE SENSOR MODULE (IN/ FT) W/CARRYING CASE		1
92288	24" SMARTTOOL DIGITAL LEVEL (IN/FT)		1
92379	24" SMARTTOOL DIGITAL LEVEL (IN/FT) W/ CARRYING CASE	NEW	1
92296	48" SMARTTOOL DIGITAL LEVEL (IN/FT)		1
92325	48" SMARTTOOL DIGITAL LEVEL (IN/FT) W/ CARRYING CASE	NEW	1
92395	MAGNETIC BRACKET (USE WITH MODULE)		1

### SmartTool™ Digital Levels (International) Millimeters Per Meter

93969	BUILDER'S ANGLE SENSOR MODULE (MM/M) W/CARRYING CASE	NEW	1
93967	60 CM SMARTTOOL DIGITAL LEVEL (MM/M)	NEW	1
94005	60 CM SMARTTOOL DIGITAL LEVEL (MM/M) W/CARRYING CASE	NEW	1
93968	120 CM SMARTTOOL DIGITAL LEVEL (MM/M)	NEW	1
94010	120 CM SMARTTOOL DIGITAL LEVEL (MM/M) W/CARRYING CASE	NEW	1
92395	MAGNETIC BRACKET (USE WITH MODULE)		1

### ADA Digital Slope Walker™

Measures slopes, cross slopes, sidewalks, and curb height in handicap accessible areas. 16" SmartTool with two pivoting feet set at 12" spacing to provide stable readings. Designed to save your back and knees. 1-1/2" clearance over debris at construction sites. Designed for ADA contractors and inspectors.

93975	SMARTTOOL ADA DIGITAL SLOPE WALKER W/CARRYING CASE	NEW	1
-------	--	-----	---

### SmartLaser™

Combines high accuracy (0.05°) SmartTool™ electronic module with laser technology. A professional tool that will extend a line at any angle. Saves time and labor. Includes soft sided carrying case.

92437	SMARTLASER (SMARTTOOL™ W/LASER) IN / FT		1
-------	---	--	---

### SmartTool™ Carrying Cases

Durable SmartTool™ carrying cases are padded for tool protection. Builder's Angle Sensor Module Carrying Case features a belt clip for easy access.

92910	BUILDER'S ANGLE SENSOR MODULE CARRYING CASE	NEW	1
92908	24" / 60CM PADDED VINYL CASE		1
92924	48" / 120CM PADDED VINYL CASE		1



# FLOORING INSTALLATION TOOLS



M-D#

DESCRIPTION

COLOR

PACK QTY

### TILE INSTALLATION TOOLS

#### Fusion™ Series Tools

Fusion™ Wet Saws – Portable and ridged wet saws for cutting tile, stone, granite & marble

48190 7" FUSION™ WET SAW  
3/4 HP with patented ridged steel cage frame 1

48191 7" FUSION™ WET SAW  
1 HP with cast aluminum cutting table and patented steel cage frame NEW 1

48088 7" FUSION™ WET SAW REPLACEMENT BLADE  
Wet-cutting continuous rim type blade - designed to provide long life and chip free cutting. 5/8" arbor fits #48190 and #48191 Fusion™ Wet Saws. NEW 1

49046 4" FUSION™ MARBLE/TILE SAW  
Includes laser guide and adjustable steel base for bevel cuts 1

#### Fusion™ Mixer & Mixing Paddles

48152 FUSION™ MIXER  
The ultimate mixer for mortars, grouts and other viscous materials. Thumb dial for complete RPM control. 1

48154 FUSION™ MIXER REPLACEMENT PADDLE  
Replacement paddle for Fusion™ Mixer. Threaded shaft creates a positive connection. 6

49058 DELUXE MIXER PADDLE  
Fits a standard 1/2" drive drill. Mixes a variety of materials. 3

#### Tile Cutters & Accessories

Manual tile cutters for repetitive cutting. Selection covers first-time users to seasoned professionals.

49194 14" TILE CUTTER  
Economy cutter for general purpose use NEW 4

49195 20" TILE CUTTER  
General purpose cutter for cutting up to 14" x 14" tile (diagonally) NEW 4



M-D#	DESCRIPTION	COLOR	PACK QTY
------	-------------	-------	----------

**TILE INSTALLATION TOOLS**

**Tile Cutters & Accessories (continued)**

49047 20" TILE CUTTER (PRO)  
Ball bearing carriage for smooth operation. Includes handy carrying bag.

1



49905 24" TILE CUTTER (PRO)  
Heavy-duty extruded aluminum base. Includes handy carrying bag.

1



49096 1/2" CARBIDE CUTTING WHEEL  
For use with #49194 (14" Tile Cutter)

6



49078 7/8" TITANIUM COATED CARBIDE CUTTING WHEEL  
For use with #49195 (20" Tile Cutter)

6



48158 7/8" TITANIUM COATED CARBIDE CUTTING WHEEL (PRO)  
For use with #49047 & #49905 (20" & 24" Tile Cutters)

6

**Layout Tools**

Tools assist in determining starting point of your job, creating straight tile lines and allowing cut tiles to fall at the edges of a room.

49887 LASER CHALK LINE (PRO)  
Eliminate the need for chalk with this versatile laser line

4



00760 CONTRACTOR CHALK REEL  
100' Tuff Line™ Braided Poly/Cotton line for strength

6



00687 100' CHALK REPLACEMENT REEL LINE  
Replacement Poly/Cotton Line for M-D #00760

6



M-D#

DESCRIPTION

COLOR

PACK QTY

### TILE INSTALLATION TOOLS

#### Scrapers

Heavy-duty scrapers remove old floor or wall coverings. High carbon replaceable steel blades.

49847 4" ADJUSTABLE FLOOR & WALL SCRAPER (PRO) 3  
Removes adhesive and wall coverings. Handle extends to 24".

49977 4" FLOOR & WALL SCRAPER REPLACEMENT BLADES 6  
Replacement blades for #49847, #48114, and #48160

49126 7" HEAVY DUTY FLOOR SCRAPER 3  
Provides increased leverage when removing old flooring

49084 7" FLOOR SCRAPER REPLACEMENT BLADE 6  
Replacement blade for #49126

#### Hand Tools

Variety of saws and cutting tools when making irregular cuts or holes in tile/backer board.

49054 TILE NIPPERS 6  
Tungsten tipped - great for irregular cuts

49943 COMPOUND TILE NIPPERS (PRO) 6  
Twice the power of conventional nippers

49062 TILE PLIERS / HAND CUTTER 6  
Only cutting tool you need for small format tile. Great when tiling around toilets.





M-D#	DESCRIPTION	COLOR	PACK QTY
------	-------------	-------	----------

**TILE INSTALLATION TOOLS**

**Hand Tools (continued)**

49074 COPING SAW  
Clean, controllable cutting action for cutting curves in tile

6



49094 6" ROD SAW BLADE  
Replacement blade for #49074

6



49070 BACKER BOARD SCORING KNIFE  
Dust free - scores all types of cement based backer boards

6



49985 CONTOUR GAUGE  
No-rust plastic - creates an instant template for marking precise cuts

6



49144 CHINA MARKERS  
Installer's choice – great way to mark tile, marble and granite before making your cut. Easy clean up.

6



**Economy Trowels**

Economy grade trowels in common sizes for the DIY'er.

49100 ECONOMY SQUARE NOTCH 1/4" X 1/4" X 1/4"

12

49102 ECONOMY SQUARE NOTCH 1/4" X 3/8" X 1/4"

12

49104 ECONOMY SQUARE NOTCH 1/2" X 1/2" X 1/2"

12

20064 ECONOMY SQUARE NOTCH 1/16" X 1/16" X 1/16"

12

49108 ECONOMY V NOTCH 3/16" X 5/32"

12

20065 ECONOMY V NOTCH 1/8" X 1/8" X 1/16"

12

20063 ECONOMY U NOTCH 1/16" X 1/32" X 1/32"

12

30004 ECONOMY FLAT V NOTCH 3/32" X 3/32" X 3/32"

12



### TILE INSTALLATION TOOLS

#### Premium Trowels

Comfortable TPR handle - Designed for contractors.



Notch Size Etched on Blade



TPR Handle

49110	PREMIUM SQUARE NOTCH 1/4" X 1/4" X 1/4"	6
49112	PREMIUM SQUARE NOTCH 1/4" X 3/8" X 1/4"	6
49038	PREMIUM SQUARE NOTCH 1/2" X 1/2" X 1/2"	6
20045	PREMIUM SQUARE NOTCH 1/4" X 1/8" X 1/4"	6
20056	PREMIUM SQUARE NOTCH 1/16" X 1/16" X 1/16"	6
20098	PREMIUM SQUARE NOTCH (LH) 1/16" X 1/16" X 1/16"	6
20057	PREMIUM SQUARE NOTCH 1/8" X 1/8" X 1/8"	6
20058	PREMIUM SQUARE NOTCH 3/16" X 3/16" X 3/16"	6
20048	PREMIUM SQUARE NOTCH (14") 1/16" X 1/16" X 1/16"	6
20044	PREMIUM U NOTCH 1/16" X 1/32" X 5/64"	6
20051	PREMIUM U NOTCH 1/16" X 1/32" X 1/32"	6
20097	PREMIUM U NOTCH (LH) 1/16" X 1/32" X 1/32"	6
20052	PREMIUM U NOTCH 1/16" X 1/16" X 3/32"	6
20053	PREMIUM U NOTCH 1/8" X 1/8" X 1/16"	6
20054	PREMIUM U NOTCH 1/8" X 3/16" X 1/8"	6
20055	PREMIUM U NOTCH 1/8" X 1/8" X 1/8"	6
20047	PREMIUM U NOTCH (14") 1/16" X 1/32" X 1/32"	6
49116	PREMIUM V NOTCH 1/4" X 3/16"	6
20059	PREMIUM V NOTCH 3/16" X 5/32"	6
20060	PREMIUM FLAT V NOTCH 3/32" X 3/32" X 3/32"	6
20061	PREMIUM FLAT V NOTCH 1/8" X 1/8" X 1/16"	6
20099	PREMIUM FLAT V NOTCH (LH) 1/8" X 1/8" X 1/16"	6
30000	PREMIUM FLAT V NOTCH 3/16" X 1/4" X 5/16"	6
20049	PREMIUM FLAT V NOTCH (14") 1/8" X 1/8" X 1/16"	6
20062	PREMIUM FLAT TROWEL 4" X 14"	6
20050	PREMIUM FLAT POOL FINISHING 4" X 16"	6

#### Professional Trowels

Professional grade Stainless Steel trowels. Easy to clean and rust resistant. Ergonomic handle.

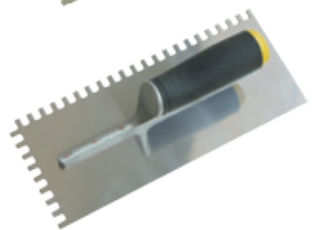
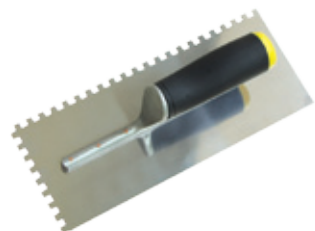

49819	PRO SQUARE NOTCH 1/4" X 1/4" X 1/4"	6
49821	PRO SQUARE NOTCH 1/4" X 3/8" X 1/4"	6
49807	PRO SQUARE NOTCH 1/2" X 1/2" X 1/2"	6
49823	PRO V NOTCH 3/16" X 5/32"	6

M-D#	DESCRIPTION	COLOR	PACK QTY
------	-------------	-------	----------

**TILE INSTALLATION TOOLS**

**Miscellaneous Trowels**

Specialized trowels to make the job faster and for getting into tight spaces

49120	MARGIN TROWEL		6
-------	---------------	--	---



49124	POINTING TROWEL		6
-------	-----------------	--	---



**Spacers**

For accurate tile alignment in a range of sizes.

49162	1/16 SPACERS	250/BAG	12
49168	1/8" SPACERS	200/BAG	12
49164	3/16" SPACERS	150/BAG	12
49160	1/4" SPACERS	100/BAG	12
49166	3/8" SPACERS	50/BAG	12



**Grout Floats**

Multiple grouting floats for job specific applications. Include ergonomic TPR handles.

49118	ECONOMY GROUT FLOAT Lightweight molded grout float		6
-------	---	--	---



49827	GUM RUBBER GROUT FLOAT (PRO) Lightweight float - edges are beveled and two front corners rounded for spreading grout evenly		6
-------	--	--	---



49829	EPOXY GROUT FLOAT (PRO) Dense green rubber pad used with tough-to-spread epoxy and modified grouts		6
-------	---	--	---



49837	MARGIN FLOAT (PRO) Ideal for spreading grout around backsplashes and toe kicks		6
-------	---	--	---



M-D#

DESCRIPTION

COLOR

PACK QTY

### TILE INSTALLATION TOOLS

#### Grouting Supplies

Various grouting tools for spreading or removing grout.



48155 M-D GROUT MONSTER SAW 6  
Use to remove damaged grout prior to repair. Vibrating carbide grit-edge blade makes grout removal effortless.



49066 TILE GROUT SAW – HEAVY DUTY 6  
For use in repairing or replacing damaged grout



49090 TILE GROUT SAW REPLACEMENT BLADES 6  
Replacement blades for #49066



49136 GROUT BAG 6  
For easy application of grout on detailed installations



49174 GROUT SPREADER 6  
Lightweight reusable spreader



49146 TILE AND GROUT BRUSH 6  
Quality brush effectively scrubs dirty grout lines



49142 GROUTING GLOVES 6  
Protects hands from harsh chemicals

M-D# DESCRIPTION COLOR PACK QTY

TILE INSTALLATION TOOLS

**Grouting Supplies (continued)**

49134 SEAL 'O WHEEL  
Easy applicator bottle for use with sealer to protect new and restore old grout

6



49152 SPONGE  
For clean-up of grout haze and hardened grout. Maximum holding power.

10



49156 SCRUBBING SPONGE  
Double texture – grout sponge on one side and scrubbing sponge on the other

10



**Tile Installation Bucket**

Complete with all the essential professional grade items needed to install floor tile.

49834 CERAMIC FLOOR TILE INSTALLATION BUCKET KIT  
Kit includes a tile installation trowel, tile nippers, grout float, sponge, gloves, tile spacers and a sturdy reusable 2.5 gallon plastic bucket

NEW

4



**Folding Saw Horse**

Made from galvanized steel. Heavy duty load capacity.

27094 28-1/2" HIGH X 31" WIDE

1



**Tile Installation Tools Assortments**

See Assortment Catalog for Assortment Contents and Costs

- 09417084 4 FT TILE INSTALLATION TOOL ASSORTMENT
- 09417370 4 FT PRO TILE INSTALLATION TOOL ASSORTMENT

M-D#

DESCRIPTION

COLOR

PACK QTY

### CARPET INSTALLATION TOOLS



#### Knee Kickers

Stretches carpet over tack strip to ensure carpet fits tight and lies flat.

60000 PROFESSIONAL KNEE KICKER  
Adjustable pin depth and handle. Includes carrying bag. 1



48113 ADJUSTABLE KNEE KICKER  
Adjustable pin depth allows for use with any carpet. Handle adjusts from 19" to 24". 1



#### Seam Rollers

Used to roll soft flooring goods, carpet seams and wall coverings to strengthen adhesive bond.

48076 SMOOTH SEAM ROLLER – 3"  
Improves seam strength by forcing adhesive into carpet backing 6



48078 SMOOTH SEAM ROLLER – 6"  
Improves seam strength by forcing adhesive into carpet backing 6



48080 STAR WHEEL CARPET SEAM ROLLER – 3"  
Star wheel design blends carpet yarn at seam 6



48082 STAR WHEEL CARPET SEAM ROLLER – 6"  
Star wheel design blends carpet yarn at seam 6



48084 EXTENDABLE WALL AND FLOOR ROLLER  
Raised handle provides increased leverage and control 3

M-D#	DESCRIPTION	COLOR	PACK QTY
------	-------------	-------	----------

**CARPET INSTALLATION TOOLS**

**Cutters**

Cut all types of carpet for any installation method.

48098 CUSHION BACK CUTTER 6  
Locking dual blades allow for close cuts on either side of the row



48100 LOOP PILE CUTTER 6  
Adjustable throat opening for precise cuts



**Shears**

48104 7" DUCKBILL NAPPING SHEARS 6  
Offset handle allows level cutting



**Tucking Tools**

Will tuck and set carpet into stair crevices and tack strip.

48106 PLASTIC TUCKING TOOL – 3-1/2" 6  
For tucking around delicate materials, baseboards, tile, and plumbing fixtures



48108 STAIR TOOL – 3-1/2" 6  
Heavy duty tucking tool for setting carpet into stair crevices and tack strip



**Knives**

Three types of knives for cutting a variety of materials including carpet, carpet pad, vinyl tile, vinyl sheet goods, linoleum, wallpaper etc.

48086 PRO UTILITY 6  
Internal blade storage and slip resistant grip



48092 LINOLEUM KNIFE 6  
Excellent tucking tool with high carbon steel blade



48094 PRO RAZOR KNIFE 6  
Cuts hard to reach areas. Thumb screw for easy blade exchange.



48090 LED KNIFE 6  
Quick blade change feature, takes standard utility blades. Has built in light that allows for precise cuts in dimly lit areas.



M-D#

DESCRIPTION

COLOR

PACK QTY

### CARPET INSTALLATION TOOLS

#### Scrapers

Ideal for scraping floors, walls and countertops.

48114 4" SCRAPER WITH 12" HANDLE  
Extra durable blade holder with three tightening screws 3

48160 4" SCRAPER WITH 18" HANDLE  
Extra durable blade holder with three tightening screws 6

49977 4" FLOOR & WALL SCRAPER REPLACEMENT BLADES  
Replacement blades for item #'s 49847, 48114, 48160 6

#### Chrome Rollers

48194 75 POUND HARD CHROME ROLLER  
Corrosion resistant hard chrome plated solid 5" steel rollers. Removable handle for convenient storage and a protective padded cover. 1

48195 100 POUND HARD CHROME ROLLER  
Corrosion resistant hard chrome plated solid 5" steel rollers. Removable handle for convenient storage and a protective padded cover. 1

#### Miscellaneous Carpet Tools

48110 STAPLE HAMMER  
Ideal for stapling pad. Well balanced for easy use. 6

48120 ROW RUNNER  
Dual heads for use on cut pile or loop pile carpet 6





# FLOORING PRODUCTS

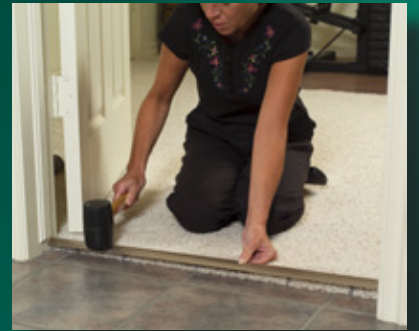

### ALUMINUM FLOOR & CARPET TRIM



#### MultiFloor Transitions with Hidden Fasteners

Adjust to varying floor heights for easy DIY installation! Can be positioned after hard surface floors and adjoining floors have been installed. Hidden fasteners for safety and better appearance.

46131	36"	SILVER	3
46133	72"	SILVER	3
46137	36"	GOLD	3
46139	72"	GOLD	3
43811	36"	PEWTER	3
43813	72"	PEWTER	3



#### MultiFloor Transitions with Hidden Fasteners – MetalDecor™ Finish

Aluminum MultiFloor Transitions with the look of finished hardwood (MetalDecor™)

46141	36"	OAK	3
46145	72"	OAK	3
46147	36"	CHERRY	3
46149	72"	CHERRY	3
46240	36"	BEECH	3
46244	72"	BEECH	3

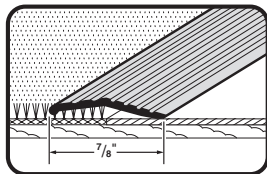

#### Carpet Trim

##### FLUTED

78006	7/8" X 36"	SCREW NAILS	SILVER	6
78089	7/8" X 72"	SCREW NAILS	SILVER	6
79004	7/8" X 36"	SCREW NAILS	SATIN BRASS	6
79087	7/8" X 72"	SCREW NAILS	SATIN BRASS	6
43748	7/8" X 96"	BULK	SATIN BRASS	12

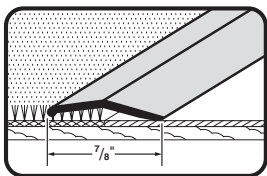

##### SMOOTH

66001	7/8" X 36"	SCREW NAILS	POLISHED	6
66217	7/8" X 72"	SCREW NAILS	POLISHED	6

M-D# DESCRIPTION COLOR PACK QTY

ALUMINUM FLOOR & CARPET TRIM

Carpet Trim – Wide

METALDECOR™ FINISH

Durable aluminum transitions with the look of finished hardwood. Matching fasteners.

40120	1-3/8" X 36"	SCREW NAILS	OAK	6
40122	1-3/8" X 72"	SCREW NAILS	OAK	6
40124	1-3/8" X 36"	SCREW NAILS	CHERRY	6
40126	1-3/8" X 72"	SCREW NAILS	CHERRY	6



FLUTED

78071	1-3/8" X 36"	SCREW NAILS	SILVER	6
78154	1-3/8" X 72"	SCREW NAILS	SILVER	6
43712	1-3/8" X 96"	BULK	SILVER	12
79079	1-3/8" X 36"	SCREW NAILS	SATIN BRASS	6
79152	1-3/8" X 72"	SCREW NAILS	SATIN BRASS	6
43714	1-3/8" X 96"	BULK	SATIN BRASS	12
43854	1-3/8" X 36"	SCREWS	PEWTER	6
43856	1-3/8" X 72"	SCREWS	PEWTER	6
43928	1-3/8" X 96"	BULK	PEWTER	12
74187	1-3/8" X 36"	SCREW NAILS	ALMOND	6
74336	1-3/8" X 72"	SCREW NAILS	ALMOND	6

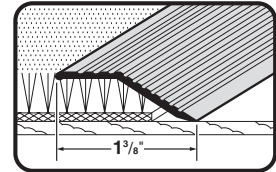

SMOOTH

45907	1-3/8" X 36"	SCREW NAILS	CHARCOAL	6
45909	1-3/8" X 72"	SCREW NAILS	CHARCOAL	6
66092	1-3/8" X 36"	SCREW NAILS	POLISHED	6
66472	1-3/8" X 72"	SCREW NAILS	POLISHED	6
67439	1-3/8" X 96"	SCREW NAILS	POLISHED	6
72074	1-3/8" X 36"	SCREW NAILS	SATIN BRASS	6
72256	1-3/8" X 72"	SCREW NAILS	SATIN BRASS	6

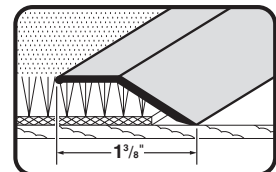

Carpet Trim – Wide

HAMMERED

43716	1-3/8" X 96"	BULK	SILVER	6
43718	1-3/8" X 96"	BULK	SATIN BRASS	12

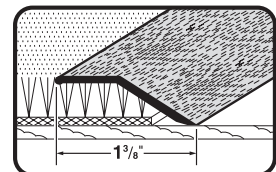

### ALUMINUM FLOOR & CARPET TRIM

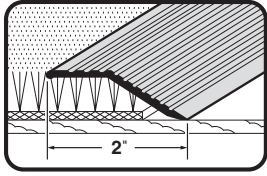

#### Carpet Trim – Extra Wide

##### FLUTED

78212	2" X 36"	SCREW NAILS	SILVER	6
78220	2" X 72"	SCREW NAILS	SILVER	6
48188	2" X 96"	BULK	SILVER	12
79244	2" X 36"	SCREW NAILS	SATIN BRASS	6
79251	2" X 72"	SCREW NAILS	SATIN BRASS	6
43755	2" X 96"	BULK	SATIN BRASS	12
43858	2" X 36"	SCREW NAILS	PEWTER	6
43860	2" X 72"	SCREW NAILS	PEWTER	6
74930	2" X 36"	SCREW NAILS	ALMOND	6
74971	2" X 72"	SCREW NAILS	ALMOND	6

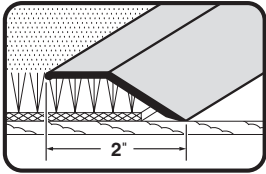

##### SMOOTH

66084	2" X 36"	SCREW NAILS	POLISHED	6
66449	2" X 72"	SCREW NAILS	POLISHED	6
72066	2" X 36"	SCREW NAILS	SATIN BRASS	6
72249	2" X 72"	SCREW NAILS	SATIN BRASS	6

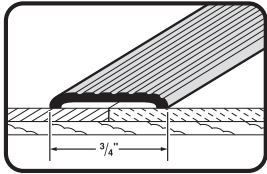

#### Seam Binder

##### FLUTED

78048	3/4" X 36"	SCREW NAILS	SILVER	6
78121	3/4" X 72"	SCREW NAILS	SILVER	6
79046	3/4" X 36"	SCREW NAILS	SATIN BRASS	6
79129	3/4" X 72"	SCREW NAILS	SATIN BRASS	6

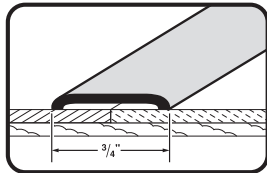

##### SMOOTH

66324	3/4" X 72"	SCREW NAILS	POLISHED	6
-------	------------	-------------	----------	---

M-D# DESCRIPTION COLOR PACK QTY

**ALUMINUM FLOOR & CARPET TRIM**

**Seam Binder – Wide**

**METALDECOR™ FINISH**

Durable aluminum transitions with the look of finished hardwood. Matching fasteners.

40132	1-1/4" X 36"	SCREW NAILS	OAK	6
40134	1-1/4" X 72"	SCREW NAILS	OAK	6
40136	1-1/4" X 36"	SCREW NAILS	CHERRY	6
40138	1-1/4" X 72"	SCREW NAILS	CHERRY	6



**FLUTED**

78014	1-1/4" X 36"	SCREW NAILS	SILVER	6
78097	1-1/4" X 72"	SCREW NAILS	SILVER	6
43732	1-1/4" X 96"	BULK	SILVER	12
79012	1-1/4" X 36"	SCREW NAILS	SATIN BRASS	6
79095	1-1/4" X 72"	SCREW NAILS	SATIN BRASS	6
43734	1-1/4" X 96"	BULK	SATIN BRASS	12
43872	1-1/4" X 36"	SCREW NAILS	PEWTER	6
43874	1-1/4" X 72"	SCREW NAILS	PEWTER	6
43932	1-1/4" X 96"	BULK	PEWTER	12
74450	1-1/4" X 36"	SCREW NAILS	ALMOND	6
74492	1-1/4" X 72"	SCREW NAILS	ALMOND	6

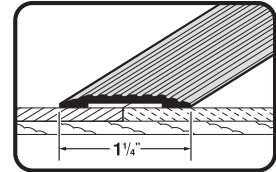

**SMOOTH**

66019	1-1/4" X 36"	SCREW NAILS	POLISHED	6
66225	1-1/4" X 72"	SCREW NAILS	POLISHED	6
72017	1-1/4" X 36"	SCREW NAILS	SATIN BRASS	6
72132	1-1/4" X 72"	SCREW NAILS	SATIN BRASS	6

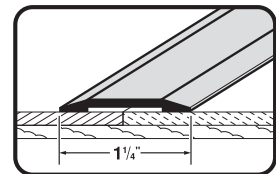

**Seam Binder – Extra Wide**

**SMOOTH**

06684	1-3/4" X 36"	SCREW NAILS	SILVER	6
06700	1-3/4" X 36"	SCREW NAILS	BRITE BRASS	6
55160	1-3/4" X 72"	SCREW NAILS	BRITE BRASS	6

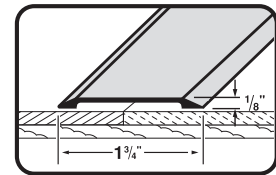

### ALUMINUM FLOOR & CARPET TRIM

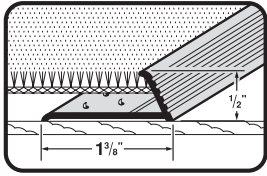

#### Carpet Gripper with Teeth – For Stretch-In Carpet

##### FLUTED

78055	36"	SCREW NAILS	SILVER	6
78139	72"	SCREW NAILS	SILVER	6
43720	96"	BULK	SILVER	12
79053	36"	SCREW NAILS	SATIN BRASS	6
79137	72"	SCREW NAILS	SATIN BRASS	6
43722	96"	BULK	SATIN BRASS	6
43882	36"	SCREW NAILS	PEWTER	12
43886	72"	SCREW NAILS	PEWTER	12
43938	96"	BULK	PEWTER	12
74534	36"	SCREW NAILS	ALMOND	6
74575	72"	SCREW NAILS	ALMOND	6

##### HAMMERED

43726	96"	BULK	SATIN BRASS	6
-------	-----	------	-------------	---

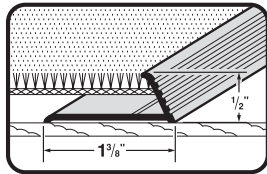

#### Carpet Gripper without Teeth – For Glue-Down Carpet

##### FLUTED

78063	36"		SILVER	6
78147	72"		SILVER	6
79061	36"		SATIN BRASS	6
79145	72"		SATIN BRASS	6
43730	96"		SATIN BRASS	12

M-D# DESCRIPTION COLOR PACK QTY

**ALUMINUM FLOOR & CARPET TRIM**

**Stair Edging**

**METALDECOR™ FINISH**

Aluminum stair edgings with the look of finished hardwood. Matching fasteners.

32009	36"	SCREW NAILS	NEW	OAK	6
32010	72"	SCREW NAILS	NEW	OAK	6
32012	36"	SCREW NAILS	NEW	CHERRY	6
32013	72"	SCREW NAILS	NEW	CHERRY	6



**FLUTED**

78022	1-1/8" X 1-1/8" X 36"	SCREW NAILS		SILVER	6
78105	1-1/8" X 1-1/8" X 72"	SCREW NAILS		SILVER	6
43742	1-1/8" X 1-1/8" X 96"	BULK		SILVER	12
79020	1-1/8" X 1-1/8" X 36"	SCREW NAILS		SATIN BRASS	6
79103	1-1/8" X 1-1/8" X 72"	SCREW NAILS		SATIN BRASS	6
43746	1-1/8" X 1-1/8" X 96"	BULK		SATIN BRASS	12
43878	1-1/8" X 1-1/8" X 36"	SCREW NAILS		PEWTER	6
43880	1-1/8" X 1-1/8" X 72"	SCREW NAILS		PEWTER	6
43936	1-1/8" X 1-1/8" X 96"	BULK		PEWTER	12
74690	1-1/8" X 1-1/8" X 36"	SCREW NAILS		ALMOND	6
74732	1-1/8" X 1-1/8" X 72"	SCREW NAILS		ALMOND	6

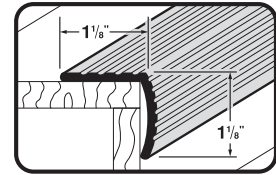

**SMOOTH**

66035	1-1/8" X 1-1/8" X 36"	SCREW NAILS		POLISHED	6
66266	1-1/8" X 1-1/8" X 72"	SCREW NAILS		POLISHED	6
67215	1-1/8" X 1-1/8" X 96"	SCREW NAILS		POLISHED	6

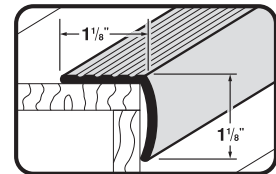

**Stair Edging – Tall**

**FLUTED**

73262	1" X 1-3/4" X 36"	SCREW NAILS		SILVER	6
73270	1" X 1-3/4" X 72"	SCREW NAILS		SILVER	6
73304	1" X 1-3/4" X 72"	SCREW NAILS		SATIN BRASS	6

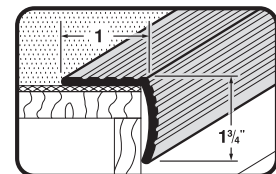

**Vinyl Tile Edging**

**FLUTED**

78030	3/4" X 36"	SCREW NAILS		SILVER	6
78113	3/4" X 72"	SCREW NAILS		SILVER	6
79038	3/4" X 36"	SCREW NAILS		SATIN BRASS	6
79111	3/4" X 72"	SCREW NAILS		SATIN BRASS	6

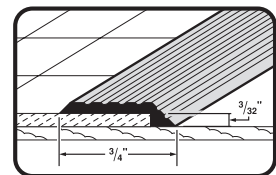

**ALUMINUM CARPET TRIM ASSORTMENTS**

See Assortment Catalog for Assortment Contents and Costs

- 09417476 2 FT FLOOR TRENDS ALUMINUM & WOOD TRIM ASSORTMENT
- 09417477 2 FT ALUMINUM FLOOR TRIM ASSORTMENT
- 09417479 4 FT ALUMINUM & HARDWOOD FLOOR TRIM ASSORTMENT
- 09417570 4 FT ALUMINUM FLOOR TRIM ASSORTMENT

### HARDWOOD FLOOR TRIM

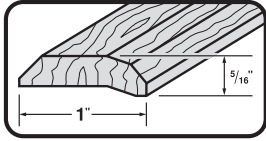

#### Carpet Trim

85290	1" X 36"	SCREWS	UNFINISHED	6
85308	1" X 72"	SCREWS	UNFINISHED	6

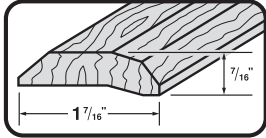

#### Carpet Trim - Wide

85357	1-7/16" X 36"	SCREWS	UNFINISHED	6
85365	1-7/16" X 72"	SCREWS	UNFINISHED	6
85373	1-7/16" X 36"	SCREWS	LIGHT STAIN	6
85381	1-7/16" X 72"	SCREWS	LIGHT STAIN	6

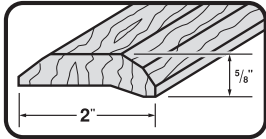

#### Carpet Trim - Extra Wide

85415	2" X 36"	SCREWS	UNFINISHED	6
85423	2" X 72"	SCREWS	UNFINISHED	6
85431	2" X 36"	SCREWS	LIGHT STAIN	6
85449	2" X 72"	SCREWS	LIGHT STAIN	6

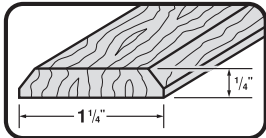

#### 1-1/4" Seam Binder

85233	1-1/4" X 36"	SCREWS	UNFINISHED	6
85241	1-1/4" X 72"	SCREWS	UNFINISHED	6
85258	1-1/4" X 36"	SCREWS	LIGHT STAIN	6
85266	1-1/4" X 72"	SCREWS	LIGHT STAIN	6

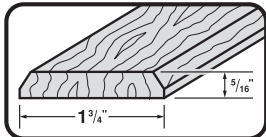

#### 1-3/4" Seam Binder

85621	1-3/4" X 36"	SCREWS	UNFINISHED	6
85043	1-3/4" X 72"	SCREWS	UNFINISHED	6
85001	1-3/4" X 36"	SCREWS	LIGHT STAIN	6
85019	1-3/4" X 72"	SCREWS	LIGHT STAIN	6

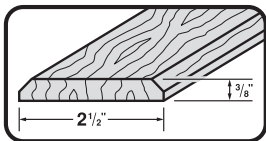

#### 2-1/2" Seam Binder

85639	2-1/2" X 36"	SCREWS	UNFINISHED	6
85092	2-1/2" X 72"	SCREWS	UNFINISHED	6
85050	2-1/2" X 36"	SCREWS	LIGHT STAIN	6
85068	2-1/2" X 72"	SCREWS	LIGHT STAIN	6

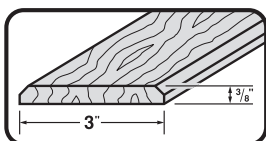

#### 3" Seam Binder

85613	3" X 36"	SCREWS	UNFINISHED	6
85100	3" X 72"	SCREWS	UNFINISHED	6



M-D# DESCRIPTION COLOR PACK QTY

**HARDWOOD FLOOR TRIM**

**5" Seam Binder**

85597	5" X 36"	SCREWS	UNFINISHED	3
85605	5" X 72"	SCREWS	UNFINISHED	3

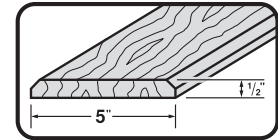

**Reducer**

85472	1" X 36"	SCREWS	UNFINISHED	6
85480	1" X 72"	SCREWS	UNFINISHED	6

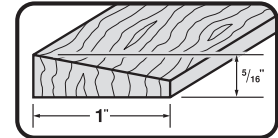

**Reducer – Wide**

85530	1-3/4" X 36"	SCREWS	UNFINISHED	6
85548	1-3/4" X 72"	SCREWS	UNFINISHED	6

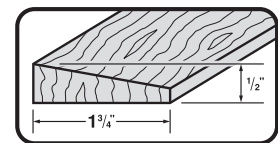

**Hardwood Transitions with Snap Track**

**HARDWOOD TRANSITION – TILE TO LAMINATE**

48901	36"	ANCHORS/SCREWS		3
48905	72"	ANCHORS/SCREWS		3

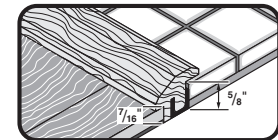

**HARDWOOD TRANSITION – TILE TO VINYL**

48909	36"	ANCHORS/SCREWS		3
48913	72"	ANCHORS/SCREWS		3

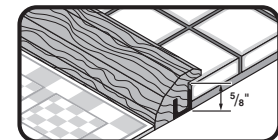

**HARDWOOD TRANSITION – TILE TO CARPET**

48927	36"	ANCHORS/SCREWS		3
48931	72"	ANCHORS/SCREWS		3

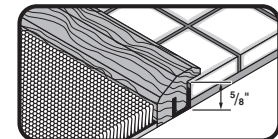

**Hardwood Floor Assortments**

See Assortment Catalog for Assortment Contents and Costs

09417478 2 FT HARDWOOD FLOOR TRIM ASSORTMENT

### CERAMIC TILE EDGING

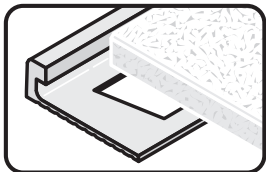

#### "L-Shape" Tile Edging

<b>1/4"</b>			
10922	96"	MILL FINISH	6
10751	96"	SATIN CLEAR ANODIZED	6
10769	96"	SATIN BRASS ANODIZED	6
10835	96"	BRIGHT DIPPED BRASS	6
<b>5/16"</b>			
10924	96"	MILL FINISH	6
10777	96"	SATIN CLEAR ANODIZED	6
10785	96"	SATIN BRASS ANODIZED	6
10843	96"	BRIGHT DIPPED BRASS	6
<b>3/8"</b>			
10926	96"	MILL FINISH	6
10793	96"	SATIN CLEAR ANODIZED	6
10801	96"	SATIN BRASS ANODIZED	6
10850	96"	BRIGHT DIPPED BRASS	6
19750	96"	SANDSTONE	6
<b>1/2"</b>			
10928	96"	MILL FINISH	6
10819	96"	SATIN CLEAR ANODIZED	6
10827	96"	SATIN BRASS ANODIZED	6
10868	96"	BRIGHT DIPPED BRASS	6

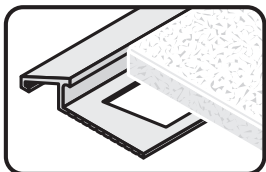

#### Tile Edge Reducers

<b>5/16"</b>			
07385	96"	SATIN CLEAR ANODIZED	6
07393	96"	SATIN BRASS ANODIZED	6
07401	96"	BRIGHT DIPPED BRASS	6
<b>3/8"</b>			
07419	96"	SATIN CLEAR ANODIZED	6
07427	96"	SATIN BRASS ANODIZED	6
07435	96"	BRIGHT DIPPED BRASS	6
19725	96"	SANDSTONE	6
<b>1/2"</b>			
07443	96"	SATIN CLEAR ANODIZED	6
07112	96"	SATIN BRASS ANODIZED	6
07468	96"	BRIGHT DIPPED BRASS	6

M-D# DESCRIPTION COLOR PACK QTY

CERAMIC TILE EDGING

Tile Caps

<b>1/4"</b>			
31894	96"	SATIN CLEAR ANODIZED	6
31896	96"	SATIN BRASS ANODIZED	6
<b>5/16"</b>			
07476	96"	SATIN CLEAR ANODIZED	6
07484	96"	SATIN BRASS ANODIZED	6
07492	96"	BRIGHT DIPPED BRASS	6
<b>3/8"</b>			
07500	96"	SATIN CLEAR ANODIZED	6
07518	96"	SATIN BRASS ANODIZED	6
07526	96"	BRIGHT DIPPED BRASS	6
19733	96"	SANDSTONE	6

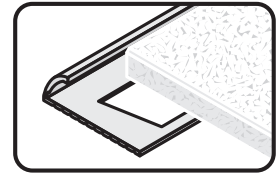

Tile to Carpet

<b>5/16"</b>			
07534	96"	SATIN CLEAR ANODIZED	6
07542	96"	SATIN BRASS ANODIZED	6
07559	96"	BRIGHT DIPPED BRASS	6
<b>3/8"</b>			
07567	96"	SATIN CLEAR ANODIZED	6
07575	96"	SATIN BRASS ANODIZED	6
07583	96"	BRIGHT DIPPED BRASS	6
19741	96"	SANDSTONE	6

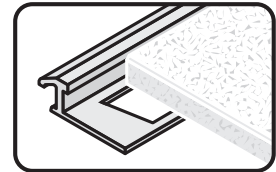

Stair Edging for Tile

<b>3/8"</b>			
48170	96"	SATIN CLEAR ANODIZED	6
48178	96"	SATIN BRASS ANODIZED	6

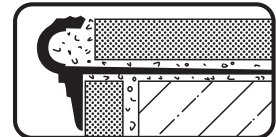

### CERAMIC TILE EDGING

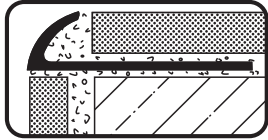

**PVC Tile Caps**  
For installation at outside wall corners

1/4"			
73804	96"	BLACK	6
73806	96"	WHITE	6
73810	96"	BEIGE	6
73812	96"	GRAY	6
73814	96"	IVORY	6
3/8"			
73826	96"	BLACK	6
73792	96"	WHITE	6
73820	96"	BEIGE	6
73822	96"	GRAY	6
73794	96"	IVORY	6

### Ceramic Tile Edging Assortment

See Assortment Catalog for Assortment Contents and Costs  
09416595 3 FT. CERAMIC TILE EDGING ASSORTMENT

### FLOOR & CARPET ACCESSORIES

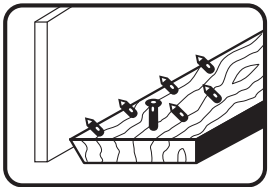

**Carpet Tack Strip**  
3 PACKS  
Three 4 ft. pieces of tackstrip per polybag. 30 sets per carton.

75093	48"	WOOD/CONCRETE NAIL		30
75302	48"	WOOD/CONCRETE NAIL (CALIF REG)		30
100 PER CARTON				
75312	48"	1" WITH WOOD NAIL	NEW	100
75314	48"	1" WITH CONCRETE NAIL	NEW	100
75320	48"	1" WITH WOOD NAIL (CALIF REG)	NEW	100
75322	48"	1" WITH CONCRETE NAIL (CALIF REG)	NEW	100

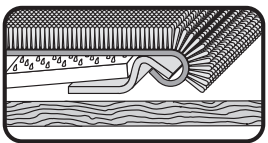

**Z Bar**  
Creates a finished edge where stretch-in carpeting meets floor tile. Install with tack strip.

25 PER CARTON				
65110	48"	MILL		25

M-D#	DESCRIPTION	COLOR	PACK QTY
------	-------------	-------	----------

**FLOOR & CARPET ACCESSORIES**

**Screw Nails**

**FOR CARPET METAL – 12 PER PACKAGE**

21501	1-1/4"	SILVER	20
21485	1-1/4"	BRASS	20
21478	1-1/4"	PEWTER	20

**FOR CARPET METAL – 1 LB. PACKAGE**

95638	1-1/4"	SILVER	10
95653	1-1/4"	BRASS	10
91194	1-1/4"	PEWTER	10

**Concrete Nails**

**FOR CARPET METAL – 1 LB. PACKAGE**

19777	5/8"	MILL	10
-------	------	------	----

**Wooden Pegs**

For use in installing floor trims over concrete floors.

**FOR FLOOR TRIMS – 12 PER PACKAGE**

95661	1-1/4" X 3/8" DIAMETER		20
-------	------------------------	--	----

**Hot Melt Carpet Seaming Tapes**

31142	22 YARDS	M-D 20 STANDARD HOT MELT TAPE	NEW	10
-------	----------	-------------------------------	-----	----



31143	22 YARDS	M-D 40 PREMIUM HOT MELT TAPE	NEW	10
-------	----------	------------------------------	-----	----



31144	22 YARDS	M-D 50 ULTRA HOT MELT TAPE	NEW	10
-------	----------	----------------------------	-----	----



### VINYL WALL BASE

#### Dry Back

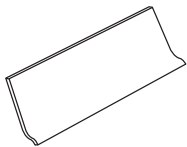

#### 4 FT STRIPS

75598	2-1/2" X 4'	BLACK	18
75614	2-1/2" X 4'	BROWN	18
75630	2-1/2" X 4'	ALMOND	18
75655	2-1/2" X 4'	DESERT BEIGE	18
75697	2-1/2" X 4'	WHITE	18
75671	2-1/2" X 4'	SILVER GRAY	18
75218	4" X 4'	BLACK	18
75234	4" X 4'	BROWN	18
75275	4" X 4'	ALMOND	18
75259	4" X 4'	DESERT BEIGE	18
75317	4" X 4'	WHITE	18
75291	4" X 4'	SILVER GRAY	18

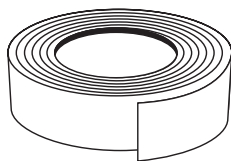

#### 60 FT BULK ROLLS

73896	4" X 60'	BLACK	1
73900	4" X 60'	BROWN	1
73899	4" X 60'	ALMOND	1
73897	4" X 60'	WHITE	1
73898	4" X 60'	SILVER GRAY	1

#### 120 FT BULK ROLLS

75887	2-1/2" X 120'	BLACK	1
75903	2-1/2" X 120'	BROWN	1
75960	2-1/2" X 120'	ALMOND	1
75929	2-1/2" X 120'	WHITE	1
75945	2-1/2" X 120'	SILVER GRAY	1
75457	4" X 120'	BLACK	1
75465	4" X 120'	BROWN	1
75481	4" X 120'	ALMOND	1
75473	4" X 120'	DESERT BEIGE	1
75507	4" X 120'	WHITE	1
75499	4" X 120'	SILVER GRAY	1

#### Adhesive Back

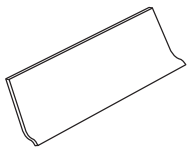

#### 4 FT STRIPS

23662	4" X 4'	BLACK	18
23688	4" X 4'	BROWN	18
23621	4" X 4'	ALMOND	18
23647	4" X 4'	DESERT BEIGE	18
23944	4" X 4'	WHITE	18
23886	4" X 4'	SILVER GRAY	18

M-D# DESCRIPTION COLOR PACK QTY

VINYL WALL BASE

Adhesive Back (continued)

20 FT ROLLS

65770	2-1/2" X 20'	WHITE	4
93146	4" X 20'	BLACK	4
93161	4" X 20'	BROWN	4
93229	4" X 20'	ALMOND	4
93187	4" X 20'	DESERT BEIGE	4
93203	4" X 20'	WHITE	4
93245	4" X 20'	SILVER GRAY	4

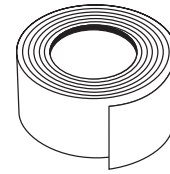

Vinyl Self-Stick Tub Cove Moulding

Protect bathtub, shower stall and flooring from scratches and water damage. Applied where flooring meets base of tub.

65788	60"	WHITE	24
-------	-----	-------	----

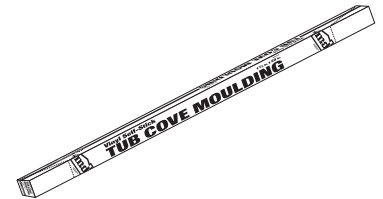

Wall Base Assortments

See Assortment Catalog for Assortment Contents and Costs

- 09415092 4 FT CORE VINYL WALL BASE ASSORTMENT
- 09417420 4 FT HORIZONTAL WALL BASE DRYBACK ASSORTMENT

VINYL FLOORING ACCESSORIES

Vinyl Stair Treads – Residential

75556	9-1/8" X 24"	BLACK	24
75572	9-1/8" X 24"	BROWN	24

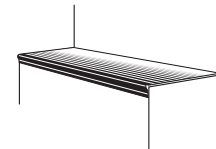

Vinyl Stair Edging

29702	36"	BLACK	12
29710	36"	BROWN	12

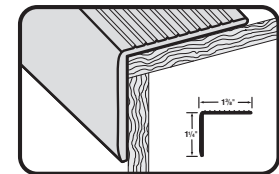

Vinyl Divider T with Metal Track

31215	96"	BLACK	6
31220	96"	BROWN	6



### STICK 'n STEP



#### Stick 'n Step®

##### ANTI-SKID ADHESIVE TREADS

Heavy-duty, peel and stick adhesive treads. Perform in all weather conditions. Apply to surfaces to improve traction and help prevent slips and falls. Adhere to wood, concrete, metal and more.

46618	2-3/4" X 14"	BLACK	12
46620	2-3/4" X 14"	NATURAL	12
46586	2-3/4" X 14"	GRAY	12
46594	2-3/4" X 14"	YELLOW	12
46596	4" X 16"	BLACK	12
46600	4" X 16"	NATURAL	12
46602	4" X 16"	GRAY	12
46612	4" X 16"	YELLOW	12

#### Stick 'n Step® Assortments

See Assortment Catalog for Assortment Contents and Costs

09417346	2 FT. 4" X 16" STICK 'n STEP ASSORTMENT
09417362	2 FT. COMBO STICK 'n STEP ASSORTMENT
09417354	4 FT. COMBO STICK 'n STEP ASSORTMENT



# DECORATIVE MOULDINGS



### DECORATIVE ALUMINUM MOULDINGS

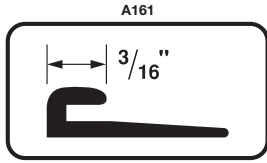

A161

#### Cap

**A161 – FOR 1/16" MATERIAL THICKNESS**

70011	96"	NAILS	ANODIZED	6
-------	-----	-------	----------	---

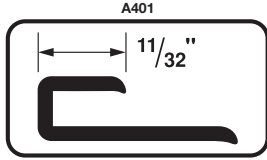

A401

**A401 – FOR 1/8" MATERIAL THICKNESS**

70094	96"	NAILS	ANODIZED	6
-------	-----	-------	----------	---

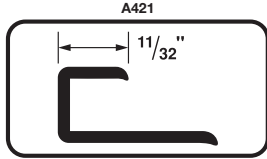

A421

**A421 – FOR 1/4" MATERIAL THICKNESS**

70144	96"	NAILS	ANODIZED	6
73098	96"	NAILS	ALBRAS	6

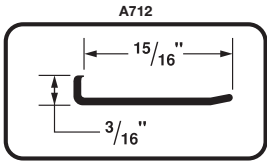

A712

#### Edging

**A712 – FOR 7/8" MATERIAL**

70201	96"	SCREWS	ANODIZED	6
73122	96"	SCREWS	ALBRAS	6

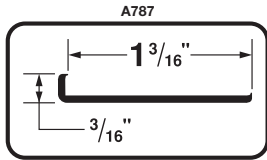

A787

**A787 – FOR 1-1/8" MATERIAL**

66407	72"	SCREWS	POLISHED	6
67363	96"	SCREWS	POLISHED	6
70391	96"	SCREWS	ANODIZED	6

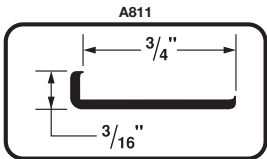

A811

**A811 – FOR 3/4" MATERIAL**

67371	96"	SCREWS	POLISHED	6
70409	96"	SCREWS	ANODIZED	6

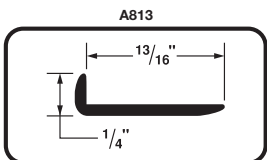

A813

**A813 – FOR 13/16" MATERIAL**

69450	72"	SCREWS	ANODIZED	6
70425	96"	SCREWS	ANODIZED	6

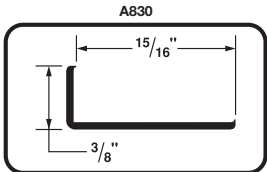

A830

**A830 – FOR 15/16" MATERIAL**

70441	96"	SCREWS	ANODIZED	6
-------	-----	--------	----------	---

M-D# DESCRIPTION COLOR PACK QTY

DECORATIVE ALUMINUM MOULDINGS

Corner – Inside

A773  
70367 96" SCREWS ANODIZED 6

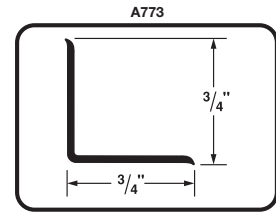

Corner – Outside

A772  
67322 96" SCREWS POLISHED 6  
70359 96" SCREWS ANODIZED 6

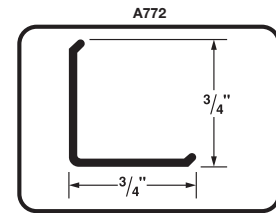

Cove

A164 – FOR 1/16" MATERIAL THICKNESS  
70045 96" NAILS ANODIZED 6

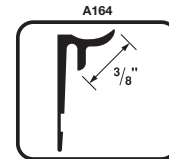

A747  
70243 96" NAILS ANODIZED 6

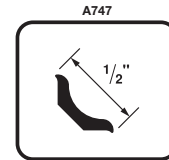

A751  
70276 96" SCREWS ANODIZED 6

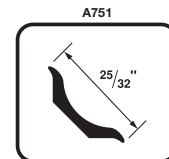

A767 – FOR 1/8" MATERIAL THICKNESS  
70318 96" NAILS ANODIZED 6

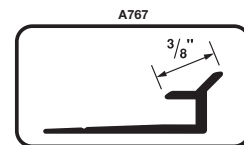

## DECORATIVE MOULDINGS

M-D#      DESCRIPTION      COLOR      PACK QTY

### DECORATIVE ALUMINUM MOULDINGS

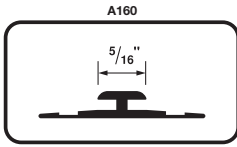

**Divider**

A160 – FOR 1/16" MATERIAL THICKNESS

69138      72"      NAILS

ANODIZED

6

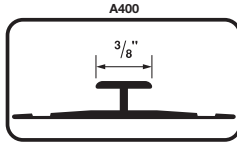

A400 – FOR 1/8" MATERIAL THICKNESS

70086      96"      NAILS

ANODIZED

6

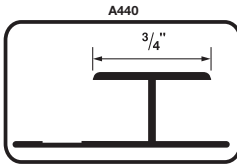

A440 - FOR 3/8" MATERIAL THICKNESS

67165      96"      BULK

MILL

40

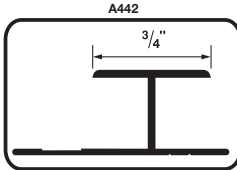

A442 - FOR 7/16" MATERIAL THICKNESS

67167      96"      BULK

MILL

25

# ALUMINUM SHAPES & METAL SHEETS



### ALUMINUM SHAPES

#### Aluminum Shapes for Craft & Hobby Projects

To make braces, table legs, drawer slides, shelf brackets, reinforcements, and more. Available in mill and anodized finishes. 6063 Alloy, T-5 Hardness.



#### Flat Bar – Mill

	A x T			
<b>48" LENGTH</b>				
60699	3/4"	X 1/16"		5
60723	1"	X 1/16"		5
60707	1-1/2"	X 1/16"		5
60772	1/2"	X 1/8"		5
60731	3/4"	X 1/8"		5
60749	1"	X 1/8"		5
60756	1-1/2"	X 1/8"		5
60715	2"	X 1/8"		5
60764	1"	X 1/4"		5
<b>72" LENGTH</b>				
58008	1/2"	X 1/16"		5
58016	3/4"	X 1/16"		5
58024	1"	X 1/16"		5
58032	1-1/2"	X 1/16"		5
58040	1/2"	X 1/8"		5
58057	3/4"	X 1/8"		5
58065	1"	X 1/8"		5
58073	1-1/4"	X 1/8"		5
58081	1-1/2"	X 1/8"		5
58099	2"	X 1/8"		5
58156	3/4"	X 1/4"		5
58164	1"	X 1/4"		5
58172	1-1/2"	X 1/4"		5
58180	2"	X 1/4"		5
<b>96" LENGTH</b>				
59014	3/4"	X 1/16"		5
59022	1"	X 1/16"		5
59030	1-1/2"	X 1/16"		5
59048	1/2"	X 1/8"		5
59055	3/4"	X 1/8"		5
59063	1"	X 1/8"		5
59071	1-1/4"	X 1/8"		5
59089	1-1/2"	X 1/8"		5
59097	2"	X 1/8"		5
59162	1"	X 1/4"		5
59188	2"	X 1/4"		5

M-D# DESCRIPTION COLOR PACK QTY

ALUMINUM SHAPES

Flat Bar – Anodized

A x T					
<b>72" LENGTH</b>					
61002	3/4"	X	1/16"		5
61010	1"	X	1/16"		5
61036	1/2"	X	1/8"		5
61044	3/4"	X	1/8"		5
61051	1"	X	1/8"		5
61077	1-1/2"	X	1/8"		5
61085	2"	X	1/8"		5
61101	1"	X	1/4"		5
<b>96" LENGTH</b>					
62018	1"	X	1/16"		5
62026	1-1/2"	X	1/16"		5
62034	1/2"	X	1/8"		5
62042	3/4"	X	1/8"		5
62059	1"	X	1/8"		5
62075	1-1/2"	X	1/8"		5
62083	2"	X	1/8"		5



Angle Equal Leg – Mill

A x A x T					
<b>48" LENGTH</b>					
61644	1/2"	X	1/2"	X	1/16"
60848	3/4"	X	3/4"	X	1/16"
60855	1"	X	1"	X	1/16"
60863	1-1/2"	X	1-1/2"	X	1/16"
61634	2"	X	2"	X	1/16"
61649	1/2"	X	1/2"	X	1/8"
60871	3/4"	X	3/4"	X	1/8"
60889	1"	X	1"	X	1/8"
60822	1-1/4"	X	1-1/4"	X	1/8"
60897	1-1/2"	X	1-1/2"	X	1/8"
60830	2"	X	2"	X	1/8"
<b>72" LENGTH</b>					
58214	1/2"	X	1/2"	X	1/16"
58230	3/4"	X	3/4"	X	1/16"
58255	1"	X	1"	X	1/16"
58289	1-1/2"	X	1-1/2"	X	1/16"
58305	2"	X	2"	X	1/16"
58222	1/2"	X	1/2"	X	1/8"
58248	3/4"	X	3/4"	X	1/8"
58263	1"	X	1"	X	1/8"
58271	1-1/4"	X	1-1/4"	X	1/8"
58297	1-1/2"	X	1-1/2"	X	1/8"
58313	2"	X	2"	X	1/8"

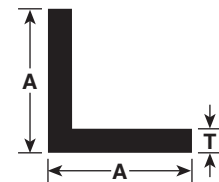

M-D#

DESCRIPTION

COLOR

PACK QTY

### ALUMINUM SHAPES

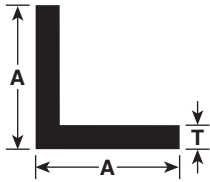

#### Angle Equal Leg – Mill

		A x A x T			
		96" LENGTH			
59196	1/2" X	1/2" X	1/16"		5
59212	3/4" X	3/4" X	1/16"		5
59238	1" X	1" X	1/16"		5
59261	1-1/2" X	1-1/2" X	1/16"		5
59287	2" X	2" X	1/16"		5
59204	1/2" X	1/2" X	1/8"		5
59220	3/4" X	3/4" X	1/8"		5
59246	1" X	1" X	1/8"		5
59253	1-1/4" X	1-1/4" X	1/8"		5
59279	1-1/2" X	1-1/2" X	1/8"		5
59295	2" X	2" X	1/8"		5

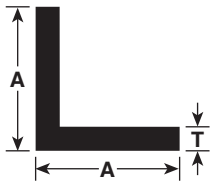

#### Angle Equal Leg – Anodized

		A x A x T			
		72" LENGTH			
61119	1/2" X	1/2" X	1/16"		5
61135	3/4" X	3/4" X	1/16"		5
61150	1" X	1" X	1/16"		5
61184	1-1/2" X	1-1/2" X	1/16"		5
61200	2" X	2" X	1/16"		5
61143	3/4" X	3/4" X	1/8"		5
61168	1" X	1" X	1/8"		5
61192	1-1/2" X	1-1/2" X	1/8"		5
61218	2" X	2" X	1/8"		5
		96" LENGTH			
62109	1/2" X	1/2" X	1/16"		5
62125	3/4" X	3/4" X	1/16"		5
62141	1" X	1" X	1/16"		5
62174	1-1/2" X	1-1/2" X	1/16"		5
62190	2" X	2" X	1/16"		5
62133	3/4" X	3/4" X	1/8"		5
62158	1" X	1" X	1/8"		5
62182	1-1/2" X	1-1/2" X	1/8"		5
62208	2" X	2" X	1/8"		5



M-D# DESCRIPTION COLOR PACK QTY

ALUMINUM SHAPES

Round Rod – Mill

A			
<b>48" LENGTH</b>			
60632	3/8"		5
60640	1/2"		5
<b>72" LENGTH</b>			
58354	3/8"		5
58362	1/2"		5
<b>96" LENGTH</b>			
59337	3/8"		5



Round Rod – Anodized

A			
<b>72" LENGTH</b>			
61275	1/4"		5
61291	3/8"		5



Round Tubing – Mill

.055" Tubing can be telescoped

A x T			
<b>48" LENGTH</b>			
61665	3/4"	.055" WALL THICKNESS	5
61674	1"	.055" WALL THICKNESS	5
<b>72" LENGTH</b>			
58420	5/8"	.093" WALL THICKNESS	5
58438	3/4"	.055" WALL THICKNESS	5
58453	7/8"	.055" WALL THICKNESS	5
58461	1"	.055" WALL THICKNESS	5
58479	1-1/4"	.055" WALL THICKNESS	5
<b>96" LENGTH</b>			
59428	3/4"	.055" WALL THICKNESS	5
59451	1"	.055" WALL THICKNESS	5
59469	1-1/4"	.055" WALL THICKNESS	5

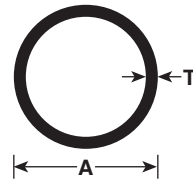

### ALUMINUM SHAPES

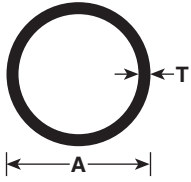

#### Round Tubing – Anodized

.055" Tubing can be telescoped

A x T			
<b>72" LENGTH</b>			
61341	3/4"	.055" WALL THICKNESS	5
61374	1"	.055" WALL THICKNESS	5
<b>96" LENGTH</b>			
62323	3/4"	.055" WALL THICKNESS	5
62356	1"	.055" WALL THICKNESS	5

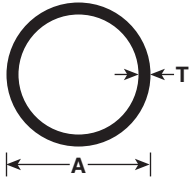

#### Round Tubing – Brite Dipped Aluminum

A x T			
<b>72" LENGTH</b>			
61440	1"	.047" WALL THICKNESS	5
61465	1-1/4"	.057" WALL THICKNESS	5

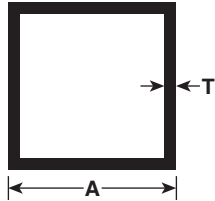

#### Square Tubing – Mill

A x T			
<b>72" LENGTH</b>			
58487	1"	1/16" WALL THICKNESS	5
58495	1-1/4"	1/16" WALL THICKNESS	5
<b>96" LENGTH</b>			
59477	1"	1/16" WALL THICKNESS	5
59485	1-1/4"	1/16" WALL THICKNESS	5

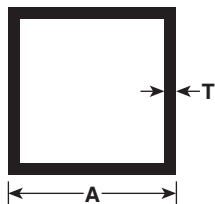

#### Square Tubing – Anodized

A x T			
<b>72" LENGTH</b>			
61317	1"	1/16" WALL THICKNESS	5
<b>96" LENGTH</b>			
62299	1"	1/16" WALL THICKNESS	5

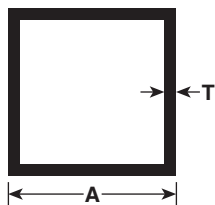

#### Square Tubing – Brite Dipped Aluminum

A x T			
<b>72" LENGTH</b>			
61481	1"	.047" WALL THICKNESS	5

M-D# DESCRIPTION COLOR PACK QTY

ALUMINUM SHAPES

Channel – Mill

A x B x T							
<b>48" LENGTH</b>							
59857	25/64"	X	1/2"	X	1/16"	FOR 1/4" PLYWOOD	5
59840	41/64"	X	1/2"	X	1/16"	FOR 1/2" PLYWOOD	5
59865	57/64"	X	9/16"	X	1/16"	FOR 3/4" PLYWOOD	5
<b>72" LENGTH</b>							
58503	25/64"	X	1/2"	X	1/16"	FOR 1/4" PLYWOOD	5
58511	33/64"	X	1/2"	X	1/16"	FOR 3/8" PLYWOOD	5
58529	41/64"	X	1/2"	X	1/16"	FOR 1/2" PLYWOOD	5
58537	57/64"	X	9/16"	X	1/16"	FOR 3/4" PLYWOOD	5
58552	1"	X	1"	X	1/8"		5
<b>96" LENGTH</b>							
59501	25/64"	X	1/2"	X	1/16"	FOR 1/4" PLYWOOD	5
59519	33/64"	X	1/2"	X	1/16"	FOR 3/8" PLYWOOD	5
59527	41/64"	X	1/2"	X	1/16"	FOR 1/2" PLYWOOD	5
59535	57/64"	X	9/16"	X	1/16"	FOR 3/4" PLYWOOD	5
59576	1"	X	1"	X	1/8"		5

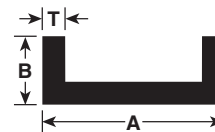

Channel – Anodized

A x B x T							
<b>72" LENGTH</b>							
61226	25/64"	X	1/2"	X	1/16"	FOR 1/4" PLYWOOD	5
61234	33/64"	X	1/2"	X	1/16"	FOR 3/8" PLYWOOD	5
61242	41/64"	X	1/2"	X	1/16"	FOR 1/2" PLYWOOD	5
61259	57/64"	X	9/16"	X	1/16"	FOR 3/4" PLYWOOD	5
<b>96" LENGTH</b>							
62216	25/64"	X	1/2"	X	1/16"	FOR 1/4" PLYWOOD	5
62224	33/64"	X	1/2"	X	1/16"	FOR 3/8" PLYWOOD	5
62232	41/64"	X	1/2"	X	1/16"	FOR 1/2" PLYWOOD	5
62240	57/64"	X	9/16"	X	1/16"	FOR 3/4" PLYWOOD	5

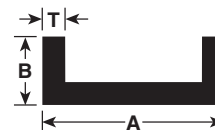

Tee – Mill

A x B x T							
<b>96" LENGTH</b>							
59634	3/4"	X	1"	X	1/16"		5

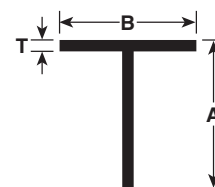

M-D#

DESCRIPTION

COLOR

PACK QTY

### METAL SHEETS

#### Metal Sheets Project Center

Choose From a Wide Selection of Styles, Sizes and Finishes for a Variety of Projects

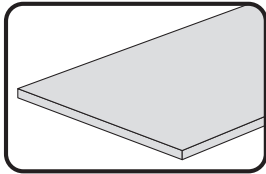

#### Solid Aluminum Sheets

Lightweight, will not rust. Easy to cut, form and fabricate.

#### ALUMINUM - .019" THICKNESS

56080	6" X 18"	PLAIN	MILL	6
56040	1' X 1'	PLAIN	MILL	6
56088	1' X 1'	PLAIN	BLACK	6
56064	1' X 2'	PLAIN	MILL	6
56086	1' X 2'	PLAIN	BLACK	3
57794	2' X 3'	PLAIN	MILL	6
57000	3' X 3'	PLAIN	MILL	3
56090	1' X 1'	LEATHERGRAIN	MILL	6
56030	1' X 2'	LEATHERGRAIN	MILL	3
57810	2' X 3'	LEATHERGRAIN	MILL	6
57026	3' X 3'	LEATHERGRAIN	MILL	3

#### Perforated Aluminum Sheets

Choose from a selection of six distinct designs

#### .020" THICKNESS

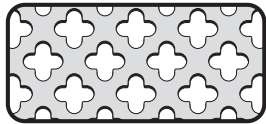

57042	2' X 3'	CLOVERLEAF	MILL	3
57166	3' X 3'	CLOVERLEAF	MILL	3
56016	1' X 2'	CLOVERLEAF	ALBRAS	3
57109	2' X 3'	CLOVERLEAF	ALBRAS	3
57240	3' X 3'	CLOVERLEAF	ALBRAS	3
56018	1' X 2'	CLOVERLEAF	BLACK	3

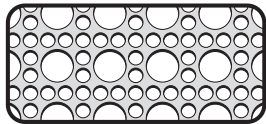

57067	2' X 3'	LINCANE	MILL	3
57182	3' X 3'	LINCANE	MILL	3
56012	1' X 2'	LINCANE	ALBRAS	3
57125	2' X 3'	LINCANE	ALBRAS	3
57265	3' X 3'	LINCANE	ALBRAS	3
56014	1' X 2'	LINCANE	BLACK	3
56062	2' X 3'	LINCANE	BLACK	3
57015	3' X 3'	LINCANE	NEW VENETIAN BRONZE	3

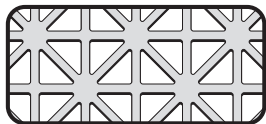

56008	1' X 2'	UNIONJACK	MILL	3
57083	2' X 3'	UNIONJACK	MILL	3
57208	3' X 3'	UNIONJACK	MILL	3
56004	1' X 2'	UNIONJACK	ALBRAS	3
57141	2' X 3'	UNIONJACK	ALBRAS	3
57281	3' X 3'	UNIONJACK	ALBRAS	3
56006	1' X 2'	UNIONJACK	BLACK	3
56000	2' X 3'	UNIONJACK	BLACK	3

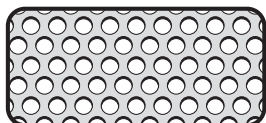

84160	3' X 3'	SMALL HOLE	MILL	3
84186	3' X 3'	SMALL HOLE	WHITE	3
84327	3' X 3'	SMALL HOLE	BLACK	3

ALUMINUM SHAPES & METAL SHEETS

M-D# DESCRIPTION COLOR PACK QTY

METAL SHEETS

**Perforated Aluminum Sheets (continued)**

57005 1' X 2' MOSAIC NEW SATIN NICKEL 3

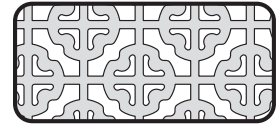

57010 1' X 2' ELLIPTICAL NEW SATIN NICKEL 3

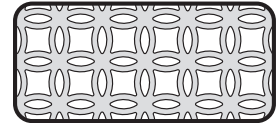

**EM-2 Expanded Aluminum**

HOLE SIZE - .255" X .100"

57349 3' X 4' SATIN 1

57364 2' X 4' ALBRAS 1

57372 3' X 4' ALBRAS 1

57398 2' X 4' BLACK 1

57406 3' X 4' BLACK 1

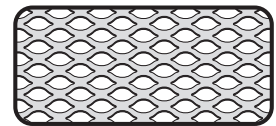

**Polished Aluminum Treadplate (.073" Thickness)**

Popular aluminum diamond tread pattern used in hundreds of decorative applications

56022 11-7/8" X 23-7/8" POLISHED 3



**Faux Metal – Thermal Plastic Sheets**

Easy to cut, form and fabricate. "Faux" diamond tread pattern. For interior use only.

56026 11-7/8" X 23-7/8" POLISHED 3



**Steel Sheets**

**GALVANIZED STEEL – 28 GAUGE**

Sheets are rust resistant for indoor or outdoor use. Great for roof repairs.

56072 6" X 18" STEEL GALVANIZED 6

56032 1' X 1' STEEL GALVANIZED 6

56020 1' X 2' STEEL GALVANIZED 3

57836 2' X 3' STEEL GALVANIZED 3

57851 3' X 3' STEEL GALVANIZED 3

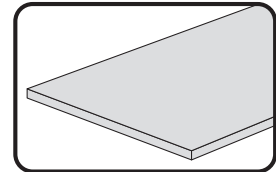

### METAL SHEETS

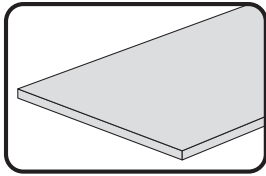
**Steel Sheets**

Weldable, uncoated cold-rolled steel. Paint to prevent rust.

**22 GAUGE**

M-D#	DESCRIPTION	COLOR	PACK QTY
56074	6" X 18"	STEEL	6
56034	1' X 1'	STEEL	6
56066	1' X 2'	STEEL	3

**16 GAUGE**

M-D#	DESCRIPTION	COLOR	PACK QTY
56078	6" X 18"	STEEL	6
56038	1' X 1'	STEEL	6
56070	1' X 2'	STEEL	3

**Aluminum Shapes Assortments**

See Assortment Catalog for Assortment Contents and Costs

09944414	2 FT SHAPES ASSORTMENT – 6 FT & 8 FT LENGTHS
09427113	2 FT SHAPES ASSORTMENT – 4 FT LENGTHS
09416728	2 FT SHAPES ASSORTMENT - FREE STANDING – 4 FT LENGTHS
09416736	2 FT SHAPES ASSORTMENT - FREE STANDING – 4 FT & 6 FT LENGTHS

**Metal Sheets Assortments**

See Assortment Catalog for Assortment Contents and Costs

09944406	3 FT ALUMINUM SHEETS ASSORTMENT
09416544	4 FT SHEETS PROJECT CENTER ASSORTMENT
09416536	4 FT SMALL SHEETS ASSORTMENT

# ASSORTMENTS

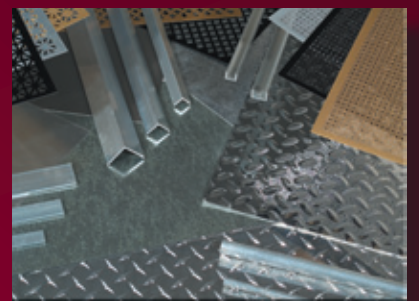
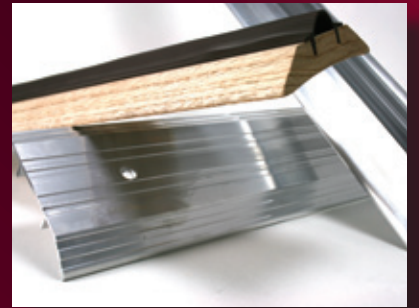

### WEATHERSTRIP ASSORTMENTS

#### Weatherstrip Assortments

See Price Catalog for Assortment Contents and Costs

09427600 4 FT PACKAGED WEATHERSTRIP ASSORTMENT

09427618 8 FT PACKAGED WEATHERSTRIP ASSORTMENT

#### Threshold, Door Bottoms Sweeps and Door Jamb Assortments

See Price Catalog for Assortment Contents and Costs

09417470 4 FT THRESHOLDS / SWEEPS / DOOR JAMB ASSORTMENT

09417471 8 FT THRESHOLDS / SWEEPS / DOOR JAMB ASSORTMENT

09416553 VINYL CLAD WEATHERSTRIP ASSORTMENT



09417470 4 FT THRESHOLDS / SWEEPS / DOOR JAMB ASSORTMENT



09427618 8 FT PACKAGED WEATHERSTRIP ASSORTMENT



0941655 VINYL CLAD WEATHERSTRIP ASSORTMENT



**WEATHERSTRIP ASSORTMENTS**

**Ultra Residential Door Weatherstrip Assortments**

See Price Catalog for Assortment Contents and Costs

- 09417472 2 FT ULTRA RESIDENTIAL THRESHOLD & DOOR BOTTOM ASSORTMENT
- 09417473 2 FT ULTRA JAMB-UP / INSERTS / DOOR BOTTOMS ASSORTMENT
- 09417474 4 FT ULTRA THRESHOLDS / SWEEPS / DOOR BOTTOMS ASSORTMENT
- 09417475 8 FT ULTRA THRESHOLD / DOOR BOTTOM ASSORTMENT

**Door Grille Assortment**

See Price Catalog for Assortment Contents and Costs

- 09945346 DOOR GRILLE ASSORTMENT

09417472 2 FT ULTRA RESIDENTIAL THRESHOLD & DOOR BOTTOM ASSORTMENT



09417474 4 FT ULTRA THRESHOLDS / SWEEPS / DOOR BOTTOMS ASSORTMENT



09417473 2 FT ULTRA JAMB-UP / INSERTS / DOOR BOTTOMS ASSORTMENT

### FLOORING INSTALLATION PRODUCTS ASSORTMENTS

#### Tile Installation Tools Assortments

See Price Catalog for Assortment Contents and Costs

09417084 4 FT TILE INSTALLATION TOOL ASSORTMENT

09417370 4 FT PRO TILE INSTALLATION TOOL ASSORTMENT



09417084 4 FT TILE INSTALLATION TOOL ASSORTMENT

FLOORING PRODUCTS ASSORTMENTS

**Aluminum Carpet Trim Assortments**

See Price Catalog for Assortment Contents and Costs

- 09417476 2 FT FLOOR TRENDS ALUMINUM & WOOD TRIM ASSORTMENT
- 09417477 2 FT ALUMINUM FLOOR TRIM ASSORTMENT
- 09417479 4 FT ALUMINUM & HARDWOOD FLOOR TRIM ASSORTMENT
- 09417570 4 FT ALUMINUM FLOOR TRIM ASSORTMENT

**Hardwood Floor Trim Assortments**

See Price Catalog for Assortment Contents and Costs

- 09417478 2 FT HARDWOOD FLOOR TRIM ASSORTMENT



09417476 2 FT FLOOR TRENDS ALUMINUM & WOOD TRIM ASSORTMENT

09417477 2 FT ALUMINUM FLOOR TRIM ASSORTMENT

### FLOORING PRODUCTS ASSORTMENTS

#### Ceramic Tile Edging Assortment

See Price Catalog for Assortment Contents and Costs  
 09416595 3 FT. CERAMIC TILE EDGING ASSORTMENT



09416595 3 FT. CERAMIC TILE EDGING ASSORTMENT

#### Wall Base Assortments

See Price Catalog for Assortment Contents and Costs  
 09415092 4 FT CORE VINYL WALL BASE ASSORTMENT  
 09417420 4 FT HORIZONTAL WALL BASE DRYBACK ASSORTMENT



09415092 CORE VINYL WALL BASE ASSORTMENT

#### Stick 'n Step® Assortments

See Price Catalog for Assortment Contents and Costs  
 09417346 2 FT. 4" X 16" STICK 'n STEP ASSORTMENT  
 09417362 2 FT. COMBO STICK 'n STEP ASSORTMENT  
 09417354 4 FT. COMBO STICK 'n STEP ASSORTMENT



09417346 2 FT. 4" X 16" STICK 'n STEP ASSORTMENT

**ALUMINUM SHAPES & METAL SHEETS ASSORTMENTS**

**Aluminum Shapes Assortments**

See Price Catalog for Assortment Contents and Costs

- 09944414 2 FT SHAPES ASSORTMENT – 6 FT & 8 FT LENGTHS
- 09427113 2 FT SHAPES ASSORTMENT – 4 FT LENGTHS
- 09416728 2 FT SHAPES ASSORTMENT - FREE STANDING – 4 FT LENGTHS
- 09416736 2 FT SHAPES ASSORTMENT - FREE STANDING – 4 FT & 6 FT LENGTHS

**Metal Sheets Assortments**

See Price Catalog for Assortment Contents and Costs

- 09944406 3 FT ALUMINUM SHEETS ASSORTMENT
- 09416544 4 FT SHEETS PROJECT CENTER ASSORTMENT
- 09416536 4 FT SMALL SHEETS ASSORTMENT



09944406 3 FT ALUMINUM SHEETS ASSORTMENT



09416736 2 FT SHAPES ASSORTMENT – FREE STANDING – 4 FT & 6 FT LENGTHS



# FULL LINE CATALOG

## PRODUCT INDEX

M-D ITEM #	CATALOG PAGE #	M-D ITEM #	CATALOG PAGE #	M-D ITEM #	CATALOG PAGE #	M-D ITEM #	CATALOG PAGE #
00687	.45	03822	.14	06619	.11	08904	.28
00760	.45	03939	.17	06635	.11	09043	.24
01025	.16	04184	.12	06668	.16	09159	.24
01033	.16	04200	.12	06684	.59	09365	.25
01040	.22	04226	.22	06700	.59	09415	.27
01073	.22	04242	.22	07039	.20	09548	.28
01156	.22	04267	.12	07112	.64	09563	.27
01271	.22	04283	.12	07153	.19	09613	.27
01305	.24	04309	.18	07179	.19	10017	.25
01438	.22	04325	.18	07237	.19	10116	.24
01560	.39	04341	.18	07385	.64	10322	.28
01586	.39	04366	.18	07393	.64	10751	.64
01610	.23	04440	.12	07401	.64	10769	.64
01636	.23	04598	.12	07419	.64	10777	.64
01669	.22	04630	.13	07427	.64	10785	.64
01677	.22	04663	.18	07435	.64	10793	.64
01750	.23	04689	.18	07443	.64	10801	.64
01958	.22	04762	.13	07468	.64	10819	.64
02006	.15	04770	.13	07476	.65	10827	.64
02055	.11	04788	.13	07484	.65	10835	.64
02071	.11	04796	.13	07492	.65	10843	.64
02097	.11	04929	.17	07500	.65	10850	.64
02113	.11	04937	.17	07518	.65	10868	.64
02238	.11	05017	.19	07526	.65	10922	.64
02253	.11	05058	.19	07534	.65	10924	.64
02279	.11	05090	.19	07542	.65	10926	.64
02295	.11	05173	.19	07559	.65	10928	.64
02311	.11	05215	.19	07567	.65	11056	.27
02352	.16	05322	.21	07575	.65	11072	.27
02378	.17	05389	.18	07583	.65	11205	.27
02394	.17	05413	.18	07766	.13	11346	.27
02535	.15	05512	.21	08003	.25	11502	.30
02550	.10	05520	.22	08029	.25	11544	.30
02576	.10	05546	.21	08078	.25	11619	.30
02592	.10	05587	.19	08086	.24	11742	.26
02618	.10	05603	.19	08102	.24	11767	.26
02733	.11	05629	.19	08151	.24	11783	.26
02758	.11	05652	.18	08185	.25	11809	.26
02790	.11	05702	.19	08243	.25	11874	.26
02816	.11	05744	.18	08264	.12	11882	.26
02832	.11	05769	.18	08273	.12	11908	.26
02857	.11	05991	.20	08286	.13	11924	.26
02873	.11	06015	.21	08308	.15	13029	.28
02899	.11	06056	.21	08311	.15	13094	.28
03100	.11	06098	.21	08383	.25	13219	.29
03335	.12	06114	.21	08409	.25	13383	.29
03350	.12	06155	.21	08433	.27	13409	.29
03376	.16	06197	.21	08456	.14	13417	.29
03392	.15	06247	.22	08460	.14	13466	.29
03426	.15	06304	.22	08462	.14	13524	.29
03434	.16	06395	.21	08472	.14	13565	.29
03509	.13	06403	.21	08599	.27	13748	.28
03525	.24	06411	.19	08631	.28	19725	.64
03541	.24	06478	.21	08656	.28	19733	.65
03723	.14	06528	.20	08664	.24	19741	.65
03749	.14	06577	.11	08748	.25	19750	.64
03772	.15	06593	.11	08763	.30	19777	.67





## PRODUCT INDEX

M-D ITEM #	CATALOG PAGE #	M-D ITEM #	CATALOG PAGE #	M-D ITEM #	CATALOG PAGE #	M-D ITEM #	CATALOG PAGE #
20044	48	28555	40	43732	59	48086	53
20045	48	28571	40	43734	59	48088	44
20047	48	28639	40	43742	61	48090	53
20048	48	28654	40	43746	61	48092	53
20049	48	28787	40	43748	56	48094	53
20050	48	28795	40	43755	58	48098	53
20051	48	28803	40	43811	56	48100	53
20052	48	29702	69	43813	56	48104	53
20053	48	29710	69	43816	20	48106	53
20054	48	30000	48	43818	23	48108	53
20055	48	30004	47	43820	20	48110	54
20056	48	31142	67	43822	24	48113	52
20057	48	31143	67	43824	28	48114	54
20058	48	31144	67	43826	28	48120	54
20059	48	31203	12	43846	10	48152	44
20060	48	31215	69	43848	10	48154	44
20061	48	31220	69	43854	57	48155	50
20062	48	31894	65	43856	57	48158	45
20063	47	31896	65	43858	58	48160	54
20064	47	32009	61	43860	58	48170	65
20065	47	32010	61	43872	59	48178	65
20097	48	32012	61	43874	59	48188	58
20098	48	32013	61	43878	61	48190	44
20099	48	33118	40	43880	61	48191	44
21478	67	33167	40	43882	60	48194	54
21485	67	33209	40	43886	60	48195	54
21501	67	33282	40	43928	57	48901	63
23621	68	33308	40	43932	59	48905	63
23647	68	33324	40	43936	61	48909	63
23662	68	33340	40	43938	60	48913	63
23688	68	33365	40	45907	57	48927	63
23886	68	33381	40	45909	57	48931	63
23944	68	33605	40	46131	56	48996	18
25706	35	33621	40	46133	56	48998	21
25708	35	40120	57	46137	56	49000	21
25710	36	40122	57	46139	56	49002	22
25714	36	40124	57	46141	56	49004	24
25716	35	40126	57	46145	56	49006	25
25718	35	40132	59	46147	56	49008	24
25722	39	40134	59	46149	56	49010	27
25724	39	40136	59	46240	56	49038	48
25726	39	40138	59	46244	56	49046	44
25730	38	43100	12	46586	70	49047	45
25732	38	43101	12	46594	70	49054	46
25734	36	43151	24	46596	70	49058	44
25736	36	43153	18	46600	70	49062	46
25740	37	43154	11	46602	70	49066	50
25742	37	43155	11	46612	70	49070	47
25744	38	43157	13	46618	70	49074	47
25748	38	43712	57	46620	70	49078	45
25750	38	43714	57	47000	20	49084	46
25752	38	43716	57	47002	23	49090	50
25756	22	43718	57	48076	52	49094	47
25756	36	43720	60	48078	52	49096	45
27094	51	43722	60	48080	52	49100	47
28472	40	43726	60	48082	52	49102	47
28506	40	43730	60	48084	52	49104	47





# FULL LINE CATALOG

## PRODUCT INDEX

M-D ITEM #	CATALOG PAGE #	M-D ITEM #	CATALOG PAGE #	M-D ITEM #	CATALOG PAGE #	M-D ITEM #	CATALOG PAGE #
49108	47	56006	82	58065	76	59451	79
49110	48	56008	82	58073	76	59469	79
49112	48	56012	82	58081	76	59477	80
49116	48	56014	82	58099	76	59485	80
49118	49	56016	82	58156	76	59501	81
49120	49	56018	82	58164	76	59519	81
49124	49	56020	83	58172	76	59527	81
49126	46	56022	83	58180	76	59535	81
49134	51	56026	83	58214	77	59576	81
49136	50	56030	82	58222	77	59634	81
49142	50	56032	83	58230	77	59840	81
49144	47	56034	84	58248	77	59857	81
49146	50	56038	84	58255	77	59865	81
49152	51	56040	82	58263	77	60000	52
49156	51	56062	82	58271	77	60632	79
49160	49	56064	82	58289	77	60640	79
49162	49	56066	84	58297	77	60699	76
49164	49	56070	84	58305	77	60707	76
49166	49	56072	83	58313	77	60715	76
49168	49	56074	84	58354	79	60723	76
49174	50	56078	84	58362	79	60731	76
49194	44	56080	82	58420	79	60749	76
49195	44	56086	82	58438	79	60756	76
49807	48	56088	82	58453	79	60764	76
49819	48	56090	82	58461	79	60772	76
49821	48	57000	82	58479	79	60822	77
49823	48	57005	83	58487	80	60830	77
49827	49	57010	83	58495	80	60848	77
49829	49	57015	82	58503	81	60855	77
49834	51	57026	82	58511	81	60863	77
49837	49	57042	82	58529	81	60871	77
49847	46	57067	82	58537	81	60889	77
49887	45	57083	82	58552	81	60897	77
49905	45	57109	82	59014	76	61002	77
49943	46	57125	82	59022	76	61010	77
49977	46	57141	82	59030	76	61036	77
49977	54	57166	82	59048	76	61044	77
49985	47	57182	82	59055	76	61051	77
50005	15	57208	82	59063	76	61077	77
50007	15	57240	82	59071	76	61085	77
50040	15	57265	82	59089	76	61101	77
50042	15	57281	82	59097	76	61119	78
50060	10	57349	83	59162	76	61135	78
50100	13	57364	83	59188	76	61143	78
50101	13	57372	83	59196	78	61150	78
50140	17	57398	83	59204	78	61168	78
50142	17	57406	83	59212	78	61184	78
50144	17	57794	82	59220	78	61192	78
50148	17	57810	82	59238	78	61200	78
50150	17	57836	83	59246	78	61218	78
50154	17	57851	83	59253	78	61226	81
50158	17	58008	76	59261	78	61234	81
50162	17	58016	76	59279	78	61242	81
50164	17	58024	76	59287	78	61259	81
55160	59	58032	76	59295	78	61275	79
56000	82	58040	76	59337	79	61291	79
56004	82	58057	76	59428	79	61317	80







PRODUCT INDEX

M-D ITEM #	CATALOG PAGE #	M-D ITEM #	CATALOG PAGE #	M-D ITEM #	CATALOG PAGE #	M-D ITEM #	CATALOG PAGE #
61341	.80	66472	.57	69596	.36	70086	.74
61374	.80	67106	.34	69604	.32	70094	.72
61440	.80	67107	.34	69609	.32	70144	.72
61465	.80	67109	.34	69612	.35	70201	.72
61481	.80	67110	.34	69620	.35	70243	.73
61634	.77	67165	.74	69633	.35	70276	.73
61644	.77	67167	.74	69638	.35	70318	.73
61649	.77	67215	.61	69644	.35	70359	.73
61665	.79	67322	.73	69648	.35	70367	.73
61674	.79	67363	.72	69652	.35	70391	.72
62018	.77	67371	.72	69694	.37	70409	.72
62026	.77	67439	.57	69698	.37	70425	.72
62034	.77	67967	.20	69703	.37	70441	.72
62042	.77	68247	.32	69709	.37	71464	.16
62059	.77	68254	.32	69733	.37	71480	.16
62075	.77	68288	.31	69737	.37	71506	.16
62083	.77	68296	.31	69745	.37	71522	.16
62109	.78	68304	.31	69749	.37	71548	.16
62125	.78	68312	.31	69752	.37	72017	.59
62133	.78	68320	.31	69791	.32	72066	.58
62141	.78	68338	.31	69808	.31	72074	.57
62158	.78	68346	.31	69811	.31	72132	.59
62174	.78	68353	.31	69816	.32	72249	.58
62182	.78	68361	.31	69824	.32	72256	.57
62190	.78	68387	.31	69828	.31	73098	.72
62208	.78	68395	.31	69833	.31	73122	.72
62216	.81	68403	.32	69839	.38	73262	.61
62224	.81	68429	.38	69844	.38	73270	.61
62232	.81	68437	.38	69848	.38	73304	.61
62240	.81	68510	.10	69851	.38	73792	.66
62299	.80	68510	.33	69858	.38	73794	.66
62323	.80	68544	.39	69860	.38	73804	.66
62356	.80	68593	.33	69867	.38	73806	.66
63602	.10	68601	.32	69871	.38	73810	.66
63628	.10	68627	.32	69875	.38	73812	.66
63644	.10	68635	.31	69901	.38	73814	.66
63669	.10	68668	.10	69909	.38	73820	.66
64386	.18	68668	.33	69911	.38	73822	.66
64394	.18	68676	.10	69918	.38	73826	.66
64428	.18	68676	.33	69923	.38	73896	.68
64444	.18	68684	.32	69927	.38	73897	.68
64469	.18	68692	.31	69935	.38	73898	.68
64501	.18	68726	.32	69938	.38	73899	.68
65110	.66	68734	.32	69940	.38	73900	.68
65770	.69	69138	.74	69945	.38	74187	.57
65788	.69	69450	.72	69956	.39	74336	.57
66001	.56	69500	.35	69962	.39	74450	.59
66019	.59	69505	.35	69969	.39	74492	.59
66035	.61	69514	.35	69974	.39	74534	.60
66084	.58	69521	.35	69989	.39	74575	.60
66092	.57	69539	.36	70011	.72	74690	.61
66217	.56	69547	.36	70023	.39	74732	.61
66225	.59	69554	.36	70031	.39	74930	.58
66266	.61	69562	.36	70045	.73	74971	.58
66324	.58	69570	.36	70056	.34	75093	.66
66407	.72	69588	.36	70068	.34	75218	.68
66449	.58	69591	.36	70077	.37	75234	.68





# FULL LINE CATALOG

## PRODUCT INDEX

M-D ITEM #	CATALOG PAGE #	M-D ITEM #	CATALOG PAGE #	M-D ITEM #	CATALOG PAGE #	M-D ITEM #	CATALOG PAGE #
75259	.68	78618	.34	85043	.62	92924	.42
75275	.68	78634	.34	85050	.62	93146	.69
75291	.68	78691	.33	85068	.62	93161	.69
75302	.66	78840	.33	85092	.62	93187	.69
75312	.66	78873	.33	85100	.62	93203	.69
75314	.66	78899	.34	85233	.62	93229	.69
75317	.68	78907	.34	85241	.62	93245	.69
75320	.66	79004	.56	85258	.62	93967	.42
75322	.66	79012	.59	85266	.62	93968	.42
75457	.68	79020	.61	85290	.62	93969	.42
75465	.68	79038	.61	85308	.62	93975	.42
75473	.68	79046	.58	85357	.62	94005	.42
75481	.68	79053	.60	85365	.62	94010	.42
75499	.68	79061	.60	85373	.62	94091	.28
75507	.68	79079	.57	85381	.62	95638	.67
75556	.69	79087	.56	85415	.62	95653	.67
75572	.69	79095	.59	85423	.62	95661	.67
75598	.68	79103	.61	85431	.62	09415092	.69, 90
75614	.68	79111	.61	85449	.62	09416536	.84, 91
75630	.68	79129	.58	85472	.63	09416544	.84, 91
75655	.68	79137	.60	85480	.63	09416553	.29, 86
75671	.68	79145	.60	85530	.63	09416595	.66, 90
75697	.68	79152	.57	85548	.63	09416728	.84, 91
75887	.68	79244	.58	85597	.63	09416736	.84, 91
75903	.68	79251	.58	85605	.63	09417084	.51, 88
75929	.68	79962	.36	85613	.62	09417346	.70, 90
75945	.68	79970	.36	85621	.62	09417354	.70, 90
75960	.68	79988	.36	85639	.62	09417362	.70, 90
76265	.33	79996	.36	87619	.15	09417370	.51, 88
76281	.33	80317	.36	87635	.22	09417420	.69, 90
77768	.39	80374	.36	87643	.14	09417470	.29, 86
77792	.33	80465	.36	87668	.14	09417471	.29, 86
77800	.33	80622	.35	87684	.14	09417472	.39, 87
77883	.38	80630	.35	87700	.14	09417473	.39, 87
77891	.38	81661	.36	87726	.14	09417474	.39, 87
77909	.38	81679	.37	87742	.14	09417475	.39, 87
78006	.56	81687	.37	87767	.23	09417476	.61, 89
78014	.59	81697	.37	87783	.23	09417477	.61, 89
78022	.61	81703	.37	87791	.39	09417478	.63, 89
78030	.61	81810	.37	87809	.39	09417479	.61, 89
78048	.58	81828	.37	87916	.16	09417570	.61, 89
78055	.60	81869	.38	87981	.23	09427113	.84, 91
78063	.60	81877	.38	91194	.67	09427600	.29, 86
78071	.57	81885	.38	91800	.23	09427618	.29, 86
78089	.56	81893	.38	91850	.23	09944406	.84, 91
78097	.59	81901	.35	91868	.23	09944414	.84, 91
78105	.61	81919	.35	91884	.23	09945346	.40, 87
78113	.61	81927	.35	92288	.42		
78121	.58	81935	.35	92296	.42		
78139	.60	82578	.20	92325	.42		
78147	.60	82586	.20	92346	.42		
78154	.57	82594	.20	92379	.42		
78196	.12	84160	.82	92395	.42		
78212	.58	84186	.82	92395	.42		
78220	.58	84327	.82	92437	.42		
78394	.12	85001	.62	92908	.42		
78600	.34	85019	.62	92910	.42		







**M-D Building  
Products**

**4041 N Santa Fe  
Oklahoma City, OK 73118  
800.654.8454  
[www.mdteam.com](http://www.mdteam.com)**

**09902011**