



# MOULTRIE®

## Instructions for Feeder Feet Gen2

THANK YOU for your purchase of the Feeder Feet Gen2. Please read this sheet before operating the unit. If you should have any questions about this product or any other Moultrie product, please contact us using the information on the back of this sheet. To help us to better serve you and to activate your Lifetime Warranty, please submit your warranty information online at <http://www.moultriefeeders.com/warranty>

### A INSTALLING ON 1.5" SQUARE TUBE LEGS

- 1** Remove pin from feeder feet assembly.

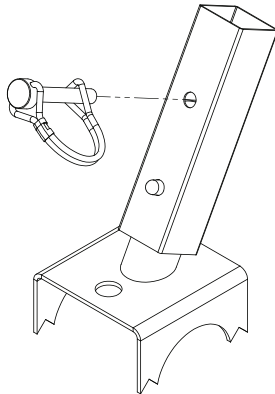

- 2** Slide whole assembly into 1.5" Square tube feeder leg.

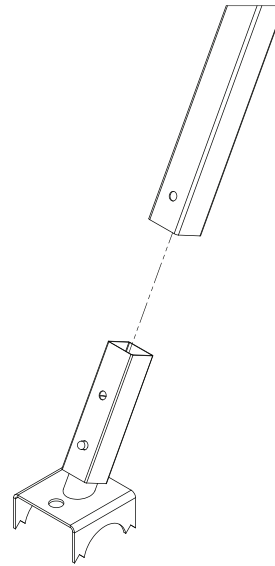

- 3** Insert pin through hole of leg and adapter.

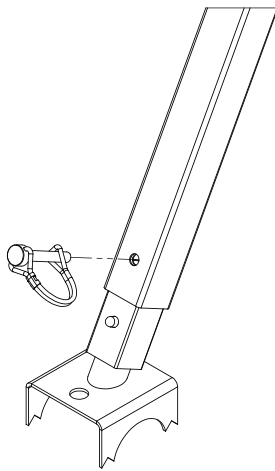

- 4** Insert Stake through foot into the ground to the desired depth.

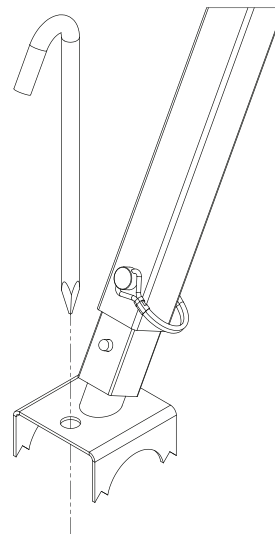

- 5** Repeat for all three feeder feet.



**WARNING: Do not use feeder feet on hard/slick ground or surfaces without stakes.**





## **B** INSTALLING ON 1.25" SQUARE TUBE LEGS OR 1.25" ROUND LEGS

**1** Remove pin from feeder feet assembly.

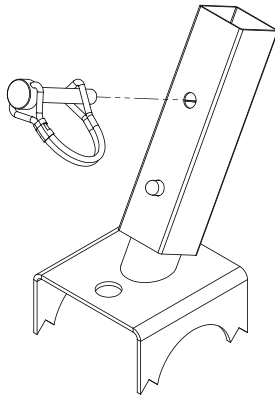

**2** Press in button and remove adapter from feeder feet assembly.

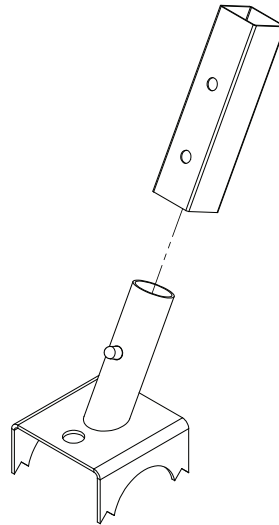

**3** Press button and insert foot into square leg (or round leg) until button snaps in place into hole in leg

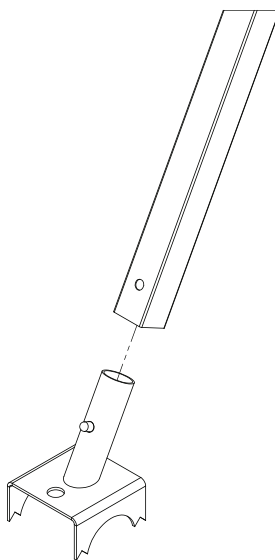

**4** Insert Stake through foot into the ground to the desired depth.

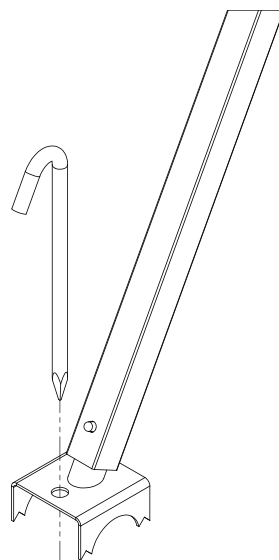

**5** Repeat for all three feeder feet.



**WARNING: Do not use feeder feet on hard/slick ground or surfaces without stakes.**

**MOULTRIE**

Our Service Department will gladly answer any questions you have.  
[www.moultriefeeders.com/support](http://www.moultriefeeders.com/support)

08132020 / MFG-13455

