

Merchandising

Display Programs:

Our high-impact styrene display cabinets are engineered specifically for the storage and display of packages and/or loose fasteners. They are attractively designed, yet are built to withstand heavy-duty usage for many years of service. These display fixtures are available at no-charge to qualified retailers. The display cabinets' space-saving design allows for maximum product per square foot of floor space, and the product is presented to the customer in an orderly and "easy-to-shop" style.

Point-Of-Sale Graphics:

Midwest Fastener offers a complete graphics package for your fastener department which includes color-coded bin labels, indexers, box labels and overhead signage. They are designed to aid the customer in making the correct purchase. (They are a silent sales force working for you every day.) All of our graphics are item specific, and the first generation artwork is the best available in our industry.

Pricing Programs:

The Midwest pricing program will give you 100% control of your fastener profits. You can choose any margin markup for your display. You can even request different price margins for each product group or customize your prices item by item. Our partner pricing option provides more profit to the retailer. You request it, and we will do it. We also can provide price stickers for packaged goods provided at no charge upon your request.

Service

Our Sales-Force:

There are hundreds of men and women representing Midwest Fastener every day. They are professional people who will:

- Design and install your fastener department.
- Service and maintain your fastener department on a regular schedule.
- Become your partner in profit when it comes to fasteners and specialty products.

Our Website:

- The industry's only business to business website allowing you to place orders, check order status, track returns and get item history information: www.fastenerconnection.com

Our Distribution System:

- Midwest Fastener Corporation has five distribution centers located across the United States, with over 600,000 square feet of modern and efficient warehousing space to serve you.
- Your orders are processed within 48 hours and will have a 98% fill rate on all product groups...no excuses!
- Toll-Free fax lines are available 24 hours a day for your convenience.
- Low prepaid freight minimum.
- Midwest Fastener has a dependable and knowledgeable office staff ready to answer your questions, help with orders, and offer you quotes.

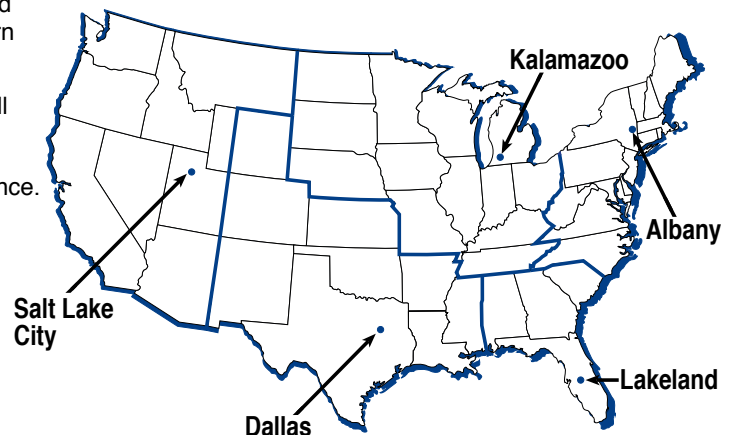

Many
NEW
Displays!

Saberdrive Program



THE COMPLETE SELECTION

**100's
of NEW
Items!**



Bigger Bite.
Better Drive.

SABER DRIVE



**Star Drive
No Cam-Out**

**Green, Tan, Red
& Gold Deck Screws**

XL1500 COATING



**Green, Tan & White
Trim Screws**

XL1500 COATING

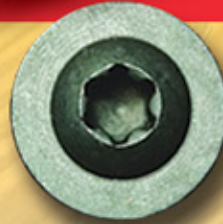

**Green & Tan
Construction Lag Screws**

XL1500 COATING



**Green & Tan Timber
Screws**

XL1500 COATING



**Serrated Thread
Secure Fastening**



**Type 17-Point
No Pre-Drilling**



**Tan Hex Head Construction
& Ledger Screws**

XL1500 COATING

Now featuring
fully-specced
Construction Lag and
Timber Screws for your
structural project. Available
in Tan and Green, these
screws are tough, require
no pre-drilling, and truly
complete the Saberdrive brand.

Indoor construction

Use for fences, decks, sheds & other outdoor projects



2



Saberdrive Features:

- Star Drive reduces Cam-out
- Unique serrated thread for secure fastening
- Type 17-point eliminates the need for pre-drilling and reduces wood splitting
- Available in both interior & exterior use screws
- Convenient package quantities for any project
- Consumer recognized brand name
- Screws are case hardened

Table of Contents

Construction Lag Screws & Timber Screws

Saberdrive Structural Tubs - 4 & 5



Construction Lag Screws, Ledger & Timber Screws

Saberdrive Structural Boxes - 6 & 7



1lb, 5lb, 25lb Tubs

Saberdrive Buckets - 8 & 9



1lb, 5lb, 1/4 Kegs

Saberdrive Boxes - 10 & 11



"Small Project Needs"

Hanging Packs - page 12



Preset Displays

Pages 13, 14 & 15



Great for treated lumber decks, railings, spindles, stairs & siding

For All of Your Construction Needs. Large & Small.





**Bigger Bite.
Better Drive.**

SABER DRIVE

**Construction Lag &
Timber Screw Buckets**

Construction Lag Screws

Buckets - Tan

S/C	SIZE	PCS/BUCKET
52530	1/4x1-1/2	100
52531	1/4x2	75
52532	5/16x2-1/2	50
52533	5/16x3	40
52534	5/16x3-1/2	35
52535	5/16x4	30
52536	5/16x5	25
52537	5/16x6	20
52538	5/16x8	30
52539	3/8x6	20
52540	3/8x8	25
52541	3/8x10	25



Construction Lag Screws

10lb Bucket - Tan

S/C	SIZE	PCS/BUCKET
52542	1/4x1-1/2	778
52543	1/4x2	644
52544	5/16x2-1/2	381
52545	5/16x3	330
52546	5/16x3-1/2	295
52547	5/16x4	258
52548	5/16x5	211
52549	5/16x6	179
52550	5/16x8	140



Construction Lag Screws

20lb Bucket - Tan

S/C	SIZE	PCS/BUCKET
52557	5/16x4	516
52558	5/16x5	422
52559	5/16x6	358



Indoor construction

Use for fences, decks, sheds & other outdoor projects



Program Features:

- Fully specced for structural applications
- Star and Hex Drive reduces Cam-out
- Unique serrated thread for secure fastening
- Type 17-point eliminates the need for pre-drilling and reduces wood splitting
- Available in both interior & exterior use screws
- Convenient package quantities for any project
- Consumer recognized brand name
- Screws are case hardened

Ledger Board Screws



Bucket - Tan

S/C	SIZE	PCS/BUCKET
53749	5/16x1-1/2	100
53750	3/8x2	100
53751	3/8x2-1/2	75
53752	3/8x3	50
53753	3/8x3-5/8	50
53754	3/8x4	35
53755	3/8x5	25
53756	3/8x6	25
53757	3/8x8	25
53758	3/8x10	25
53759	3/8x12	25
53760	3/8x14	25



Hex Timber Screws

Bucket - Tan

S/C	SIZE	PCS/BUCKET
52551	1/4x4	50
52552	1/4x6	40
52553	1/4x8	50
52554	1/4x10	40
52555	5/16x12	30
52556	5/16x14	30



Hex Timber Screws

10 lb Tub - Tan

S/C	SIZE	PCS/BUCKET
53722	1/4x4	248
53723	1/4x6	172
53724	1/4x8	131
53725	1/4x10	107
53693	5/16x12	91
53694	5/16x14	78



The Ultimate Construction Screw In The Ultimate Container





**Bigger Bite.
Better Drive.**

SABER DRIVE

**Construction Lag &
Timber Screw Boxes**



Construction Lag Screws

Bulk Box - Green

S/C	SIZE	PCS/BOX
09757	1/4x1-1/2	100
09758	1/4x2	75
09759	5/16x2-1/2	50
09760	5/16x3	40
09427	5/16x3-1/2	35
09428	5/16x4	30
09429	5/16x5	25
09430	5/16x6	20
09431	5/16x8	30
09765	3/8x6	30
09766	3/8x8	25
09767	3/8x10	25

10lb Box - Green

S/C	SIZE	PCS/BOX
09761	1/4x1-1/2	751
09762	1/4x2	601
09763	5/16x2-1/2	352
09764	5/16x3	310
09432	5/16x3-1/2	282
09433	5/16x4	249
09434	5/16x5	203
09435	5/16x6	174
09436	5/16x8	133

Bulk Box - Tan

S/C	SIZE	PCS/BOX
51950	1/4x1-1/2	100
51951	1/4x2	75
51952	5/16x2-1/2	50
51953	5/16x3	40
51954	5/16x3-1/2	35
51955	5/16x4	30
51956	5/16x5	25
51957	5/16x6	20
51958	5/16x8	30
51959	3/8x6	30
51960	3/8x8	30
51961	3/8x10	25

10lb Box - Tan

S/C	SIZE	PCS/BOX
51962	1/4x1-1/2	778
51963	1/4x2	644
51964	5/16x2-1/2	381
51965	5/16x3	330
51966	5/16x3-1/2	295
51967	5/16x4	258
51968	5/16x5	211
51969	5/16x6	179
51970	5/16x8	140

Indoor construction

Use for fences, decks, sheds & other outdoor projects

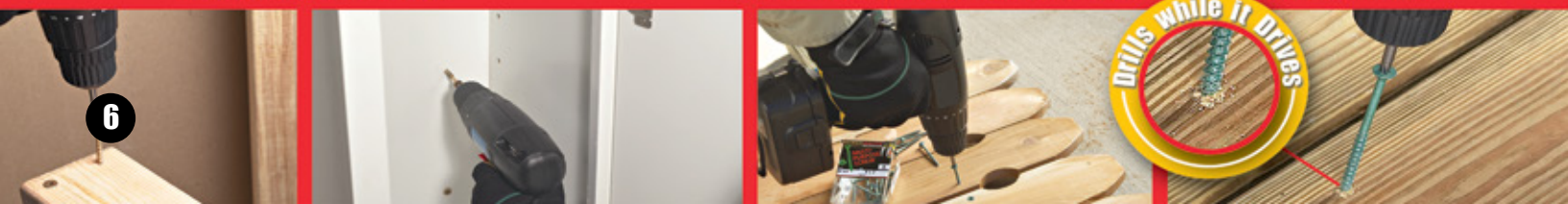

Program Features:

- Fully specced for structural applications
- Star and Hex Drive reduces Cam-out
- Unique serrated thread for secure fastening
- Type 17-point eliminates the need for pre-drilling and reduces wood splitting
- Available in both interior & exterior use screws
- Convenient package quantities for any project
- Consumer recognized brand name
- Screws are case hardened



Hex Timber Screws

Bulk Box - Green

S/C	SIZE	PCS/BOX
09348	1/4x4	50
09349	1/4x6	50
09350	1/4x8	50
09351	1/4x10	40
50269	5/16x12	30
50270	5/16x14	30

Bulk Box - Tan

S/C	SIZE	PCS/BOX
51971	1/4x4	50
51972	1/4x6	50
51973	1/4x8	50
51974	1/4x10	40
51975	5/16x12	30
51976	5/16x14	30

10lb Box - Tan

S/C	SIZE	PCS/BOX
53229	1/4x4	248
53230	1/4x6	172
53231	1/4x8	131
53232	1/4x10	107
53233	5/16x12	91
53234	5/16x14	78



Hex Construction Lag Screws

Bulk Box - Tan

S/C	SIZE	PCS/BOX
52005	5/16x1-1/2	100
52006	3/8x2	100
52007	3/8x2-1/2	75
52008	3/8x3	50

Ledger Board Screws

Bulk Box - Tan

S/C	SIZE	PCS/BOX
52009	3/8x3-5/8	50
52010	3/8x4	35
52011	3/8x5	25
52012	3/8x6	25
52013	3/8x8	25
52014	3/8x10	25
52015	3/8x12	25
52016	3/8x14	25

10 lb Box - Tan

S/C	SIZE	PCS/BOX
52017	3/8x3-5/8	198
52018	3/8x4	182
52019	3/8x5	151
52020	3/8x6	128
52021	3/8x8	99
52417	3/8x10	81
52418	3/8x12	67
52419	3/8x14	58

Fully Specced For Structural Applications





Bigger Bite.
Better Drive.

SABER DRIVE

1, 5, 25 lb Tubs

Cabinet Screws

1 lb. Tubs

S/C	SIZE	PCS/TUB
50238	9x1-3/4	126
50239	9x2-1/2	89



1 lb. Tubs - White Heads

S/C	SIZE	PCS/TUB
54094	9x1-1/4	163
54095	9x1-1/2	143
54096	9x1-3/4	123
54097	9x2-1/2	87
54098	9x3	75
54099	9x3-1/2	64



5 lb. Tubs

S/C	SIZE	PCS/TUB
50244	9x1-3/4	630
50245	9x2-1/2	445



Trim Screws

1 lb. Tubs - Gold

S/C	SIZE	PCS/TUB
50240	8x1-5/8	203
50241	8x2	169
50242	8x2-1/2	136
50243	8x3	91



1 lb. Tubs - Green Coated

S/C	SIZE	PCS/TUB
50312	8x1-5/8	208
50313	8x2	173
50314	8x2-1/2	136
50315	8x3	93



1 lb. Tubs - White Coated

S/C	SIZE	PCS/TUB
51253	8x1-5/8	206
51254	8x2	171
51255	8x2-1/2	109
51256	8x3	92



1 lb. Tubs - Tan Coated

S/C	SIZE	PCS/TUB
51667	8x1-5/8	208
51668	8x2	173
51669	8x2-1/2	136
51670	8x3	93



1 lb. Tubs - Stainless Steel

S/C	SIZE	PCS/TUB
50316	8x1-5/8	208
50317	8x2	173
50318	8x2-1/2	110
50319	8x3	93



5 lb. Tubs - Gold

S/C	SIZE	PCS/TUB
50246	8x1-5/8	1015
50247	8x2	845
50248	8x2-1/2	679
50249	8x3	455



5 lb. Tubs - Tan Coated

S/C	SIZE	PCS/TUB
51671	8x1-5/8	1040
51672	8x2	865
51673	8x2-1/2	679
51674	8x3	465



5 lb. Tubs - White Coated

S/C	SIZE	PCS/TUB
51257	8x1-5/8	1030
51258	8x2	855
51259	8x2-1/2	545
51260	8x3	460



5 lb. Tubs - Stainless Steel

S/C	SIZE	PCS/TUB
53761	8x1-5/8	1039
53762	8x2	864
53763	8x2-1/2	548
53764	8x3	464



Composite Trim Screws

1 lb. Tubs - White Ruspert

S/C	SIZE	PCS/TUB
50768	8x1-5/8	221
50769	8x2	176
50770	8x2-1/2	139
50771	8x3	116



5 lb. Tubs - White Ruspert

S/C	SIZE	PCS/TUB
50772	8x1-5/8	1105
50773	8x2	880
50774	8x2-1/2	695
50775	8x3	580



Pocket Cabinet Screws

1 lb. Tubs - Plain, Coarse

S/C	SIZE	PCS/TUB
50320	7x1	213
50321	7x1-1/4	183
50322	7x1-1/2	160
50323	7x2-1/2	107



1 lb. Tubs - Plain, Fine

S/C	SIZE	PCS/TUB
50324	7x1	194
50325	7x1-1/4	166
50326	7x1-1/2	145
50327	7x2-1/2	97



Friction Fit Star Drive Bits for use with Pocket Cabinet Screws

S/C	SIZE	PCS
50328	T15x3	1
50329	T15x6	1

Packed in 1 piece sleeves

Pan Head Screws

1 lb. Tubs - Tan

S/C	SIZE	PCS/TUB
54331	9x1-1/4	149
54332	9x1-1/2	133
54333	9x1-3/4	116
54334	9x2	104
54335	9x2-1/4	99
54336	9x2-1/2	87
54337	9x3	74
54338	10x3-1/2	55
54339	10x4	48



Star Drive Bits

1 lb. Star Drive Bits

S/C	SIZE	PCS/TUB
50370	T10 1"	102
50371	T15 1"	99
50372	T20 1"	95
50373	T25 1"	93
50374	T30 1"	83
51920	T10 Long 2"	56
51921	T15 Long 2"	50
51922	T20 Long 2"	49
51923	T25 Long 2"	48
51924	T30 Long 2"	42



Indoor construction

Use for fences, decks, sheds & other outdoor projects

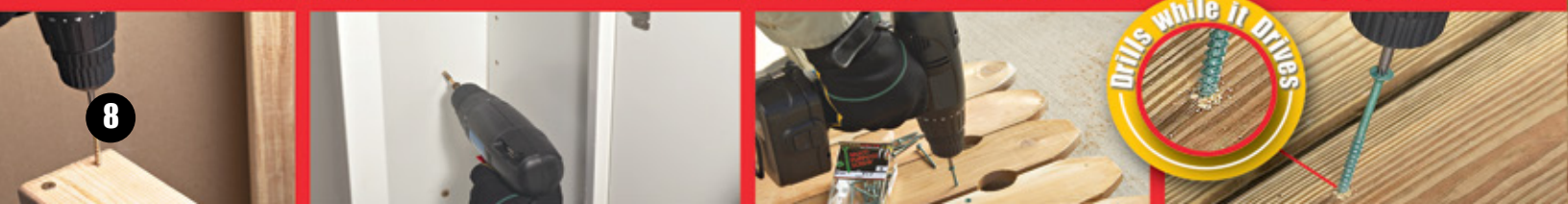

For All Your Project Needs

Program Features:

- Now available in durable 1lb., 5lb. & 25lb. plastic tubs
- Star Drive reduces Cam-out
- Unique serrated thread for secure fastening
- Type 17-point eliminates the need for pre-drilling and reduces wood splitting
- Available in both interior & exterior use screws
- Convenient package quantities for any project
- Consumer recognized brand name
- Screws are case hardened

Exterior Deck Screws

Recommended for Treated Lumber

1 lb. Tubs - Green Coated

S/C	SIZE	PCS/TUB
09880	9x1-1/4	194
50209	9x1-1/2	159
09881	9x1-3/4	141
09882	9x2	124
50234	9x2-1/4	113
09883	9x2-1/2	88
09884	9x3	73
09885	10x3-1/2	55
09886	10x4	48



1 lb. Tubs - Red Coated

S/C	SIZE	PCS/TUB
50289	9x1-1/4	194
50290	9x1-1/2	167
50291	9x1-3/4	141
50292	9x2	124
50293	9x2-1/4	119
50294	9x2-1/2	88
50295	9x3	73
50296	10x3-1/2	55
50297	10x4	48



1 lb. Tubs - Tan Coated

S/C	SIZE	PCS/TUB
50740	9x1-1/4	194
50741	9x1-1/2	167
50742	9x1-3/4	141
50743	9x2	124
50744	9x2-1/4	119
50745	9x2-1/2	88
50746	9x3	73
52377	10x3	69
50747	10x3-1/2	55
50748	10x4	48



5 lb. Tubs - Green Coated

S/C	SIZE	PCS/TUB
09887	9x1-1/4	970
50210	9x1-1/2	795
09888	9x1-3/4	705
09889	9x2	620
50235	9x2-1/4	565
09890	9x2-1/2	439
09891	9x3	363
09892	10x3-1/2	272
09893	10x4	240



5 lb. Tubs - Red Coated

S/C	SIZE	PCS/TUB
50298	9x1-1/4	970
50299	9x1-1/2	835
50300	9x1-3/4	705
50301	9x2	620
50302	9x2-1/4	565
50303	9x2-1/2	439
50304	9x3	363
50305	10x3-1/2	272
50306	10x4	240



5 lb. Tubs - Tan Coated

S/C	SIZE	PCS/TUB
50749	9x1-1/4	970
50750	9x1-1/2	795
50751	9x1-3/4	705
50752	9x2	620
50753	9x2-1/4	565
50754	9x2-1/2	439
50755	9x3	363
52378	10x3	344
50756	10x3-1/2	272
50757	10x4	240



10 lb. Tubs - Tan Coated

S/C	SIZE	PCS/TUB
53292	9x1-1/4	1939
53293	9x1-1/2	1590
53294	9x1-3/4	1409
53295	9x2	1240
53296	9x2-1/4	1129
53297	9x2-1/2	880
53298	9x3	730
53299	10x3-1/2	550
53300	10x4	480
53301	12x5	390
53302	12x6	326



25 lb. Tubs - Green Coated

S/C	SIZE	PCS/TUB
50284	9x1-1/4	5150
51261	9x1-1/2	3975
50285	9x1-3/4	3750
50286	9x2	3325
50287	9x2-1/4	2975
09894	9x2-1/2	2192
09895	9x3	1811
09896	10x3-1/2	1358
50288	10x4	1196
51262	12x5	975
51263	12x6	814



25 lb. Tubs - Red Coated

S/C	SIZE	PCS/TUB
50307	9x2-1/2	2192
50308	9x3	1811
50309	10x3-1/2	1358



25 lb. Tubs - Tan Coated

S/C	SIZE	PCS/TUB
50794	9x1-1/4	5150
51264	9x1-1/2	3975
50795	9x1-3/4	3750
50796	9x2	3325
50797	9x2-1/4	2975
50758	9x2-1/2	2192
50759	9x3	1811
52379	10x3	1719
50760	10x3-1/2	1358
50798	10x4	1196
51265	12x5	975
51266	12x6	814



Stainless Steel Deck Screws

1 lb. Tubs

S/C	SIZE	PCS/TUB
50215	9x1-1/4	194
50216	9x1-1/2	167
50217	9x1-3/4	141
50218	9x2	124
50219	9x2-1/2	86
50220	10x3	60
51675	10x3-1/2	53
51676	10x4	47



5 lb. Tubs

S/C	SIZE	PCS/TUB
51677	9x1-1/4	943
51678	9x1-1/2	834
51679	9x1-3/4	681
51680	9x2	613
50236	9x2-1/2	426
50237	10x3	299
51681	10x3-1/2	264
51682	10x4	233



25 lb. Tubs

S/C	SIZE	PCS/TUB
51818	9x2-1/2	2130
51819	10x3	1492
51822	10x3-1/2	1319



Multi-Purpose Screws (Gold)

1 lb. Tubs

S/C	SIZE	PCS/TUB
50222	8x1-1/4	237
50223	8x1-3/4	158
50211	9x2	124
50224	9x2-1/4	114
50212	9x2-1/2	88
50213	9x3	73
50214	10x3-1/2	55
50225	10x4	48



5 lb. Tubs

S/C	SIZE	PCS/TUB
50226	8x1-1/4	1183
50227	8x1-3/4	789
50228	9x2	646
50229	9x2-1/4	570
50230	9x2-1/2	439
50231	9x3	363
50232	10x3-1/2	272
50233	10x4	240



10 lb. Tubs

S/C	SIZE	PCS/TUB
53303	8x1-1/4	2366
53304	8x1-3/4	1577
53305	9x2	1291
53306	9x2-1/4	1139
53307	9x2-1/2	880
53308	9x3	730
53309	10x3-1/2	550
53310	10x4	480



25 lb. Tubs

S/C	SIZE	PCS/TUB
50761	8x1-1/4	6225
50762	8x1-3/4	4150
50763	9x2	3401
50764	9x2-1/2	2192
50765	9x3	1811
50766	10x3-1/2	1358
50767	10x4	1196



The Ultimate Construction Screw In The Ultimate Container



Bigger Bite.
Better Drive.

SABER DRIVE

1 lb, 5 lb, 1/4 Keg Boxes

Exterior Deck Screws Recommended for Treated Lumber

1 lb. Box - Green Coated

S/C	SIZE	PCS/BOX
09305	9x1-1/4	194
09306	9x1-3/4	141
09307	9x2	124
09308	9x2-1/4	113
09309	9x2-1/2	88
09310	9x3	73
09311	10x3-1/2	55
09312	10x4	48
09313	12x5	39
09314	12x6	33



1 lb. Box - Tan Coated

S/C	SIZE	PCS/BOX
51170	9x1-1/4	194
51171	9x1-3/4	141
51172	9x2	124
51173	9x2-1/4	113
51174	9x2-1/2	88
51175	9x3	73
52374	10x3	69
51176	10x3-1/2	55
51177	10x4	48
51178	12x5	39
51179	12x6	33



1 lb. Box - Red Coated

S/C	SIZE	PCS/BOX
52480	9x1-1/4	194
52481	9x1-1/2	167
52482	9x1-3/4	141
52483	9x2	124
52484	9x2-1/4	119
52485	9x2-1/2	88
52486	9x3	73
52487	10x3-1/2	55
52488	10x4	48
52489	12x5	39
52490	12x6	33



3 lb. Box - Tan Coated

S/C	SIZE	PCS/BOX
54007	9x1-1/4	568
54008	9x1-3/4	412
54009	9x2	366
54010	9x2-1/2	264
54011	9x3	219
54012	10x3-1/2	165
54013	10x4	144
54014	12x5	117



5 lb Box - Green Coated

S/C	SIZE	PCS/BOX
09315	9x1-1/4	970
09316	9x1-3/4	705
09317	9x2	620
09318	9x2-1/4	565
09319	9x2-1/2	439
09320	9x3	363
09321	10x3-1/2	272
09322	10x4	240



5 lb Box - Tan Coated

S/C	SIZE	PCS/BOX
51180	9x1-1/4	970
51181	9x1-3/4	705
51182	9x2	620
51183	9x2-1/4	585
51184	9x2-1/2	439
51185	9x3	363
52375	10x3	344
51186	10x3-1/2	272
51187	10x4	240



5 lb Box - Red Coated

S/C	SIZE	PCS/BOX
52491	9x1-1/4	970
52492	9x1-1/2	835
52493	9x1-3/4	705
52494	9x2	620
52495	9x2-1/4	585
52496	9x2-1/2	439
52497	9x3	363
52498	10x3-1/2	272
52499	10x4	240



Stainless Steel Deck Screws

1lb Box - Stainless Steel

S/C	SIZE	PCS/BOX
09605	9x1-1/4	194
09606	9x1-3/4	141
09607	9x2	124
09608	9x2-1/2	86
09609	10x3	60
09610	10x3-1/2	53



3 lb. Box - Stainless Steel

S/C	SIZE	PCS/BOX
53995	9x1-1/4	580
53996	9x1-3/4	420
53997	9x2	374
53998	9x2-1/2	258
53999	10x3	180
54000	10x3-1/2	159



5lb Box - Stainless Steel

S/C	SIZE	PCS/BOX
09611	9x1-1/4	943
09612	9x1-3/4	705
09613	9x2	613
09614	9x2-1/2	426
09615	10x3	299
09616	10x3-1/2	264



Multi-Purpose Screws (Gold)

1 lb. Box - Gold

S/C	SIZE	PCS/BOX
09287	8x1-1/4	237
09288	8x1-3/4	173
09289	8x2	139
09290	9x2-1/4	114
09291	9x2-1/2	88
09292	9x3	73
09293	10x3-1/2	55
09294	10x4	48
09295	12x5	39
09296	12x6	28



5 lb. Box

S/C	SIZE	PCS/BOX
09297	8x1-1/4	1183
09298	8x1-3/4	789
09299	8x2	695
09300	9x2-1/4	570
09301	9x2-1/2	439
09302	9x3	363
09303	10x3-1/2	272
09304	10x4	240



Cabinet Screws

1lb Box

S/C	SIZE	PCS/BOX
09323	9x1-3/4	126
09324	9x2-1/2	89



1lb Box - White Heads

S/C	SIZE	PCS/BOX
54082	9x1-1/4	163
54083	9x1-1/2	143
54084	9x1-3/4	123
54085	9x2-1/2	87
54086	9x3	75
54087	9x3-1/2	64



5lb Box

S/C	SIZE	PCS/BOX
09325	9x1-3/4	630
09326	9x2-1/2	445



Indoor construction

Use for fences, decks, sheds & other outdoor projects

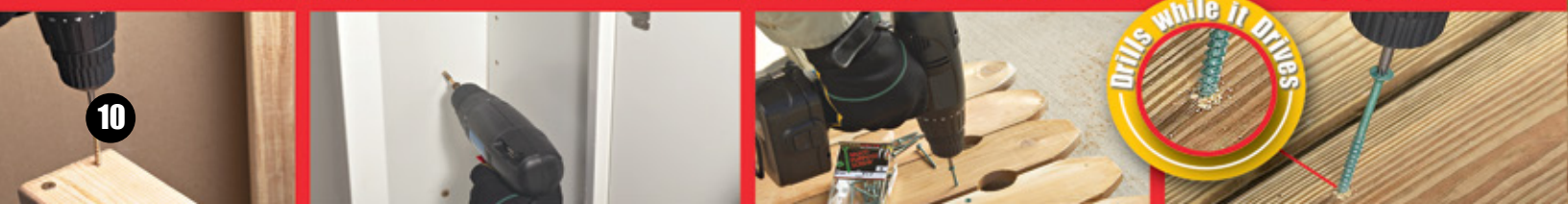

Program Features:

- Now available in reusable 1lb., 5lb. & 1/4 keg boxes
- Star Drive reduces Cam-out
- Unique serrated thread for secure fastening
- Type 17-point eliminates the need for pre-drilling and reduces wood splitting

- Available in both interior & exterior use screws
- Convenient package quantities for any project
- Consumer recognized brand name
- Screws are case hardened

Trim Screws

1lb Box - Gold

S/C	SIZE	PCS/BOX
09327	8x1-5/8	203
09328	8x2	169
09329	8x2-1/2	136
09330	8x3	91
09331	9x4	62
52520	9x5	57



1lb Box - Tan

S/C	SIZE	PCS/BOX
51659	8x1-5/8	208
51660	8x2	173
51661	8x2-1/2	136
51662	8x3	93
52525	9x4	69
52526	9x5	55



1lb Box - Green

S/C	SIZE	PCS/BOX
51663	8x1-5/8	208
51664	8x2	173
51665	8x2-1/2	138
51666	8x3	93



1lb Box - Composite White

S/C	SIZE	PCS/BOX
52503	8x1-5/8	221
52504	8x2	176
52505	8x2-1/2	139
52506	8x3	116
52507	9x4	79
52508	9x5	63



1lb Box - Stainless Steel

S/C	SIZE	PCS/BOX
52514	8x1-5/8	208
52515	8x2	173
52516	9x2-1/2	110
52517	9x3	93
52518	9x4	71
52519	9x5	57



5lb Box - Gold

S/C	SIZE	PCS/BOX
09332	8x1-5/8	1015
09333	8x2	845
09334	8x2-1/2	679
09335	8x3	455



Wood Screws

3lb Box - Gold

S/C	SIZE	PCS/BOX
54001	6x1-1/4	812
54002	8x1-3/4	474
54003	8x2	317
54004	9x2-1/2	264
54005	9x3	219
54006	10x3-1/2	165



5lb Box - Composite White

S/C	SIZE	PCS/BOX
52510	8x1-5/8	1105
52511	8x2	880
52512	8x2-1/2	695
52513	8x3	580



Floor Board Screws

1lb Box

S/C	SIZE	PCS/BOX
51267	1/4-20x1	71
51268	1/4-20x1-1/4	62
51269	1/4-20x1-1/2	54
51270	1/4-20x2	45
51271	1/4-20x2-1/4	40
51272	1/4-20x2-1/2	37
51273	1/4-20x3	31
51274	5/16-18x2	23
51275	5/16-18x2-1/4	21



5lb Box

S/C	SIZE	PCS/BOX
51278	1/4-20x2	225
51279	1/4-20x2-1/4	200
51280	1/4-20x2-1/2	185
51281	5/16-18x2	115
51282	5/16-18x2-1/4	105
51283	5/16-18x2-1/2	100



Cement & Backer Board Screws

1lb Box - Cement Board

S/C	SIZE	PCS/BOX
53205	9x1-1/4	151
53206	9x1-5/8	122



1lb Box - Backer Board

S/C	SIZE	PCS/BOX
53201	10x1-1/4	157
53202	10x1-5/8	129



5lb Box - Cement Board

S/C	SIZE	PCS/BOX
53207	9x1-1/4	752
53208	9x1-5/8	606



5lb Box - Backer Board

S/C	SIZE	PCS/BOX
53203	10x1-1/4	785
53204	10x1-5/8	641



Composite Deck Screws

1lb Box

S/C	SIZE	PCS/BOX	COLOR
09665	10x2-1/2	86	Tan
09669	10x3	71	Tan
09666	10x2-1/2	86	Gray
09670	10x3	71	Gray
09667	10x2-1/2	86	Red
09671	10x3	71	Red
50250	10x2-1/2	86	Brown
50251	10x3	71	Brown
09668	10x2-1/2	86	Stainless
09672	10x3	71	Stainless



Tan Shown

5lb Box

S/C	SIZE	PCS/BOX	COLOR
09673	10x2-1/2	426	Tan
09677	10x3	353	Tan
09674	10x2-1/2	426	Gray
09678	10x3	353	Gray
09675	10x2-1/2	426	Red
09679	10x3	353	Red
50252	10x2-1/2	426	Brown
50253	10x3	353	Brown
09676	10x2-1/2	426	Stainless
09680	10x3	353	Stainless



Tan Shown

1/4 Keg Boxes

Deck Screws Green Coated

S/C	SIZE	PCS/BOX
50206	9x1-1/4	6000
50207	9x1-3/4	4000
09342	9x2	3500
09343	9x2-1/4	3000
09344	9x2-1/2	2500
09345	9x3	2000
09346	10x3-1/2	1500
09347	10x4	1000



Deck Screws Tan Coated

S/C	SIZE	PCS/BOX
51188	9x1-1/4	6000
51189	9x1-3/4	4000
51190	9x2	3500
51191	9x2-1/4	3000
51192	9x2-1/2	2500
51193	9x3	2000
52376	10x3	1500
51194	10x3-1/2	1500
51195	10x4	1000

Deck Screws Red Coated

S/C	SIZE	PCS/BOX
52500	9x2-1/2	2500
52501	9x3	2000
52502	10x3-1/2	1500

Composite Deck Screws

S/C	SIZE	PCS/BOX	COLOR
09681	10x2-1/2	2000	Tan
09685	10x3	1500	Tan
09682	10x2-1/2	2000	Gray
09686	10x3	1500	Gray
09683	10x2-1/2	2000	Red
09687	10x3	1500	Red
50310	10x2-1/2	2000	Brown
50311	10x3	1500	Brown
09684	10x2-1/2	2000	SS
09688	10x3	1500	SS

Multi-Purpose Screws (Gold)

S/C	SIZE	PCS/BOX
50377	8x1-1/4	7500
50378	8x1-3/4	4500
09336	8x2	3500
09337	9x2-1/4	3000
09338	9x2-1/2	2500
09339	9x3	2000
09340	10x3-1/2	1500
09341	10x4	1000
50375	12x5	1400
50376	12x6	1100



The Complete Saberdrive Program In 1 lb, 3 lb, 5 lb & 1/4 Keg Boxes

Small Project Needs

Program Features:

- Now available in carded blisters & value packs
- Star Drive reduces Cam-out
- Unique serrated thread for secure fastening
- Type 17-point eliminates the need for pre-drilling and reduces wood splitting
- Available in both interior & exterior use screws
- Convenient package quantities for any project
- Consumer recognized brand name
- Screws are case hardened

Saberdrive in Value Packs (Driver Bit Included)



SABERDRIVE in Carded Blisters

Interior Multi-Purpose Screws



S/C	SIZE	PRICE CODE
24094	6x1/2	D
24095	6x3/4	D
24096	6x1	D
24097	6x1-1/4	D
24098	6x1-1/2	D
24099	8x1	D
24100	8x1-1/4	D
24101	8x1-1/2	D
24102	8x1-3/4	D
24103	8x2	D
24104	9x1-1/2	D
24105	9x2	D
24106	9x2-1/4	D
24107	9x2-1/2	D
24108	9x3	D
24109	12x1-3/4	D
24110	12x2	D
24111	12x2-1/4	D
24112	12x2-1/2	D
24113	12x3	D

Star Drive Bits



S/C	SIZE	PRICE CODE
24410	T-10	D
24090	T-15	D
24091	T-20	D
24092	T-25	D
24359	T-30	D
24411	T-40	D

Interior Multi-Purpose Screws



S/C	SIZE	PRICE CODE
11849	6x1/2	P
11850	6x3/4	P
11851	6x1	P
11852	6x1-1/4	P
11853	8x1	P
11854	8x1-1/4	P
11855	8x1-1/2	P
11856	8x1-3/4	P
11857	9x2	P
11858	9x2-1/4	P
11859	9x2-1/2	P
11860	9x3	P
11861	12x2	P
11862	12x2-1/2	P
11863	12x3	P
11864	12x3-1/2	P

Stainless Steel Multi-Purpose Screws



S/C	SIZE	PRICE CODE
11996	9x1-1/4	S
11997	9x1-1/2	S
11865	9x1-3/4	S
11866	9x2	S
11867	9x2-1/2	S
11868	10x3	S
11998	10x3-1/2	S

Green Exterior Deck Screws



S/C	SIZE	PRICE CODE
11869	9x1-1/4	R
11870	9x1-1/2	R
11871	9x1-3/4	R
11872	9x2	R
11873	9x2-1/4	R
11874	9x2-1/2	R
11875	9x3	R
11876	10x3-1/2	R
11877	12x2	R
11878	12x2-1/2	R
11879	12x3	R
11880	12x3-1/2	R

Tan Exterior Deck Screws



S/C	SIZE	PRICE CODE
12102	9x1-1/4	R
12103	9x1-1/2	R
12104	9x1-3/4	R
12105	9x2	R
12106	9x2-1/4	R
12107	9x2-1/2	R
12108	9x3	R
12109	10x3-1/2	R
12110	12x2	R
12111	12x2-1/2	R
12112	12x3	R
12113	12x3-1/2	R

Gold Interior Trim Screws



S/C	SIZE	PRICE CODE
12114	8x1-5/8	P
12115	8x2	P
12116	8x2-1/2	P
12117	8x3	P

Green Exterior Trim Screws



S/C	SIZE	PRICE CODE
12118	8x1-5/8	P
12119	8x2	P
12120	8x2-1/2	P
12121	8x3	P

Stainless Trim Screws



S/C	SIZE	PRICE CODE
12122	8x1-5/8	P
12123	8x2	P
12124	9x2-1/2	P
12125	9x3	P

White Composite Trim Screws



S/C	SIZE	PRICE CODE
12128	8x1-5/8	P
12129	8x2	P
12130	8x2-1/2	P
12131	8x3	P

White Trim Screws



S/C	SIZE	PRICE CODE
12132	8x1-5/8	P
12133	8x2	P
12134	8x2-1/2	P
12135	8x3	P

Cabinet Screws



S/C	SIZE	PRICE CODE
12126	9x1-3/4	P
12127	9x2-1/2	P

Indoor construction

Use for fences, decks, sheds & other outdoor projects

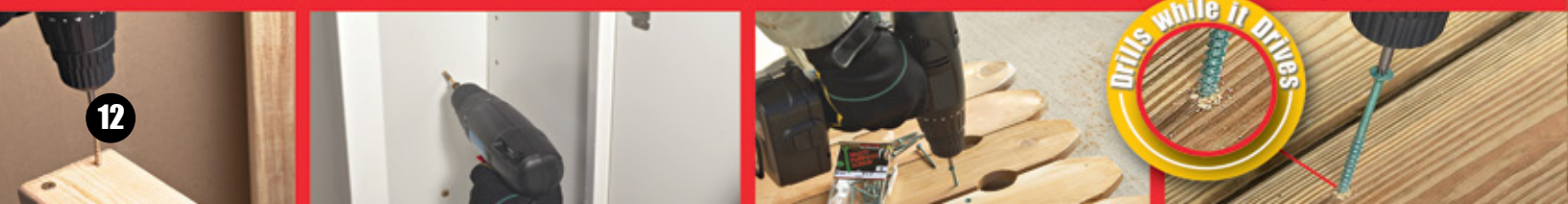

Saberdrive Preset Displays



SABERDRIVE Preset Tub Displays

S/C	Description
17741	1 lb. Pan Tan Deck Display
17779	1 lb. White Cabinet Tub Display
17418	1 lb. & 5 lb. White Composite Deck Screw Display
17450	1 lb. & 5 lb. White Trim Screw Display
17799	1 lb. & 5 lb. Stainless Trim Screw Display
17411	1 lb. & 5 lb. Tan Starter Deck Screw Display
17401	1 lb. & 5 lb. Red Starter Deck Screw Display
17582	1 lb. & 5 lb. Cabinet & Trim Screw Display
17587	1 lb. & 5 lb. Interior Multi-Purpose Screw Display
17583	1 lb. & 5 lb. Stainless Steel Deck Screw Display
17578	1 lb. & 5 lb. Green Deck Screw Display
17412	1 lb. & 5 lb. Tan Deck Screw Display
17402	1 lb. & 5 lb. Red Deck Screw Display
17579	1 lb., 5 lb. & 25 lb Green Deck Screw Display
17404	1 lb., 5 lb. & 25 lb Tan Deck Screw Display
17403	1 lb., 5 lb. & 25 lb. Red Deck Screw Display
17467	1 lb., 5 lb. & 25 lb. Stainless Deck Screw Display
17735	10 lb. Tan Deck Display
17787	10 lb. Interior Multi-Purpose Screw Display
17469	1 lb. Pocket Cabinet Starter Display
17580	1 lb. & 5 lb. Complete Tub Display
17581	1 lb., 5 lb. & 25 lb. Complete Tub Display Green
17468	1 lb., 5 lb. & 25 lb. Complete Tub Display Tan
17798	1 lb., 5 lb. & 25 lb. Saberdrive 10x3 Deck Screw Addition Display



SABERDRIVE Mobile Cart Displays

S/C	Description
17536	1 lb. & 5 lb. Green Classic Display
17538	1 lb. & 5 lb. Green Standard Display
17435	1 lb. & 5 lb. Tan Standard Display

SABERDRIVE Hanging Displays

S/C	Description
17546	VR Interior/VR Exterior Display
17547	CR Interior/VR Interior
17548	CR Interior/VR Exterior Display
17446	Tan VR Display
17447	Tan VR Display (no rack)
17545	Complete CR/VR Display (no rack)
17488	Exterior VR Counter Display
17489	Exterior VR Counter Display (no rack)

Bits Displays

S/C	Description
17616	Contractor Bits Display
17745	Contractor Bits Counter Display
17773	Contractor Bit Display #2
17774	Mini-Bowl Bit Starter Display
17775	Mini-Bowl Bit Complete Display



Versatile Merchandising Displays

The Ultimate Construction Screws In The Ultimate Preset Displays

Saberdrive Preset Displays

SABERDRIVE

Bigger Bite.
Better Drive



S/C **Description**
17742 Tan Construction Lag Tub Display (piece count)

S/C **Description**
17744 Tan Timber Screw Tub Display (piece count)
17743 Tan Construction Lag 10lb. Tub Display
17780 Tan Timber 10lb. Tub Display **NEW**
17781 Tan Construction Lag 20lb. Tub Display **NEW**



S/C **Description**
17784 Tan Ledger Board 10lb. Tub Display **NEW**



TAN SABERDRIVE Preset Box Displays



17438 shown

S/C **Description**
17738 1 lb. & 3 lb. Tan Saberdrive Display
17436 1 lb. & 5 lb. Tan Deck Screw Starter Display
17437 1 lb. & 5 lb. Tan Deck Screw Display
17438 1 lb., 5 lb. & 1/4 Keg Tan Deck Screw Complete Display
17684 1 lb. & 5 lb. Red Deck Screw Starter Display
17685 1 lb. & 5 lb. Red Deck Screw Display
17686 1 lb., 5 lb. & 1/4 Keg Red Deck Screw Complete Display
17792 1 lb. & 3 lb. Stainless Deck Display **NEW**
17793 1 lb. & 5 lb. Stainless Deck Display **NEW**
17687 1 lb. & 5 lb. White Composite Trim Display
17688 1 lb. Stainless Trim Display
17470 Floor Board Screws Display
17797 Saberdrive Box 10x3 Deck Screw Addition Preset Display **NEW**
17800 1 lb. & 5 lb. Cabinet Trim Display **NEW**
17778 1 lb. White Cabinet Display **NEW**
17796 1 lb. & 5 lb. Saberdrive Cement & Backer Board Screw Display **NEW**



SABERDRIVE Assortment Display

S/C **Description**
17620 MR Saberdrive Assortment Display

Indoor construction

Use for fences, decks, sheds & other outdoor projects



Saberdrive Preset Displays



SABERDRIVE Construction Lag Displays



- | S/C | Description |
|-------|--------------------------------|
| 17471 | Green Construction Lag Display |
| 17679 | Tan Construction Lag Display |



- | S/C | Description |
|-------|---------------------------------------|
| 17472 | Green Construction Lag 10 lb. Display |
| 17680 | Tan Construction Lag 10 lb. Display |

SABERDRIVE Timber Large Dia. Hex Box Displays



- | S/C | Description |
|-------|---------------------------|
| 17473 | Green Timber Box Display |
| 17681 | Tan Timber Box Display |
| 17786 | Tan Timber 10lb. Display |
| 17682 | Tan Ledger Screw Display |
| 17683 | Tan Ledger 10 lb. Display |

SABERDRIVE Complete Construction Lag Timber Display



- | S/C | Description |
|-------|--|
| 17474 | Complete Construction Lag & Timber Display |

SABERDRIVE Merchandising aids



- | S/C | Description |
|-------|--------------------------------|
| 17759 | Saberdrive Screw Display Board |



- | S/C | Description |
|-------|------------------------------------|
| 17761 | 12" x 17.75" Saberdrive Counterpad |



Shirt & hat shipped with every preset display ordered!

Versatile Merchandising Displays

The Ultimate Construction Screws In The Ultimate Preset Displays