

## TUB SPOUTS

**B = BULK**  
**C = CARDED**  
**P = POLY BAG**

| ITEM NO. | PACK | DESCRIPTION | CTN. QTY. |
|----------|------|-------------|-----------|
|----------|------|-------------|-----------|

### REGULAR TUB FILLERS 1/2" IPS THREAD ZAMAK TYPE "A"

|          |   |   |     |
|----------|---|---|-----|
| 08-1070  | B | Chrome tub spout  | 100 |
| 08-1070P | P | Same as above poly bag  | 12  |
| 08-1071  | C | Same as above carded  | 6   |
| 08-1075  | C | Antique bronze tub spout  | 6   |
| 08-1077  | C | Polished brass tub spout  | 6   |
| 08-1079  | C | White tub spout   | 6   |
| 08-1081  | C | Satin Nickel tub spout  | 6   |
| 08-1002  | B | Chrome Extra Long tub spout • 1 Piece for IPS or copper • 4 in 1 Style • 7" | 25  |
| 08-1003  | C | Chrome Extra Long tub spout • 1 Piece                                       | 6   |



08-1070  
08-1070P  
08-1071  
08-1075  
08-1077  
08-1079  
08-1081

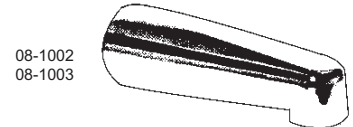

08-1002  
08-1003

### REGULAR TUB FILLERS 1/2" IPS THREAD BRASS TYPE "B"

|         |   |                      |    |
|---------|---|----------------------|----|
| 08-1072 | B | Chrome tub spout     | 50 |
| 08-1073 | C | Same as above carded | 6  |

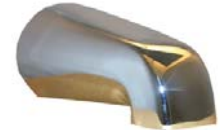

08-1072  
08-1073

### DIVERTER TUB FILLERS 1/2" IPS THREAD ZAMAK TYPE "A" FRONT LIFT

|          |   |   |    |
|----------|---|---|----|
| 08-1036  | B | Chrome tub spout  | 50 |
| 08-1036P | P | Same as above poly bag  | 12 |
| 08-1037  | C | Same as above carded  | 6  |
| 08-1039  | C | Antique bronze tub spout  | 6  |
| 08-1041  | C | Polished brass tub spout  | 6  |
| 08-1043  | C | White tub spout   | 6  |
| 08-1045  | C | Satin Nickel tub spout  | 6  |
| 08-1004  | B | Chrome Extra Long tub spout • 1 Piece for IPS or copper • 4 in 1 Style • 7" | 1  |
| 08-1005  | C | Same as above carded  | 6  |



08-1036  
08-1036P  
08-1037  
08-1039  
08-1041  
08-1043  
08-1045



08-1004  
08-1005

### DIVERTER TUB FILLERS 1/2" or 3/4" THREAD ZAMAK TYPE "B" REAR LIFT

|          |   |                          |    |
|----------|---|--------------------------|----|
| 8-1050   | B | Chrome tub spout         | 50 |
| 08-1050P | P | Same as above poly bag   | 12 |
| 08-1051  | C | Same as above carded     | 6  |
| 08-1053  | C | Antique bronze tub spout | 6  |

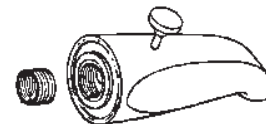

08-1050  
08-1050P  
08-1051  
08-1053  
08-1055

### TUB SPOUT BEAUTY RING

|         |   |  |   |
|---------|---|--|---|
| 03-6011 | C | 3-1/2" Chrome trim ring                              | 6 |
| 03-6013 | C | 3-1/2" Polished brass trim ring                      | 6 |
| 03-6014 | B | 3-1/2" Satin Nickel trim ring                        | 6 |
| 03-6015 | C | 3-1/2" Satin Nickel trim ring                        | 6 |
| 03-6021 | C | 2-1/8" Chrome trim ring • 7/8 ID also for shower arm | 6 |
| 03-6023 | C | 2-1/8" Polished brass trim ring                      | 6 |
| 03-6025 | C | 2-1/8" Satin Nickel trim ring                        | 6 |

03-6011  
03-6013  
03-6014  
03-6015  
03-6021  
03-6023  
03-6025



B = BULK  
C = CARDED  
P = POLY BAG

TUB SPOUTS CONTINUED

| ITEM NO. | PACK | DESCRIPTION | CTN. QTY. |
|----------|------|-------------|-----------|
|----------|------|-------------|-----------|

**DIVERter Tub Fillers**

**BRASS TYPE "B" REAR LIFT**

|         |   |                                    |    |
|---------|---|------------------------------------|----|
| 08-1020 | B | Chrome 1/2" tub spout              | 12 |
| 08-1021 | C | Same as above carded               | 6  |
| 08-1022 | B | Chrome 3/4" tub spout              | 12 |
| 08-1023 | C | Same as above carded               | 6  |
| 82198   | B | Chrome 9" long tub spout • 1 Piece | 6  |



*Simpatico*



**SLIP-FIT Tub Fillers ZAMAK TYPE "C"**

Fits over 5/8 O.D. (1/2 Nominal) Copper Tube

|           |   |                          |   |
|-----------|---|--------------------------|---|
| 08-1011   | C | Chrome tub spout         | 6 |
| 08-1011AB | C | Antique bronze tub spout | 6 |
| 08-1011PB | C | Polished brass tub spout | 6 |



**SLIP-FIT DIVERter Tub Fillers ZAMAK TYPE "C"**

Fits over 5/8 O.D. (1/2 Nominal) Copper Tube FRONT LIFT

|                |          |  |           |
|----------------|----------|--|-----------|
| 08-1012        | B        | Chrome tub spout                         | 50        |
| 08-1012P       | P        | Same as above poly bag                   | 12        |
| 08-1013        | C        | Same as above carded                     | 6         |
| 08-1015        | C        | Antique bronze tub spout                 | 6         |
| 08-1017        | C        | Polished brass tub spout                 | 6         |
| 08-1019        | C        | White tub spout                          | 6         |
| 08-1025        | C        | Satin Nickel tub spout                   | 6         |
| 08-1008        | B        | CP Genuine Mixet tub spout               | 12        |
| <b>08-1006</b> | <b>B</b> | <b>Genuine Delta pull down • RP17453</b> | <b>12</b> |

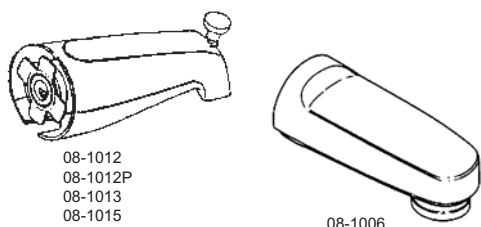

*Simpatico*



**SLIP-FIT Tub Fillers ZAMAK TYPE "C"**

Fits over 5/8 O.D. (1/2 Nominal) Copper Tube

|        |   |           |   |
|--------|---|-----------|---|
| 81291* | C | Tub spout | 6 |
|--------|---|-----------|---|

**SLIP-FIT DIVERter Tub Fillers ZAMAK TYPE "C"**

Fits over 5/8 O.D. (1/2 Nominal) Copper Tube FRONT LIFT

|        |   |           |   |
|--------|---|-----------|---|
| 82291* | C | Tub spout | 6 |
|--------|---|-----------|---|



**DIVERter Tub Fillers • 4 in 1 FIT-ALL • FRONT LIFT**

Front Thread • Rear Thread Adjustable 1" • Slip Fit

|         |   |   |     |
|---------|---|---|-----|
| 08-1056 | B | Chrome tub spout  | 100 |
| 08-1057 | C | Same as above carded  | 6   |
| 08-1047 | C | ORB Lift tub spout  | 100 |
| 08-1059 | C | Same as above carded  | 6   |
| 08-1065 | C | SN Tub spout  | 6   |
| 08-1061 | C | 4 in 1 Adapter only • Use with Front Thread Spouts • Includes assembly tool | 6   |

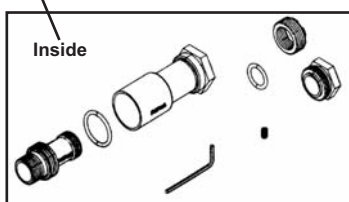
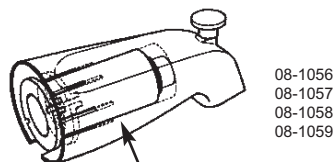

**\* ADD SUFFIX FOR FINISH**

**A** = Antique Bronze **C** = Chrome **P** = Polished Brass **W** = White  
**OB** = Oil Rubbed Bronze **SN** = Satin Nickel

TUB SPOUTS CONTINUED

B = BULK  
C = CARDED

| ITEM NO.                | PACK | DESCRIPTION            | CTN. QTY. |
|-------------------------|------|------------------------|-----------|
| <i>Simpatico</i>        |      |                        |           |
| <b>ROMAN TUB SPOUTS</b> |      |                        |           |
| 81150*                  | B    | Deck mount 7-1/2" long | 1         |
| 81180*                  | B    | Wall mount 6-1/4" long | 1         |
| 81160*                  | B    | Deck mount "C" spout   | 1         |
| 81170*                  | B    | Wall mount "C" spout   | 1         |

\* ADD SUFFIX FOR FINISH  
C = Chrome P = Polished Brass

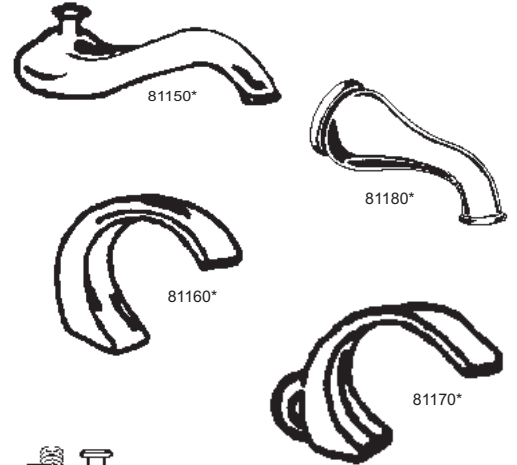

**SPECIALTY TUB SPOUTS**

|         |   |   |    |
|---------|---|---|----|
| 08-2001 | C | Chrome diverter with outlet for personal shower   | 6  |
| 08-1090 | B | Chrome Div. with 3/8" outlet for ADD-A-Shower     | 12 |
| 08-1091 | C | Same as above carded                              | 6  |
| 08-5720 | B | Slip Fit diverter with outlet for personal shower | 6  |



**SPECIALTY TUB SPOUTS WITH OUTLET FOR PERSONAL SHOWER**

|        |   |                             |   |
|--------|---|-----------------------------|---|
| 82193* | C | Slip Fit diverter tub spout | 6 |
| 82194* | B | I.P.S diverter tub spout    | 1 |
| 82195* | C | Same as above carded        | 6 |

\* ADD SUFFIX FOR FINISH  
A = Antique Bronze C = Chrome P = Polished Brass W = White  
SN = Satin Nickel

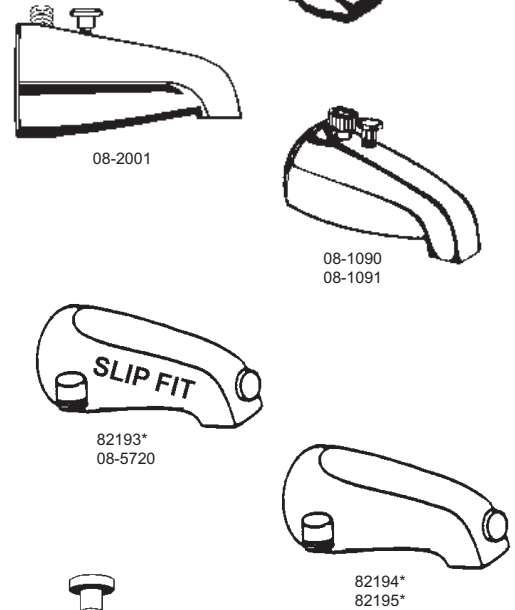

**TUB SPOUT EXTENSIONS**

|         |   |                                       |    |
|---------|---|---------------------------------------|----|
| 08-1130 | B | Chrome 3" tub spout extension         | 25 |
| 08-1131 | C | Same as above carded                  | 6  |
| 08-1132 | B | Polished brass 3" tub spout extension | 25 |
| 08-1133 | C | Same as above carded                  | 6  |
| 08-1140 | B | Chrome 5" tub spout extension         | 25 |
| 08-1141 | C | Same as above carded                  | 6  |
| 08-1142 | B | Polished brass 5" tub spout extension | 25 |
| 08-1143 | C | Same as above carded                  | 6  |
| 08-1049 | C | Diverter replacement lift and gate    | 6  |

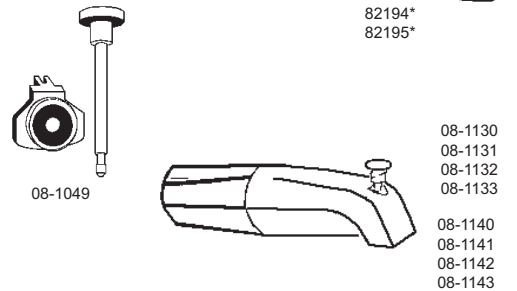

**TYPE A  
NOSE CONNECT**



1/2" - 14 NPT THREAD

FITS STANDARD 1/2" IPS THREAD.

**TYPE B  
WALL CONNECT**

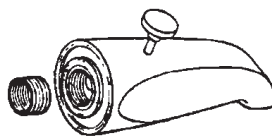

3/4" - 14 NPT THREAD

INCLUDES 3/4" to 1/2" REDUCER BUSHING TO FIT STANDARD 3/4" IPS and 1/2" IPS PIPE.

**TYPE C  
SLIP CONNECT**

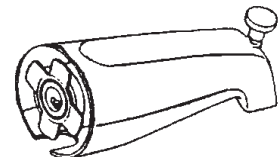

SLIP FIT

SLIDE CONNECTS TO 1/2" COPPER WATER TUBE (CWT) 5/8" OUTSIDE DIAMETER.



## SPECIALTY ITEMS

**B = BULK**  
**C = CARDED**

| ITEM NO. | PACK | DESCRIPTION | CTN. QTY. |
|----------|------|-------------|-----------|
|----------|------|-------------|-----------|

### SHOWER ARMS "LASCO"

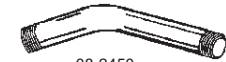

08-2450  
08-2450P  
08-2452  
08-2454  
08-2449  
08-2458  
08-2466

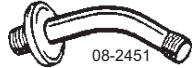

08-2451  
08-2453  
08-2459  
08-2467  
08-5515  
08-5517



08-2470  
08-2455

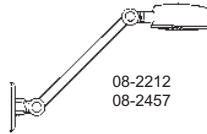

08-2212  
08-2457

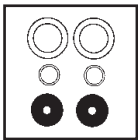

08-2470-K

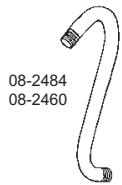

08-2484  
08-2460



08-2485  
08-2461

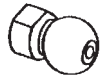

08-2464  
08-2465



08-2462  
08-2463

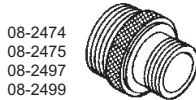

08-2474  
08-2475  
08-2497  
08-2499

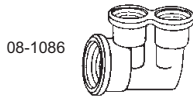

08-1086

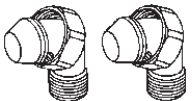

08-1088  
08-1089

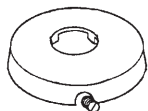

03-1521

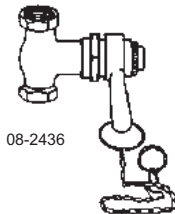

08-2436

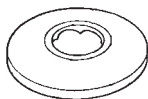

03-1519

|           |   |   |     |
|-----------|---|---|-----|
| 08-2450   | B | Chrome 6" shower arm  | 100 |
| 08-2450P  | P | Same as above poly bag with flange  | 24  |
| 08-2451   | C | Same as above carded with flange  | 6   |
| 08-2452   | B | Chrome 8" shower arm  | 100 |
| 08-2453   | C | Same as above carded with flange  | 6   |
| 08-2454   | B | Chrome 10" shower arm   | 100 |
| 08-2449   | C | Same as above carded with flange  | 6   |
| 08-2458   | B | Polished brass 6" shower arm  | 24  |
| 08-2459   | C | Same as above carded with flange  | 6   |
| 08-2466   | B | Antique bronze 6" shower arm  | 24  |
| 08-2467   | C | Same as above carded  | 6   |
| 08-5515   | C | White 6" shower arm with flange   | 6   |
| 08-5517   | C | Satin Nickel 6" shower arm with flange  | 6   |
|           |   |   |     |
| 08-2470   | B | Chrome all directional shower arm   | 12  |
| 08-2455   | C | Same as above carded  | 6   |
| 08-5523   | C | Polished Brass all directional shower arm   | 6   |
| 08-2212   | B | Chrome all directional shower head  | 12  |
| 08-2457   | C | Same as above carded  | 6   |
|           |   |   |     |
| 08-2470-K | B | Repair kit for all directional shower arm   | 6   |
|           |   |   |     |
| 08-2484   | B | Chrome 8" S - Arm   | 12  |
| 08-2485   | C | Same as above carded with flange  | 6   |
| 08-2460   | B | Chrome 10" S - Arm  | 12  |
| 08-2461   | C | Same as above carded with flange  | 6   |
|           |   |   |     |
| 08-2462   | B | Chrome 6" Ball joint shower arm   | 100 |
| 08-2463   | C | Same as above carded  | 6   |
| 08-2464   | B | Chrome shower arm ball only   | 100 |
| 08-2465   | C | Same as above carded  | 6   |
| 08-2474   | B | Price Pfister ball joint arm adapter adapts old ball joint nut to new shower head | 100 |
| 08-2475   | C | Same as above carded  | 6   |
| 08-2497   | C | American Standard ball joint arm adapter  | 6   |
| 08-2499   | C | Gerber ball joint arm adapter   | 6   |

### ACCESSORIES

|         |   |   |    |
|---------|---|---|----|
| 08-1086 | B | Twin ell tub spout connector              | 12 |
| 08-1088 | B | 3/4" FIP x 1/2" MIP Bathcock ell (1-Pair) | 12 |
| 08-1089 | C | Same as above carded                      | 6  |
|         |   |   |    |
| 08-2436 | B | Chrome self-closing shower valve          | 1  |
| 03-1521 | C | Chrome 1/2" flange with set screw         | 6  |
| 03-1519 | C | Chrome 1/2" sure grip                     | 6  |



SHOWER ARMS CONTINUED

C = CARDED

| ITEM NO. | PACK | DESCRIPTION | CTN. QTY. |
|----------|------|-------------|-----------|
|----------|------|-------------|-----------|



SHOWER ARM WITH FLANGE

|          |   |                   |   |
|----------|---|-------------------|---|
| 82451C   | C | 6" Chrome         | 6 |
| 82451A   | C | 6" Antique bronze | 6 |
| 82451AL  | C | 6" Almond         | 6 |
| 82451P   | C | 6" Polished brass | 6 |
| 82451W   | C | 6" White          | 6 |
| 82451PDV | C | 6" PDV            | 6 |
| 82451SN  | C | 6" Satin nickel   | 6 |
| 82451OB  | C | 6" Oil Rub bronze | 6 |



82451C  
82451A  
82451AL  
82451P  
82451W  
82451PDV  
82451SN  
82451OB

|         |   |                   |   |
|---------|---|-------------------|---|
| 82453C  | C | 8" Chrome         | 6 |
| 82453A  | C | 8" Antique bronze | 6 |
| 82453AL | C | 8" Almond         | 6 |
| 82453P  | C | 8" Polished brass | 6 |
| 82453W  | C | 8" White          | 6 |
| 82453SN | C | 8" Satin nickel   | 6 |
| 82453OB | C | 8" Oil Rub bronze | 6 |

82453C  
82453A  
82453AL  
82453P  
82453W  
82453SN  
82453OB



|         |   |                          |   |
|---------|---|--------------------------|---|
| 82463C  | C | 10" Chrome S-Arm         | 6 |
| 82463A  | C | 10" Antique bronze S-Arm | 6 |
| 82463P  | C | 10" Polished brass S-Arm | 6 |
| 82463W  | C | 10" White S-Arm          | 6 |
| 82463SN | C | 10" Satin nickel S-Arm   | 6 |
| 82463OB | C | 10" Oil Rub bronze S-Arm | 6 |

82463C  
82463A  
82463P  
82463W  
82463SN  
82463OB



|         |   |                                  |   |
|---------|---|----------------------------------|---|
| 82464C  | B | 12" Chrome Right Angle-Arm       | 1 |
| 82464SN | B | 12" Satin nickel Right Angle-Arm | 1 |

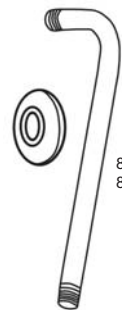

82464C  
82464SN



ALL - DIRECTIONAL SHOWER ARM

|         |   |                |   |
|---------|---|----------------|---|
| 82221C  | C | Chrome         | 6 |
| 82221A  | C | Antique bronze | 6 |
| 82221P  | C | Polished brass | 6 |
| 82221W  | C | White          | 6 |
| 82221SN | C | Satin nickel   | 6 |
| 82221OB | C | Oil Rub bronze | 6 |



82221C  
82221A  
82221P  
82221W  
82221SN  
82221OB



ALL - DIRECTIONAL SHOWER HEAD

|         |   |                |   |
|---------|---|----------------|---|
| 82211C  | C | Chrome         | 6 |
| 82211A  | C | Antique bronze | 6 |
| 82211P  | C | Polished brass | 6 |
| 82211W  | C | White          | 6 |
| 82211SN | C | Satin nickel   | 6 |
| 82211OB | C | Oil Rub bronze | 6 |

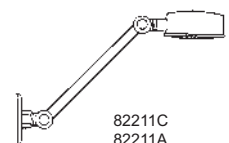

82211C  
82211A  
82211P  
82211W  
82211SN  
82211OB



## SHOWERS HEADS

**B = BULK**  
**C = CARDED**  
**P = POLY BAG**

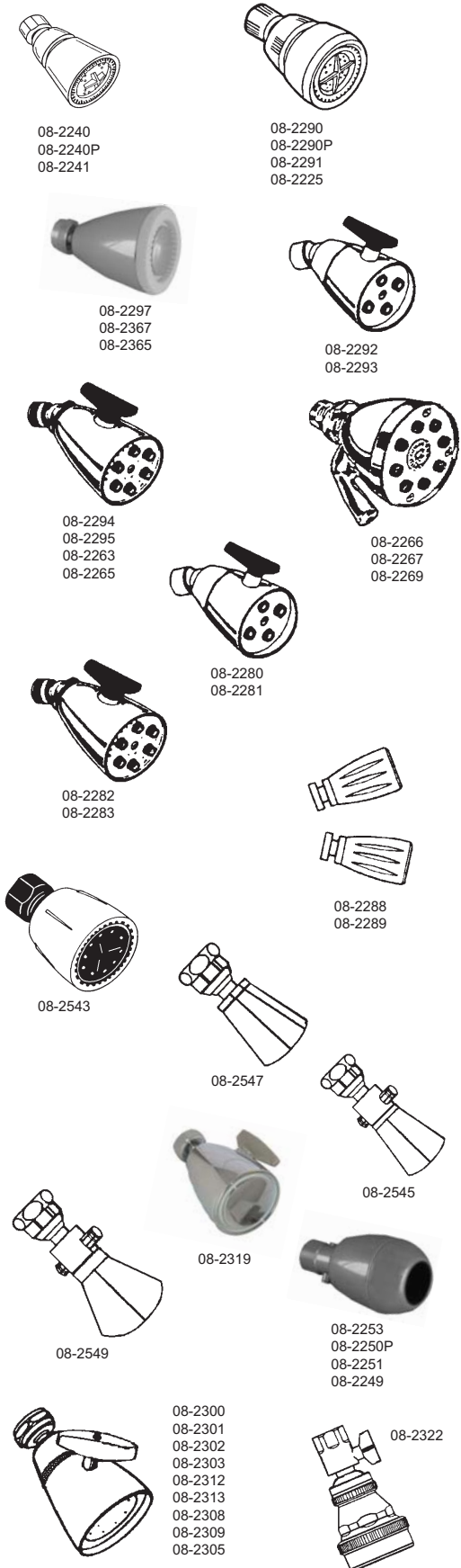

| ITEM NO. | PACK | DESCRIPTION  | CTN. QTY. |
|----------|------|--|-----------|
| 08-2240  | B    | White plastic adjustable water saver   | 100       |
| 08-2240P | P    | Same as above poly bag   | 24        |
| 08-2241  | C    | Same as above carded   | 6         |
| 08-2290  | B    | Chrome adjustable water saver  | 100       |
| 08-2290P | P    | Same as above poly bag   | 24        |
| 08-2291  | C    | Same as above carded   | 6         |
| 08-2297  | C    | Chrome universal   | 6         |
| 08-2367  | C    | Antique bronze universal   | 6         |
| 08-2365  | C    | Polished brass universal   | 6         |
| 08-2369  | C    | Satin nickel universal   | 6         |
| 08-2371  | C    | Price Pfister replacement half head  | 6         |
| 08-2222  | B    | 3/8" IPS Plastic   | 100       |
| 08-2225  | C    | Same as above carded   | 6         |
| 08-2292  | B    | Chrome 4 plunger zinc  | 50        |
| 08-2293  | C    | Same as above carded   | 6         |
| 08-2294  | B    | Chrome 6 plunger zinc  | 50        |
| 08-2295  | C    | Same as above carded   | 6         |
| 08-2263  | C    | Chrome 6 plunger brass   | 6         |
| 08-2265  | C    | Polished brass 6 plunger brass   | 6         |
| 08-2266  | B    | Chrome 8 plunger brass   | 1         |
| 08-2267  | C    | Same as above carded   | 6         |
| 08-2269  | C    | PDV 8 Plunger brass  | 1         |
| 08-2280  | B    | Chrome Speakman #3 4 plunger   | 12        |
| 08-2281  | C    | Same as above carded   | 6         |
| 08-2282  | B    | Chrome Speakman #2 6 plunger   | 12        |
| 08-2283  | C    | Same as above carded   | 6         |
| 08-2288  | B    | Replacement plunger for speakman   | 24        |
| 08-2289  | C    | Same as above carded (2 per card)  | 6         |
| 08-2543  | C    | Plastic water saver  | 6         |
| 08-2547  | C    | Brass water saver  | 6         |
| 08-2545  | C    | Brass water saver with shut off  | 6         |
| 08-2549  | C    | Brass water saver Deluxe with shut off                                       | 6         |
| 08-2250P | P    | Super Jet • White  | 24        |
| 08-2251  | C    | Super Jet • White  | 6         |
| 08-2248P | P    | Super Jet • Chrome   | 24        |
| 08-2249  | C    | Super Jet • Chrome   | 6         |
| 08-2253  | C    | Super Jet • Chrome plated with push button to switch from 1.6 gpm to 2.6 gpm | 24        |
| 08-2300  | B    | Chrome small brass adjustable  | 50        |
| 08-2301  | C    | Same as above carded   | 6         |
| 08-2302  | B    | Chrome medium brass adjustable   | 50        |
| 08-2303  | C    | Same as above carded   | 6         |
| 08-2312  | B    | Antique bronze medium adjustable   | 50        |
| 08-2313  | C    | Same as above carded   | 6         |
| 08-2308  | B    | PVD medium adjustable  | 50        |
| 08-2309  | C    | Same as above carded   | 6         |
| 08-2305  | C    | Satin Nickel shower head   | 6         |
| 08-2319  | C    | Chrome plated adjustable shower head   | 6         |
| 08-2322  | B    | Sloan AC-11  | 1         |



SHOWERS HEADS  
CONTINUED

B = BULK  
C = CARDED

| ITEM NO. | PACK | DESCRIPTION                          | CTN. QTY. |
|----------|------|--------------------------------------|-----------|
| 08-2377  | C    | White/Grey massage action            | 6         |
| 08-2387  | C    | Chrome massage action                | 6         |
| 08-2375  | C    | Antique bronze massage action        | 6         |
| 08-2373  | C    | Polished brass massage action        | 6         |
| 08-2299  | C    | Chrome head, arm and flange          | 6         |
| 08-2356  | B    | 15-040 Price Pfister                 | 1         |
| 08-2358  | B    | 15-040N Price Pfister antique bronze | 1         |
| 08-2380  | B    | 1533 Moen                            | 1         |
| 08-2382  | B    | 3905 Moen                            | 1         |
| 08-2384  | B    | 2166 Moen                            | 1         |

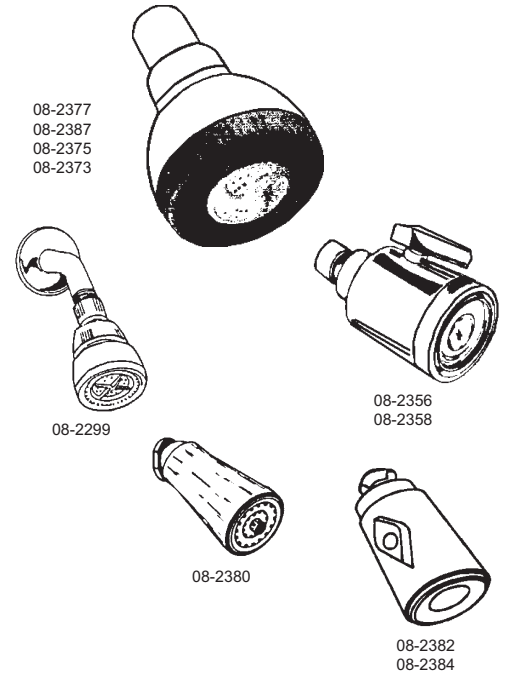

*Simpatico*

|          |   |  |   |
|----------|---|--|---|
| 82282A   | B | Antique bronze #2 Speakman Genuine         | 1 |
| 82282P   | B | Polished brass #2 Speakman Genuine         | 1 |
| 82282W   | B | White #2 Speakman Genuine                  | 1 |
| 82311C   | C | Chrome brass head, arm and flange          | 6 |
| 82311A   | C | Antique bronze brass head, arm and flange  | 6 |
| 82311P   | C | Polished brass, brass head, arm and flange | 6 |
| 82313C   | C | Chrome small Euro Style                    | 6 |
| 82313A   | C | Antique bronze small Euro Style            | 6 |
| 82313P   | C | Polished brass small Euro Style            | 6 |
| 82313W   | C | White small Euro Style                     | 6 |
| 82331C   | C | Chrome medium Euro Style                   | 6 |
| 82331A   | C | Antique bronze medium Euro Style           | 6 |
| 82331P   | C | Polished brass medium Euro Style           | 6 |
| 82331W   | C | White medium Euro Style                    | 6 |
| 82315PDV | C | PDV medium Euro Style                      | 6 |
| 82361C   | C | Chrome 3-function massage action           | 6 |
| 82361CG  | C | Chrome/Gold 3-function massage action      | 6 |
| 82361W   | C | White 3-function massage action            | 6 |
| 82545C   | C | Chrome brass with shut off                 | 6 |
| 82545A   | C | Antique bronze brass with shut off         | 6 |
| 82545P   | C | Polished brass, brass with shut off        | 6 |
| 82545W   | C | White brass with shut off                  | 6 |

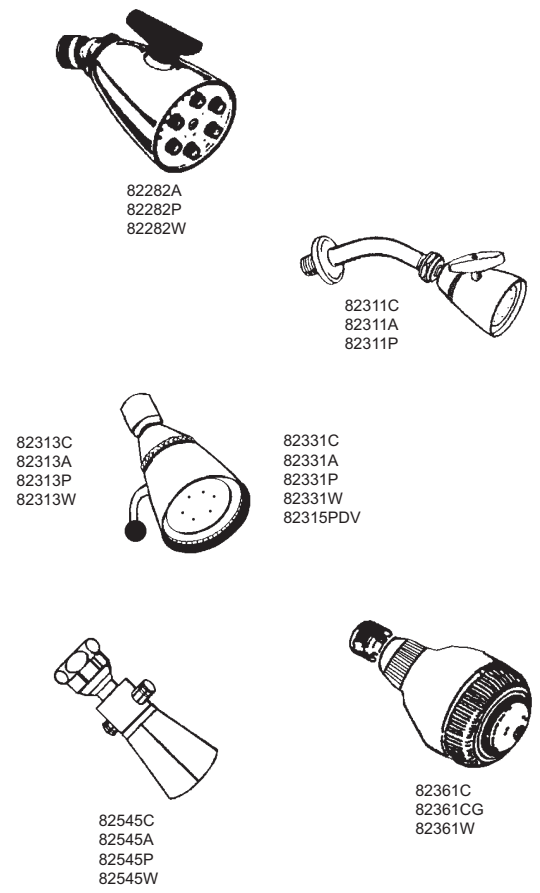

**B = BULK**  
**C = CARDED**  
**P = POLY BAG**

**SHOWER ACCESSORIES**

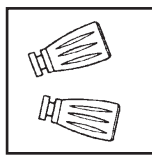
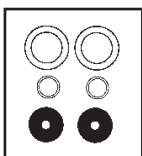
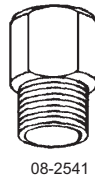
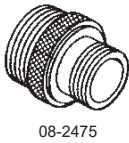
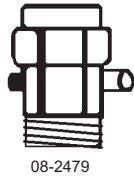
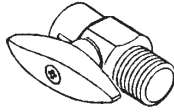
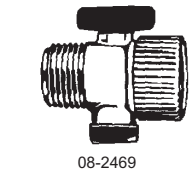

| ITEM NO.  | PACK | DESCRIPTION                               | CTN. QTY. |
|-----------|------|---|-----------|
| 08-2469   | C    | Chrome plastic flow adjuster              | 6         |
| 08-2471   | C    | Chrome brass flow adjuster                | 6         |
| 08-2471P  | C    | Polished brass flow adjuster              | 6         |
| 08-2471W  | C    | White brass flow adjuster                 | 6         |
| 08-2479   | C    | Chrome brass soaper/shut-off              | 6         |
| 08-2475   | C    | Chrome Price Pfister ball joint adapter   | 6         |
| 08-2472   | B    | Shower head sealing washer                | 10        |
| 08-2473   | C    | Same as above carded                      | 6         |
| 08-2476   | B    | Brass shower head restrictor              | 100       |
| 08-2477   | C    | Same as above carded                      | 6         |
| 08-2480   | B    | Rubber shower head restrictor             | 100       |
| 08-2480P  | P    | Same as above poly bag                    | 12        |
| 08-2481   | C    | Same as above carded                      | 6         |
| 08-2482   | B    | Plastic thread on restrictor              | 100       |
| 08-2483   | C    | Same as above carded (2 per card)         | 6         |
| 08-2541   | C    | Water saver shower arm adapter            | 6         |
| 08-2542   | B    | Washer for water saver ball joint         | 100       |
| 08-2551   | C    | Same as above carded                      | 6         |
| 02-2080   | B    | Import ball joint washer                  | 100       |
| 02-2081   | C    | Same as above carded                      | 6         |
| 02-2082   | B    | Small ball joint washer W-44S             | 100       |
| 02-2083   | C    | Same as above carded                      | 6         |
| 02-2084   | B    | Medium ball joint washer W-44M            | 100       |
| 02-2085   | C    | Same as above carded                      | 6         |
| 02-2086   | B    | Large ball joint washer W-44L             | 100       |
| 02-2087   | C    | Same as above carded                      | 6         |
| 02-2091   | C    | Price Pfister ball joint washer           | 6         |
| 02-2092   | B    | Speakman ball joint washer                | 100       |
| 02-2093   | C    | Same as above carded                      | 6         |
| 02-2088   | B    | Assorted ball joint washers (100 pcs)     | 100       |
| 08-2289   | C    | Replacement plunger for Speakman (2 pcs)  | 6         |
| 08-2470-K | B    | Repair kit for all directional shower arm | 6         |





# SHOWER ACCESSORIES CONTINUED

**B = BULK  
C = CARDED**

| ITEM NO. | PACK | DESCRIPTION | CTN.<br>QTY. |
|----------|------|-------------|--------------|
|----------|------|-------------|--------------|

## PERSONAL SHOWER ACCESSORIES

|         |   |   |   |
|---------|---|---|---|
| 84501W  | C | White 3-position hand shower bracket      | 6 |
| 84501C  | C | CP 3-position hand shower bracket         | 6 |
| 84513C  | C | Chrome (brass) wall mount pin             | 6 |
| 84513A  | C | Antique bronze wall mount pin             | 6 |
| 84513P  | C | Polished brass wall mount pin             | 6 |
| 84513W  | C | White wall mount pin                      | 6 |
| 84515C  | C | Chrome (brass) swivel connector           | 6 |
| 84515A  | C | Antique bronze swivel connector           | 6 |
| 84515P  | C | Polished brass swivel connector           | 6 |
| 84515W  | C | White swivel connector                    | 6 |
| 84521C  | C | Chrome (brass) shower arm mount           | 6 |
| 84531C  | C | Chrome (brass) lever action - diverter    | 6 |
| 84531A  | C | Antique bronze lever action - diverter    | 6 |
| 84531P  | C | PVD lever action - diverter               | 6 |
| 84531SN | C | Satin Nickle lever action - diverter      | 6 |
| 84541C  | C | Chrome (brass) push - pull diverter       | 6 |
| 84541A  | C | Antique bronze push - pull diverter       | 6 |
| 84541P  | C | Polished brass push - pull diverter       | 6 |
| 84541W  | C | White push - pull diverter                | 6 |
| 84541SN | C | Satin Nickel - push - pull diverter brass | 1 |
| 84571C  | C | Chrome 24 inch glide rail                 | 6 |
| 84571A  | C | Antique bronze 24 inch glide rail         | 6 |
| 84571P  | C | Polished brass 24 inch glide rail         | 6 |



84501W  
84501C

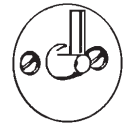

84513C  
thru  
84513W



84515C  
thru  
84515W



84521C

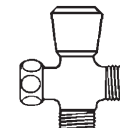

84541C  
thru  
84541W



84531C  
thru  
84531SN



84571C  
thru  
84571P

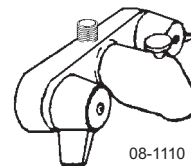

08-1110

|         |   |   |    |
|---------|---|---|----|
| 08-1110 | B | 3-3/8" Center tub filler with personal shower outlet                  | 20 |
| 08-2116 | B | Adapter to attach personal shower hose to Add - A - Shower tub filler | 12 |
| 08-2117 | C | Same as above carded  | 6  |
| 08-2118 | B | Adapter Chrome goose neck bath cock to personal (1/2") MIP shower     | 12 |
| 08-2119 | C | Same as above carded  | 6  |



08-2116  
08-2117



08-2118  
08-2119



**B = BULK  
C = CARDED**

**SHOWER ACCESSORIES  
CONTINUED**

| ITEM NO. | PACK | DESCRIPTION | CTN.<br>QTY. |
|----------|------|-------------|--------------|
|----------|------|-------------|--------------|

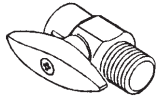

82471C  
82471A  
82471P  
82471W  
82471SN

**VOLUME CONTROL**

|         |   |                               |             |   |
|---------|---|-------------------------------|-------------|---|
| 82471C  | C | Chrome Volume control         | Solid Brass | 6 |
| 82471A  | C | Antique bronze volume control | Solid Brass | 6 |
| 82471P  | C | Polished brass volume control | Solid Brass | 6 |
| 82471W  | C | White volume control          | Solid Brass | 6 |
| 82471SN | C | Satin Nickel control          |             | 1 |



82193C  
82193A  
82193P  
82193W



82295C  
82295P

**TUB SPOUTS**

|         |   |   |  |   |
|---------|---|---|--|---|
| 82193C  | C | Chrome Slip Fit diverter tub spout              |  | 6 |
| 82193A  | C | Antique bronze Slip Fit diverter tub spout      |  | 6 |
| 82193P  | C | Polished brass Slip Fit diverter tub spout      |  | 6 |
| 82193W  | C | White Slip Fit diverter tub spout               |  | 6 |
| 82193SN | C | Satin Nickel Slip Fit diverter with outlet      |  | 1 |
| 82295C  | C | Chrome Slip Fit long diverter tub spout         |  | 6 |
| 82295P  | C | Polished Brass Slip Fit long diverter tub spout |  | 6 |
| 82194C  | B | Chrome I.P.S diverter tub spout                 |  | 1 |
| 82195C  | C | Same as above carded                            |  | 6 |
| 82194A  | B | Antique bronze I.P.S diverter tub spout         |  | 1 |
| 82195A  | C | Same as above carded                            |  | 6 |
| 82194P  | B | Polished brass I.P.S diverter tub spout         |  | 1 |
| 82195P  | C | Same as above carded                            |  | 6 |
| 82194W  | B | White I.P.S diverter tub spout                  |  | 1 |
| 82195W  | C | Same as above carded                            |  | 6 |
| 92195SN | C | Satin Nickel I.P.S. diverter spout with outlet  |  | 1 |
| 82299C  | C | Chrome I.P.S. long diverter tub spout           |  | 6 |
| 82299P  | C | Polished Brass I.P.S. long diverter tub spout   |  | 6 |



82194C  
82195C  
82194A  
82195A  
82194P  
82195P  
82194W  
82195W



82299C  
82299P



**SHOWER ACCESSORIES  
CONTINUED**

| ITEM NO. | PACK | DESCRIPTION | CTN. QTY. |
|----------|------|-------------|-----------|
|----------|------|-------------|-----------|



**PERSONAL SHOWERS**

|         |   |   |    |
|---------|---|---|----|
| 83011W  | C | White hand shower with shut-off<br>59 inch hose • wall mount bracket<br><b>(Note Above Item is on a LASCO CARD)</b> | 6  |
| 83030W  | B | White push button hand held shower only   | 10 |
| 83031W  | C | Same as above carded  | 6  |
| 08-2111 | C | Same as above on Lasco Card   | 6  |
| 83081CG | C | Chrome/Gold massage hand held shower only   | 6  |

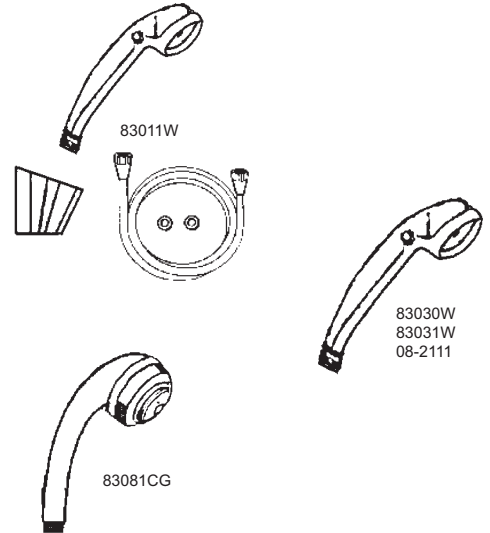

**PERSONAL SHOWERS • BRASS**

|         |   |   |   |
|---------|---|---|---|
| 82263C  | C | Chrome polished 6-plunger brass shower head | 1 |
| 82263P  | C | PVD 6-plunger brass shower head             | 1 |
| 82263SN | C | Satin Nickel 6-plunger brass shower head    | 1 |

**PERSONAL SHOWER HOSES**

|         |   |  |    |
|---------|---|--|----|
| 84059W  | C | 59 Inch White vinyl hose   | 6  |
| 84159C  | C | 59 Inch Stainless steel hose                                     | 6  |
| 84169C  | C | 69 Inch Stainless steel hose                                     | 6  |
| 84259CB | C | 59 Inch Chrome and black vinyl hose                              | 6  |
| 84259CW | C | 59 Inch Chrome and white vinyl hose                              | 6  |
| 84259PB | C | 59 Inch Polished brass and black vinyl hose                      | 6  |
| 84259PW | C | 59 Inch Polished brass and white vinyl hose                      | 6  |
| 84358C  | B | 59 Inch Chrome (brass) double spiral hose                        | 1  |
| 84359C  | C | (Same as above carded)   | 6  |
| 84358P  | B | 59 Inch Polished brass (brass) double spiral hose                | 1  |
| 84359P  | C | (Same as above carded)   | 6  |
| 84368C  | B | Stretchable 59" to 79" Chrome (brass) double spiral hose         | 1  |
| 84369C  | C | same as above carded   | 6  |
| 84368P  | B | Stretchable 59" to 79" Polished brass (brass) double spiral hose | 1  |
| 84369P  | C | (Same as above carded)   | 6  |
| 08-1978 | B | Gasket for Shower Hose   | 12 |
| 08-1979 | C | (Same as above carded) • 2 pcs                                   | 6  |
| 09-6500 | B | Thick Shower Hose Washer   | 12 |
| 09-6501 | C | (Same as above carded)   | 6  |

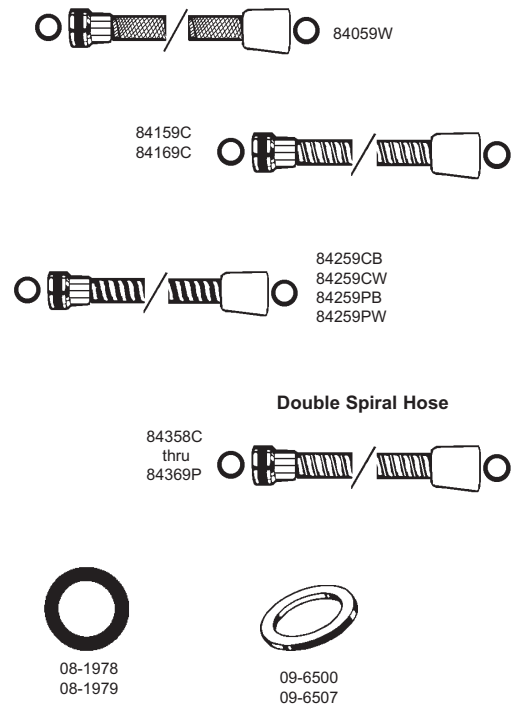

C = CARDED

**PERSONAL SHOWER ACCESSORIES  
(LASCO CARD)**

| ITEM NO. | PACK | DESCRIPTION | CTN. QTY. |
|----------|------|-------------|-----------|
|----------|------|-------------|-----------|

**HOSES**

|         |   |   |   |
|---------|---|---|---|
| 08-2023 | C | 59" Stainless steel hose                            | 6 |
| 08-2025 | C | 69" Stainless steel hose                            | 6 |
| 08-2027 | C | Stretchable 59" to 79" CP Delux double spiral hose  | 6 |
| 08-2029 | C | Stretchable 59" to 79" PB Delux double spiral hose  | 6 |
| 08-2033 | C | Stretchable 59" to 79" SN Delux double spiral hose  | 6 |
| 08-2031 | C | 59" White vinyl hose                                | 6 |
| 08-2035 | C | 59" CP/White voral hose                             | 6 |
| 08-2037 | C | 59" PB/White voral hose                             | 6 |
| 08-2065 | C | Chrome tangle nut <i>(Keeps hoses from kinking)</i> | 6 |

**SHOWER ARM DIVERTERS**

|         |   |                                   |   |
|---------|---|-----------------------------------|---|
| 08-2013 | C | Chrome plastic Dual-Flo diverter  | 6 |
| 08-2021 | C | Chrome Lever action diverter      | 6 |
| 08-2011 | C | Chrome brass Push-Pull diverter   | 6 |
| 08-2017 | C | Polished brass Push-Pull diverter | 6 |

**SHOWER ARM BRACKETS & MOUNTS**

|          |   |                                       |   |
|----------|---|---------------------------------------|---|
| 08-2423  | C | White Hometek shower arm bracket      | 6 |
| 08-2425  | C | Chrome Hometek shower arm bracket     | 6 |
| 08-2409  | C | White Water PIK shower arm bracket    | 6 |
| 08-2411  | C | White 3-Position Hand shower          | 6 |
| 08-2413  | C | CP 3-Position Hand shower             | 6 |
| 08-2415C | C | Chrome Plated Brass Swivel & Post Set | 6 |
| 08-2415P | C | Same as above Polished Brass          | 6 |
| 08-2417  | C | White Plastic Swivel connector only   | 6 |
| 08-2419  | C | CP Brass Swivel connector only        | 6 |
| 08-2419P | C | Same as above Polished Brass          | 6 |
| 08-2421  | C | CP Brass shower arm mount w/pin       | 6 |

**TUB SPOUTS**

|         |   |   |   |
|---------|---|---|---|
| 08-2001 | C | Chrome diverter with outlet for personal shower | 6 |
| 08-5711 | C | Chrome I.P.S. diverter tub spout                | 6 |
| 08-5713 | C | Polished Brass I.P.S. diverter tub spout        | 6 |
| 08-5715 | C | White I.P.S. diverter tub spout                 | 6 |
| 08-5721 | C | Chrome Slip Fit diverter tub spout              | 6 |
| 08-5723 | C | Polished Brass Slip Fit diverter tub spout      | 6 |
| 08-5720 | B | Geniune Mixet Slip Fit diverter                 | 6 |

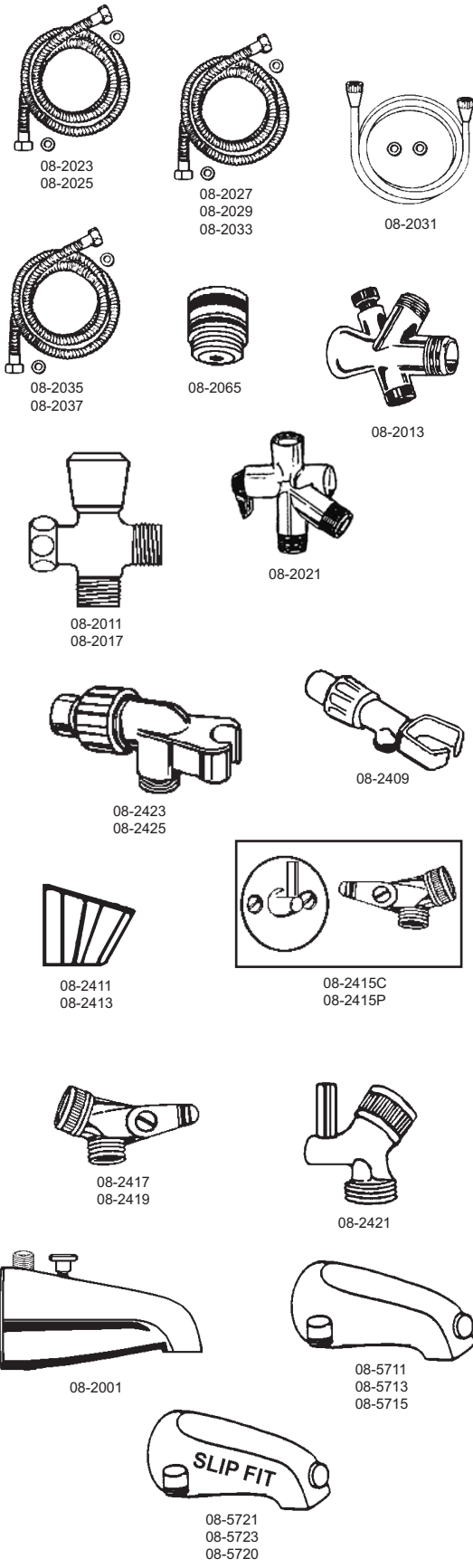



**SHOWERS**

**C = CARDED**

| ITEM NO. | PACK | DESCRIPTION | CTN. QTY. |
|----------|------|-------------|-----------|
|----------|------|-------------|-----------|

**SHOWER HEADS**

|         |   |   |   |
|---------|---|---|---|
| 08-5101 | C | White • Single Function • Rubber Nozzels            | 3 |
| 08-5103 | C | Chrome Plated • Single Function<br>• Rubber Nozzels | 3 |
| 08-5111 | C | White • Three Function • Massage Action             | 3 |
| 08-5113 | C | Chrome Plated • Three Function • Massage Action     | 3 |
| 08-5121 | C | White • Five Function • Massage Action              | 3 |
| 08-5123 | C | Chrome Plated • Five Function • Massage Action      | 3 |
| 08-5125 | C | PVD Brass • Five Function • Massage Action          | 3 |
| 08-5127 | C | Satin Nickel • Five Function • Massage Action       | 3 |
| 08-5131 | C | White • Seven Function • Massage Action             | 3 |
| 08-5133 | C | Chrome Plated • Seven Function • Massage Action     | 3 |



08-5111  
08-5113



08-5121  
thru  
08-5127



08-5131  
08-5133

**HAND HELD**

|         |   |   |   |
|---------|---|---|---|
| 08-5151 | C | White • Single Function • Rubber Nozzels            | 3 |
| 08-5153 | C | Chrome Plated • Single Function<br>• Rubber Nozzels | 3 |
| 08-5161 | C | White • Three Function • Massage Action             | 3 |
| 08-5163 | C | Chrome Plated • Three Function • Massage Action     | 3 |
| 08-5171 | C | White • Five Function • Massage Action              | 3 |
| 08-5173 | C | Chrome Plated • Five Function • Massage Action      | 3 |
| 08-5175 | C | PVD Brass • Five Function • Massage Action          | 3 |
| 08-5177 | C | Satin Nickel • Five Function • Massage Action       | 3 |
| 08-5181 | C | White • Seven Function • Massage Action             | 3 |
| 08-5183 | C | Chrome Plated • Seven Function • Massage Action     | 3 |



08-5151  
08-5153



08-5161  
08-5163



08-5171  
thru  
08-5177



08-5181  
08-5183

**RAIN SHOWER**

|         |   |  |   |
|---------|---|--|---|
| 08-5193 | C | Chrome Plated Rain Shower<br>• with Adjustable Extension Arm | 3 |
| 08-5201 | C | Chrome Plated Rain Shower<br>• 8 Inch • 1 Function           | 3 |
| 08-5195 | C | Chrome Plated Rain Shower<br>• 5 Inch • Adjustable Arm       | 3 |



08-5201



08-5193



08-5195



# SHOWER ACCESSORIES

| ITEM NO. | PACK | DESCRIPTION | CTN. QTY. |
|----------|------|-------------|-----------|
|----------|------|-------------|-----------|

## RAIN SHOWERS (ON ADJUSTABLE ARM)

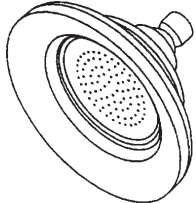
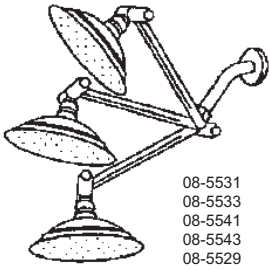

|         |   |   |   |
|---------|---|---|---|
| 08-5531 | C | Chrome Plated 5-1/4 Inch                    | 6 |
| 08-5533 | C | Polished Brass 5-1/4 Inch                   | 6 |
| 08-5541 | C | Chrome Plated 7-3/4 Inch                    | 6 |
| 08-5543 | C | Polished Brass 7-3/4 Inch                   | 6 |
| 08-5551 | C | Rain Shower Chrome 5-1/4" Head Only         | 6 |
| 08-5553 | C | Rain Shower Polished Brass 5-1/4" Head Only | 6 |
| 08-5529 | C | Promo Rain Shower Head and Adjustable Arm   | 6 |

## PORCELAIN SUNSHOWER

|         |   |                                 |   |
|---------|---|---------------------------------|---|
| 08-5574 | B | Porcelain Chrome Shower         | 6 |
| 08-5576 | B | Porcelain Polished Brass Shower | 6 |

## HOMETEK SHOWER HEAD

|         |   |  |   |
|---------|---|--|---|
| 08-5578 | B | CP/with PVD Tips 5" Shower Head  | 6 |
| 08-5580 | B | 5" Swirl Arm Shower Head (Chrome Plated)                               | 1 |
| 08-5590 | B | 8" Pan Shower Head with Arm & Flange (Chrome Plated) • Boxed           | 1 |
| 08-5610 | B | 10" Shower Head with Brass Jets & Arm & Flange (Chrome Plated) • Boxed | 1 |

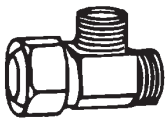

## NEW BIDET SPRAYS

|         |   |   |   |
|---------|---|---|---|
| 08-1491 | C | White Bidet Spray<br>• With Hose & Wall Bracket   | 6 |
| 08-1495 | C | Chrome Bidet Spray<br>• With Hose & Wall Bracket  | 6 |
| 06-9123 | C | 3/8 Comp x 3/8 Comp x 1/2 IPS Add-A-Tee<br>• Use to Add Bidet to 3/8 Comp Angle Stop                      | 6 |
| 06-9121 | C | 1/2 IP x 1/2 IP x 1/2 IP Add-A-Tee<br>• Use to Add Bidet to 1/2 IPS/SJ Angle Stop                         | 6 |
| 08-1497 | C | Handee Shower • Bidet<br>• For Personal Hygiene   | 8 |
| 08-1498 | B | Toilet Seat • Bidet<br>Connects Under Most Seats<br>Use 06-9111 or 06-9119 to Adapt to Your Supply Valves | 1 |





## ALSONS PRODUCTS



C = ALSON PACKAGE

| ITEM NO.            | PACK | DESCRIPTION                                  | CTN. QTY. |
|---------------------|------|--|-----------|
| <b>SHOWER HEADS</b> |      |  |           |
| 08-1804             | C    | 672CPK Chrome full spray promo head          | 10        |
| 08-1806             | C    | 673CPK Chrome adjustable spray head          | 10        |
| 08-1818             | C    | 674CPK Chrome thrift massage head            | 10        |
| 08-1788             | C    | 665CPK Chrome massage action head            | 10        |
| 08-1972             | C    | 690CPK Chrome massage multi spray            | 6         |
| 08-1976             | C    | 6902010PK Polished brass massage multi spray | 6         |

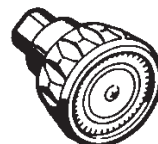

08-1804



08-1806

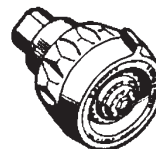

08-1818



08-1788



08-1972  
08-1976

### HAND SHOWER SETS WALL MOUNT STYLE

|         |   |  |   |
|---------|---|--|---|
| 08-1680 | C | 410PBPBK White & Chrome standard push button         | 6 |
| 08-4006 | C | 410ACPK Chrome Euro style adjustable spray           | 6 |
| 08-1682 | C | 410FCPK Chrome Euro style clog-free spray            | 6 |
| 08-4008 | C | 410MACPK Chrome Euro style massage action            | 6 |
| 08-1987 | C | 410MA2010PK Polished brass Euro style massage action | 6 |

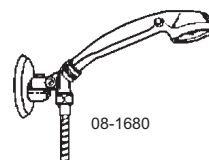

08-1680



08-4006



08-1682



08-4008  
08-1987

### HAND SHOWER SETS ARM MOUNT STYLE

|         |   |   |   |
|---------|---|---|---|
| 08-1652 | C | 44PBPBK White & Chrome standard push button       | 6 |
| 08-1650 | C | 48WCPK White & Chrome massage action              | 6 |
| 08-1648 | C | 48CPK Chrome massage action                       | 6 |
| 08-1654 | C | 45PK White & Chrome Euro style massage action     | 6 |
| 08-1657 | C | 45CPK Chrome Euro style massage action            | 6 |
| 08-4010 | C | 452010PK Polished brass Euro style massage action | 6 |

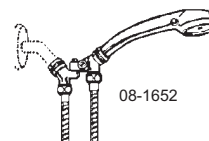

08-1652



08-1650  
08-1648

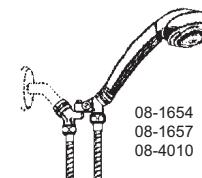

08-1654  
08-1657  
08-4010

### Add - A - Shower

|         |   |   |   |
|---------|---|---|---|
| 08-1684 | C | 410DPBPBK White & Chrome standard push button with shower head diverter | 6 |
| 08-1692 | C | 410SPBPBK White & Chrome standard push button with diverter tub spout   | 6 |

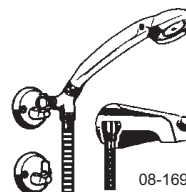

08-1692

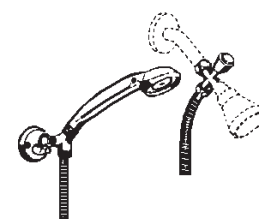

08-1684



# SHOWER ACCESSORIES

C = ALSON PACKAGE  
B = ALSON BOX



## ALSONS PRODUCTS CONTINUED



| ITEM NO. | PACK | DESCRIPTION | CTN.<br>QTY. |
|----------|------|-------------|--------------|
|----------|------|-------------|--------------|

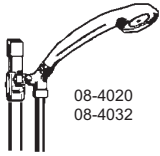

### HAND SHOWER WITH 24 INCH WALL BAR

|         |   |        |  |   |
|---------|---|--------|--|---|
| 08-4020 | B | 1551BX | White & Chrome standard spray adhesive or screw mount          | 1 |
| 08-4028 | B | 1501BX | White & Chrome standard spray double screw mount & tile offset | 1 |
| 08-4032 | B | 1553BX | White & Chrome standard spray 30" A.D.A. glide rail            | 1 |

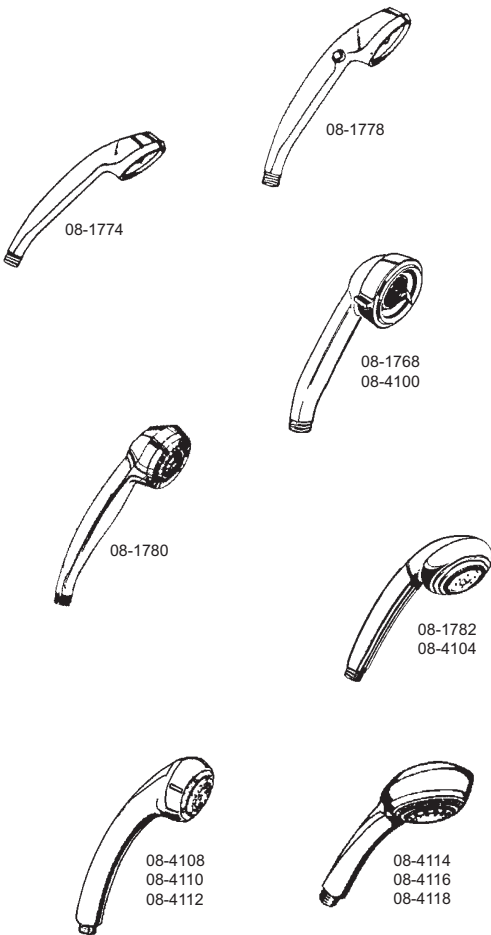
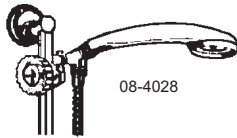

### HAND SHOWERS ONLY

|         |   |           |  |    |
|---------|---|-----------|--|----|
| 08-1774 | C | 462PK     | White standard                               | 10 |
| 08-1778 | C | 462PBPK   | White standard with push button              | 10 |
| 08-1768 | C | 465CPK    | Chrome massage action                        | 10 |
| 08-4100 | B | 4652010BX | Chrome & Polished Brass massage action       | 10 |
| 08-1780 | C | 428CPK    | Chrome Euro style Adj. spray                 | 10 |
| 08-1782 | C | 425CPK    | Chrome Euro style massage action             | 10 |
| 08-4104 | C | 4252010PK | Polished Brass Euro style massage action     | 10 |
| 08-4108 | C | 435PK     | White New 5 function massage action          | 10 |
| 08-4110 | C | 435CPK    | Chrome New 5 function massage action         | 10 |
| 08-4112 | C | 4352010PK | Polished Brass New 5 function massage action | 10 |
| 08-4118 | B | 4452010BX | Polished Brass multi spray massage           | 10 |





# SHOWER ACCESSORIES



## ALSONS PRODUCTS CONTINUED



**C = ALSON PACKAGE**  
**B = ALSON BOX**

| ITEM NO.           | PACK | DESCRIPTION  | CTN.<br>QTY. |
|--------------------|------|--|--------------|
| <b>ACCESSORIES</b> |      |  |              |
| 08-1888            | C    | 4002PK White plastic swivel connector                  | 10           |
| 08-1892            | C    | 4002CPK Chrome plastic swivel connector                | 10           |
| 08-1906            | C    | 5002PK Chrome metal swivel connector                   | 10           |
| 08-1900            | C    | 5001PK Chrome wall mount pin                           | 10           |
| 08-1896            | C    | 4301PK Chrome shower arm mount pin                     | 10           |
| 08-4204            | B    | 4303CBX Chrome fork style shower arm mount             | 10           |
| 08-4206            | C    | 3001PK White new style wall mount bracket              | 6            |
| 08-4208            | C    | 3001CPK Chrome new style wall mount bracket            | 6            |
| 08-4210            | C    | 30012010PK Polished Brass new style wall mount bracket | 6            |
| 08-1794            | C    | 476PK Chrome volume control                            | 10           |
| 08-1850            | C    | 4990FPK Chrome wall mount elbow                        | 10           |
| 08-4222            | B    | 4991FBX Chrome wall mount supply ell with pin          | 10           |
| 08-1844            | C    | 4900PK Chrome vacuum breaker                           | 10           |
| 08-1842            | C    | 4923PK Chrome push-pull diverter                       | 10           |
| 08-1995            | C    | 49232010PK Polished Brass push-pull diverter           | 10           |

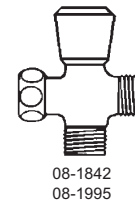
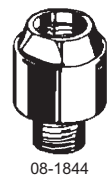
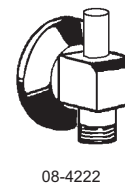
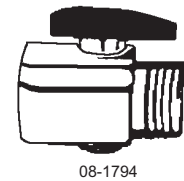
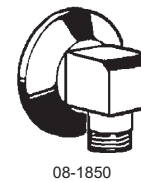
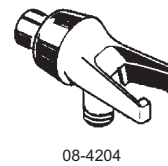
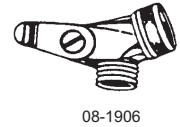

# SHOWER ACCESSORIES

C = ALSON PACKAGE  
B = ALSON BOX



## ALSONS PRODUCTS CONTINUED



| ITEM NO. | PACK | DESCRIPTION | CTN. QTY. |
|----------|------|-------------|-----------|
|----------|------|-------------|-----------|

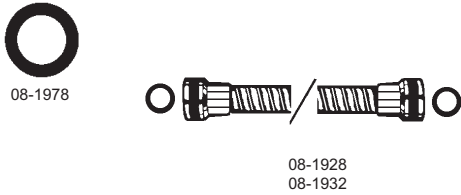

### HOSES

|         |   |           |  |    |
|---------|---|-----------|--|----|
| 08-1924 | C | 490-60PK  | Black and Chrome 60 inch voral hose                | 10 |
| 08-1926 | C | 490-70PK  | Black and Chrome 70 inch voral hose                | 10 |
| 08-1920 | C | 490-84PK  | Black and Chrome 84 inch voral hose                | 10 |
| 08-1997 | C | 4902070PK | Black and Brass 70 inch voral hose                 | 10 |
| 08-1928 | C | 495DS60PK | Chrome Stretchable 60-82 Inches double spiral hose | 10 |
| 08-1978 | B | 4959BG    | Gasket for Alson hose                              | 1  |

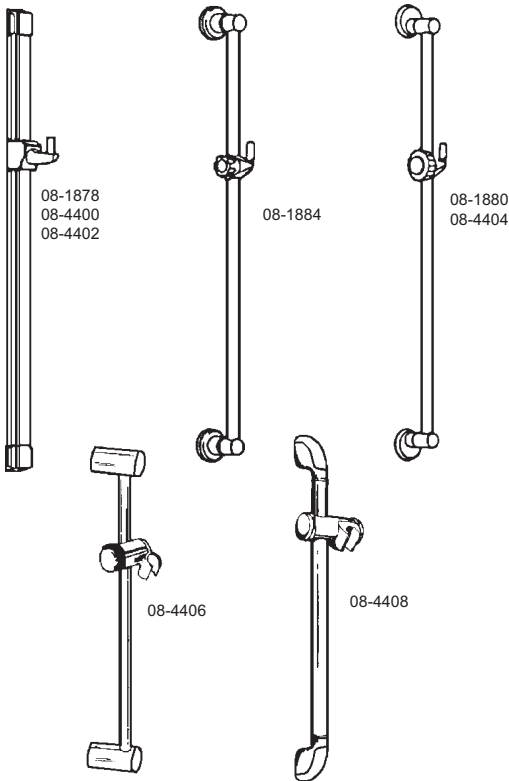

### WALL BAR

|         |   |             |  |   |
|---------|---|-------------|--|---|
| 08-1878 | C | 15511CPK    | Chrome 24" glide rail adhesive mount                         | 1 |
| 08-4400 | B | 15531CBX    | Chrome 30" glide rail adhesive mount ( <b>MEETS A.D.A.</b> ) | 1 |
| 08-4402 | C | 155112010PK | Polished Brass 24" glide rail adhesive mount                 | 1 |
| 08-1884 | B | 25011CBX    | Chrome 24" single screw and tile offset                      | 1 |
| 08-1880 | B | 15011cBX    | Chrome 24" double screw and tile offset                      | 1 |
| 08-4404 | B | 150112010BX | Polished Brass 24" double screw and tile offset              | 1 |
| 08-4406 | B | 15051CBX    | Chrome 24" adjustable height                                 | 1 |
| 08-4408 | B | 15041CBX    | Chrome 24" deluxe Adj. height                                | 1 |



### TUB SPOUT

|         |   |         |   |   |
|---------|---|---------|---|---|
| 08-1824 | C | 1071PK  | Chrome slip-fit Add-A-Shower Div.         | 1 |
| 08-1826 | C | 1010LPK | Chrome 1/2" or 3/4" Add-A-Shower diverter | 1 |

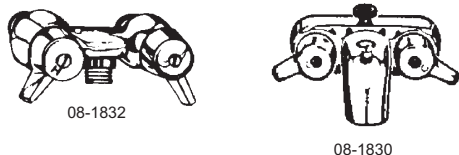

### VALVES

|         |   |        |  |   |
|---------|---|--------|--|---|
| 08-1832 | B | 1050BX | 3-3/8" Center mixer with personal shower outlet      | 1 |
| 08-1830 | B | 1025BX | 3-3/8" Center tub filler with personal shower outlet | 1 |



**ADD - A - SHOWERS**

**B = BULK  
C = CARDED**

| ITEM NO. | PACK | DESCRIPTION  | CTN. QTY. |
|----------|------|--|-----------|
| 08-2140  | B    | Chrome Add -A- Shower with diverter spout                            | 1         |
| 08-2141  | C    | Same as above carded   | 6         |
| 08-2150  | B    | Chrome 3-3/8" center bathcock with 59" shower                        | 1         |
| 08-2151  | C    | Same as above carded   | 6         |
| 08-2152  | B    | Chrome Non- Siphon Add - A - Shower                                  | 1         |
| 08-1090  | B    | Chrome diverter spout  | 10        |
| 08-1091  | C    | Same as above carded   | 6         |
| 08-1092  | B    | 3-3/8" Center bathcock for Add - A - Shower                          | 1         |
| 08-1110  | B    | 3-3/8" Center bathcock with 1/2" M.I.P. personal shower outlet       | 10        |
| 08-1094  | B    | 50" 2 piece Add-A-Shower riser • Less coupling                       | 10        |
| 08-1095  | C    | Same as above carded • With coupling                                 | 6         |
| 08-1096  | B    | 50" 1 piece Add - A - Shower riser                                   | 10        |
| 08-1098  | B    | 6" Add - A - Shower bracket and rod                                  | 10        |
| 08-1099  | C    | Same as above carded   | 6         |
| 08-1100  | B    | Add - A - Shower wall mount bracket                                  | 10        |
| 08-2161  | C    | 12" Add - A - Shower riser extension                                 | 6         |
| 08-1088  | B    | 3/4" FIP x 1/2" MIP bathcock ell (1 pair)                            | 12        |
| 08-1089  | C    | Same as above carded   | 6         |
| 03-5460  | B    | 1/2" Offset bath supply  | 1         |
| 10-0901  | C    | 1/2" FIP x 3/4" FIP x 24" braided stainless steel bathcock connector | 6         |
| 08-2125  | C    | Bathcock lift gate and lever   | 6         |
| 08-2127  | C    | Add - A - Shower 3/8" FIP riser fitting                              | 6         |
| 08-2180  | C    | Rubber massage spray • Connects to faucet                            | 1         |

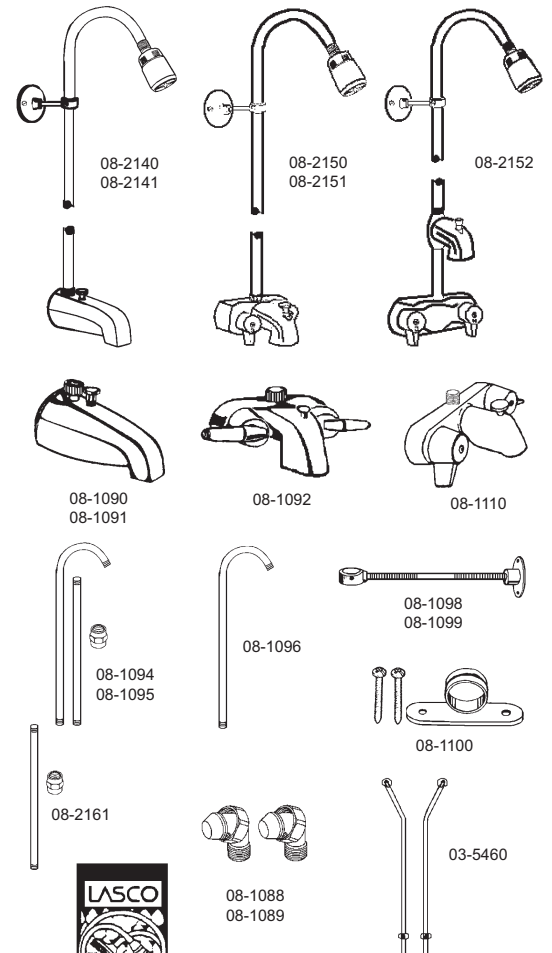

**SHOWER ROD ACCESSORIES**

|         |   |                                      |    |
|---------|---|--------------------------------------|----|
| 03-5053 | C | Chrome plastic adjustable rod holder | 6  |
| 03-5050 | B | Chrome metal adjustable rod holder   | 50 |
| 03-5051 | C | Same as above carded                 | 6  |
| 03-5054 | B | Polished Brass adjustable rod holder | 50 |
| 03-5055 | C | Same as above carded                 | 6  |
| 03-5062 | B | Chrome 1" steel rod holder           | 50 |
| 03-5063 | C | Same as above carded                 | 6  |
| 03-5080 | B | Chrome Jumbo rod holder              | 50 |
| 03-5081 | C | Same as above carded                 | 6  |
| 03-5091 | C | 6" Chrome ceiling support            | 6  |
| 03-5089 | C | 18" Chrome ceiling support           | 6  |
| 03-5093 | C | 24" Chrome ceiling support           | 6  |
| 03-5094 | B | 36" Chrome rod adjustable 6" - 36"   | 1  |
| 03-5096 | B | 1/4-20 Wall mount flange only        | 1  |
| 03-5098 | B | 36" Chrome swivel up ceiling support | 1  |

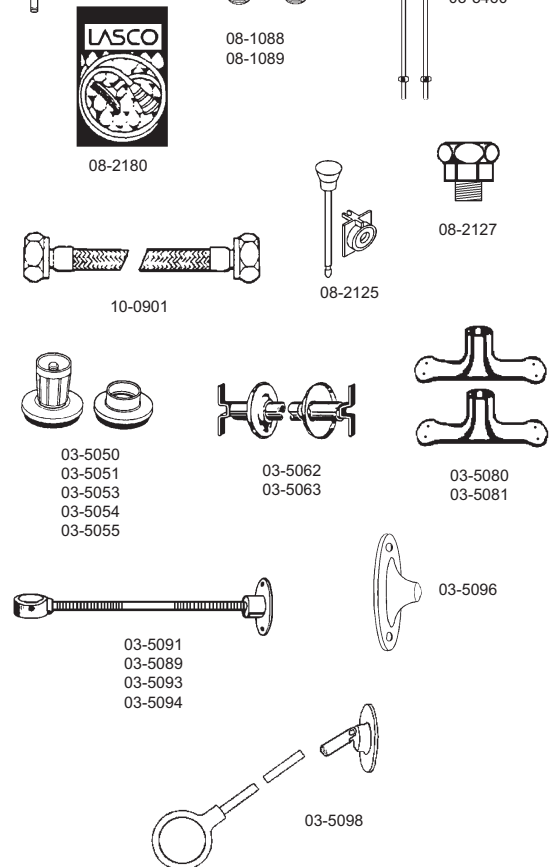

**B = BULK**  
**C = CARDED**

## SHOWER RODS

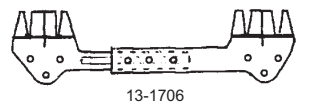
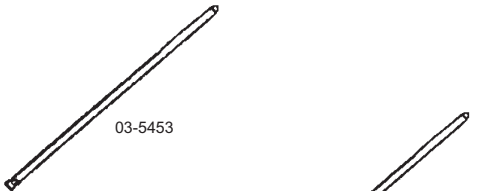
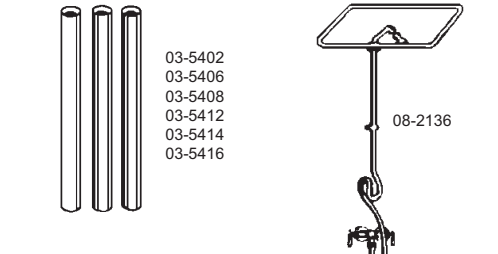
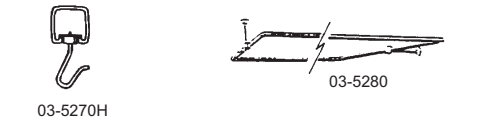
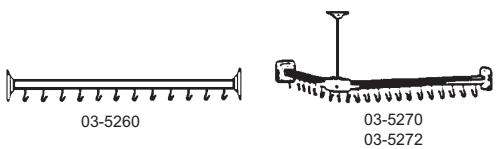
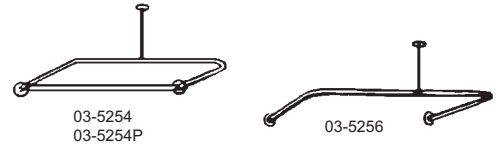
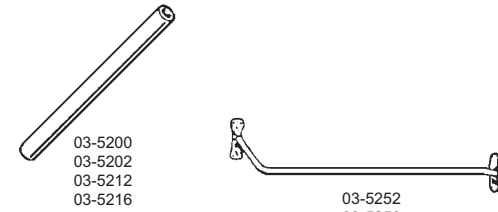

| ITEM NO. | PACK | DESCRIPTION                                   | CTN. QTY. |
|----------|------|---|-----------|
| 03-5200  | B    | 1" x 5 Foot aluminum shower rod               | 50        |
| 03-5202  | B    | 1" x 6 Foot aluminum shower rod               | 50        |
| 03-5212  | B    | 15/16" x 6' Chrome (Brass) shower rod         | 1         |
| 03-5216  | B    | 15/16" x 6' Polished Brass (Brass) shower rod | 1         |
| 03-5252  | B    | 5 Foot corner shower rod                      | 1         |
| 03-5250  | B    | 6 Foot corner shower rod                      | 1         |
| 03-5248  | B    | 6 Foot Chrome plated brass corner shower rod  | 1         |
| 03-5254  | B    | 5 Foot D - Style shower rod                   | 1         |
| 03-5254P | B    | 5 Foot Polished Brass D - Style shower rod    | 1         |
| 03-5256  | B    | 5 Foot C - Style shower rod                   | 1         |
| 03-5260  | B    | 5-1/2 Foot straight tract shower rod          | 1         |
| 03-5270  | B    | 6 Foot LH corner tract shower rod             | 1         |
| 03-5272  | B    | 6 Foot RH corner tract shower rod             | 1         |
| 03-5270H | B    | Hooks for tract shower rods                   | 1         |
| 03-5280  | B    | 24" x 42" Rectangular shower rod              | 1         |
| 08-2136  | B    | 24" x 30" Rectangular ring with shower        | 1         |
| 03-5402  | B    | 1-1/8" x 6 Ft. Chrome (Brass) tubing          | 1         |
| 03-5406  | B    | 1-3/8" x 6 Ft. Chrome (Brass) tubing          | 1         |
| 03-5408  | B    | 1-1/2" x 6 Ft. Chrome (Brass) tubing          | 1         |
| 03-5412  | B    | 2" x 6 Ft. Chrome (Brass) tubing              | 1         |
| 03-5414  | B    | 1-1/2" x 6 Ft. Rough Brass (Brass) tubing     | 1         |
| 03-5416  | B    | 1-1/2" x 6 Ft. PVC tubing                     | 1         |

### LAVATORY LEGS 27 INCH

|         |   |                                      |   |
|---------|---|--------------------------------------|---|
| 03-5453 | C | Adjustable lavatory legs             | 6 |
| 03-5454 | B | Adjustable lavatory legs with flange | 1 |
| 03-5455 | C | Same as above carded                 | 6 |

### BASIN HANGERS

|         |   |                               |     |
|---------|---|-------------------------------|-----|
| 13-1704 | B | Basin hanger bracket          | 100 |
| 13-1705 | C | Same as above carded (1 pair) | 6   |
| 13-1706 | B | Pasco "Z" hanger              | 12  |





**MAGIC AMERICA**



**B = BULK  
C = CARDED**

| ITEM NO.                  | PACK | DESCRIPTION                             | CTN. QTY. |
|---------------------------|------|---|-----------|
| <b>TUB AND WALL CAULK</b> |      |   |           |
| 11-1312                   | B    | MC38 White 1/2" x 11Ft. narrow tub      | 6         |
| 11-1312A                  | B    | MC39 Almond 1/2" x 11Ft. narrow tub     | 6         |
| 11-1304                   | B    | MC15 White 3/4" x 11Ft. tub and wall    | 6         |
| 11-1304A                  | B    | MC16 Almond 3/4" x 11Ft. tub and wall   | 6         |
| 11-1306                   | B    | MC20 White 3/4" x 6Ft. vanity and wall  | 6         |
| 11-1306A                  | B    | MC23 Almond 3/4" x 6Ft. vanity and wall | 6         |
| 11-1308                   | B    | MC30 White 1-1/2" x 5Ft. tub and floor  | 6         |
| 11-1308A                  | B    | MC32 Almond 1-1/2" x 5Ft. tub and floor | 6         |
| 11-1310                   | B    | MC40 White 1-5/8" x 11Ft. wide tub      | 6         |
| 11-1310A                  | B    | MC43 Almond 1-5/8" x 11Ft. wide tub     | 6         |
| 11-1278                   | B    | BS30 White 5 foot bath trim seal        | 6         |
| 11-1290                   | B    | TE30 White 1" x 131" tub surround       | 6         |
| 11-1292                   | B    | TE50 Almond 1" x 131" tub surround      | 6         |
| 11-1294                   | B    | FT30 White 1/2" x 61" fixture trim      | 6         |
| 11-1298                   | B    | CT30 White 1/2" x 16 foot counter trim  | 6         |



11-1312  
thru  
11-1278



11-1290  
thru  
11-1298



08-1388



08-1390

**TUB AND SHOWER ACCESSORIES**

|          |   |                                      |    |
|----------|---|--------------------------------------|----|
| 08-1371  | C | LASCO White shower splash guard      | 6  |
| 08-1376  | B | 5" White Round Hole Cover            | 12 |
| 08-1377  | C | Same as above carded                 | 6  |
| 08-1386  | B | SG37 White shower splash guard       | 6  |
| 08-1386A | B | SG49 Almond shower splash guard      | 6  |
| 08-1388  | B | CC02 White shower curtain clip       | 12 |
| 08-1390  | B | QE25 White shower squeegee           | 12 |
| 08-1392  | B | SE90 Aluminum appliance space eraser | 12 |



08-1376  
08-1377



08-1371  
08-1386  
08-1386A



08-1392

**SAFETY STRIPS**

|         |   |  |   |
|---------|---|--|---|
| 02-4160 | B | 771 White tub safety strips            | 6 |
| 02-4162 | B | ST11 White tub safety roll             | 6 |
| 02-4164 | B | ST02 White tub safety fish appliques   | 6 |
| 02-4166 | B | ST04 White tub safety shells appliques | 6 |
| 02-4168 | B | ST06 White tub safety marine appliques | 6 |



02-4160  
thru  
02-4168



**SHOWER ACCESSORIES**

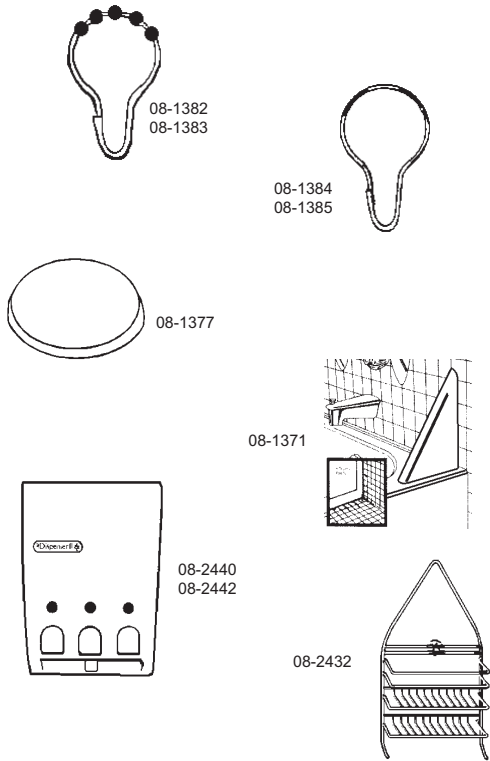

| ITEM NO.                                | PACK | DESCRIPTION   | CTN. QTY. |
|---|------|---|-----------|
| <b>LASCO TUB AND SHOWER ACCESSORIES</b> |      |   |           |
| 08-1382                                 | B    | Nickel plated steel shower curtain pins<br><i>(With Stainless Steel Ballbearings)</i> | 100       |
| 08-1383                                 | C    | Same as above carded <i>(12 per pack)</i>   | 6         |
| 08-1384                                 | B    | Nickel plated steel shower curtain pins   | 100       |
| 08-1385                                 | C    | Same as above carded <i>(12 per pack)</i>   | 6         |
| 08-1377                                 | C    | 5" White plastic hole cover<br><i>(With self adhesive back)</i>                       | 6         |
| 08-1371                                 | C    | White shower splash guard <i>(2 per card)</i>   | 6         |
| 08-2432                                 | B    | Ekco White wire shower caddy  | 6         |
| 08-2440                                 | B    | Double pump soap/shampoo dispenser  | 6         |
| 08-2442                                 | B    | Triple pump soap/shampoo dispenser  | 6         |

**SHOWER DOOR SEAL**

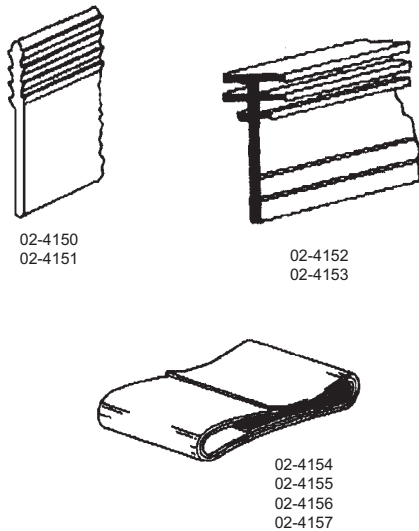

|         |   |  |   |
|---------|---|--|---|
| 02-4150 | B | 1-7/16" Wide • 1200" Long<br>Heavy Duty Grey Vinyl | 1 |
| 02-4151 | C | Same as above carded <i>(37" Long)</i>             | 6 |
| 02-4152 | B | 3/4" Wide • 1200" Long<br>"T" Top Vinyl Sweep      | 1 |
| 02-4153 | C | Same as above carded <i>(37" Long)</i>             | 6 |
| 02-4154 | B | 1-1/2" Wide • 1200" Long<br>Flat Grey Vinyl Sweep  | 1 |
| 02-4155 | C | Same as above carded <i>(37" Long)</i>             | 6 |
| 02-4156 | B | 1-5/16" Wide • 1200" Long<br>Flat Grey Vinyl Sweep | 1 |
| 02-4157 | C | Same as above carded <i>(37" Long)</i>             | 6 |

