



SIGNALISATION
SIGNALING



LISTED
HOMOLOGUÉ

SINGLE STATION
CARBON MONOXIDE ALARM

SINGLE STATION
SMOKE ALARM

Photoelectric Smoke and Carbon Monoxide Alarm User Guide

Model: **P3010CUCA** (with voice warning)

NOTE: This model is battery operated and features a non-replaceable, sealed-in battery and Hush® to temporarily silence nuisance alarms.



10-year sealed lithium battery

ATTENTION: Please take a few minutes to thoroughly read this User guide which should be saved for future reference and passed on to any subsequent owner.

What to do When the Alarm Sounds!

Carbon monoxide (CO) alarm pattern is 4 quick beeps repeating every 5 seconds, followed by "Warning! Carbon Monoxide! Monoxyde de carbone!"

Carbon Monoxide Alarm Procedure

⚠ WARNING: Activation of the CO Alarm indicates the presence of Carbon Monoxide (CO) which can kill you.

- 1) Immediately move to fresh air – outdoors or by an open door/window. Do a head count to check that all persons are accounted for. Do not re-enter the premises nor move away from the open door/window until the emergency services responders have arrived, the premises have been aired out, and your alarm remains in its normal condition.
- 2) Call your local emergency service.
(fire department or 911)

PHONE NUMBER

Never restart the source of a CO problem until it has been corrected. Never ignore the sound of the alarm!

If the alarm is sounding, pressing the test/reset button will terminate the alarm. If the CO condition that caused the alert in the first place continues, the alarm will reactivate. If the unit alarms again within six minutes, it is sensing high levels of CO which can quickly become a dangerous situation.

What to do When the Alarm Sounds!

Smoke alarm pattern is 3 long beeps, repeating, followed by "Fire! Feu!"

NEVER IGNORE THE SOUND OF THE ALARM!

The smoke alarm takes precedence when both smoke and carbon monoxide are present.

Determining what type of alarm has sounded is easy with your Combination Smoke/CO Alarm. The voice message warning system will inform you of the type of situation occurring. Refer to the Features section for a detailed description of each alarm pattern.

What To Do If The Alarm Sounds When the smoke alarm sounds:

Smoke alarms are designed to minimize false alarms. Cigarette smoke will not normally set off the alarm, unless the smoke is blown directly into the alarm. This unit contains nuisance alarm protection, which will reduce the impact of cooking particles. However, large quantities of combustible particles from spills or broiling could still cause the unit to alarm. Careful location of the unit away from the kitchen area will give the maximum nuisance alarm protection. Combustion particles from cooking may set off the alarm if located too close to the cooking area. Large quantities of combustible particles are generated from spills or when broiling. Using the fan on a range hood which vents to the outside (non- recirculating type) will also help remove these combustible products from the kitchen.

If the alarm sounds, check for fires first. If a fire is discovered follow these steps. Become thoroughly familiar with these items, and review with all family members!

- Alert small children in the home. Children sleep very sound and may not be awakened by the sound of the smoke alarms.
- Leave immediately using one of your planned escape routes. Every second counts, don't stop to get dressed or pick up valuables.

What to do When the Alarm Sounds!

Smoke alarm pattern is 3 long beeps, repeating, followed by "Fire! Feu!"

- Before opening inside doors look for smoke seeping in around the edges, and feel with the back of your hand. If the door is hot use your second exit. If you feel it's safe, open the door very slowly and be prepared to close immediately if smoke and heat rush in.
- If the escape route requires you to go through smoke, crawl low under the smoke where the air is clearer.
- Go to your predetermined meeting place. When two people have arrived one should leave to call 911 from a neighbor's home, and the other should stay to perform a head count.
- **Do not reenter under any circumstance until fire officials say that it is safe to do so.**
- **There are situations where a smoke alarm may not be effective to protect against fire as noted by the NFPA Standard 72. For instance:**
 - Smoking in bed
 - Leaving children unsupervised
 - Cleaning with flammable liquids, such as gasoline
 - Fires where the victim is intimate with a flaming initiated fire; for example, when a person's clothes catch fire while cooking
 - Fires where the smoke is prevented from reaching the detector due to a closed door or other obstruction
 - Incendiary fires where the fire grows so rapidly that an occupant's egress is blocked even with properly located detectors

Contents of This User Guide

1. **Introduction / Limitation of Alarms**
2. **Features**
3. **Recommended Locations**
4. **Locations To Avoid**
5. **Installation / Mounting Instructions**
6. **Operation And Testing**
7. **Visual And Audible Indications**
8. **Nuisance And Hush**
9. **Battery**
10. **Deactivation Of Alarm**
11. **General Carbon Monoxide (CO) Information**
12. **Cleaning Your Alarm**
13. **Good Safety Habits**
14. **Warranty**

1. Introduction

Model P3010CUCA

Thank you for purchasing this Kidde Combination Smoke/CO Alarm.

It is an important part of your family's home safety plan. You can trust this product to provide the highest quality safety protection. We know you expect nothing less when the lives of your family are at stake.

Please take a few minutes to thoroughly read this alarm user guide, and save it for future reference. Teach children how to respond to the alarms, and that they should never play with the unit.

If you have any questions about the operation or installation of your alarm, please call our toll free Consumer Hotline at 1-800-880-6788.

Image 1C will help you determine the correct location of safety products that will help make your home a safer place.

1. Introduction

IMPORTANT: Read all instructions before installation and keep this user guide near the alarm for future reference.

Do not try to repair the smoke alarm yourself. Refer to the instructions in Warranty section for service.

This alarm detects products of combustion using photoelectric technology and carbon monoxide using an electrochemical cell. Many times throughout this User Guide, we will refer to Carbon Monoxide as "CO."

This alarm is acceptable for use in all residential applications where a smoke or CO alarm is required, but locations near kitchens or cooking areas should be carefully considered to give the maximum nuisance alarm protection.

After ten (10) years of cumulative power up, this unit will "chirp" two times every 30 seconds. This is an "operational end of life" feature which will indicate that it is time to replace the alarm.

To help identify the date to replace the unit, a label has been affixed to the side of the alarm. Write the "Replace by" date (10 years from initial power up) in permanent marker on the label prior to installing the unit.

1. Limitations of Smoke Alarms



WARNING: PLEASE READ CAREFULLY AND THOROUGHLY

- NFPA 72 states: Life safety from fire in residential occupancies is based primarily on early notification to occupants of the need to escape, followed by the appropriate egress actions by those occupants.
- Fire warning systems for dwelling units are capable of protecting about half of the occupants in potentially fatal fires. Victims are often intimate with the fire, too old or young, or physically or mentally impaired such that they cannot escape even when warned early enough that escape should be possible. For these people, other strategies such as protection-in-place or assisted escape or rescue are necessary.
- Leading authorities recommend that both ionization and photoelectric smoke alarms be installed to help ensure maximum detection of the various types of fires that can occur within the home. Ionization sensing alarms may detect invisible fire particles (associated with fast flaming fires) sooner than photoelectric alarms. Photoelectric sensing alarms may detect visible fire particles (associated with slow smoldering fires) sooner than ionization alarms.
- A battery powered alarm must have a battery of the specified type, in good condition and installed properly.
- Smoke alarms must be tested regularly to make sure the battery and the alarm circuits are in good operating condition.
- Smoke alarms cannot provide an alarm if smoke does not reach the alarm. Therefore, smoke alarms may not sense fires starting in chimneys, walls, on roofs, on the other side of a closed door or on a different floor.
- If the alarm is located outside the bedroom or on a different floor, it may not wake up a sound sleeper.
- The use of alcohol or drugs may also impair one's ability to hear the smoke alarm. For maximum protection, a smoke alarm should be installed in each sleeping area on every level of a home.
- Although smoke alarms can help save lives by providing an early warning of a fire, they are not a substitute for an insurance policy. Home owners, landlords and tenants should have adequate insurance to protect their lives and property.

This alarm is not intended to alert hearing impaired individuals.

1. Limitations of CO Alarms

⚠ WARNING: PLEASE READ CAREFULLY AND THOROUGHLY

- **IMPORTANT:** This carbon monoxide alarm is designed to detect carbon monoxide gas from ANY source of combustion. It is NOT designed to detect any other gas.
- **⚠ CAUTION:** This alarm will only indicate the presence of carbon monoxide gas at the sensor. Carbon monoxide gas may be present in other areas. Never restart the source of a CO problem until it has been fixed. NEVER IGNORE THE ALARM!

⚠ WARNING: This product is intended for use in ordinary indoor locations of family living units. It is not designed to measure compliance with commercial or industrial standards. It is not suitable for installation in hazardous locations as defined in your local building code.

- The installation of this device should not be used as a substitute for proper installation, use and maintenance of fuel burning appliances, including appropriate ventilation and exhaust systems.
- This alarm does not prevent CO from occurring, nor can it solve any existing CO problem.

⚠ WARNING: This device is designed to protect individuals from acute effects of carbon monoxide exposure. It may not fully safeguard individuals with specific medical conditions. If in doubt, consult a medical practitioner. Individuals with medical problems may consider using warning devices which provide audible and visual signals for carbon monoxide concentrations under 30 PPM.

- This alarm has not been investigated for carbon monoxide detection below 70 PPM.
- This carbon monoxide alarm requires a continuous supply of electrical power – it will not work without power.

2. Features

- Loud 85 decibel alarm.
- Independent smoke and carbon monoxide sensors.
- **Smoke alarm takes precedence** when **both** smoke and carbon monoxide are present.
- Powered by a sealed 3V lithium battery, which will last the life of the alarm. No need to replace batteries.
- Alarm/Voice message warning system that alerts you of the following conditions in the manner described below, thus eliminating any confusion over which alarm is sounding:
- **FIRE:** The alarm/voice pattern is three long alarm beeps followed by the verbal warning message "FIRE! FEU!" This pattern is repeated until the smoke is eliminated. The red LED light will flash while in alarm/voice mode.
- **CARBON MONOXIDE:** The alarm/voice pattern is four short alarm beeps followed by the verbal warning message "WARNING! CARBON MONOXIDE! MONOXYDE DE CARBONE!". This continues until the unit is reset or the CO is eliminated. While powered by battery only, after four minutes the alarm/voice pattern will sound once every minute. The red Light Emitting Diode (LED) light will flash while in alarm/voice mode.
- **LOW BATTERY:** If the battery is low, the red LED light will flash and the unit will "chirp" one time, followed by the warning message "LOW BATTERY! PILE FAIBLE!". This alarm contains a sealed 3V Lithium battery, which will last the life of the alarm. No need to replace batteries. This cycle will occur once every minute and will continue for at least seven days. Under battery power, the "LOW BATTERY! PILE FAIBLE!" voice only occurs once every 15 minutes.

2. Features

- Voice Message System that alerts user to the following conditions:
 - Only for smoke alarm Hush

System announces “HUSH MODE ACTIVATED. MODE HUSH ACTIVÉ.” when the unit is first put into HUSH Mode.
 - Only for smoke alarm Hush

System announces “HUSH MODE CANCELLED. MODE HUSH ANNULÉ.” when unit resumes normal operation after Hush Mode has been cancelled.
 - Only if button is pushed

System announces “CAUTION! CARBON MONOXIDE PREVIOUSLY DETECTED! ATTENTION! MONOXYDE DE CARBONE PRÉCÉDEMMENT DÉTECTÉ” when the unit has detected CO concentrations of 100 ppm or higher.
 - System announces “PUSH TEST BUTTON. APPUYER SUR LE BOUTON D’ESSAI.” when the unit is powered up, reminding user to activate the Test Button.
- The End of Product Life Alarm/Signal is a double chirp and red LED flash every 30 seconds.
- End of Life Hush. At end of product life, the button can be pushed to silence the end of life “chirps” for 3 days. Can be used 10 times within 30 days.
- One “chirp” every 30 seconds coupled with an LED flash twice a second is an indication that the alarm is malfunctioning. If this occurs call the Product Support Line at 1-800-880-6788.
- Test/Reset button performs functions.
- HUSH Control Feature that silences the unit during nuisance alarm situations.
- Peak Level Memory Feature which alerts user when the unit has detected CO concentrations of 100 ppm or greater.
- Alarm Memory Feature that gives visual indication when an alarm has sensed a hazardous condition.
- LED light indicates normal operation and alarm status.

3. Recommended Locations

- Locate the first alarm in the immediate area of the bedrooms. Try to monitor the exit path, as the bedrooms are usually farthest from the exit. If more than one sleeping area exists, locate additional alarms in each sleeping area (Image 1A).
- Locate additional alarms to monitor any stairway as stairways act like chimneys for smoke and heat.
- Locate at least one alarm on every floor level (Image 1B).
- Locate an alarm in every Sleeping Room.
- Locate an alarm in every room where electrical appliances are operated (i.e. portable heaters or humidifiers).
- Locate an alarm in every room where someone sleeps with the door closed. The closed door may prevent an alarm not located in that room from waking the sleeper.
- Smoke, heat, and combustion products rise to the ceiling and spread horizontally. Mounting the smoke alarm on the ceiling in the center of the room places it closest to all points in the room. Ceiling mounting is preferred in ordinary residential construction.
- When mounting an alarm on the ceiling, locate it at a minimum of 10 cm (4") from the side wall (Image 2A).
- When mounting the alarm on the wall, use an inside wall with the top edge of the alarm at a minimum of 10 cm (4") and a maximum of 30.5 cm (12") below the ceiling (Image 2A).
- Put smoke alarms at both ends of a bedroom hallway or large room if the hallway or room is more than 9.1 m (30') long.
- For mobile home installation, select locations carefully to avoid thermal barriers that may form at the ceiling. For more details, see **Mobile Homes**.
- Install smoke alarms on sloped, peaked or cathedral ceilings following the mounting guidelines outlined in image 2B and 2C. Smoke alarms in rooms with ceiling slopes greater than 0.3 m in 2.4 m (1 foot in 8 feet) horizontally shall be located on the high side of the room (Image 2B and 2C).

3. Recommended Locations

- Install Smoke Alarms on tray-shaped ceilings (coffered ceilings) on the highest portion of the ceiling or on the sloped portion of the ceiling within 30.5 cm (12") vertically down from the highest point (Image 2D).



- Required Smoke or Smoke / CO Alarms
- Smoke Alarms for Additional Protection
- △ Ionization Type Smoke Alarm with Hush® Control or Photoelectric Type

SINGLE FLOOR PLAN

IMAGE 1A

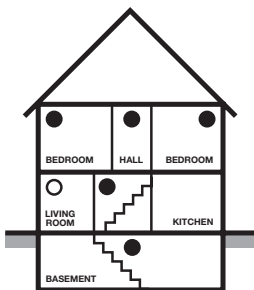

MULTIPLE FLOOR PLAN

IMAGE 1B

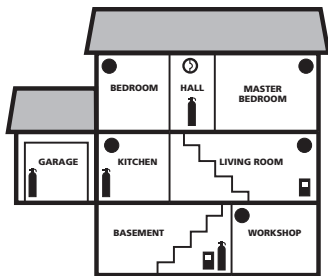

-  FIRE EXTINGUISHERS
-  SMOKE ALARMS
-  CARBON MONOXIDE ALARMS
-  SMOKE/CO ALARM

IMAGE 1C

TOTAL HOME PROTECTION

3. Recommended Locations

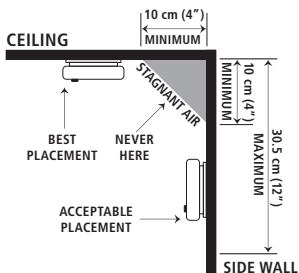

IMAGE 2A

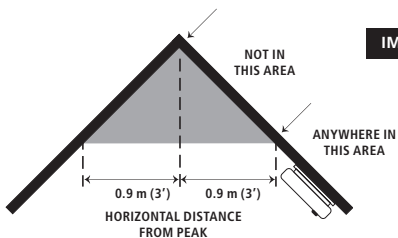

IMAGE 2B

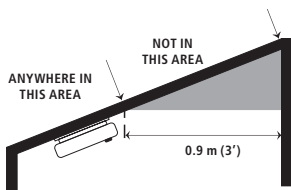

IMAGE 2C

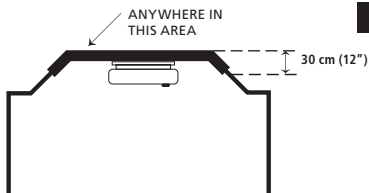

IMAGE 2D

4. Locations to Avoid

- Do not install within 0.9 m (3') of the following: The door to a kitchen, or a bathroom that contains a tub or shower, forced air supply ducts used for heating or cooling, ceiling or whole house ventilating fans, or other high air-flow areas.
- Do not place the alarm where drapes or other objects will block the sensor. Smoke must be able to reach the sensor to accurately detect conditions.
- Do not install in peaks of vaulted ceilings. In this area install as shown in images 2B and 2C.
- Install at least 30.5 cm (12") away from fluorescent lights as electronic noise may cause nuisance alarms.
- Keep out of insect infested areas. Avoid excessively dusty, dirty or greasy areas. Dust particles may cause nuisance alarms or failure to alarm.
- Extreme temperatures may affect the sensitivity of the alarm. Do not install in areas where the temperature is colder than 4.4°C (40°F) or hotter than 37.8°C (100°F), such as garages and unfinished attics.
- Do not install in areas where the relative humidity (RH) is greater than 95%. Very humid areas, with moisture or steam, can cause nuisance alarms.
- Normal cooking may cause nuisance alarms. If a kitchen alarm is desired, it should have an alarm silence feature or be a photoelectric type.
- Do not place in the garage. Particles of combustion and CO are present when you start your automobile.
- Smoke alarms are not to be used with detector guards unless the combination (alarm and guard) has been evaluated and found suitable for that purpose.
- Do not install within 5 ft of heating or cooking appliances.

5. Installation / Mounting Instructions

Mobile Homes

Modern mobile homes have been designed to be energy efficient. Install smoke alarms as recommended in **Recommended Locations** and Image 2A.

In older mobile homes that are not well insulated compared to present standards, extreme heat or cold can be transferred from the outside to the inside through poorly insulated walls and roof. This may create a thermal barrier that can prevent the smoke from reaching an alarm mounted on the ceiling. In such units, install the smoke alarm on an inside wall with the top edge of the alarm at a minimum of 10 cm (4") and a maximum of 30.5 cm (12") below the ceiling (Image 2A).

If you are not sure about the insulation in your mobile home, or if you notice that the outer walls and ceiling are either hot or cold, install the alarm on an inside wall. For minimum protection, install at least one alarm close to the bedrooms. For additional protection, see Image 1A.

⚠ WARNING: Test your smoke alarm operation after R.V. or mobile home vehicle has been in storage, before each trip and at least once a week during use.

Attaching Mounting Plate

OPTION 1: Easy Mount – Drywall Only

1. Choose a mounting location (wall or ceiling) and drill a 3/16" diameter hole at least 1/2" deep.
2. Insert the provided screw aligning the ribs on the screw with the slots on the mounting plate.
3. Tighten the screw/mounting plate to wall or ceiling until mounting plate is snug against surface. DO NOT over-tighten.

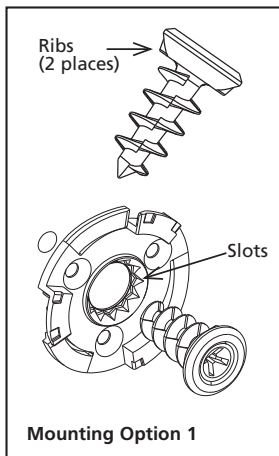

5. Installation / Mounting Instructions

OPTION 2: Mounting on Other Surfaces

1. Choose a mounting location (wall or ceiling) and using the mounting plate provided as a template, mark three-hole locations.
2. Install the three provided screws through the mounting plate and tighten. DO NOT over-tighten screws. (If mounting in plasterboard or similar surface, drill 3/16" holes and use the plastic anchors provided.) Anchors are not required for mounting on hard surfaces such as wood.

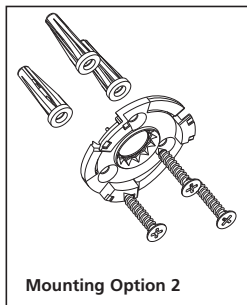

Attaching And Activating The Alarm

This model is equipped with a feature that automatically activates the alarm when the alarm is attached to the mounting plate for the first time. Once activated, the battery will supply power to the alarm for the life of the alarm (10 years) under normal conditions.

Align the alarm with the mounting plate and rotate clockwise (right) approximately 45 degrees until the unit stops and clicks into place. DO NOT over-tighten. If unit needs to be re-aligned, rotate the alarm counter clockwise, remove and rotate to desired alignment. NOTE: The alarm will mount to the plate in three (3) positions (every 120 degrees).

You will know power has been supplied when alarm briefly chirps. Unit will remain on until unit is deactivated (turned off) by the user at alarm's end of life. Do not over tighten the alarm as damage to alarm or mounting surface may occur.

The alarm is now activated! This alarm will issue a voice prompt at activation asking the user to press the test button. After installation/activation, test your alarm as described in Operation and Testing section.

⚠ Warning: Failure to properly install and activate this alarm will prevent proper operation of this alarm and will prevent its response to fire hazards.

6. Operation And Testing

OPERATION: The alarm is operating once it is activated and testing is complete.

The photoelectric smoke sensor monitors the air for the presence of products of combustion. When these levels exceed the alarm threshold the alarm will sound, and be accompanied by the blinking red LED light, followed by a voice message.

The carbon monoxide (CO) sensor monitors the air for the presence of CO. It will alarm when there are high levels of CO present, and when there are low levels of CO present over a longer period of time. When a CO condition matches either of these situations, the alarm will sound, and be accompanied by the blinking red LED light, followed by a voice message.

The CO sensor meets the alarm response time as follows:

At 70 PPM, the unit must alarm within 60-240 minutes.

At 150 PPM, the unit must alarm within 10-50 minutes.

At 400 PPM, the unit must alarm within 4-15 minutes.

TESTING: Test your alarm by pressing the test button until the unit chirps, then release the test button. The unit will then emit 2 sets of three slow beeps followed by 2 sets of four quick beeps and a voice prompt stating "Fire! Feu! Warning! Carbon Monoxide! Monoxyde de carbone!" indicating that the alarm is operating normally. The alarm will sound if the electronic circuitry, horn, and battery are working. If the alarm does not sound, the unit must be replaced.

⚠ WARNING: Due to the loudness (85 decibels) of the alarm, always stand an arm's length (about 2.5 feet) away from the unit or use ear protection when testing.

Weekly testing is required to ensure proper operation. Erratic or low volume sound (or no sound) coming from your alarm may indicate a defective alarm and it should be returned for service. See deactivation section to determine how to prepare the unit for shipment or disposal.

⚠ WARNING: DO NOT use an open flame to test your alarm, you could damage the alarm or ignite combustible materials and start a structure fire.

7. Alarm Visual and Audible Indicators

The following table describes the visual and audible alarm conditions the unit may encounter and illustrates how the unit will indicate normal standby, alarm and error conditions.

Alarm Mode	Visual Indications	Audible Indications
Smoke or Fire detected	3 blinks synchronized with audible alarm	3 long beeps, voice message "Fire! Feu!", 3 long beeps repeating.
Carbon Monoxide detected	4 blinks synchronized with audible alarm	4 quick beeps, voice message "Warning! Carbon Monoxide! Monoxyde de carbone!", repeating (First 4-5 minutes - The repeating pattern is 4 quick beeps, "Warning! Carbon Monoxide! Monoxyde de carbone!", 4 quick beeps. After 4-5 minutes, the pattern is 4 quick beeps, "Warning! Carbon Monoxide! Monoxyde de carbone!" once every minute).

Operational Mode	Visual Indications	Audible Indications	Note:
Normal Operation	Blink once every 60 seconds	None	LED will flash every 60 seconds for 10 minutes following power on or reset. After initial 10 minutes, LED will flash once every 10 minutes
Test/Hush Button Press	Blink with each alarm pattern	Two sets of 3 long beeps with voice "Fire! Feu!" and two sets of 4 quick beeps with voice "Warning! Carbon Monoxide! Monoxyde de carbone!"	Test/Hush button press will initiate test sequence
Smoke Alarm Hush	Blink once every 10 seconds	Voice message "Hush mode activated. Mode Hush activé." (The voice message "Hush Mode Cancelled. Mode Hush annulé." occurs if: 1. The button is pushed again, and the smoke level is below the Alarm level. 2. The Hush mode timer expires, (approximately 9 minutes), and the smoke level is below the Alarm level.)	Alarm hush feature silences smoke alarm for approximately 9 minutes.

7. Alarm Visual and Audible Indicators

Low Battery	Blink once every 30 seconds	During Low Battery mode, the red LED will blink every 30 seconds and the sounder will chirp every 60 seconds followed by the voice message "Low Battery. Pile faible." After 5 minutes, the red LED will continue to blink every 30 seconds and the sounder will continue to chirp every 60 seconds, but the voice message will change to once every 15 minutes. After 60 minutes, (1 hour), of Low Battery mode, the red LED will continue to blink every 30 seconds and the sounder will continue to chirp every 60 seconds, but the voice message will no longer occur.	Remove alarm, deactivate (turn off), replace within 7 days!
Fault Mode	Fault code (2-12 flashes every 30 seconds)	Chirp every 30 seconds	Call Product Support. If fault continues, remove alarm, deactivate (turn off), replace.
End of Unit Life	2 blinks every 30 seconds	2 chirps every 30 seconds	Remove alarm, deactivate (turn off), replace
End of Unit Life Hush	None	None (End of Life chirps silenced)	Silences EOL chirps for 3 days. Can be used 10 times within 30 days.

If you require further information please contact Product Support at 1-800-880-6788 or write us at: Kidde Canada Inc., P.O. Box 40, Apsley, ON K0L 1A0 or visit us on the web at www.kiddecanada.com.

8. Nuisance and Hush

This smoke alarm is designed to minimize nuisance alarms. Cigarette smoke will not normally cause the unit to alarm, unless the smoke is blown directly into the alarm. Combustion particles from cooking may set off the alarm if it is located too close to a cooking appliance. Large quantities of combustible particles are generated from spills or when broiling. Using the fan on a range hood which vents to the outside (non-recirculating type) will also help remove these combustible products from the kitchen.

If the source of a smoke alarm (3 long beeps with the voice message "Fire! Feu!") is immediately known, you can use the Hush feature to silence the alarm for about 9 minutes. If no fire is present, check to see if one of the reasons listed in "Locations to avoid" may have caused the alarm. If a fire is discovered, get out and call the fire department.

8. Nuisance and Hush

Hush® Control: Hush® control is extremely useful in a kitchen area or other area prone to nuisance alarms. The Hush® feature has the capability of temporarily desensitizing the alarm circuit for approximately 9 minutes.

This feature is to be used only when a known alarm condition, such as smoke from cooking, activates the alarm. Pushing the Test/Hush button on the smoke alarm cover will issue a voice prompt stating “Hush Mode Activated. Mode Hush activ  .” and desensitize the smoke alarm. If the smoke is not too dense, the alarm will silence immediately and the red LED will blink every 10 seconds. This indicates that the alarm is in a temporarily desensitized condition.

The smoke alarm will automatically reset after approximately 9 minutes and sound the alarm and issue a voice prompt stating “Fire! Feu!” if particles of combustion are still present.

The Hush® feature can be used repeatedly until the air has been cleared of the condition causing the alarm. Pushing the Test/Hush button during Hush® mode on the alarm will issue a voice prompt stating “Hush Mode Cancelled. Mode Hush annul  .” and end the temporarily desensitized period.

Voice message, “Hush Mode Cancelled. Mode Hush annul  ”, is announced by one of the following conditions:

1. The user cancels Hush mode by pressing the Test button while Hush® mode is active and the smoke level is below the alarm threshold.
2. The Hush mode timer expires, (approximately 9 minutes) and the smoke level is still below the Alarm Threshold.

Note: If the smoke level drops below the Alarm Threshold while in Hush mode, no voice message occurs.

If the smoke is not too dense, after 9 minutes the alarm will return to normal operation.

NOTE: Dense smoke will override the Hush® feature and sound a continuous alarm.

 **CAUTION:** Before using the alarm Hush® feature, identify the source of the smoke and be certain safe conditions exist.

9. Battery

BATTERY ACTIVATION AND DEACTIVATION

NOTE: One Lithium-Ion battery, permanently sealed inside the alarm, powers this unit; no battery installation or replacement is necessary for the life of the alarm.

IMPORTANT: Constant exposure to high or low humidity may reduce battery life.

⚠ WARNING! DO NOT ATTEMPT TO OPEN THE ALARM FOR ANY REASON!

Do not try to repair the smoke alarm yourself. No serviceable parts included.

Low battery: This alarm is equipped with a low battery monitor circuit which will cause the alarm to produce a single “chirp” approximately every 60 seconds and blink the Red LED every 30 seconds, for a minimum of seven (7) days should the battery become low.

The unit must be replaced within 7 days of the first occurrence of the “Low Battery Warning” to provide continuous alarm protection. The UNIT MUST BE DEACTIVATED (see “Deactivation of Alarm” section) prior to disposing.

10. Deactivation of Alarm

! WARNING!

- Deactivation of the alarm is permanent. Once the alarm has been deactivated, it cannot be reactivated!
- Once deactivated, the alarm will **NO LONGER DETECT SMOKE OR CO.**
- Once the alarm is deactivated the battery will be depleted and the alarm will no longer function.
- Once the alarm has been deactivated, it cannot be mounted onto the mounting plate or reactivated.

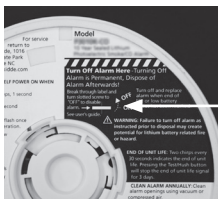

To Deactivate The Alarm:

Remove the alarm from the mounting plate by rotating it in the direction indicated by the arrows on the cover of the alarm.

On back side of alarm, locate the area on product label.



Break through label with a screw driver.

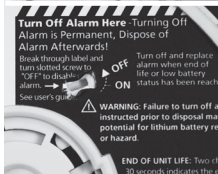

Turn the screw to the "OFF" location. This will deactivate the alarm, stop the low battery or End of Life "chirps" and render the alarm safe for disposal by draining the battery.

! **WARNING!** Failure to deactivate alarm as instructed prior to disposal may create potential for lithium battery related fire or hazard.

11. General Carbon Monoxide (CO) Information

Carbon monoxide (CO) is a colorless, odorless, and tasteless poison gas that can be fatal when inhaled. CO inhibits the blood's capacity to carry oxygen.

Possible Sources Of Carbon Monoxide

Inside your home, appliances used for heating and cooking are the most likely sources of CO. Vehicles running in attached garages can also produce dangerous levels of CO.

CO can be produced when burning any fossil fuel: gasoline, propane, natural gas, oil and wood. It can be produced by any fuel-burning appliance that is malfunctioning, improperly installed, or not ventilated correctly, such as:

Possible sources include furnaces, gas ranges/stoves, gas clothes dryers, water heaters, portable fuel burning space heaters, fireplaces, wood-burning stoves and certain swimming pool heaters. Blocked chimneys or flues, back drafting and changes in air pressure, corroded or disconnected vent pipes, or a loose or cracked furnace exchanger can also release CO into your building. Vehicles and other combustion engines running in an attached garage and using a charcoal/gas grill or hibachi in an enclosed area are all possible sources of CO.

The following conditions can result in transient CO situations:

Excessive spillage or reverse venting of fuel-burning appliances caused by outdoor ambient conditions such as: Wind direction and/or velocity, including high gusts of wind, heavy air in the vent pipes (cold/humid air with extended periods between cycles), negative pressure differential resulting from the use of exhaust fans, simultaneous operation of several fuel-burning appliances competing for limited internal air, vent pipe connections vibrating loose from clothes dryers, furnaces, or water heaters, obstructions in, or unconventional, vent pipe designs which can amplify the above situations, extended operation of unvented fuel-burning devices (range, oven, fireplace, etc.), temperature inversions which can trap exhaust gasses near the ground, car idling in an open or closed attached garage, or near a home.

11. General Carbon Monoxide (CO) Information

CO Safety Tips

Every year, have the heating system, vents, chimney and flue inspected and cleaned by a qualified technician. Always install appliances according to manufacturer's instructions and adhere to local building codes. Most appliances should be installed by professionals and inspected after installation. Regularly examine vents and chimneys for improper connections, visible rust, or stains, and check for cracks in furnace heat exchangers. Verify that the color of flame is blue on pilot lights and burners. A yellow or orange flame is a sign that the fuel is not burning completely and may be releasing CO. Teach all household members what the alarm sounds like and how to respond. Fire Departments, most utility companies and HVAC contractors will perform CO inspections, some may charge for this service. It's advisable to inquire about any applicable fees prior to having the service performed. Kidde will not pay for, or reimburse the owner or user of this product, for any repair or dispatch calls related to the alarm sounding.

Symptoms of CO Poisoning

Initial carbon monoxide poisoning symptoms are similar to the flu with no fever and can include dizziness, severe headaches, nausea, vomiting and disorientation. Everyone is susceptible but experts agree that unborn babies, pregnant women, senior citizens and people with heart or respiratory problems are especially vulnerable. If symptoms of carbon monoxide poisoning are experienced seek medical attention immediately. CO poisoning can be determined by a carboxyhemoglobin test.

The following symptoms are related to CARBON MONOXIDE POISONING and should be discussed with ALL members of the household:

- 1. Mild Exposure:** Slight headache, nausea, vomiting, fatigue (often described as "Flu-like" symptoms).
- 2. Medium Exposure:** Severe throbbing headache, drowsiness, confusion, fast heart rate.
- 3. Extreme Exposure:** Unconsciousness, convulsions, cardio respiratory failure and death.

11. General Carbon Monoxide (CO) Information

The levels of exposure listed on the previous page, relate to healthy adults. Levels differ for those at high risk. Exposure to high levels of carbon monoxide can be fatal or cause permanent damage and disabilities. Many cases of reported carbon monoxide poisoning indicate that while victims are aware they are not feeling well, they become so disoriented they are unable to save themselves by either exiting the building, or calling for assistance. Also, young children and household pets may be the first effected. Familiarization with the effects of each level is important.

12. Cleaning Your Alarm

Your alarm should be cleaned at least once a year

You can clean the interior of your alarm (sensing chamber) by using compressed air or a vacuum cleaner hose and blowing or vacuuming through the openings around the perimeter of the alarm. The outside of the alarm can be wiped with a damp cloth. Use only water to dampen the cloth, use of detergents or cleaners could damage the alarm.

After cleaning, test your alarm by using the test button. If cleaning does not restore the alarm to normal operation, the alarm should be replaced.

- Never use detergent or other solvents to clean the unit.
- Avoid spraying air freshener, hair spray, or other aerosols near the alarm.
- Do not paint the unit. Paint will seal the vents and interfere with the sensor's ability to detect smoke and CO.
- Never attempt to disassemble the unit or clean inside. This action will void your warranty.
- The following substances can affect the CO sensor and may cause false readings and damage to the sensor: Methane, propane, isobutane, iso-propanol, ethyl acetate, hydrogen sulfide, sulfide dioxides, alcohol based products, paints, thinner, solvents, adhesives, hair spray, after shave, perfume, and some cleaning agents.

12. Cleaning Your Alarm

- Move the Smoke/CO Alarm and place in another location prior to performing any of the following:
 - Staining or stripping wood floors or furniture
 - Painting
 - Wall papering
 - Using adhesives

Storing the unit in a plastic bag during any of the above projects will protect the sensors from damage. When household cleaning supplies or similar contaminants are used, the area must be well ventilated.

 **WARNING: Reinstall the Smoke/CO Alarm as soon as possible to assure continuous protection.**

13. Good Safety Habits

Develop and practice a plan of escape!

- Install and maintain fire extinguishers on every level of the home and in the kitchen, basement and garage. Know how to use the fire extinguisher prior to an emergency.
- Make a floor plan indicating all doors and windows and at least two (2) escape routes from each room. Second-storey windows may need an escape ladder.
- Have a family meeting and discuss your escape plan, showing everyone what to do in case of fire.
- Determine a place outside your home where you all can meet if a fire occurs.
- Familiarize everyone with the sound of the smoke and CO alarm and train them to leave your home when they hear it.
- Practice a fire drill at least every six months, including fire drills at night. Ensure that small children hear the alarm and wake when it sounds. They must wake up in order to execute the escape plan. Practice allows all occupants to test your plan before an emergency. You may not be able to reach your children. It is important they know what to do.

13. Good Safety Habits

- Current studies have shown smoke alarms may not awaken all sleeping individuals, and that it is the responsibility of individuals in the household that are capable of assisting others to provide assistance to those who may not be awakened by the alarm sound, or to those who may be incapable of safely evacuating the area unassisted.

Alarm Exit Procedure

- Leave immediately by your escape plan. Every second counts, so don't waste time getting dressed or picking up valuables.
- In leaving, don't open any inside door without first feeling its surface. If hot, or if you see smoke seeping through cracks, don't open that door! Instead, use your alternate exit. If the inside of the door is cool, place your shoulder against it, open it slightly and be ready to slam it shut if heat and smoke rush in.
- Stay close to the floor if the air is smokey. If possible do not breathe too deeply to avoid smoke inhalation. Breathe through a cloth (preferably wet) if possible.
- Once outside, go to your selected meeting place and make sure everyone is there.
- Call the fire department from your neighbor's home - not from yours!
- Don't return to your home until the fire officials say that it is all right to do so.
- There are situations where a smoke alarm may not be effective to protect against fire. For instance:
 - a) smoking in bed
 - b) leaving children home alone
 - c) cleaning with flammable liquids, such as gasoline
 - d) fires where the victim is intimate with a flaming initiated fire; for example, when a person's clothes catch fire while cooking
 - e) fires where the smoke is prevented from reaching the detector due to a closed door or other obstruction
 - f) incendiary fires where the fire grows so rapidly that an occupant's egress is blocked even with properly located detectors

13. Good Safety Habits

Additional Recommendations

The National Fire Protection Association's Standard 72 provides the following information:

Where required by other governing laws, codes, or standards for a specific type of occupancy, approved single and multiple-station smoke alarms shall be installed as follows:

1. In all sleeping rooms and guest rooms
2. Outside of each separate dwelling unit sleeping area, within 6.4 m (21') of any door to a sleeping room, with the distance measured along a path of travel
3. On every level of a dwelling unit, including basements
4. On every level of a residential board and care occupancy (small facility), including basements and excluding crawl spaces and unfinished attics
5. In the living area(s) of a guest suite
6. In the living area(s) of a residential board and care occupancy (small facility)

Smoke Detection - Are More Smoke Alarms Desirable?

Required number of smoke alarms (as shown in Image 1A and Image 1B): The required number of smoke alarms might not provide reliable early warning protection for those areas separated by a door from the areas protected by the required smoke alarms. For this reason, it is recommended that the householder consider the use of additional smoke alarms for those areas for increased protection.

The additional areas include the basement, bedrooms, dining room, furnace room, utility room, and hallways not protected by the required smoke alarms. The installation of the smoke alarms in the kitchen, attic (finished or unfinished), or garage is normally not recommended, as these locations occasionally experience conditions that can result in improper operation.

Alarms should be installed in accordance with the National Fire Protection Association's Standard 72 (NFPA, Batterymarch Park, Quincy, MA 02269).

Notify your local fire department and insurance company of your smoke alarm installation.

14. Warranty

TEN YEAR LIMITED WARRANTY

If after reviewing this user guide you feel that your alarm is defective in any way, do not tamper with the unit. In many cases, the quickest way to exchange your alarm is to return it to the original place of purchase. Alternatively, you may return it for servicing to Kidde. If you have questions, call Kidde Customer Service at 1-800-880-6788.

Kidde warrants that the enclosed alarm will be free from defects in material and workmanship or design under normal use and service for a period of ten years from the date of purchase. The obligation of Kidde under this warranty is limited to repairing or replacing the alarm or any part which we find to be defective in material, workmanship or design, free of charge, upon sending the alarm with proof of date of purchase, postage and return postage prepaid, to: Kidde Canada Inc., P.O. Box 40, Apsley, ON K0L 1A0.

This warranty shall not apply to the alarm if it has been damaged, modified, abused or altered after the date of purchase or if it fails to operate due to improper maintenance or inadequate power. Any implied warranties arising out of this sale, including but not limited to the implied warranties of description, merchantability and fitness for a particular purpose, are limited in duration to the above warranty period. In no event shall the Manufacturer be liable for loss of use of this product or for any indirect, special, incidental or consequential damages, or costs, or expenses incurred by the consumer or any other user of this product, whether due to a breach of contract, negligence, strict liability in tort or otherwise. The Manufacturer shall have no liability for any personal injury, property damage or any special, incidental, contingent or consequential damage of any kind resulting from gas leakage, fire or explosion.

Since some provinces do not allow limitations of the duration of an implied warranty or do not allow the exclusion or limitation of incidental or consequential damages, the above limitations or exclusions may not apply to you. While this warranty gives you specific legal rights, you may also have other rights which vary from province to province. The above warranty may not be altered except in writing signed by both parties hereto.

IMPORTANT: Do not remove unit back cover. Back cover removal will void warranty. Your Kidde smoke alarm is not a substitute for property, disability, life or other insurance of any kind. Appropriate insurance coverage is your responsibility. Consult your insurance agent.



Kidde Canada Inc., P.O. Box 40, Apsley, ON K0L 1A0

QUESTIONS OR FOR MORE INFORMATION

Call our Consumer Hotline at **1-800-880-6788** or contact us at our website at **www.kiddecanada.com**