

*get started*

MULTI-FUNCTION  
**COFFEE MAKER**

Instant

# Welcome

---

## Welcome to your new Multi-function coffee maker!

Brew cafe-quality coffee at home using your favorite Keurig K-Cup®\* pod, espresso capsule, or pre-ground coffee loaded into the included reusable coffee pod.

### **⚠ WARNING**

Before using your Instant Multi-function coffee maker, read all instructions, including the Safety Information on pages 4-6 and Warranty on pages 18-19. Failure to follow the safeguards and instructions may result in injury and/or property damage.

*\* K-Cup is a registered trademark of Keurig Green Mountain, Inc. Use of the K-Cup trademark does not imply any affiliation with or endorsement by Keurig Green Mountain, Inc.*

## Table of Contents

---

Welcome	2
Safety Warnings	4
What's in the box	7
Your Multi-function coffee maker	8
Before you brew	11
Brewing Coffee	13
Care, Cleaning, Storage	15
Learn more	17
Warranty	18

# IMPORTANT SAFEGUARDS

## SAFETY WARNINGS

### **⚠ WARNING**

Read all instructions before using and only use this appliance as directed. Failure to follow these Important Safeguards may result in injury and/or property damage and will void your warranty.

When using electrical appliances, basic safety precautions should always be followed to reduce the risk of fire, electric shock, and injury to persons.

#### Placement

- **DO** operate the appliance on a stable, non-combustible, level surface.
- **DO NOT** place the appliance on or near a hot gas or electric burner, or in a heated oven.

#### General Use

- **DO NOT** use this coffee maker outdoors.
- **DO NOT** fill the water tank with mineral water, milk or other liquids. Only fill the water tank with clean, cold water.
- **DO NOT** let the coffee maker operate without water.
- **DO NOT** use the appliance for anything than its intended use. Not for commercial use. For household use only.
- **DO** regularly inspect the appliance and power cord.
- **DO** only fill the water tank with clean, cold water.
- **DO NOT** fill the water tank with mineral water, milk or other liquids.
- **DO NOT** leave the appliance exposed to sun, wind, and/or snow.
- **DO** operate and store the appliance above 32°F / 0°C
- **DO NOT** leave the appliance unattended when in use.
- **DO NOT** allow children operate the appliance; close supervision is required when any appliance is used near children.
- **DO NOT** let children play with this appliance.
- **DO NOT** force the pod into the appliance. Only use pods intended for this appliance.
- To avoid the risk of extremely hot water, **DO NOT** open the top cover during the brew process. There is extremely hot water in the brewing chamber during the brew process.
- **DO NOT** touch hot surfaces. Use handles or knobs.
- The use of an accessory not evaluated for use with this appliance may cause injuries.
- See instructions regarding closing the Brew Chamber on Page 14.

# SAFETY WARNINGS

## Care and Storage

- **DO** unplug from outlet when not in use before cleaning. Allow the appliance to cool before putting on or taking off parts, and before cleaning the appliance.
- **DO NOT** store any materials in the brewing chamber when not in use.

## Power Cord

- A short power-supply cord is used to reduce the risk resulting from it being grabbed by children, becoming entangled in, or tripping over a longer cord.

## WARNING

Spilled liquids from this coffee maker can cause serious burns. Keep appliance and cord away from children.

Never drape cord over edge of counter, and never use outlet below counter.

- **DO NOT** let the power cord touch hot surfaces or open flame, including the stovetop.
- **DO NOT** use with power converters or adapters, timer switches or separate remote-control systems.
- **DO NOT** let the power cord hang over the edge of tables or counters.
- **DO** unplug your coffee maker by grasping the plug and pull from the outlet. Never pull from the power cord.
- **DO NOT** attempt to modify the plug. If the plug does not fit full into the outlet, reverse the plug.
- **DO** contact a qualified electrician if the plug does not fit in the outlet.
- **DO** plug this appliance into a polarized outlet one way. This appliance has a polarized plug, and one blade is wider than the other.

This appliance has a polarized plug, and one blade is wider than the other. To reduce the risk of electrical shock:

- **ONLY** plug the appliance into a polarized outlet. If the plug does not fit into the outlet properly, reverse the plug
- If the plug does not fit, contact a qualified electrician.
- **DO NOT** attempt to modify the plug in anyway.

# SAFETY WARNINGS

## **⚠ WARNING**

### **Electrical Warning**

The coffee maker contains electrical components that are an electrical shock hazard. Failure to follow these instructions may result in electric shock.

To protect against electrical shock:

- To reduce the risk of fire or electric shock, do not remove the bottom cover. No user-serviceable parts inside. Repair should be done by authorized service personnel only.
- To disconnect, turn any control to the off position, remove plug from power source. Always unplug when not in use, as well as before adding or removing parts or accessories, and before cleaning. To unplug, grasp the plug and pull from the outlet. Never pull from the power cord.
- **DO** regularly inspect the appliance and power cord. **DO NOT** operate the appliance if the power cord or plug is damaged, or after the appliance malfunctions or is dropped or damaged in any manner. For assistance, contact Customer Care by email at support@instanthome.com or by phone at 1-800-828-7280.
- **DO NOT** attempt to repair, replace or modify components of the appliance, as this may cause electric shock, fire or injury, and will void the warranty.
- **DO NOT** tamper with any of the safety mechanisms, as this may result in injury or property damage.
- **DO NOT** immerse power cord, plug or the appliance in water or other liquid.
- **DO** plug this appliance into a polarized outlet one way. This appliance has a polarized plug, and one blade is wider than the other.
- **DO NOT** use the appliance in electrical systems other than 120 V ~ 60 Hz for North America.
- If a long detachable power-supply cord or extension cord is used:
  - The marked electrical rating of the detachable power-supply cord or extension cord should be at least as great as the electrical rating of the appliance.
  - The longer cord should be arranged so that it will not drape over the countertop or tabletop where it can be pulled on by children or tripped over.

## **SAVE THESE INSTRUCTIONS**

# What's in the box

## Instant Multi-function coffee maker

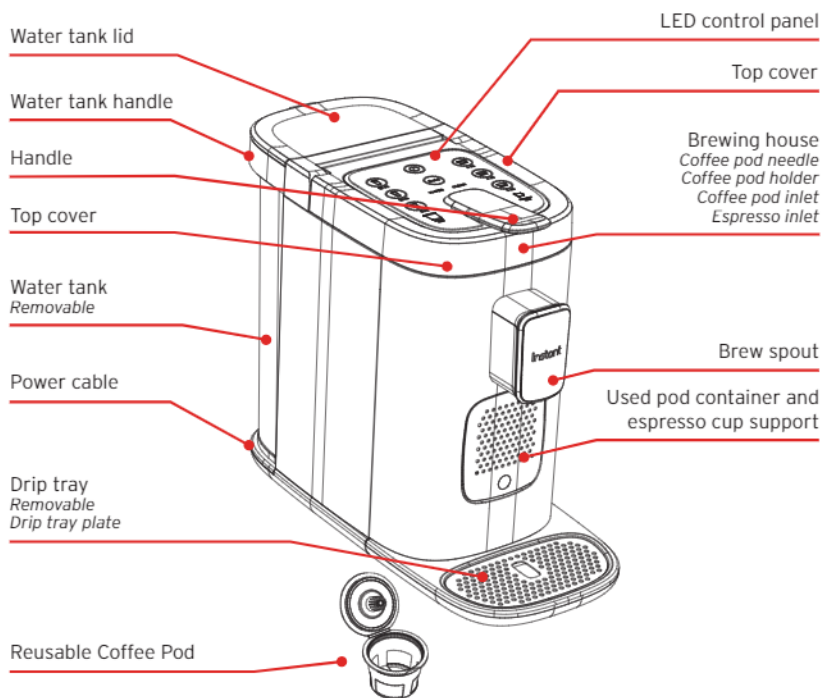

*Illustrations are for reference only and may differ from the actual product.*

# Your Multi-function coffee maker

## Remember to recycle!

We designed this packaging with sustainability in mind. Please recycle everything that can be recycled where you live. Be sure to keep this User Manual for reference.

## Control panel

Here's a look at the simple-to-use, easy-to-read Instant Multi-function coffee maker control panel.

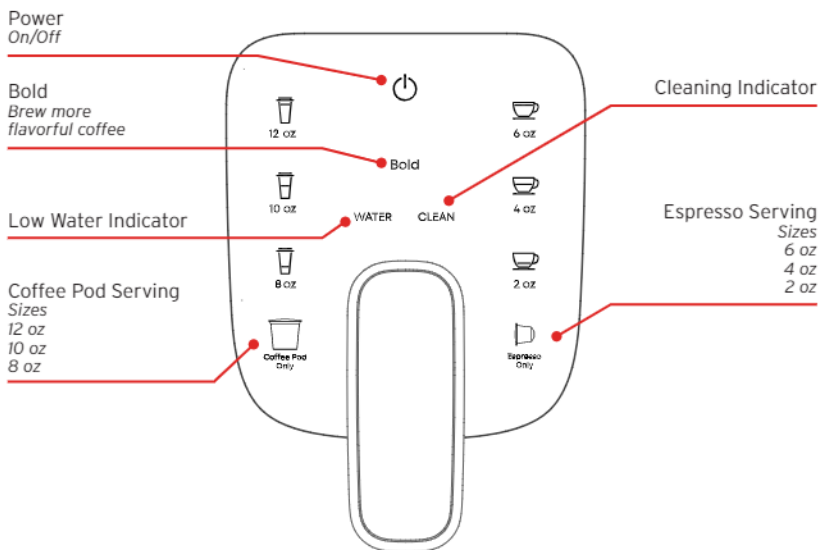

# Your Multi-function coffee maker

---

## Plugging in your Multi-function coffee maker

Before you plug in your Multi-function coffee maker, make sure your Multi-function coffee maker is on a dry, stable, and level surface. Once the Multi-function coffee maker is plugged in, press the power button, located above the **Bold** button. Your device is now in Function Selection mode. From here, you can begin brewing. See page 13 for brewing instructions.

To turn off the Multi-function coffee maker, press the **Power Button**.

After 30 minutes of inactivity, your coffee maker will enter standby mode. The LED control panel will dim. After another 2 hours of inactivity, the LED panel will shut off.

## Sound Settings

You can turn button-pressing sounds and reminder beeps on or off.

1. Make sure your Instant Multi-function coffee maker is on.
2. Press and hold the **4 oz** and **6 oz** espresso buttons at the same time for 3 seconds.
3. Wait for the **4 oz** and **6 oz** buttons to blink twice. *To turn button-pressing sounds on, repeat the above instructions – the 4 oz and 6 oz buttons will blink three times.*

*Note: The device failure sound cannot be deactivated*

## Altitude Mode

If you're using the Instant Multi-function coffee maker at +5,000 feet sea level, enable **Altitude Mode** before you brew.

To turn **Altitude Mode** on

1. Make sure your Instant Multi-function coffee maker is on.
2. Press and hold the **8 oz** and **10 oz** buttons at the same time for 3 seconds.
3. Wait until the **8 oz** and **10 oz** buttons blink three times.

# Your Multi-function coffee maker

---

To turn **Altitude Mode** off

1. Make sure your Instant Multi-function coffee maker is on.
2. Press and hold the **8 oz** and **10 oz** buttons at the same time for 3 seconds.
3. Wait until the **8 oz** and **10 oz** buttons blink twice.

## Low water alert

While or after brewing, your coffee maker will notify you the water tank is nearly empty. If this happens during a brewing cycle, the Water LED on the control panel will start flashing and the brewing program will continue.

While in this low water state, both the Water LED and Power button will remain lit. You cannot run another brewing program until you add water to the tank.

## Adding water

1. Either remove the water tank from the coffee maker or leave the tank on the unit.
2. Fill the water tank with clean, cold water.
3. Place the water tank back onto the coffee maker or close the water tank lid.
4. Begin brewing your next cup of coffee.

You must add water before brewing your next cup of coffee.

**DO NOT** operate this coffeemaker without water in the water tank.

# Before you brew

---

## Initial set up

1. Pull the Instant Multi-function coffee maker and all accessories out of the box.
2. Remove all packaging materials from within and around the Instant Multi-function coffee maker.
3. Place your Multi-function coffee maker on a dry, stable, and level surface.
4. Place water tank back on the coffee maker base.
5. Plug in your Instant Multi-function coffee maker.

## Clean before use

1. Handwash the water tank and reusable coffee pod with warm water and dish soap. Rinse with warm, clear water.
2. Lift the water tank up and remove the foam cushion from underneath the water tank. Stickers on the water tank may be removed.
3. Place the water tank back on the base and press down to secure it.
4. Wipe the water tank and accessories with a clean, dry cloth.
5. With a damp cloth, wipe down the coffee maker base and control panel.

## Before you brew

---

### Initial Cleaning

Before you brew your first cup of coffee, clean your Instant Multi-function coffee maker. Run the following cleaning program without a coffee pod or the reusable coffee pod.

1. Lift the water tank from the back of the coffee maker and remove the water tank lid.
2. Fill the water tank with cold water to the **MAX** fill line as indicated on the water tank.
3. Put the lid back onto the water tanks and place the water tank back onto the coffee maker.
4. Place a large mug which can hold at least 10 oz of liquid beneath the brew spout and onto the drip tray.
5. Close the brewing lid and ensure it's securely latched. Press **8 oz** button. The key flashes as the water heats.
6. The **8 oz** button will illuminate and the coffee maker begins a brewing cycle, and hot water will pour from the brew spout. After the brewing cycle ends or is cancelled and the water stops dripping from the spout, discard the water in the mug. *To stop brewing at any time, touch 8 oz again.*
7. Place the mug back on the drip tray.
8. Touch **10 oz**. The button flashes as the water heats.
9. The **10 oz** button will illuminate and the coffee maker begins a brewing cycle, and hot water will pour from the brew spout. After the brewing cycle ends or is cancelled and the water stops dripping from the spout, discard the water in the mug. *To stop brewing at any time, touch 10 oz again.*

#### **⚠ WARNING**

**Be careful:** Brewing reaches high temperatures. **DO NOT** touch the brewing housing unit or spout during the brewing process. Touching hot surfaces may result in personal injury and/or property damage.

# Brewing Coffee

---

## Brewing Coffee

Once you've cleaned your Instant Multi-function coffee maker and accessories, and you've run the initial cleaning program, you can begin brewing a delicious cup of coffee.

### **Bold**

This program lets you brew a more flavorful cup of coffee by increasing brewing time, allowing the water to extract more flavor from a coffee pod or espresso pod.

### **Altitude Mode**

If you live at higher altitudes (over 5,000 feet above sea level) be sure you follow these instructions, so your coffee maker works properly. See page 9 for instructions.

### **Coffee pods and espresso capsules**

With the Instant® Multi-function coffee maker, you can brew coffee with a K-Cup® pod, espresso capsules or brew your favorite coffee grounds using the included reusable coffee pod.

# Brewing Coffee

## How to brew coffee

### Prep

1. Fill the water tank up to the **MAX** fill line. *DO NOT attempt to brew if the water level is below the MIN fill line.*
2. Choose your favorite K-Cup\* pod, espresso capsule, or fill the reusable coffee pod with two tablespoons of medium or medium-fine ground coffee.

### Brew

1. Lift the latch to the brewing house.
2. Place your desired brewing pod into its appropriate inlet.  
*Close the brewing lid and ensure it is securely latched.*
3. For a stronger cup of coffee, press **Bold** before selecting serving size.
4. Select the desired amount of coffee you would like to brew by pressing the **8 oz**, **10 oz** or **12 oz** buttons for coffee pods, or **4 oz**, **6 oz**, **8 oz** for espresso capsules. The selected button will flash while water heating cycle begins. *You can stop brewing at any time by pressing the selected cup size again.*
5. The selected brewing button will flash and remain illuminated when the coffee maker starts brewing. Soon, hot coffee will pour from the brew spout.
6. When the coffee stops dripping from the spout, remove your cup of coffee.

### **⚠ WARNING**

**Be careful:** Brewing reaches high temperatures. **DO NOT** touch the brewing housing unit or spout during the brewing process. Touching hot surfaces may result in personal injury and/or property damage.

## Care, Cleaning, Storage

Regularly clean your Instant Multi-function coffee maker and included accessories to ensure the best possible flavor and to prevent mineral deposits from building up in the coffee maker.

Always unplug the coffee maker and let it cool to room temperature before cleaning. Never use metal scouring pads, abrasive powders, or harsh chemical detergents on any of the coffee maker's parts.

Let all parts dry thoroughly before use, and before storage.

Instant Multi-function coffee maker Part/Accessory	Cleaning methods and instructions
Water tank	Remove the tank and handwash with dish soap and warm water.
Coffee pod holder	Remove and handwash with dish soap and warm water or place in the top rack of a dishwasher.
Stainless steel drip tray	Can be removed and washed by hand with dish soap and warm water or placed in the top rack of a dishwasher.
Coffee maker / LED panel	Use a damp dish cloth to clean the outside of the coffee maker and LED panel
Power cord	DO NOT fold power cord when storing.
Used pod container	Open the used pod container by folding down the cup support and pulling back on the cup support. Recycle the used pods. Holds up to 10 used pods at a time. Empty weekly, or more as needed. DO NOT allow pods to sit for longer than 7 days. Hand wash container with warm soapy water. Let air dry before placing back into the coffee maker.

### **⚠ WARNING**

**Be careful:** The coffee maker contains electrical components.

To avoid fire, electric shock, or personal injury:

- Hand wash only.
- **DO NOT** rinse or immerse the coffee maker, power cord, or plug in water or other liquids.

## Care, Cleaning, Storage

---

### Descaling / Removing Mineral Deposits

With regular use, mineral deposits may accumulate in the coffee maker, which can affect the temperature and strength of your brew.

To make sure your coffee maker stays in tip top shape, descale it regularly to keep mineral deposits from building up.

After 300 cycles, the 10 oz and 12 oz keys flash to remind you to clean and descale your coffee maker.

### Descaling Solution Ratio

Cleaner	Cleaner to water ratio
Household descaler	1 : 4
Citric acid	3 : 100

1. Combine cleaner and water as shown in the table above.
2. Make sure the reusable pod is in the brewing housing unit.
3. Fill the water tank to the **MAX** line with the cleaning mixture.
4. Place a large container beneath the drip nozzle.
5. Touch and hold the **10 oz** and **12 oz** keys for 3 seconds. *The cleaning mixture runs through the appliance until the water tank is empty.*
6. Discard the cleaning mixture from the container and place the emptied container beneath the drip nozzle.
7. Rinse the water tank and fill to the **MAX** line with cool, clean water.
8. Touch and hold the **10 oz** and **12 oz** keys for 3 seconds. *The cleaning mixture runs through the appliance until the water tank is empty.*
9. Discard water produced from coffee maker.

#### **⚠ WARNING**

**Be careful:** Hot water is used for descaling. To avoid risk of personal injury and/or property damage, the container must be large enough to hold the **entire contents of the water tank** (68oz / 2000 mL).

Any other servicing should be performed by an authorized service representative.

---

## Learn more

---

There's a whole world of Instant Multi-function coffee maker information and help just waiting for you. Here are some of the most helpful resources.

### Register your product

[Instanthome.com/register](http://Instanthome.com/register)

### Contact Consumer Care

[Instanthome.com](http://Instanthome.com)

[support@instanthome.com](mailto:support@instanthome.com)

1-800-828-7280

### Replacement parts and accessories

[Instanthome.com](http://Instanthome.com)

### Connect and Share



### Get started online with your new product!



### Product specifications

Model	Volume	Wattage	Power	Weight	Dimensions
DPCM-1100	68 oz / 2011 mL water tank	1500 watts	120V/ 60Hz	12.0 lb / 5.4 kg	in: 13.0 H X 7.0 W X 15.4 D cm: 33.0 H X 17.8 W X 39.1 D

# Warranty

---

## One (1) Year Limited Warranty

This One (1) Year Limited Warranty applies to purchases made from authorized retailers of Instant Brands Inc. ("Instant Brands") by the original appliance owner and is not transferable. Proof of original purchase date and, if requested by Instant Brands, return of your appliance, is required to obtain service under this Limited Warranty. Provided the appliance was used in accordance with the use & care instructions, Instant Brands will, in its sole and exclusive discretion, either: (i) repair defects in materials or workmanship; or (ii) replace the appliance. In the event that your appliance is replaced, the Limited Warranty on the replacement appliance will expire twelve (12) months from the date of receipt. Failure to register your product will not reduce your warranty rights. The liability of Instant Brands, if any, for any allegedly defective appliance or part will not exceed the purchase price of a comparable replacement appliance.

## What is not covered by this warranty?

1. Products purchased, used, or operated outside of the United States and Canada.
2. Products that have been modified or attempted to be modified.
3. Damage resulting from accident, alteration, misuse, abuse, neglect, unreasonable use, use contrary to the operating instructions, normal wear and tear, commercial use, improper assembly, disassembly, failure to provide reasonable and necessary maintenance, fire, flood, acts of God, or repair by anyone unless directed by an Instant Brands representative.
4. Use of unauthorized parts and accessories.
5. Incidental and consequential damages.
6. The cost of repair or replacement under these excluded circumstances.

EXCEPT AS EXPRESSLY PROVIDED HEREIN AND TO THE EXTENT PERMITTED BY APPLICABLE LAW, INSTANT BRANDS MAKES NO WARRANTIES, CONDITIONS OR REPRESENTATIONS, EXPRESS OR IMPLIED, BY STATUTE, USAGE, CUSTOM OF TRADE OR OTHERWISE WITH RESPECT TO THE APPLIANCES OR PARTS COVERED BY THIS WARRANTY, INCLUDING BUT NOT LIMITED TO, WARRANTIES, CONDITIONS, OR REPRESENTATIONS OF WORKMANSHIP, MERCHANTABILITY, MERCHANTABILITY, FITNESS FOR A PARTICULAR PURPOSE OR DURABILITY.

# Warranty

---

Some states or provinces do not allow for: (1) the exclusion of implied warranties of merchantability or fitness; (2) limitations on how long an implied warranty lasts; and/or (3) the exclusion or limitation of incidental or consequential damages; so these limitations may not apply to you. In these states and provinces, you have only the implied warranties that are expressly required to be provided in accordance with applicable law. The limitations of warranties, liability, and remedies apply to the maximum extent permitted by law. This limited warranty gives you specific legal rights, and you may also have other rights which vary from state to state or province to province.

## Product Registration

Please visit [www.instanthome.com/register](http://www.instanthome.com/register) to register your new Instant Brands™ appliance. Failure to register your product will not diminish your warranty rights. You will be asked to provide the store name, date of purchase, model number (found on the back of your appliance) and serial number (found on the bottom of your appliance) along with your name and email address. The registration will enable us to keep you up to date with product developments, recipes and contact you in the unlikely event of a product safety notification. By registering, you acknowledge that you have read and understand the instructions for use, and warnings set forth in the accompanying instructions.

## Warranty Service

To obtain warranty service, please contact our Customer Care Department by phone at 1-800-828-7280 or by email to [support@instanthome.com](mailto:support@instanthome.com). You can also create a support ticket online at [www.instanthome.com](http://www.instanthome.com). If we are unable to resolve the problem, you may be asked to send your appliance to the Service Department for quality inspection. Instant Brands is not responsible for shipping costs related to warranty service. When returning your appliance, please include your name, mailing address, email address, phone number, and proof of the original purchase date as well as a description of the problem you are encountering with the appliance.

Instant Brands Inc.  
495 March Road, Suite 200  
Kanata, Ontario, K2K 3G1 Canada

**[instanthome.com](http://instanthome.com)**

© 2021 Instant Brands Inc.  
140-6013-01-0101