

# HERCULES<sup>®</sup> Rebar Chair

A PRODUCT OF T.J. HARRIS CO.

## DATA SHEET

Patented Rebar Support

### Material

P6M5U-003 (POLYPROPYLENE COPOLYMER)

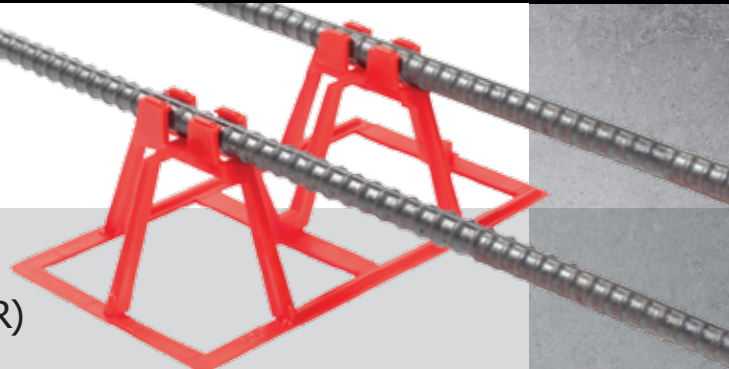

TYPICAL RESIN PROPERTIES	ASTM TEST METHOD	VALUE	UNIT
MELT FLOW RATE	D1238	18	G/10 min
DENSITY	D1505	0.900	G/CM3
TENSILE	D638	3,200	PSI
FLEXURAL MODULUS	D790	145,000	PSI
DEFLECTION TEMP	D648	180	F
HARDNESS VALUE	R-Scale	65	

### STRENGTH

PRODUCT #	911	912	Footer Stand
MAXIMUM LOAD	1,599 lbs	1,131 lbs	665 lbs per bar

Load applied to the bar at a rate of .5-inches deflection per minute until the support fails. Point loads are determined at the weakest point on continuous supports.

Strength. Quality.  
**SOLUTION.**



[WWW.HERCULESCHAIR.COM](http://WWW.HERCULESCHAIR.COM)

T.J. HARRIS COMPANY | 1116 Glider Avenue | Knoxville, TN 37917  
865-633-9955 | Fax: 865-633-9916 | [anthony@herculeschair.com](mailto:anthony@herculeschair.com)