



Product Guide

Graco's Select Line of Sprayers and Accessories



PROVEN QUALITY. LEADING TECHNOLOGY.

Our Story. . .

TrueCoat® 360 Handheld Sprayers

The Best Choice for Small Painting Projects

There is nothing like a Graco sprayer. Graco is a world leader in fluid handling solutions. Our products move, measure, control, dispense, and apply a wide range of materials. Designed with innovation and leading technology, Graco spray equipment makes painting fast and easy while delivering a professional finish.

The company’s success is built on its unwavering commitment to technical excellence, world-class manufacturing and unparalleled customer service.

For more than 85 years, Graco has provided customers with proven quality and leading technology. Founded in 1926, Graco is the world leader in fluid handling systems and components. Since developing its first portable airless sprayer in 1958, Graco is recognized worldwide as the professional contractor’s top choice for spray equipment.

- World leader in fluid handling technologies
 - Publicly Traded, NYSE: GGG
 - Leading technology development, Graco holds more than 2,000 patents
 - Global, with major distribution centers in the USA, Belgium, Japan, Korea, China, Australia
- Headquartered in Minneapolis, MN USA
 - More than 2,600 employees

Proven Quality. Leading Technology.

Graco manufactures the most extensive and highest quality professional line of material application equipment in the market. This informational guide is designed to help you select the right solutions for your material application needs.

- Graco delivers:
- Maximum Performance
 - Unmatched Productivity
 - Reliable Warranty Coverage

Just Fill, Squeeze & Spray!

With one simple squeeze of the bag you’re **Ready to Go!**

Never in the history of painting has this much power been this simple to use. Thanks to its industry-first innovative FlexLiner paint bag technology, the TrueCoat 360 line of sprayers makes fast work of indoor and outdoor painting and staining projects.



FlexLiner™ Paint Bag System

Replaces traditional material cups with suction tubes—when you’re done, reuse or toss, *it’s your choice!*

VacuValve™ Technology

Creates a vacuum for spraying in any direction without losing prime.

Reverse-A-Clean® (RAC®) Tip

4 and 12 Inch Reverse-A-Clean (RAC) Spray Tips (.015 hole size) included.

Dual Speed Switch

Provides more control and less overspray. Available on TrueCoat 360ds model only.

Variable Speed Control

Low speed to move slower, high speed to move faster. Available on TrueCoat 360vsp model only.

Durable, High-Pressure Piston Pump

Sprays paints and stains with no thinning required!



32 oz FlexLiner Paint Bags – 451652/Graco #17A226

Paint bags that can be reused or disposed of for fast cleanup. 3 pack.

42 oz FlexLiner Paint Bags – 451655/Graco #17F005

42 oz Big Job Cup for less refills and larger jobs. For use with TrueCoat 360 VSP only.



4 & 12 inch Reverse-A-Clean (RAC)

Spray Tip Pack – 451650/Graco #17A223

Reversible spray tips to quickly clear tip clogs without disassembly; .015 tip hole size. 2 pack.



Model:	TrueCoat 360ds	TrueCoat 360vsp
Item Number	451652	451655
Graco Part Number	17A466	17D889
Refills per Gallon	4	3
Speed Control	Low/High	Variable
Performance	1500 psi	900 to 1500 psi
Spray Control	Better	Best
Weight / Weight with material	3.5 lbs / 5.5 lbs	3.9 lbs / 7.0 lbs

MAGNUM® Airless Sprayers

Professional Finish. Faster. Easier.

The Brand Preferred by Pros

Whether you are a homeowner with home improvement projects or a contractor that paints on a regular basis, Magnum has the perfect sprayer for the job. The durable stainless steel piston pump delivers a finely atomized spray for a flawless professional finish with just one coat. Equipped with the breakthrough technology of the ProXChange™ Pump, the new ProX sprayers allow you to replace your pump on the job faster and easier without any tools, eliminating downtime!

ProX Sprayer Features:

Stainless Steel Piston Pump

Handles heavier materials, is corrosion resistant for long life and is modular for easy repair.

DC Motor

Supports longer extension cords and up to 150 ft (46 m) airless hose.

InstaClean™ Pump Filter

Remove unwanted debris to reduce tip plugging and improve finish.

Power Flush™ Adapter

Connects to a garden hose for fast and easy cleaning.

Reversible Spray Tip

Quickly clears tip clogs.

Adjustable Pressure Control

Easy control of paint flow.

PushPrime™

Fast and reliable start-up.



Model:	Magnum Project Painter™ Plus	Magnum X5	Magnum X7	Magnum ProX17 Stand	Magnum ProX19 Cart
Item Number	451681	451682	451683	451657	451658
Graco Part Number	257025	262800	262805	17G177	17G180
Recommended Annual Usage*	50 gal	125 gal	125 gal	300 gal	500 gal
Max Tip Size	.015	.015	.017	.017	.019
Max PSI	2800 (193 bar)	3000 (207 bar)	3000 (207 bar)	3000 (207 bar)	3000 (207 bar)
Max GPM	0.24 (.90 lpm)	0.27 (1.0 lpm)	0.31 (1.14 lpm)	0.34 (1.28 lpm)	0.38 (1.4 lpm)
Max Hose Length	50 ft (15 m)	75 ft (23 m)	100 ft (30 m)	150 ft (46 m)	150 ft (46 m)
Motor	3/8 hp Universal	1/2 hp Universal	5/8 hp Universal	3/4 hp DC	7/8 hp DC

New Technology! ProXChange Pump Replacement System

*Ideal for property Maintenance professionals,
Remodelers and General Contractors*

(Available on all Magnum ProX Sprayers)

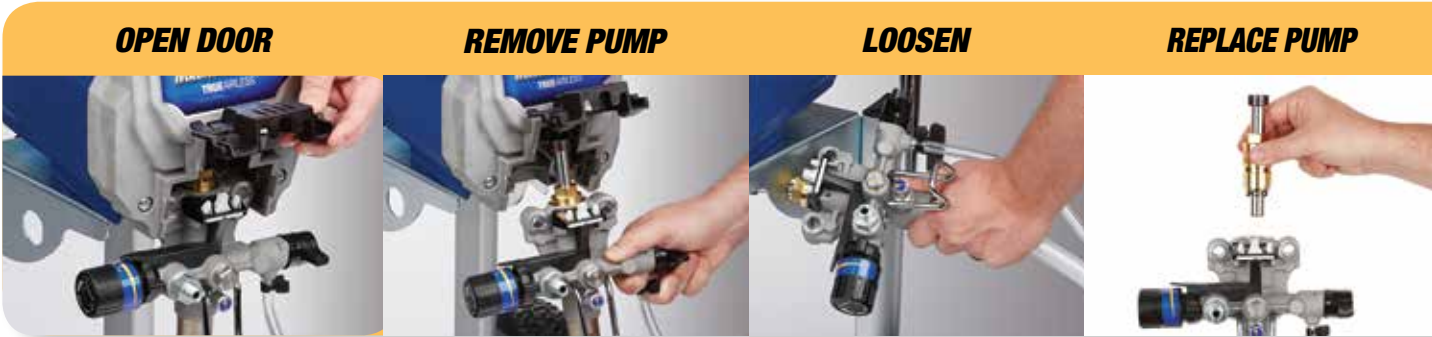

PROXCHANGE™ PUMP REPLACEMENT SYSTEM

- ▶ ON-THE-JOB PUMP REPLACEMENT
- ▶ ELIMINATE DOWNTIME



3 *Annual usage is a general guideline to help with product selection only. With good care and routine maintenance, our sprayer should last for years. Refer to the product box for materials supported by each sprayer.

Professional Sprayer

Pro Painting Solutions. Expert Results!™

The Pro210Es includes the industry-proven Endurance™ Pump with ProConnect™ for maximum life and reparability required by professional painting contractors. Being able to quickly change a pump can be the difference between keeping a sprayer spraying or having it sit idle waiting for repairs.

Endurance™ Pump

- The most reliable pump on the market—lasts 2 times longer than the next leading brand
- Long-life V-Max Blue™ packings, Chromex™ rod and hardened stainless steel cylinder
- QuikAccess™ intake valve for fast cleaning or debris clearing

Easy Out™ Manifold Filter

- Vertical design helps eliminate spills
- Filters from the inside out and won't collapse
- Flow-through design cleans with only a few gallons

Durable DuraDC™ Motor

- DC motors are more forgiving to voltage fluctuations allowing them to run on longer cords

SG3 Metal Spray Gun with 50 ft DuraFlex™ Paint Hose

- Premium SG3 metal spray gun with hose swivel makes it easy to manage longer hose length while spraying.



Finish Every Job, Every Day!

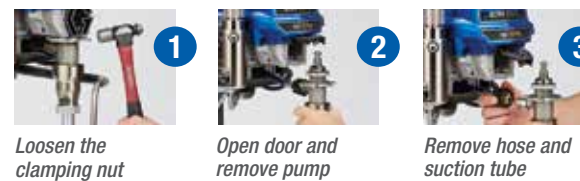

Fast Pump Removal

- ▶ 1-minute jobsite replacement
- ▶ Keeps you spraying instead of waiting for service
- ▶ No pins or parts to lose!

- ▶ **Fast and Easy on-the-job pump replacement system**
- ▶ **Eliminates downtime!**



Model:	Graco Pro210Es Stand
Item Number	451654
Graco Part Number	17D163
Recommended Annual Usage*	1500 gal
Max Tip Size	.021
Max PSI	3000 (207 bar)
Max GPM	0.47 (1.78 lpm)
Max Hose Length	200 ft (61 m)
Motor	1 hp DuraDC

Accessories

PROXCHANGE PUMP REPLACEMENT KIT – 451673/Graco #24Y472

Eliminates downtime with quick, no-tools pump replacement on-the-job! Graco's Pump Replacement System provides the only one-part pump replacement solution on the market today. For use on ProX models only.

SG3™ DELUXE METAL SPRAY GUN – 451675/Graco #243012

Built-in swivel provides easy gun movement without tangling hose. In-handle paint filter reduces tip clogs and improves finish. Full trigger (4-finger) is comfortable when spraying for long periods of time.

REVERSE-A-CLEAN (RAC) IV SWITCHTIPS™

High precision spray tip provides excellent fan pattern life and a high quality finish. Reverse the handle to quickly clean material clogs.

RAC IV Tip, 211	451660/Graco #221211	RAC IV Tip, 415	451666/Graco #221415
RAC IV Tip, 311	451661/Graco #221311	RAC IV Tip, 417	451667/Graco #221417
RAC IV Tip, 313	451662/Graco #221313	RAC IV Tip, 515	451668/Graco #221515
RAC IV Tip, 315	451663/Graco #221315	RAC IV Tip, 517	451669/Graco #221517
RAC IV Tip, 411	451664/Graco #221411	RAC IV Tip, 519	451670/Graco #221519
RAC IV Tip, 413	451665/Graco #221413	RAC IV Tip, 521	451671/Graco #221521

RAC IV TIP GASKET – 451674/Graco #243004

INLET STAINER FOR MAGNUM UNITS – 451684/Graco #288716

40-MESH INSTA-CLEAN FILTER – 451685/Graco #288747

Remove unwanted debris and reduce tip plugging to improve finish (ProX sprayers only).

PUMP ARMOR™ STORAGE FLUID – 451679/Graco #243104

Protects your pump when not in use. Simply fill your pump and leave it in until you use your sprayer again. 1 qt (1 l).

PROCONNECT ENDURANCE PUMP REPLACEMENT – 451653/Graco #17C721

Graco's Pump Replacement System provides the only one-part pump replacement solution on the market today. For use on Pro210ES models only.

RAC IV TIP GUARD, 7/8 INCH THREAD – 451672/Graco #237859

Used with RAC IV SwitchTips. No tools need to install or remove. Fits all Graco spray guns.

50-MESH GUN FILTER – 451686/Graco #288749

100-MESH GUN FILTER – 451687/Graco #288750

Remove unwanted debris to reduce tip plugging and improve finish.

DURAFLEX PAINT HOSE (3300 PSI) – 451680/Graco #247340

50 ft x 1/4 in, includes connector

Lighter weight and increased hose flexibility improves usability when spraying under pressure. With superior flexibility and durability, DuraFlex ensures you get the best results from your airless sprayer.

20 INCH TIP EXTENSION – 451677/Graco #243042

30 INCH TIP EXTENSION – 451678/Graco #243043

Attach to any Graco airless spray gun to extend your reach. Ideal for spraying ceilings, overhangs and decks.

TSL™ (THROAT SEAL LIQUID) – 451659/Graco #206994

TSL prevents dried paint from accumulating on the pump rod—extending the life of the pump packings. Not required for Magnum sprayers. 8 oz (.24 l).

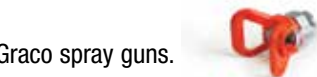
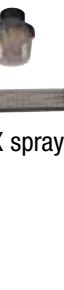



ABOUT GRACO

PROVEN QUALITY. LEADING TECHNOLOGY.

Founded in 1926, Graco is a world leader in fluid handling systems and components. Graco products move, measure, control, dispense and apply a wide range of fluids and viscous materials used in vehicle lubrication, commercial and industrial settings.

The company's success is based on its unwavering commitment to technical excellence, world-class manufacturing and unparalleled customer service. Working closely with qualified distributors, Graco offers systems, products and technology that set the quality standard in a wide range of fluid handling solutions. Graco provides equipment for spray finishing, protective coating, paint circulation, lubrication, and dispensing sealants and adhesives, along with power application equipment for the contractor industry. Graco's ongoing investment in fluid management and control will continue to provide innovative solutions to a diverse global market.

GRACO LOCATIONS

Graco Customer Service
800-690-2894
Fax 800-334-6955

MAILING ADDRESS

P.O. Box 1441
Minneapolis, MN 55440-1441
Tel: 612-623-6000
Fax: 612-623-6777

AMERICAS

MINNESOTA

Worldwide Headquarters
Graco Inc.
88 -11th Avenue N.E.
Minneapolis, MN 55413

EUROPE

BELGIUM

European Headquarters
Graco N.V.
Industrieterrein - Oude Bunders
Slakweidestraat 31
3630 Maasmechelen,
Belgium
Tel: 32 89 770 700
Fax: 32 89 770 777

ASIA PACIFIC

AUSTRALIA

Graco Australia Pty Ltd.
Suite 17, 2 Enterprise Drive
Bundoora, Victoria 3083
Australia
Tel: 61 3 9468 8500
Fax: 61 3 9468 8599

CHINA

Graco Hong Kong Ltd.
Shanghai Representative Office
Building 7
1029 Zhongshan Road South
Huangpu District
Shanghai 200011
The People's Republic of China
Tel: 86 21 649 50088
Fax: 86 21 649 50077

INDIA

Graco Hong Kong Ltd.
India Liaison Office
Room 443, Augusta Point
Regus Business Centre 53
Golf Course Road
Gurgaon, Haryana
India 122001
Tel: 91 124 435 4208
Fax: 91 124 435 4001

JAPAN

Graco K.K.
1-27-12 Hayabuchi
Tsuzuki-ku
Yokohama City, Japan 2240025
Tel: 81 45 593 7300
Fax: 81 45 593 7301

KOREA

Graco Korea Inc.
Shinhan Bank Building
4th Floor #1599
Gwanyang-Dong, Dongan-Ku,
Anyang-si, Korea 431-060
Tel: 82 31 476 9400
Fax: 82 31 476 9801



Questions? 888-541-9788
magnum.graco.com/aplus

Graco Inc. is registered to I.S. EN ISO 9001

SALES/ DISTRIBUTION/ SERVICE

Contact your local sales rep for more information.
www.worldandmain.com