

## 1-1/2" U-Channel (CRC) 150U50-54

54mil (16ga) 50ksi

### Used in framing applications:

- Furring for metal lath systems
- Drop down ceilings
- Lateral bracing in walls

### Geometric Properties

**Web Depth:** 1.500 in

**Design Thickness:** 0.0566 in

**Ultimate, Fu:** 65 ksi

**Leg Width:** 0.500 in

**Min. steel thickness:** 0.0538 in

**Yield stress, Fy:** 50ksi

\*Fy with Cold-Work, Fya 55.3 ksi

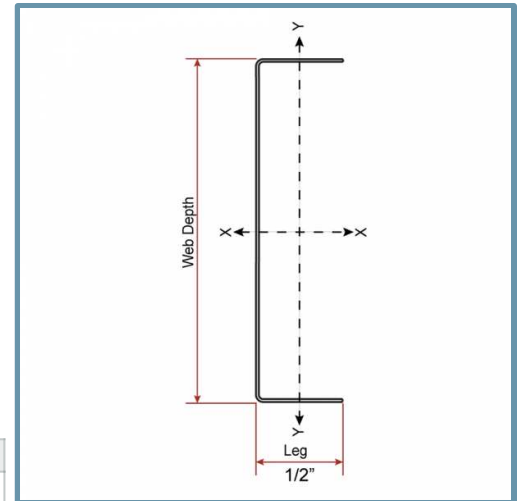

Gross Section Properties of Full Section, Strong Axis	
Cross sectional area (A)	0.130 in <sup>2</sup>
Member weight per foot of length	0.441 lb/ft
Moment of inertia (Ix)	0.039 in <sup>4</sup>
Radius of gyration (Rx)	0.549 in
Gross moment of inertia (Iy)	0.003 in <sup>4</sup>
Gross radius of gyration (Ry)	0.146 in
Effective Section Properties, Strong Axis	
Moment of inertia for deflection (Ix)	0.039 in <sup>4</sup>
Section modulus (Sx)	0.039 in <sup>4</sup>
Section modulus (Sx)	0.052 in <sup>3</sup>
Allowable bending moment (Ma)	1.821 in-k
Allowable shear force (Va)	1292 lb

### Product Data & Ordering Information:

**Coating:** G40, CP60 or G90

**Color coding:** Green

**Stock length:** 16'-0" long pieces (Custom length available by special orders)

**Packaging:** 10 pieces per bundle - 240 pieces per pallet

**Packaging weight:** 71 lbs/bundle

### Code Approvals & Performance Standards

- **AISI S100-16** North American Specification for the Design of CFS Structural Members
- **AISI S240-15** North American Standard for Cold-Formed Steel Structural Framing
  - Section A3 Material - Chemical & mechanical requirements (Referencing ASTM A1003/A1003M)
  - Section A4 Corrosion Protection (Referencing ASTM A653/A653M)
  - Section C Installation - (Referencing ASTM C1007)
- **SDS For ASTM A1003 Steel Framing Products** For Interior Framing, Exterior Framing and Clips/Accessories

**Sustainability Credits** For more details and LEED letters contact Technical Services at 888-437-3244 or visit [clarkdietrich.com/LEED](http://clarkdietrich.com/LEED).

- **LEED v4.1 MR Credit:** Environmental Product Declarations: EPD (1 point) - Sourcing of Raw Materials (up to 2 points) - Material Ingredients (1 point) - Construction and Demolition Waste Management (up to 2 points)
- **LEED v4 MR Credit:** Building Product Disclosure and Optimization: EPD (1 point) - Sourcing of Raw Materials (1 point) - Material Ingredients (1 point) - Construction and Demolition Waste Management (up to 2 points) - Innovation Credit (up to 2 points).

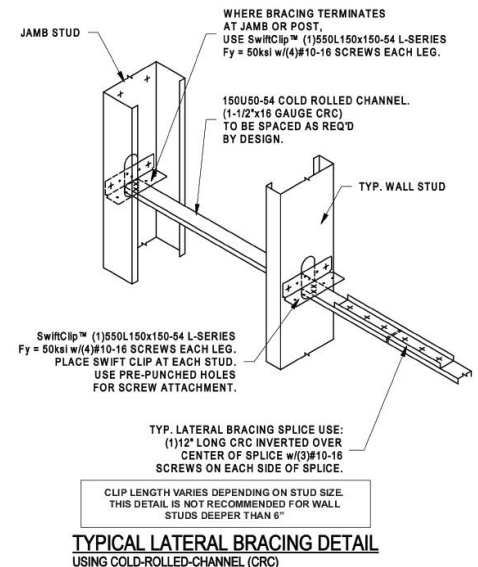

For more ClarkDietrich CAD details see:  
[cad.clarkdietrich.com](http://cad.clarkdietrich.com)