

— AIR TOOLS — **CARPENTER**

15 GAUGE FINISH NAILER

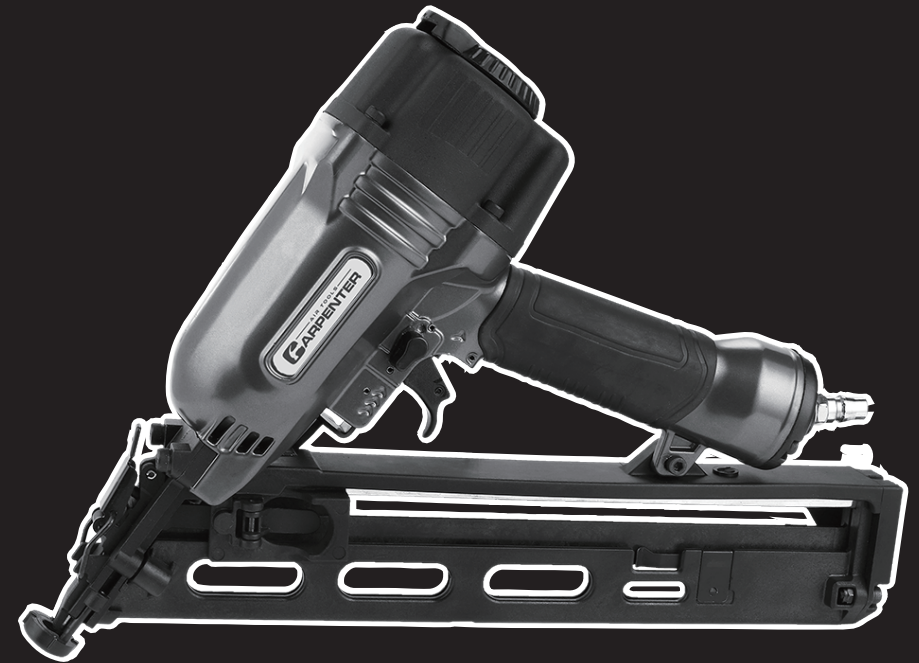

Model No. C1565

IMPORTANT:
Please read this manual carefully before
using this product, and save it for reference.

**INSTRUCTION
MANUAL**

Contact us



info@carpenterpowertools.com



Carpenter Power Tools
359 Hood Rd, Suite #230
Jasper, GA, 30143



1-888-666-1887



<http://www.carpenterpowertools.com>

TABLE OF CONTENTS

TECHNICAL SPECIFICATIONS	4
SAFETY GUIDELINES	5
KEY PARTS DIAGRAM	8
TECHNICAL INFORMATION	9
TYPES OF NAILS	10
OPERATING INSTRUCTIONS	11
TROUBLESHOOTING	17
EXPLODED VIEW	18
PARTS LIST	19

TECHNICAL SPECIFICATIONS

Operating pressure	70–120 psi (4.9–8.3 bar; 5– 8.5 kgf/cm ²)
Dimensions (Length*Height*Width)	13-1/2"(L)x12"(H)x3-1/4"(W)
	(344mmx304mmx82mm)
Net Weight	4.41 lbs (2.0 kg)
Nail capacity	100 PCS
Air consumptio	.045 ft ³ /cycle at 100 psi
	(1.3 ltr/cycle at 6.9 bar)
	(1.3 ltr/cycle at 7 kgf/cm ²)

SAFETY GUIDELINES

This manual contains information that relates to PROTECTING PERSONAL SAFETY and PREVENTING EQUIPMENT PROBLEMS. It is very important to read this manual carefully and understand it thoroughly before using the product. The symbols listed below are used to indicate this information.



DANGER!

Potential hazard that could result in serious personal injury including possible death.



WARNING!

Potential hazard that could result in serious personal injury to the tool user or others in the work area.



CAUTION!

Potential hazard that could result in damage to the tool or property.

PERSONAL SAFETY

These precautions are intended for the personal safety of the user and others working with the user. Please take time to read and understand them. Make sure you read and understand this manual before using this tool. Make sure other users read and understand this manual before they use the tool.

SAFETY GUIDELINES

- **DANGER!** Potential hazard that could result in serious personal injury including possible death.
- Do not use oxygen or any other combustible or bottled gas to power air-powered tools. Failure to observe this warning can cause explosion and serious personal injury or death.
- Do not use this tool in the presence of flammable liquids, dust or gases. Sparks that are created during use may ignite these materials.
- Use only compressed air to power air-powered tools. Use an approved air hose with a minimum length of 25' (7.6 m).
- Do not allow inexperienced or untrained individuals to operate any air-powered tool.
- Keep hands and other parts of the body away from the Outlet (Firing Head) during use.
- Nails or objects in the workpiece can cause serious injury if they are deflected by the workpiece.
- Keep children away from the work area. Do not allow children to handle power tools.
- Never point nailer toward yourself or anyone else.
- Always assume the nailer contains fasteners. Never point the nailer toward yourself or anyone else, whether it contains fasteners or not. If fasteners are mistakenly driven, it can lead to severe injuries. Never engage in horseplay with the nailer. Respect the nailer as a dangerous working implement.

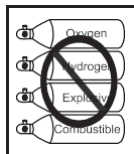

CAUTION!

Potential hazard that could result in damage to the tool or property.

- Disconnect the tool from the air supply and turn off the compressor before performing any maintenance, when the tool is not in use, when it is being handed to another person, when it is left unattended, or when loading and changing nails. Failure to comply may result in injury or damage to equipment.
- Do not exceed the maximum or minimum pressures. Operating the tool at the wrong pressure (too low or too high) may cause excessive noise or rapid wear.
- Use only Non-Detergent Air Tool Lubricating Oil for this tool.
- Near and below freezing, moisture in the air line may freeze and prevent tool operation. Do not store in a cold weather environment to prevent frost or ice formation. Frost and ice on the tools operating valves and mechanisms could cause tool failure.

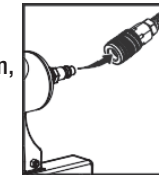

NOTE: Some commercial air line drying liquids are harmful to "O" rings and seals—
Do not use these low temperature air dryers without checking compatibility.



WARNING!

Potential hazard that could result in serious personal injury to the tool user or others in the work area.

- Always wear eye and hearing protection when using the air compressor. Failure to do so may result in sight or hearing loss.
- Do not overload the tool. Allow the tool to operate at its optimum speed for maximum efficiency.
- Do not point the tool towards yourself or other people, even when the tool has stopped. Keep hands, feet, and all other parts of the body clear from work area.
- Do not attempt to clear nailer jams while the air hose is connected.
- Do not keep the trigger or the Push Lever pressed while loading nails.

No.	Description	No.	Description
①	Top Cover	⑬	Nail Feeder(B)
②	Air Outlet	⑭	Valve part
③	Exhaust Cover	⑮	Switching Device
④	Piston O-ring	⑯	Trigger
⑤	Piston	⑰	Body
⑥	Driver Blade	⑱	Cap
⑦	Lock Lever	⑲	Air Plug
⑧	Nail Feeder(A)	⑳	Nail Rail
⑨	Guide Plate(A)	㉑	Nail Stopper
⑩	Push Lever	㉒	Magazine
⑪	Outlet(Firing Head)	㉓	Ribbon Spring
⑫	Blade Guide	㉔	Adjuster

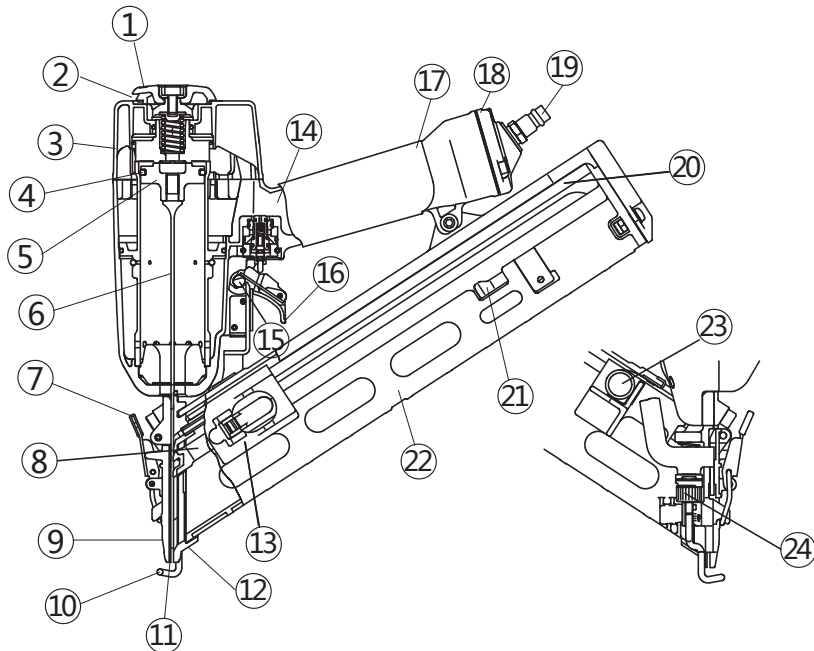

COMPATIBLE COMPRESSORS

GUIDELINES FOR PROPER USE AND OPERATION

Be sure to use a proper air compressor with CARPENTER Air Tools. The compressor should be able to supply a minimal air delivery of 4.7 CFM @ 90 PSI to ensure the compressor can run continuously with the CARPENTER 15 Gauge finish Nailer.

GENERAL USE

The C1565 is ideal finish nailer for interior trim, exterior trim, baseboards, crown molding, window and door casings, chair rails and so on, it accepts 15-gauge nails from 1-1/4" up to 2-1/2" in length. The tool is lightweight and durable, stands up to the elements and provides consistently accurate results over the life of the tool. An ideal tool for a variety of construction projects, including installation of asphalt roofing shingles and insulation boards. It also features a high-capacity side-load magazine, tool-less depth adjustment, durable construction, and more.

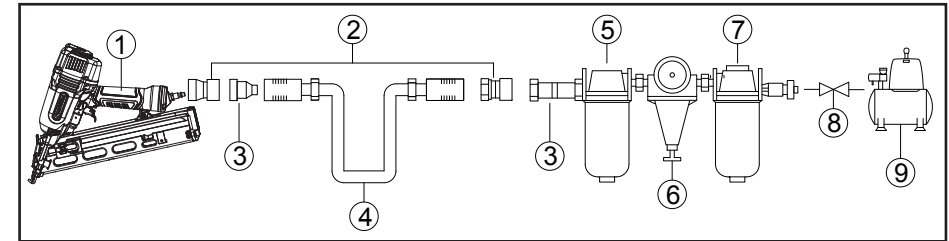



No.	Description	No.	Description
1	15 Gauge finish Nailer	6	Regulator
2	Quick connector	7	Filter
3	Quick coupler	8	Cut-off valve
4	Air hose	9	Air compressor
5	Lubricator		

- It is recommended that a filter-regulator-lubricator be used and be located as close to the tool
- If a filter-regulator-lubricator is not installed, place up to 6 drops of compressor oil into the air inlet plug before each use.
- If a filter-regulator-lubricator is installed, keep the air filter clean. A dirty filter will reduce the air pressure to the tool, which will cause a reduction in power, efficiency, and general
- Verify that all of the connections in the air supply system are sealed in order to prevent air leakage.

Read and follow all the safety instructions at the beginning of this manual and inspect the air-powered nailer prior to each use in order to ensure that the proper power source is being used and verify that the tool is in proper working order

ACCEPTABLE NAILS

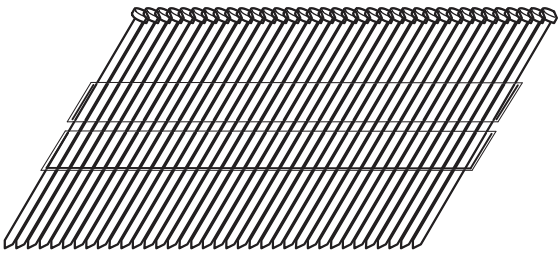
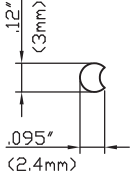
Only nails shown in the Table below can be driven with this Nailer.

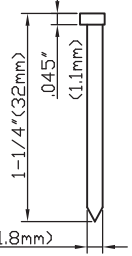
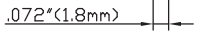
15 Gauge finish nails	Min.	Max.
		
		
		

STANDARD ACCESSORIES

1	Safety glasses	1
2	Allen wrench for M6 screw	1
3	Allen wrench for M5 screw	1
4	Nose cap	1

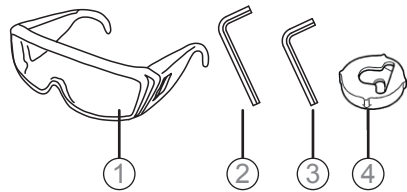

LOADING NAILS

1. Insert nail strip into rear of magazine (Fig.A).

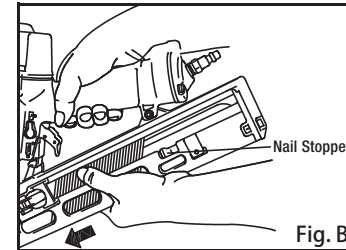
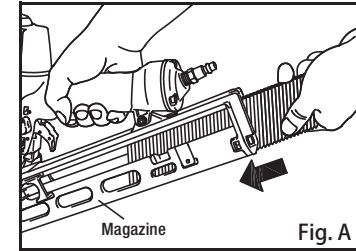

2. Slide the nail strip forward in the magazine. The nail strip should pass the nail stopper (Fig.B).

3. Pull the nail feeder(B) back to engage the nail feeder(A) to the nail strip (Fig.A).

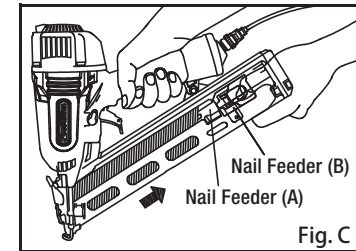

REMOVING NAILS

1. Disconnect Air hose (Fig.D).

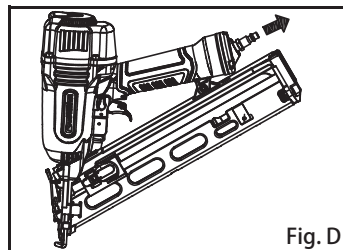

Fig. D

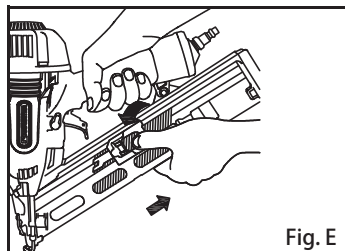

Fig. E

2. Depress the nail feeder and slowly slide the nail feeder forward (Fig.E).

3. Remove the remaining nails from the magazine (Fig.F).

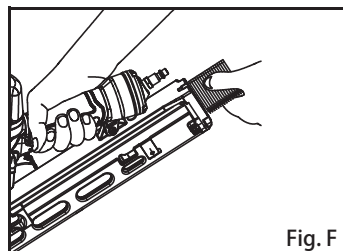

Fig. F

METHOD OF OPERATION

The Carpenter Air-powered Brad Nailer is equipped with a push lever at the nailing point and will not operate unless the push lever is depressed (pushed upwards)(Fig.G).

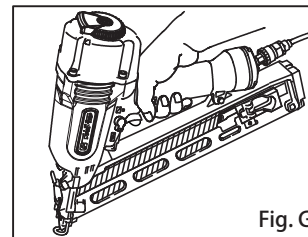
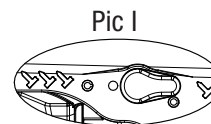

Fig. G

① Single Actuation Mechanism

1. Set the switching device to the position as (Pic I);
2. Make sure the push lever position to the workpiece, Pull the gunbody and keep the push lever connect to the workpiece and then press the trigger, It start to work;
3. After the first nails fire, loosen the trigger and raise up the gunbody, Position the push lever to the workpiece and rework as above steps.



Pic I

② Contact Actuation Mechanism

1. Set the switching device to the position as (Pic II);
2. Press the trigger first and then position the push lever to the workpiece, Press the push lever and begin to fire;
3. After the first nails out, hold the trigger tight, and raise up the push lever, Make sure the push lever position to the workpiece, and then press it and rework as above steps.

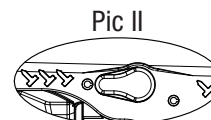

Pic II



DANGER!

- Do not drive nails on top of other nails or with nailer at too steep an angle. Nails can ricochet and seriously injure someone.
- In order to avoid double firing or unwanted ejection of a nail due to bouncing of the nailer, do not push nailer on workpiece to avoid recoil. Recoil is necessary for proper operation of the nailer.
- Do not drive nails from both sides of a wall at the same time. Nails can be driven into and through the wall and hit a person on the opposite side.
- Never drive nails into thin boards or near corners and edges of workpiece. Nails can be driven through or away from workpiece resulting in serious or life threatening injury.
- Never use a nailer which is defective or operating abnormally.
- Never use a nailer as hammer.

ADJUSTING THE NAILING DEPTH

To assure that each nail penetrates to the same depth, be sure that:

- ① The air pressure to the Nailer remains constant (regulator is installed and working properly).
- ② The nailer is always held firmly against the workpiece. If nails are driven too deep or too shallow into the workpiece, adjust the nailing depth using the following instructions.

1. Disconnect air hose from nailer (Fig. H).

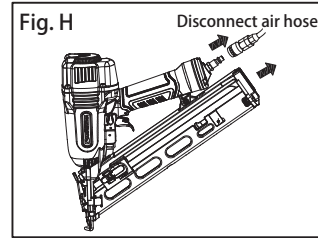

- 2a. If the nails are driven too deep, pull the adjuster downward and turn counter-clockwise (Fig. J).

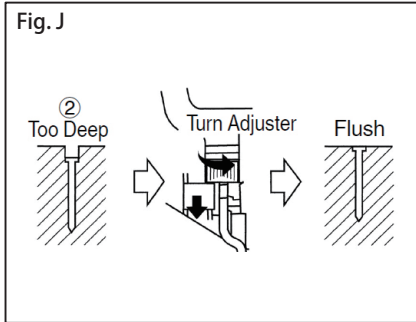

- 2b. If nails are driven too shallow, pull the adjuster downward and turn clockwise (Fig. K).

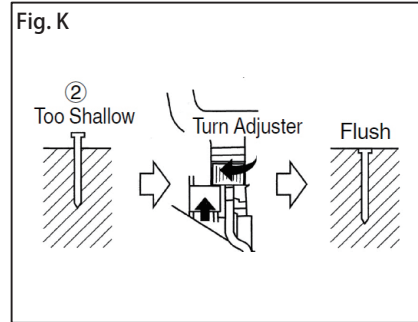

3. Connect the air hose and perform a nailing test. ALWAYS WEAR EYE PROTECTION.
4. If additional adjustments are necessary, DISCONNECT AIR HOSE FROM NAILER and repeat step 2.

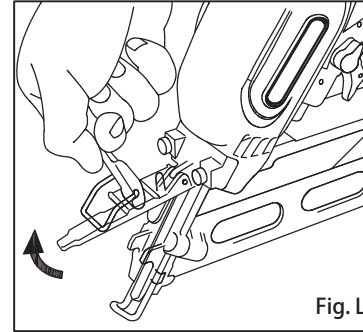

1. Open the guide (Fig.L).

2. Remove the jammed nails with a slotted-head screwdriver (Fig.M).

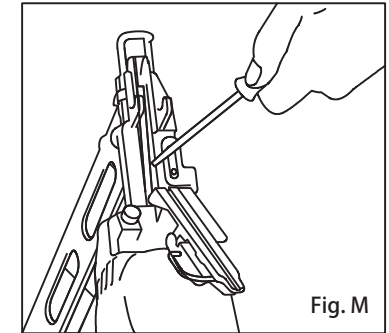

MAINTENANCE

MAINTENANCE REQUIRED	DESCRIPTION	TOOLS OR MATERIALS REQUIRED	MAXIMUM SERVICE INTERVAL		
			Each Use or Every 2 Hrs	Monthly	As Needed
General inspection-free movement	Adjusting screw assembly Movable magazine	None	X		
In-depth inspection	Worn or broken parts			X	X
Replace worn or broken parts					X
Lubrication	See below	Pneumatic tool oil	X		

- Lubrication: If the air-powered finish nailer and the compressor are not equipped with an in-line lubrication system, place up to 6 drops of pneumatic tool oil into the air inlet before each work day or after every 2 hours of continuous use, depending on the characteristics of the workpiece and type of fasteners used.
- Air-operated tools must be inspected periodically and worn or broken parts must be replaced to ensure that the tools are operating safely and efficiently.
- Inspect and replace worn or damaged O-rings, seals, etc. Tighten all screws and caps frequently in order to help prevent personal injury.
- Keep the magazine of the tool clean and free of any dirt or abrasive particles.

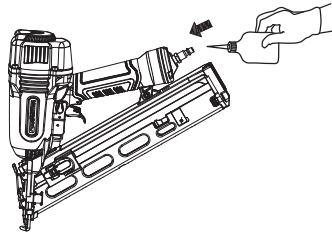

Note: Solvent sprayed on the nose to clean and free up the push lever may have the opposite effect. The solvent may soften the tar on the shingles and cause tar buildup to be accelerated. Dry operation is better.

TROUBLESHOOTING

Most minor problems can be resolved quickly and easily using the table below. If problems persist, contact a Carpenter for assistance.

SYMPTOM	PROBLEM	SOLUTIONS
Nailer operates, but no nail is driven.	<ol style="list-style-type: none"> 1. Check for a jam. 2. Nail feeder damaged? 3. Ribbon spring weakend or damaged? 4. Check for proper nails. 	<ol style="list-style-type: none"> 1. Clear a jam per page 18. 2. Replace nail feeder. 3. Replace ribbon spring. 4. Use only recommended nails.
Weak drive. Slow to cycle.	<ol style="list-style-type: none"> 1. Check air pressure. 2. Check position of nailing depth adjustment adjuster. 3. — 4. Driver blade worn 5. Piston O-ring worn or damaged? 	<ol style="list-style-type: none"> 1. Increase air pressure. (Do not exceed 120 psi (8.3bar 8.5kg/cm²)) 2. Readjust per page 15. 3. Use Hitachi pneumatic tool lubricant. 4. Contact Hitachi for replacement. 5. Contact Hitachi for replacement.
Drives too deep.	<ol style="list-style-type: none"> 1. Check air pressure. 2. Check position of nailing depth adjustment guide plate (A) 	<ol style="list-style-type: none"> 1. Reduce air pressure. (Adjust 70-120psi (4.9-8.3bar 5-8.5kg/cm²)) 2. Readjust per page 15.
Skipping nails. Intermittent feed.	<ol style="list-style-type: none"> 1. Check for proper nails. 2. — 3. Nail feeder damaged? 4. Ribbon spring weakend or damaged? 	<ol style="list-style-type: none"> 1. Use only recommended nails. 2. Lubricate the nail rail per page 18. 3. Replace nail feeder. 4. Replace ribbon spring.
Nails jam Driven nail is bent.	<ol style="list-style-type: none"> 1. Piston O-ring worn or damaged? 2. Check for proper nails. 3. — 4. Driver blade worn? 	<ol style="list-style-type: none"> 1. Contact Hitachi for replacement. 2. Use only recommended nails. 3. Lubricate the nail rail per page 18. 4. Contact Hitachi for replacement.
Drives properly during normal operation, but does not drive fully at faster nailing speeds.	<ol style="list-style-type: none"> 1. Check inside diameter of air hose. 	<ol style="list-style-type: none"> 1. Use larger air hose.

Note: Solvent sprayed on the nose to clean and free up the push lever may have the opposite effect. The solvent may soften the tar on the shingles and cause tar buildup to be accelerated. Dry operation is better.

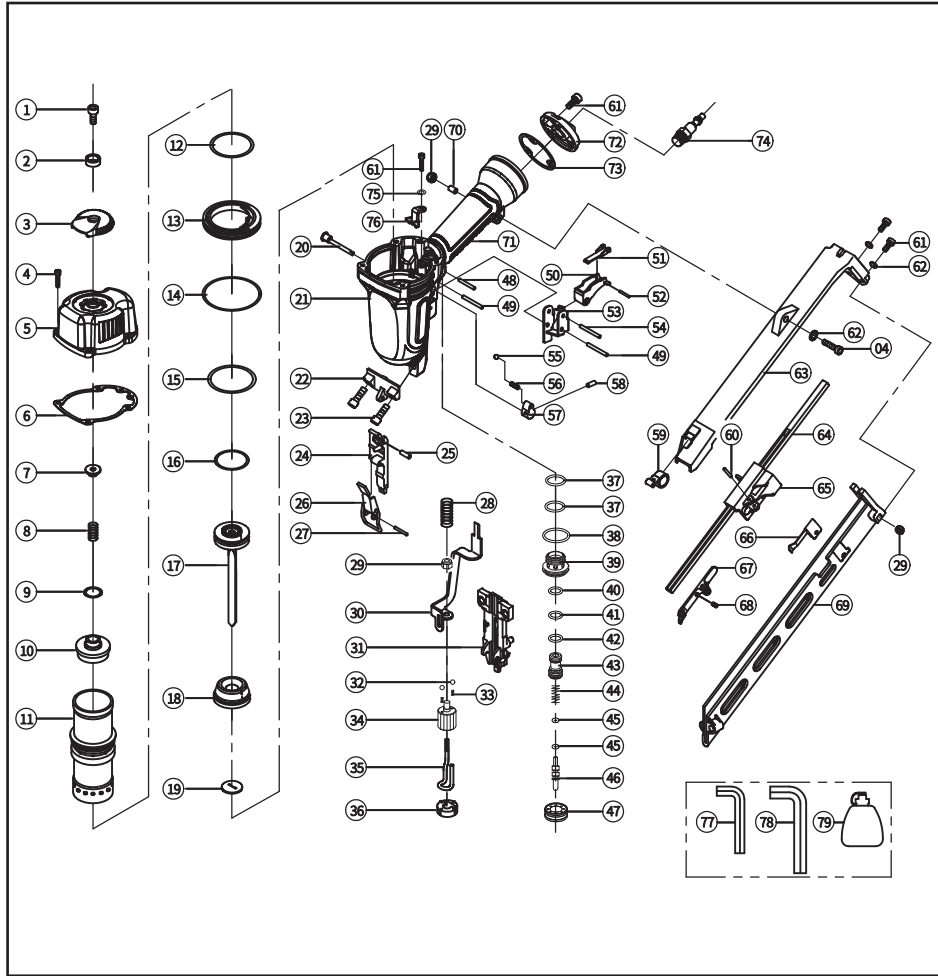

No.	Description	Qty.
1	Hex bolt M6X12	1
2	Plate	1
3	Air exhauster	1
4	Hex bolt M5X20	5
5	Exhaust cover	1
6	Gasket	1
7	Washer	1
8	Head Valve Spring	1
9	O-ring 20.4X2.4	1
10	Head valve	1
11	Cylinder	1
12	O-ring 46X2	1
13	Collar	1
14	O-ring 56X2.4	1
15	O-ring 45X3.55	1
16	O-ring 34.5X3.55	1
17	Main piston	1
18	Bumper	1
19	Washer	1
20	Shift lever	1
21	Gunbody	1
22	Mixed plate	1
23	Hex bolt M6X30	2
24	Movable Plate	1
25	Roll pin 4x14	1
26	Guide Plate	1
27	Roll pin 3x20	1
28	Spring	1
29	Locked nut M5	4
30	Safety shelf	1
31	Driver head	1
32	Steelball Dw=2	1
33	Spring	1
34	Adjustable Nut	1
35	Safety tip	1
36	Safety sleeve	1
37	O-ring 14X1.8	2
38	O-ring 20X1.8	1
39	Valve bushing	1
40	O-ring 6.1X1.8	1

No.	Description	Qty.
41	O-ring 6.4X2	1
42	O-ring 9X1.8	1
43	Sleeve	1
44	Switch Spring	1
45	O-ring 2.4X1.6	2
46	Valve plunger	1
47	Valve bushing	1
48	Roll pin 3x22	1
49	Roll pin 3x20	2
50	Trigger	1
51	Safety shield	1
52	Roll pin 3x16	1
53	Guide seat	1
54	Roll pin 3x35	1
55	Steelball Dw=4	1
56	Spring	1
57	Shift knob	1
58	Roll pin 3x10	1
59	Coil Spring	1
60	Roll pin 2.5x20	1
61	Hex bolt M5X16	5
62	Washer d=5	3
63	Magazine cover	1
64	Nail Rail	1
65	Pusher seat	1
66	Nail Stopper	1
67	Pusher	1
68	Spring	1
69	Nail groove	1
70	Sleeve	1
71	Handle Sleeve	1
72	End Cap	1
77	Washer	1
74	1/4 NPT18 Air inlet plug	1
75	Air plug	1
76	Block	1
77	Hex wrench M5/4mm	1
78	Hex wrench M6/5mm	1
79	Oil pot	1