

FlipToggle™

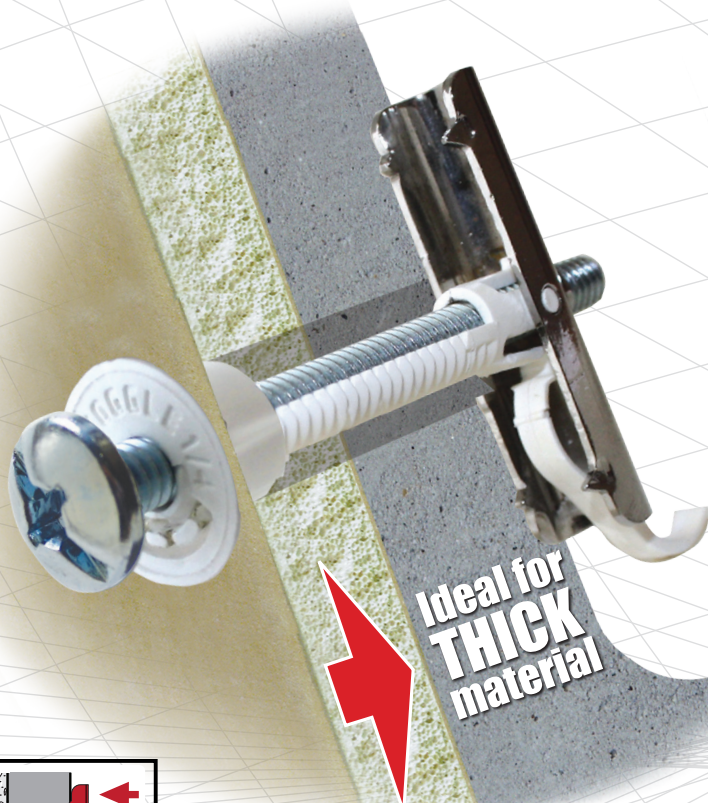

PERFECT FOR THESE MATERIALS

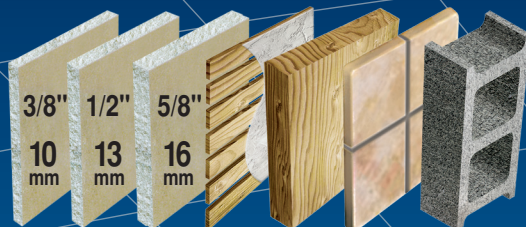

Ideal for **THICK** material

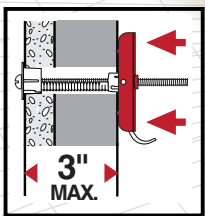

- ▶ 2X STRONGER THAN REGULAR TOGGLE WINGS FOR SAME BOLT DIAMETER.
- ▶ REQUIRES A SMALLER HOLE, A SHORTER BOLT AND THE TOGGLE WILL NEVER FALL BEHIND THE WALL.
- ▶ INSTALLS WITH A SCREW GUN FOR FAST AND EASY INSTALLATION. NO NEED TO PULL BACK ON THE BOLT ANYMORE.
- ▶ NEW, SIMPLE, ONE STRAP DESIGN TO HOLD THE TOGGLE PERFECTLY VERTICAL FOR EASY INSERTION AND FLIPPING OPERATION.

INSTALLS IN 4 EASY STEPS

- 1 FOLD IT
- 2 INSERT IT
- 3 FLIP IT
- 4 TIGHTEN IT



UP TO	
5/8" Drywall Max. Pull	375 lb 170 kg
Concrete (3000 psi) Max. Pull	1135 lbs 515 kg

Made in



COBRA

ANCHORS ► FIXATIONS

www.cobraanchors.com

FlipToggle™



COBRA

ANCHORS > FIXATIONS

TECHNICAL SPECIFICATIONS

LOAD CAPACITIES

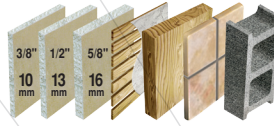

Material	Size	Drill Size	LBS				KG			
			Pull Max	Pull Safe	Shear Max	Shear Safe	Pull Max	Pull Safe	Shear Max	Shear Safe
DRYWALL 1/2" / 13 mm	3/16"-24	1/2"/13 mm	250 lbs ⇒ 125 lbs	240 lbs ⇒ 120 lbs	250 lbs ⇒ 125 lbs	113 kg ⇒ 57 kg	109 kg ⇒ 54 kg			
	1/4"-20	1/2"/13 mm	280 lbs ⇒ 140 lbs	250 lbs ⇒ 125 lbs	127 kg ⇒ 64 kg	113 kg ⇒ 57 kg				
DRYWALL 5/8" / 16 mm	3/16"-24	1/2"/13 mm	375 lbs ⇒ 188 lbs	315 lbs ⇒ 158 lbs	170 kg ⇒ 85 kg	143 kg ⇒ 71 kg				
	1/4"-20	1/2"/13 mm	375 lbs ⇒ 188 lbs	352 lbs ⇒ 176 lbs	170 kg ⇒ 85 kg	160 kg ⇒ 80 kg				
HOLLOW BLOCK	3/16"-24	1/2"/13 mm	840 lbs ⇒ 420 lbs	—	—	381 kg ⇒ 191 kg	—	—		
	1/4"-20	1/2"/13 mm	1135 lbs ⇒ 568 lbs	—	—	515 kg ⇒ 257 kg	—	—		

INSTALLATION INSTRUCTIONS

COMBINED HEAD
For flat, Phillips or Robertson screwdrivers

BOLT
3/16"-24 or 1/4"-20 thread

CAP

NYLON STRAP

HEAD
Comes in two sizes for bolt with 3/16" or 1/4" diameter

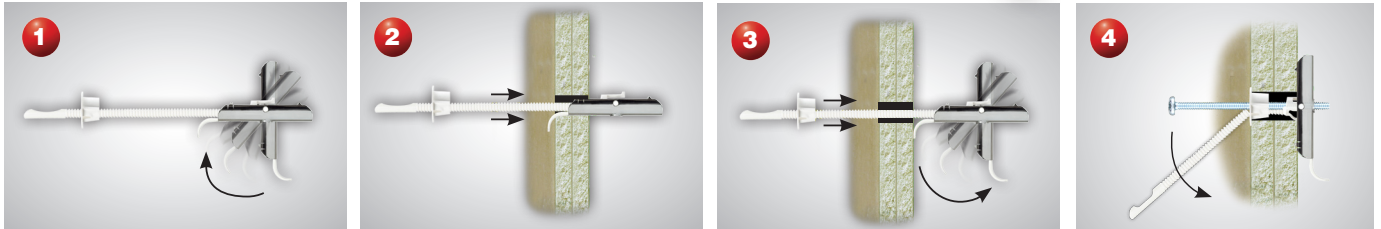

- 1 Drill the appropriate size hole (1/2" / 13 mm). Flip the head of the FlipToggle™ in order for it to be inline and secured onto the strap.
- 2 Insert the FlipToggle™ into the drilled hole. When completely inserted, pull the strap which will flip the toggle flat against the back of the wall.
- 3 Push the cap into the drilled hole until flush with the wall, and then hold the cap against the wall while pulling the strap towards you until reasonably tight.
- 4 Bend to snap off the excess of the strap flush with the wall. Insert the bolt through the fixture, into the anchor and tighten securely.

TOOLS REQUIRED



Made in

