



Product Description

The Cobra WallGripper™ is the only expandable screw-in anchor on the market. It expands and grips behind the drywall and it is twice as strong as a regular screw-in anchor. Patented design to offer you the ultimate holding power without any pre-drilling. It is a unique body design with 4 expandable wings that collapse and grip tightly behind the drywall. A fine center point that helps guide the anchor into the wall with flawless precision. A sharp cutting edge that reduces the force required to cut the material. Also, a sharp profile thread that cuts deeply into the hole to ensure ultimate holding power and stability without damaging the wall material.

Features & Benefits

- ▶ Expands and grips tightly behind drywall
- ▶ No pre-drilling required
- ▶ All you need is a screwdriver

Perfect for:



Electrical boxes, lighting fixtures, shelving, etc.

Packagings



WallGripper™

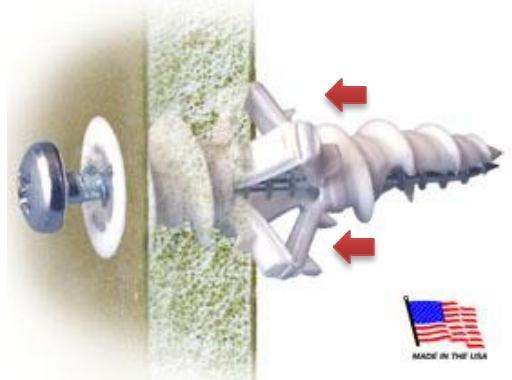

Product sizes & Materials

Nylon

Head styles & colors



Suitable Base Materials

- ▶ Drywall 3/8" – Wallboard 10 mm
- ▶ Drywall 1/2" – Wallboard 13 mm

Hollow Wall Anchors





Load Capacities



Material	Size	Material	PULL MAX lbs	PULL SAFE lbs	SHEAR MAX lbs	SHEAR SAFE lbs	PULL MAX kg	PULL SAFE kg	SHEAR MAX kg	SHEAR SAFE kg
Drywall 3/8 16mm	8	Nylon	55	28	120	60	25	12	54	27



Material	Size	Material	PULL MAX lbs	PULL SAFE lbs	SHEAR MAX lbs	SHEAR SAFE lbs	PULL MAX kg	PULL SAFE kg	SHEAR MAX kg	SHEAR SAFE kg
Drywall 1/2 13mm	8	Nylon	70	35	140	70	32	16	64	32

- Allowable load capacities are calculated using an applied safety factor of 2:1 shown in the SAFE column.
- We recommend to always use the SAFE loads capacity.

Tools required



No Pre-Drilling
Screw Driver: # 2 Phillips

Installation instructions

1. Using a screwdriver, pierce the tip of the WallGripper™ into drywall/wallboard.
2. Turn clockwise until flush with wall.
3. Insert the screw through object you need to affix and insert into the WallGripper™. Turn clockwise until you feel a firm resistance

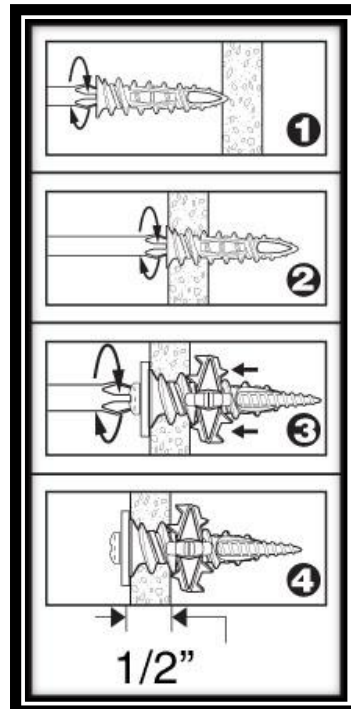

Hollow Wall Anchors