



BIRD BATH W/STAND

Item # 970 (Heated), 850 (Non-Heated) & WBU970 (Heated)

Specifications (Model 970)

150 watts, 120 VAC, 60 Hz, 1.25 Amps

Thermostatically Controlled

Heated bird bath is thermostatically controlled and will not be damaged if the bath runs out of water.

Precautions (Model 970)

1. Connect to a properly grounded outlet. Many older homes do not have properly grounded outdoor electrical outlets. Check with an electrician if you have any doubts regarding your electrical ground.
2. Locate the bird bath where it will be away from possible snow drifts.
3. Do not place the heated bath section directly on the ground.
4. Do not immerse the heated bath section in water.
5. Connect to a circuit that is protected by ground Fault Circuit Interrupter (GFCI). This is a sensitive device that cuts off the electricity if there is any leakage of current. This device may be obtained from any electrician or hardware store.

Evaporation

This bath was designed to be attractive to birds in shape, slope, texture, and depth. Because of these features, the bath has a rather large surface area relative to the amount of water it holds. This is typical of a well-designed and functional bird bath. However, these features will also accelerate evaporation therefore do not be alarmed if you must add water on a daily basis.

Maintenance

Clean the bird bath regularly to prevent build up of lime. The construction is plastic so most cleaning materials can be used. Never immerse the heated section in water.

Warranty

This heated birdbath is warranted for a period of 3 years from the date of purchase. If you believe your unit is defective and still within the warranty period, return it to the place of purchase for inspection and possible replacement.

Instructions for Bird Bath Stand

Tools needed: Phillips screwdriver

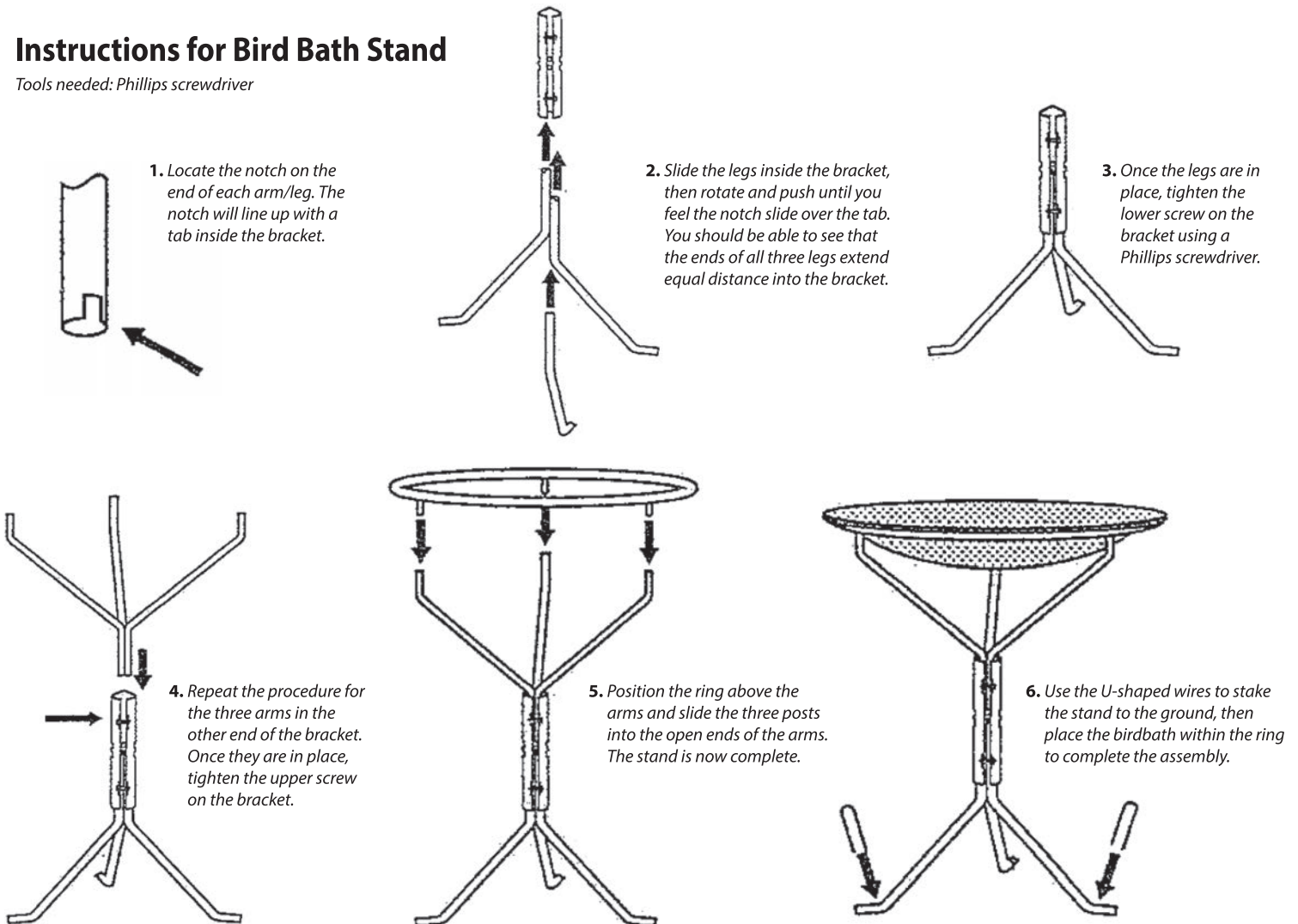

Instructions for use with the API™ LOCKNDRY™

1. Insert the plug into the receptacle just as you would a normal extension cord making sure the plug is fully inserted.

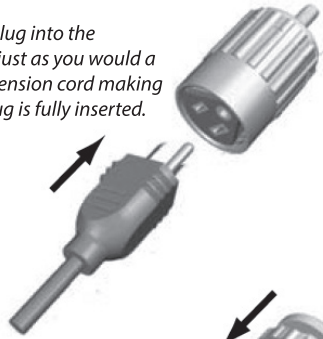

2. Slide the large nut forward to engage the threads on the plug.

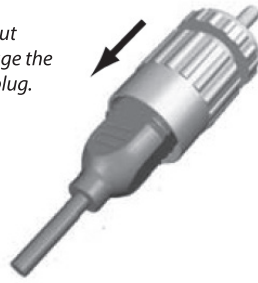

3. Rotate the nut to tighten the plug.

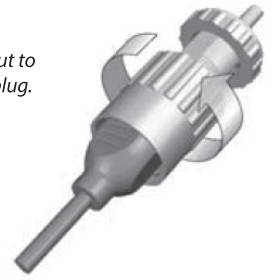

4. Slide the second, thinner, red nut forward to engage the threads.

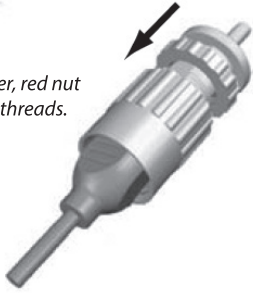

5. Rotate the red nut snugly against the larger nut.



Features

- Plugs into any normal 3-prong outlet
- Mates with LOCKNDRY plugs to form a water-resistant seal
- Keeps connection from separating during use
- Second, locking nut for secure connections