

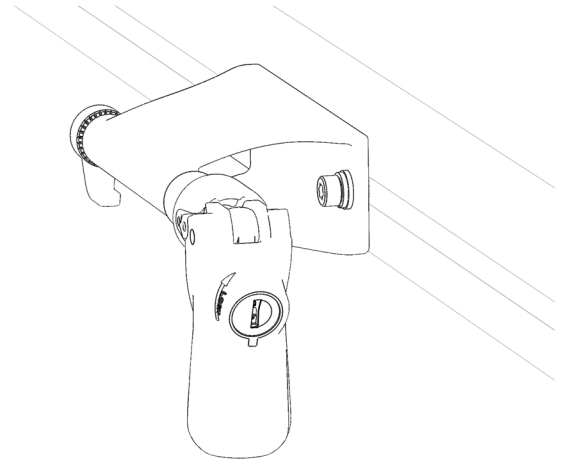

rockymounts™
LoBall
Track



Guidelines

- This carrier is intended for RockyMounts™, Toyota™, Nissan™, and GMC™ tracks only; use on others is at own risk.
- Bicycles must be equipped with quick release front wheel.
- Bicycle weight limit is 35lbs with this carrier.
- Forks equipped with carbon fiber dropouts or forks without safety tabs are not covered under this warranty.
- After loading bike, shake fork side to side to ensure assembly is tight and secure.

Parts Included

A: Body w/ Locking QR Skewer
B: Key
C: T30 Torx Key

D: M6 Split Washer
E: M6 Flat Washer
F: M6 X 25 SHCS Torx Bolt

G: Track Plate

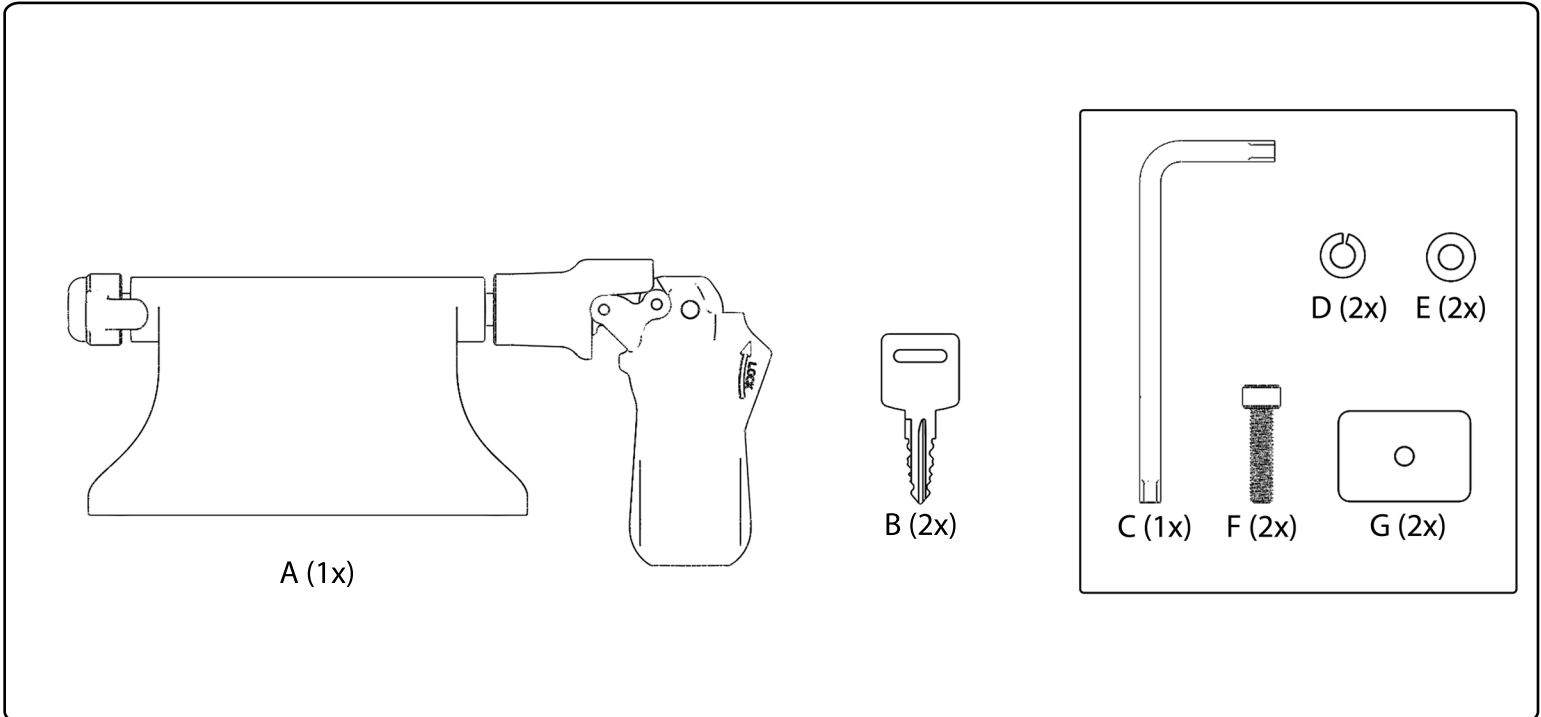

Installation Instructions

1 Remove Skewer

Remove QR skewer from main body by holding fixed end and unscrew handle

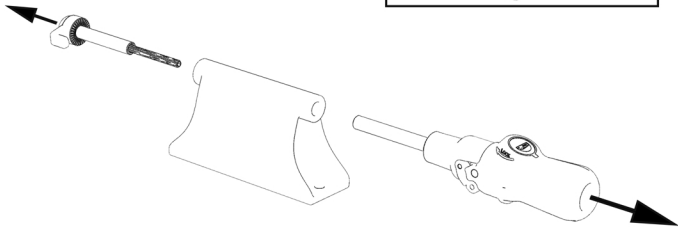
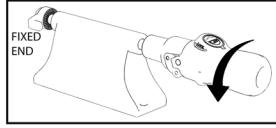

2 Install Track Kit

Place a split washer, then a flat washer onto an M6x25 bolt. Pass bolt through mounting hole and loosely thread into track plate. Repeat for the other bolt

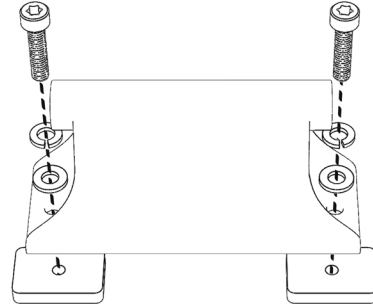

3 Mount body to Track

Slide assembly onto track from either end. Tighten two M6 bolts using T30 torx key. Reinstall QR skewer

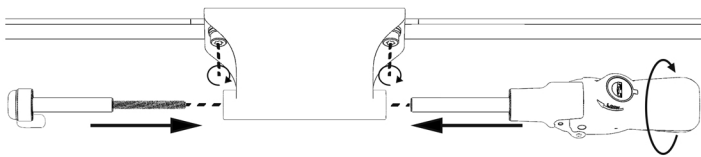
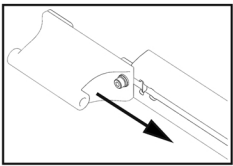

4 Loading A Bike

With QR handle open and fixed end pointed down, load bike fork onto skewer. Adjust tightness by turning handle. Close handle by flipping 90°. If too tight or too loose, open handle and re-adjust until handle closes with tension. Shake fork side to side to ensure bike is securely mounted. Lock handle with key

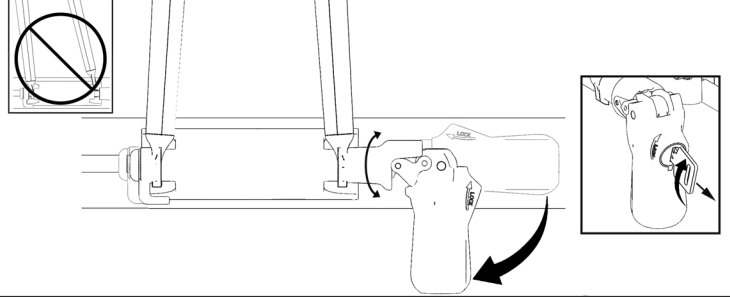

Warnings

Check all fastenings (nuts, bolts, straps, and skewer) before each use.

QR skewer is not an on/off switch. Handle must close with enough tension to hold bike. Shake bike side to side to ensure proper mounting. Fork should be properly seated and not move. If at all unsure, do not use.

Remove Baby Seats, Panniers, U-Locks, or items that could detach from the bicycle.

Not intended for off road use. Not intended for use on trailers or towed vehicles.

Locks are only deterrents to thieves, RockyMounts™, Inc. cannot be held liable for stolen bicycles.

Remove bike before entering a car wash.

Once a year, remove rack from car. Clean and inspect for damage.

Lifetime Warranty

Thank you for purchasing a RockyMounts™ product. We take pride in providing a great customer experience and manufacturing products that enable our customers to get their gear to their next colorful adventure.

As of January 1, 2014, RockyMounts™ products are covered for life to the original purchaser when used in accordance with the instruction manuals' assembly, installation and use guidelines.

If you feel something broke before it's time, please email us at ride@rockymounts.com or call us at 800.873.1871. For the most efficient service, email a digital photo (we need this photo to verify the problem) of the product in question, a brief description of the situation, and your purchase receipt. Our techs will respond within one business day. Most of the time we'll replace the part in question, but we may ask for more details.

RockyMounts™, Inc. warranty only covers RockyMounts™, Inc. products. It does not cover theft, or damage to vehicles and/or equipment.

All products purchased prior to Jan 1, 2014 are covered by a one-year warranty; see your product manual for details.